

## ATDEC AW-ORA-F Ora Mounting Arm for Monitor Installation Guide

[Home](#) » [ATDEC](#) » ATDEC AW-ORA-F Ora Mounting Arm for Monitor Installation Guide 

ATDEC AW-ORA-F Ora Mounting Arm for Monitor

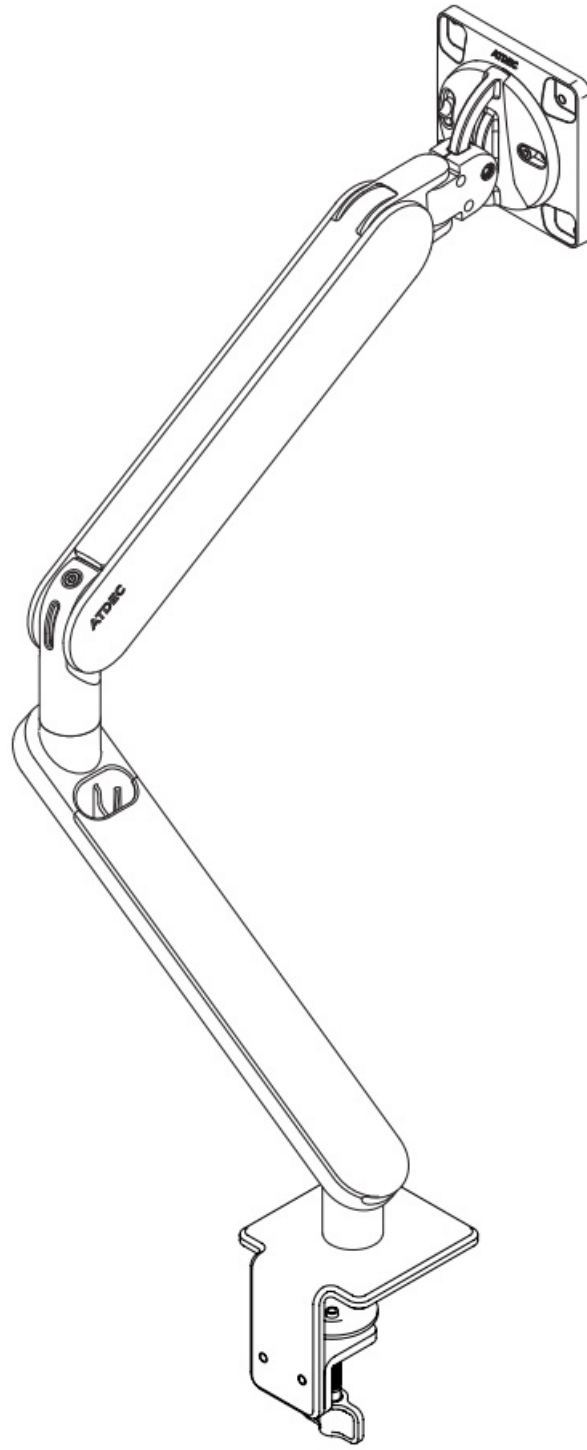

## Contents

- 1 COMPONENT CHECKLIST
- 2 Hardware & Tools
- 3 CAPACITY
- 4 WARRANTY
- 5 TOOLS REQUIRED
- 6 IMPORTANT INFORMATION
- 7 Alternative Fixing Options
- 8 Attach F-clamp to Desk
- 9 Attach Lower Link to Clamp
- 10 Attach Upper Link
- 11 Mount Monitor
- 12 Adjustments
- 13 Cable Management
- 14 Documents / Resources
  - 14.1 References

## COMPONENT CHECKLIST

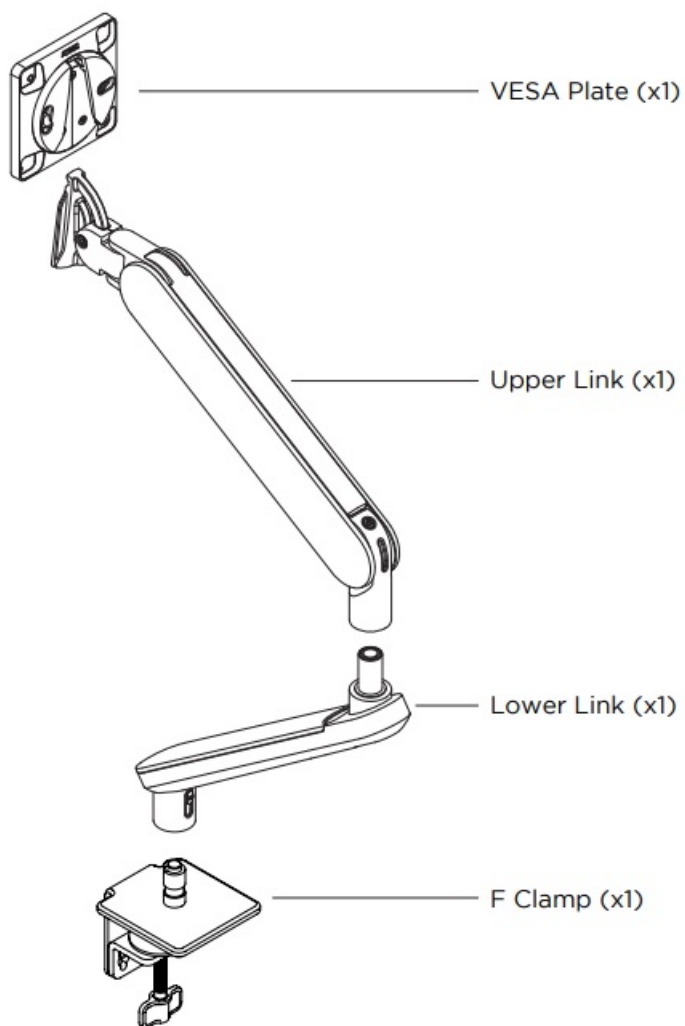

## Hardware & Tools

- M4x10 Screw (x4)

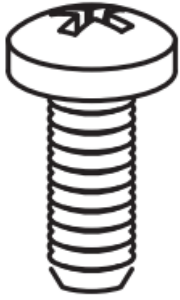

- Security Screw (x1)

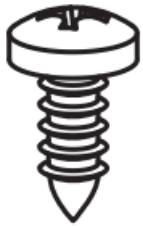

- 4mm Hex Key (x1)

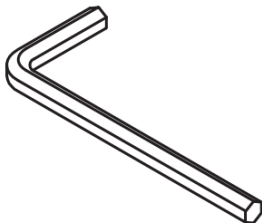

## CAPACITY

**Weight:** 2 – 8kg (4.4 – 17.6lb)

**Display Size:** Up to 35" (curved or flat) (Larger monitors within the weight capacity may be compatible, please contact Atdec for advice).

## WARRANTY

10 Years Limited

## TOOLS REQUIRED

Phillips head screwdriver

## IMPORTANT INFORMATION

- Install Ora Monitor Arm as per these installation instructions.
- The manufacturer accepts no responsibility for incorrect installation.
- Do not over-tighten screws and adjustment points on product.
- This product is not suitable for outdoor use.
- Do not use this product for mobile applications.
- Please ensure desk structure and mounting surface are of sufficient strength to support this product and

mounted equipment.

- Deep devices (such as all-in-one PCs), VESA mounted accessories (such as mini PC brackets and mounts), and offset VESA locations exert additional leverage that can exceed the capacity of the mount even though the monitor weight may be within the stated range. Please contact Atdec if you would like further information.
- Suits displays with VESA mounting hole patterns 75×75 and 100×100. Spacer kit (sold separately) may be required for recessed 75×75 hole patterns.
- For edge clamp Installations, ensure the monitor is always positioned over the work surface. Do not position the monitor beyond the rear edge of the work surface.
- Periodic adjustment to counterbalance and tilt tension may be required.

# ATDEC

No portion of this document or any artwork contained herein should be reproduced in any way without the express written consent of Atdec Pty Ltd. Due to continuing product development, the manufacturer reserves the right to alter specifications without notice. ©20230210

## Alternative Fixing Options

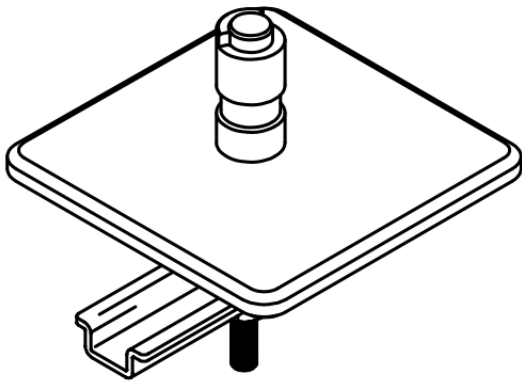

**Ora Bolt Through Fixing AW-FB**  
(sold separately)

### Attach F-clamp to Desk

Configure F Clamp for desk thickness

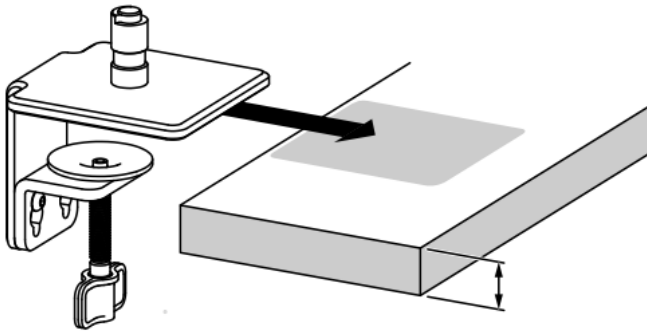

## Standard Desks

0 - 35mm

(0 - 1  $\frac{3}{8}$ " )

OR

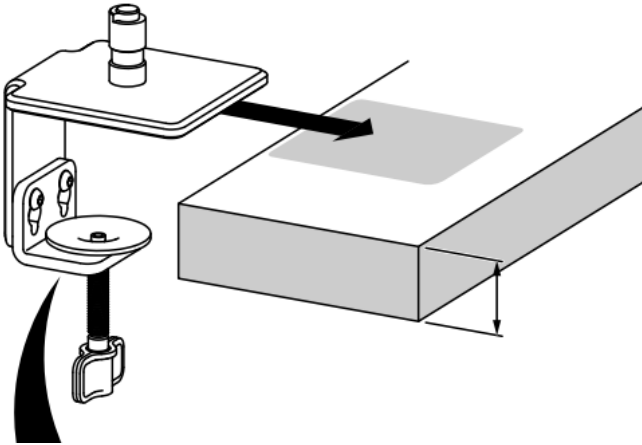

## Thicker Desks

35 - 70mm

(1  $\frac{3}{8}$  - 2  $\frac{3}{4}$ " )

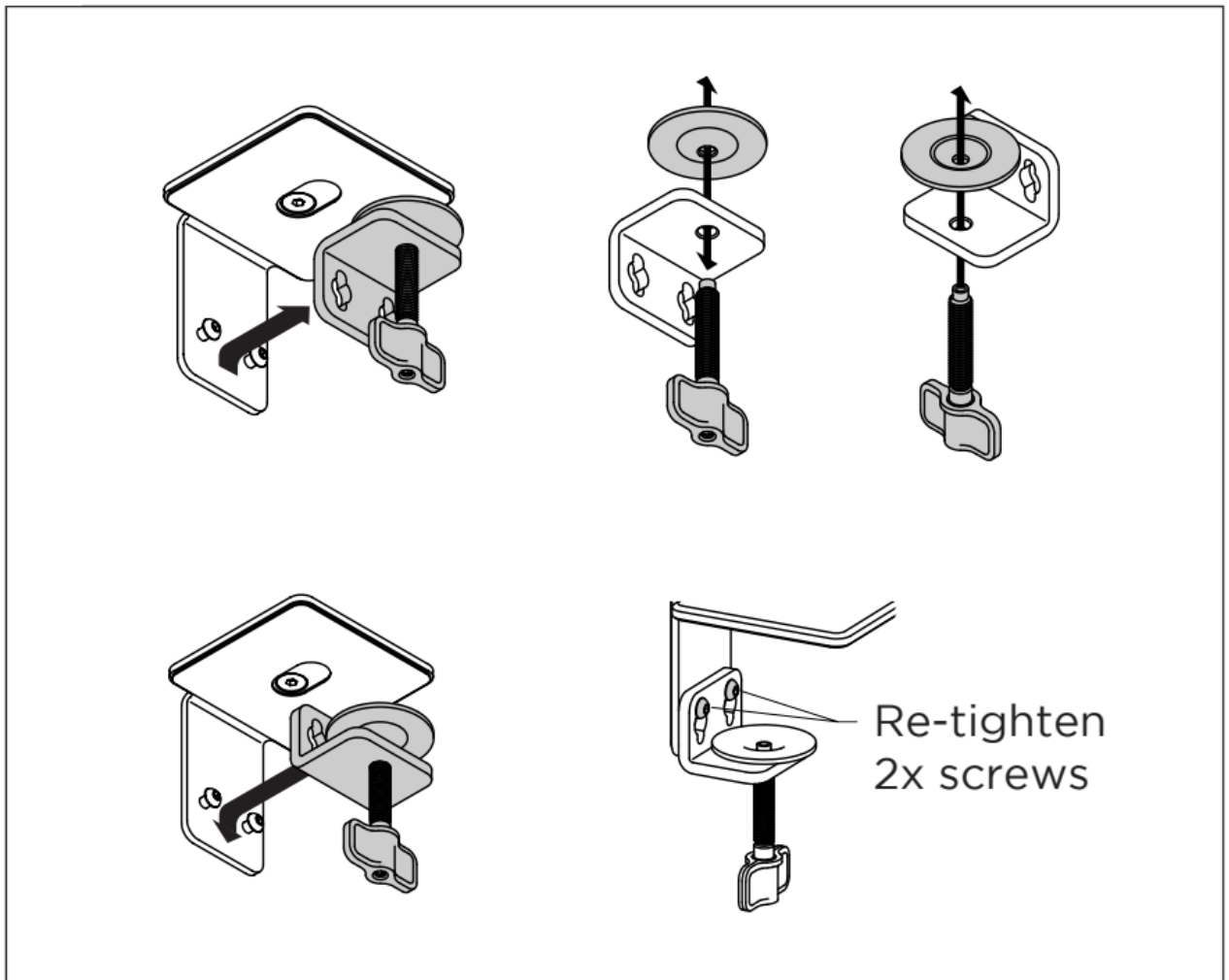

Position clamp on edge of work surface

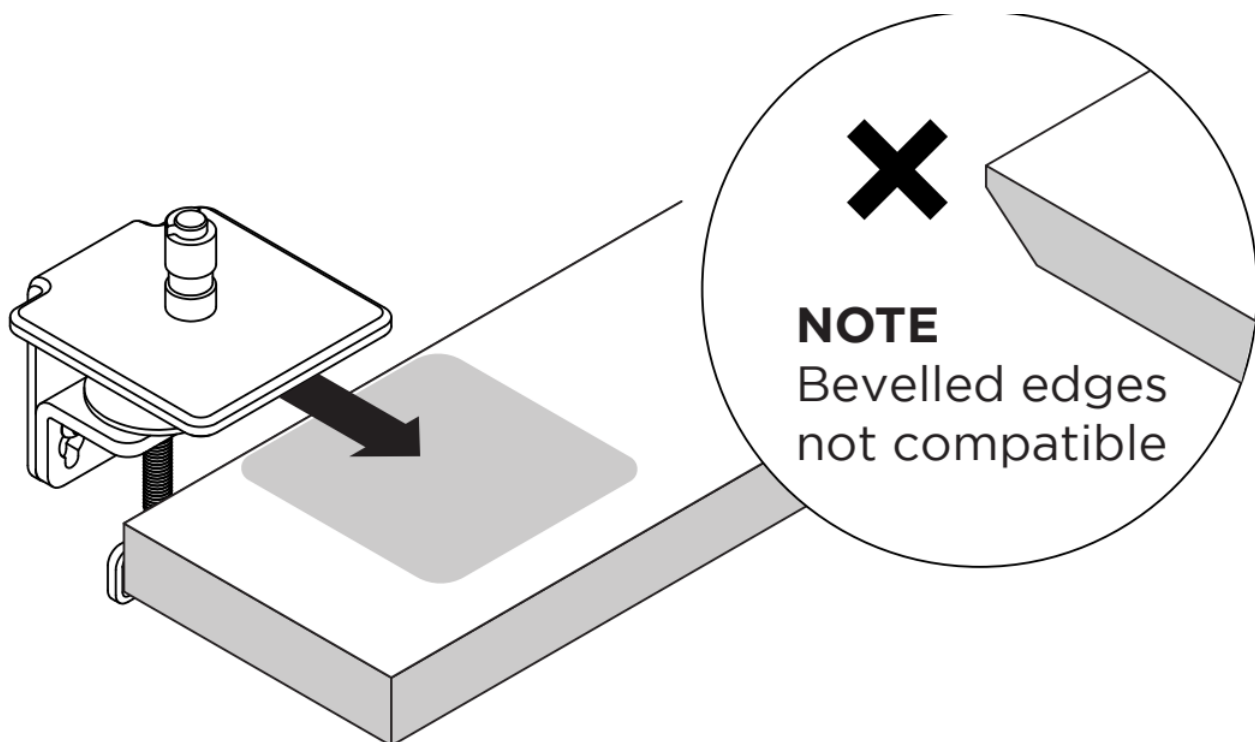

**TIP**

When positioning the desk clamp, offset the clamp to the left or right of the seating position. The monitor will then be centred for the user.

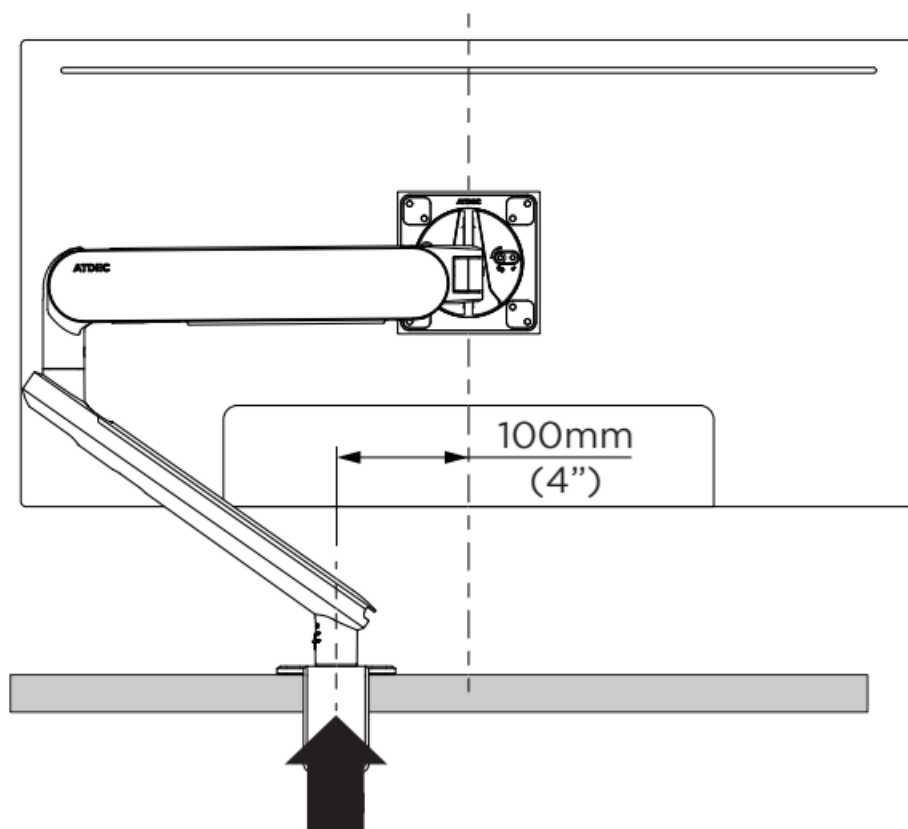

**IMPORTANT**

Ensure clamp is pushed up against work surface edge

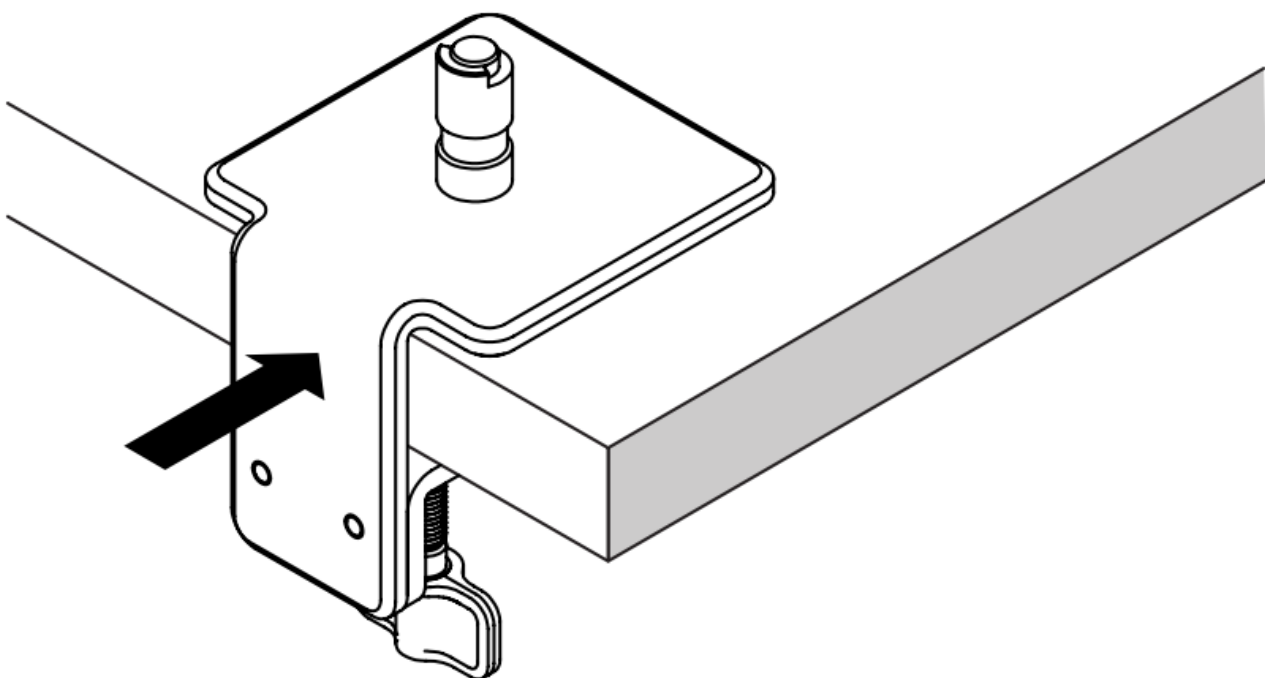

Tighten firmly by hand or using 4mm hex key

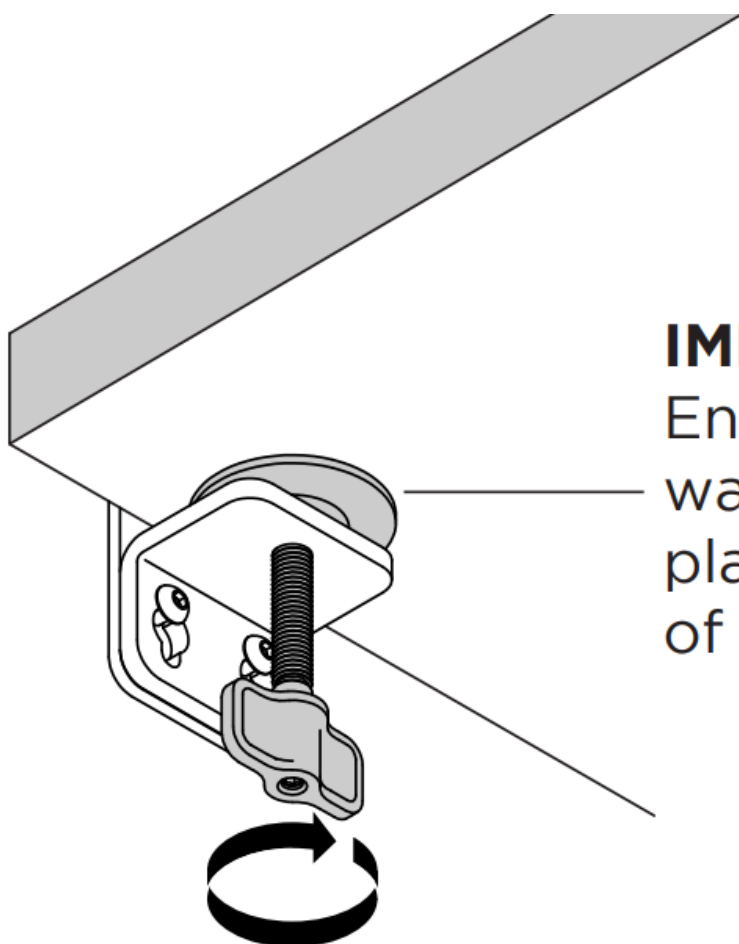

**IMPORTANT**  
Ensure metal  
washer is in  
place on the tip  
of the screw



## HINT!

If the gap behind the work surface is less than 70mm (2¾"), unhook the lower bracket and reattach it from under the desk.

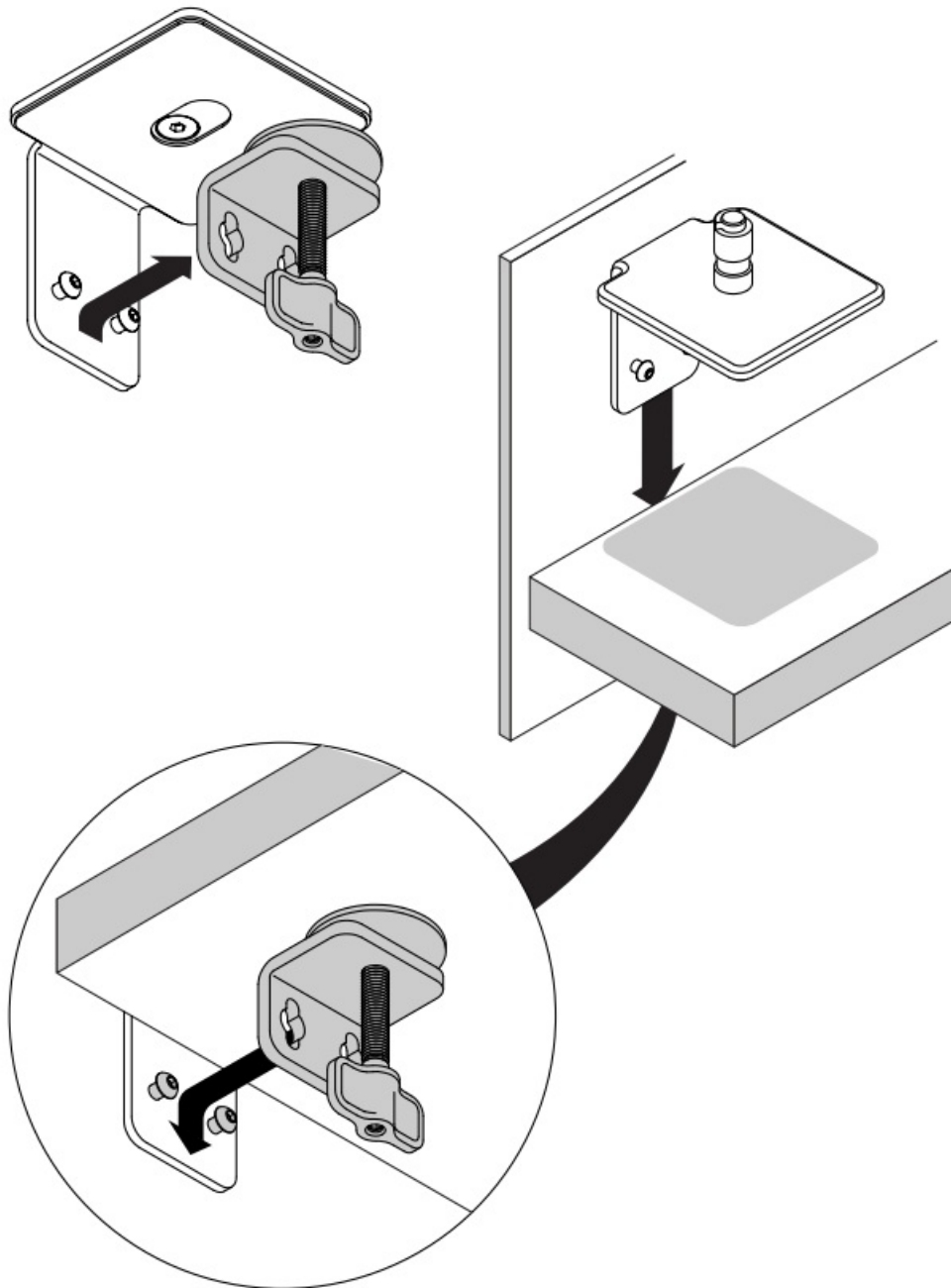

Hook on lower bracket and re-tighten 2x screws

## Attach Lower Link to Clamp

## 2.1

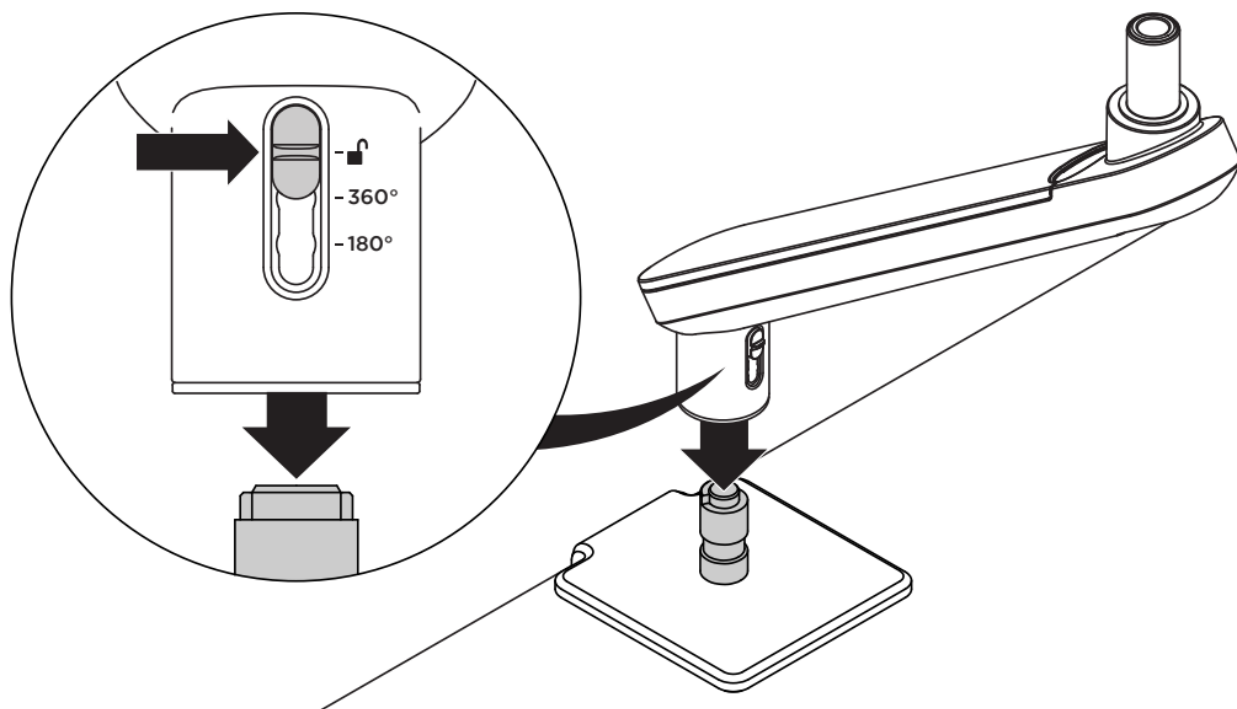

## 2.2

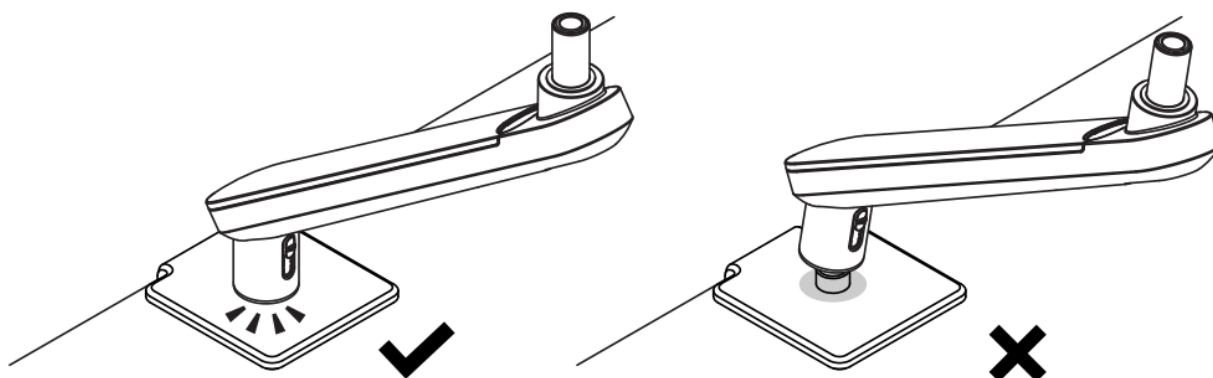

## 2.3

### Select rotation

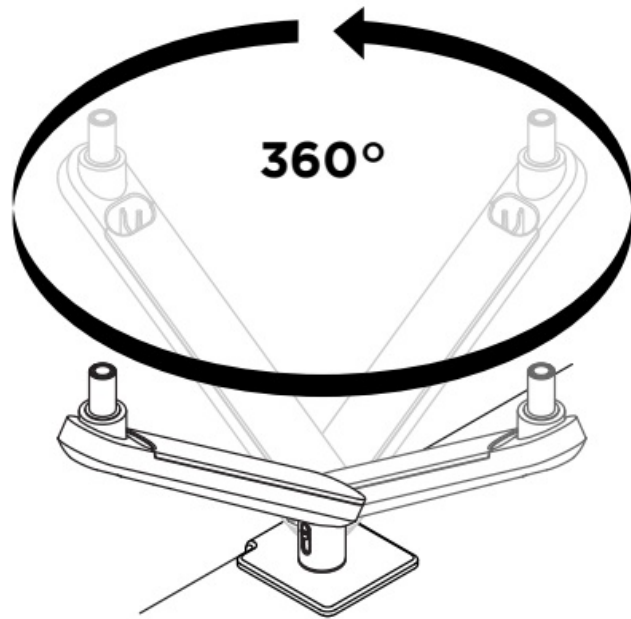
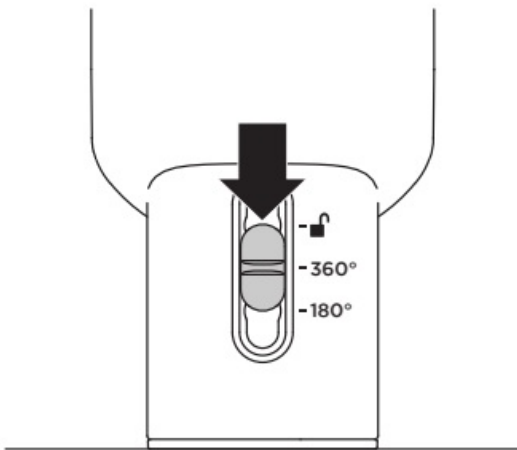

OR

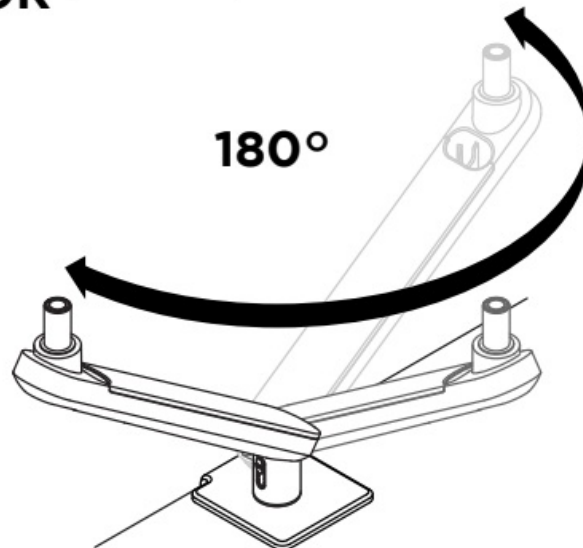
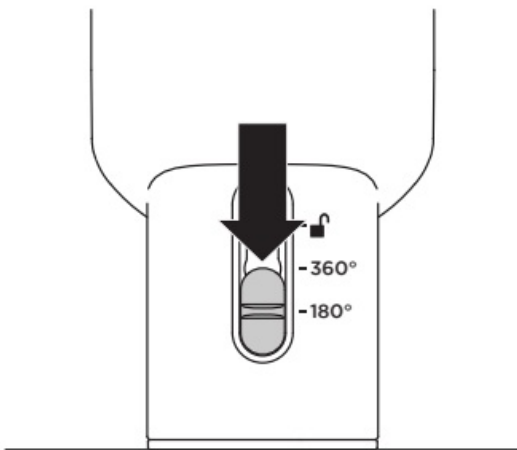

#### NOTE

Pivot lower link to the forward position shown in Step 2.2 before selecting 180° rotation.

#### Attach Upper Link

**IMPORTANT** Ensure plastic sleeve is fitted on lower link

### 3.1

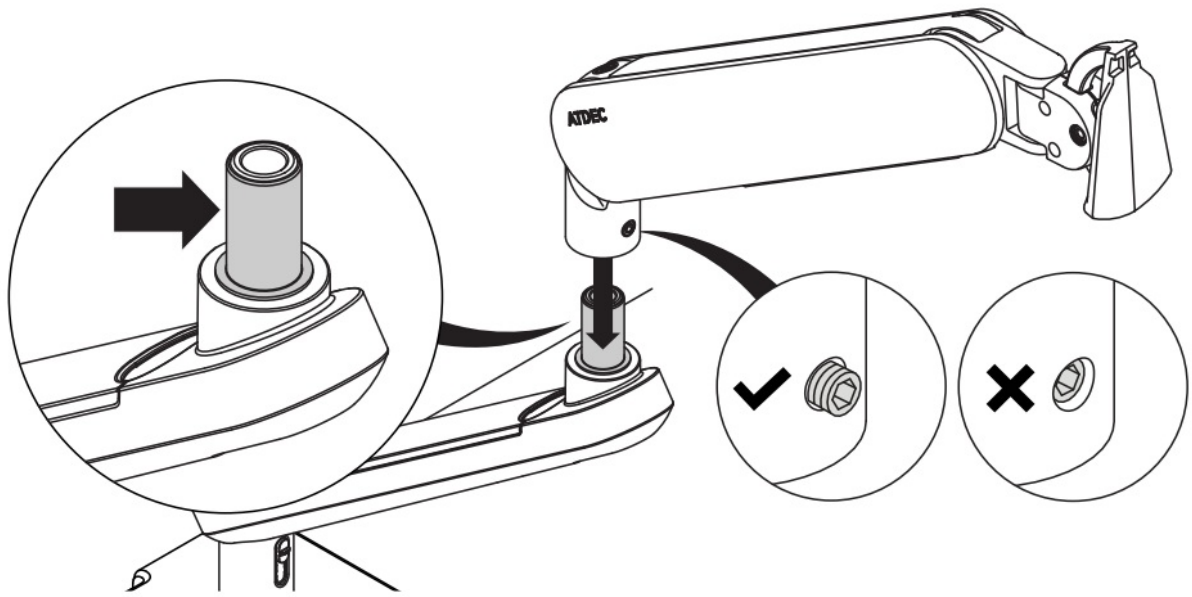

Press down firmly to ensure the upper link is fully located onto the lower link

### 3.2

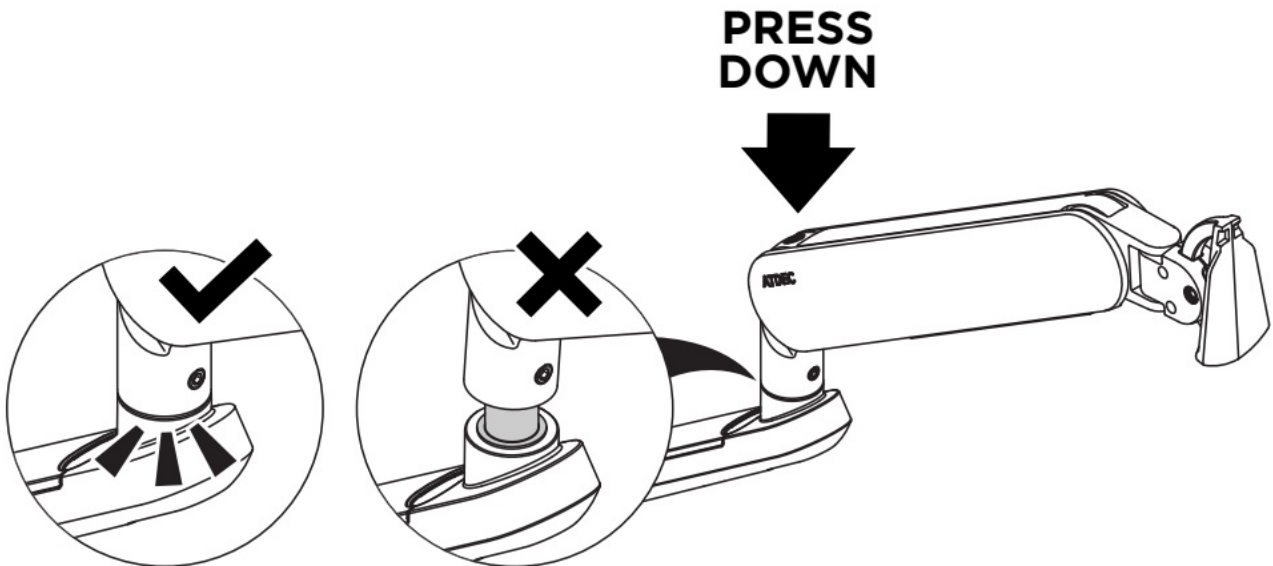

Using the 4mm hex key, tighten set screw until joint rotation is firm and smooth

### 3.3

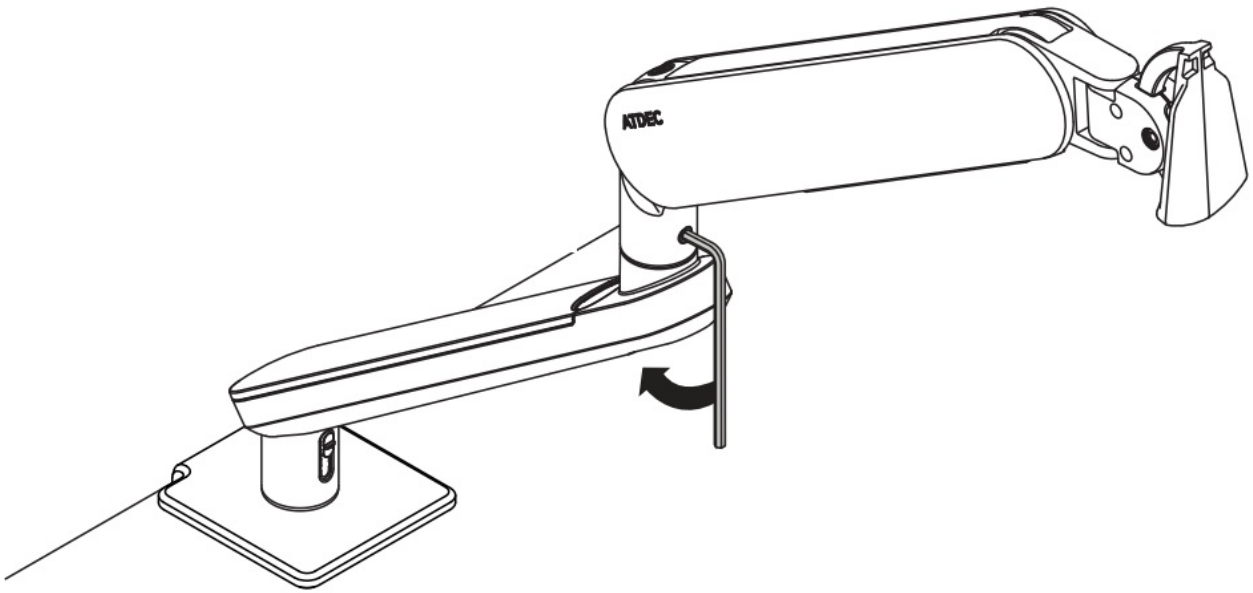

#### Check Cover Strip

To inspect cover strip, fully lower the upper link . If damaged or missing, stop installation and contact Atdec for assistance.

### 3.4

**CAUTION!**

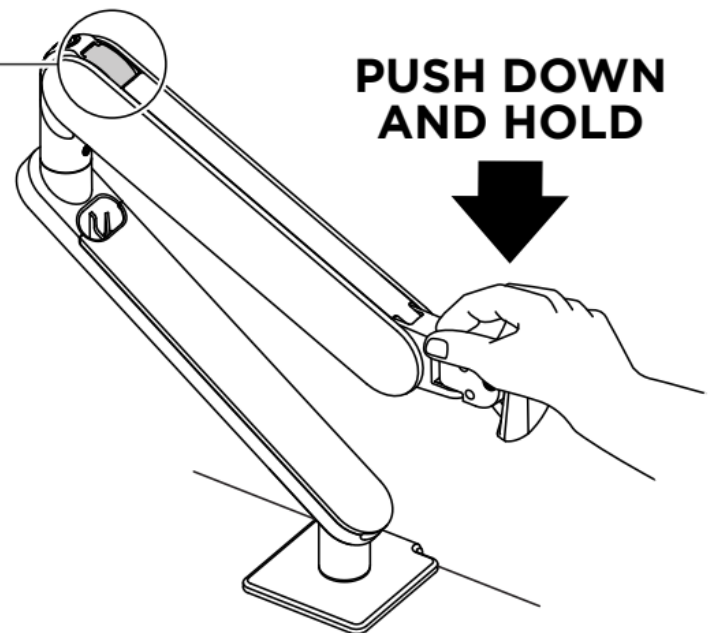

#### Mount Monitor

Check VESA mounting compatibility of monitor

## 4.1

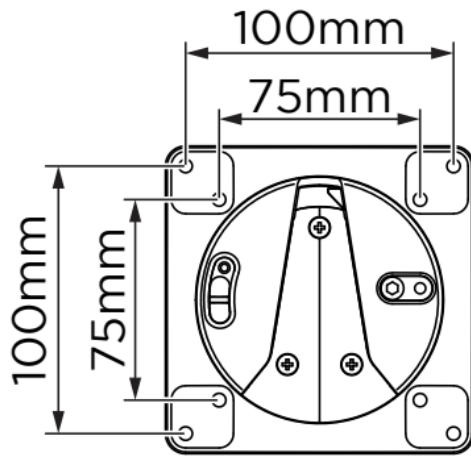

### NOTE

Recessed 75x75mm VESA interfaces will require a spacer kit (sold separately)

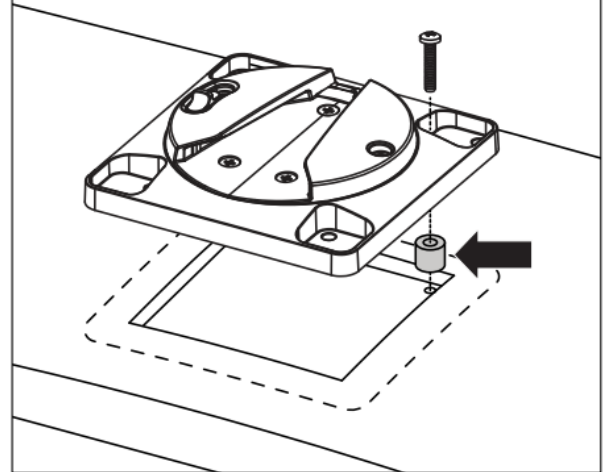

Attach VESA Plate using supplied M4x10 screws.

## 4.2

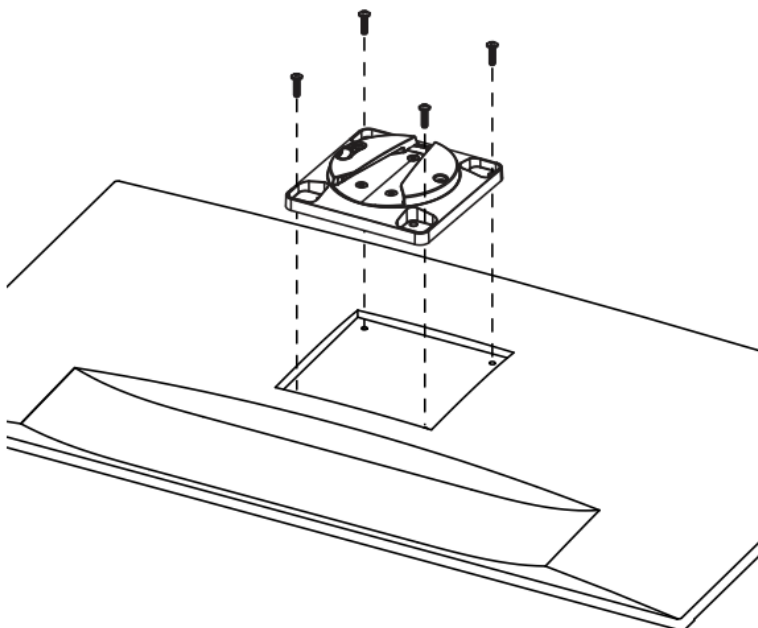

Ensure screw length suits the monitor

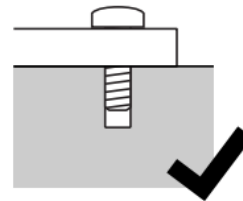

OK

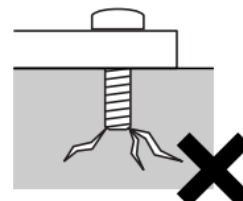

TOO LONG

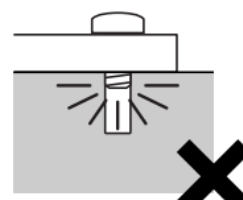

TOO SHORT

## 4.3

---

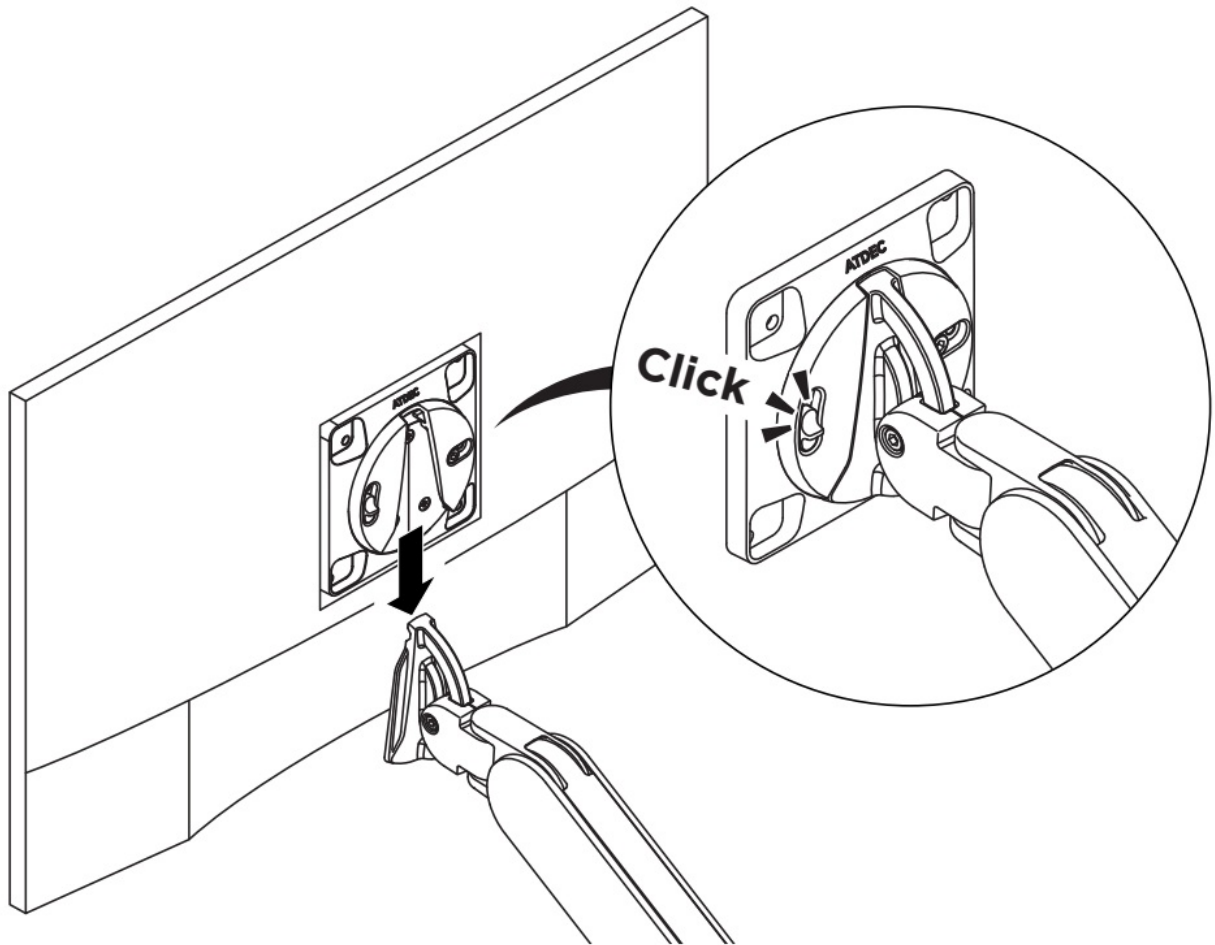

### Adjustments

#### Tilt Tension

If required, adjust tilt tension using 4mm hex key. (do not over-tighten)

**NOTE** Support the screen while adjusting

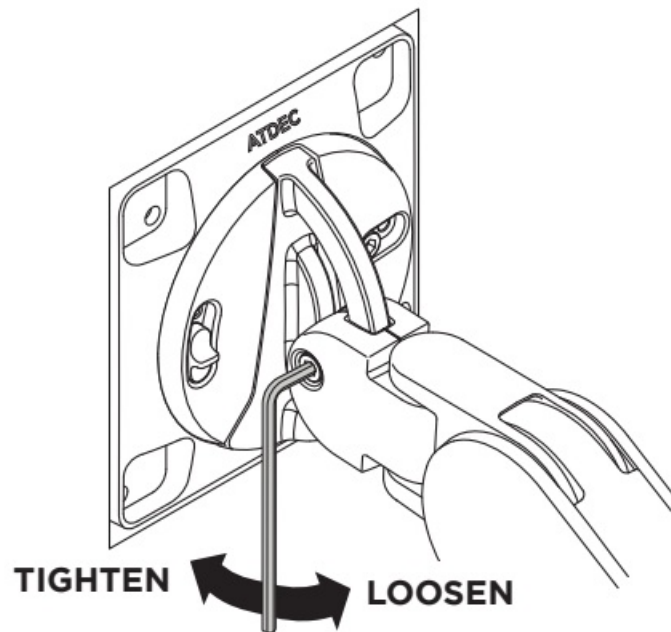

**DROOPS FORWARD**



**HOLDS POSITION**

**Monitor Rotation Tension (optional)**

Adjust rotation tension using 4mm hex key.

**NOTE**

Adjustment may only be required for ultrawide monitors



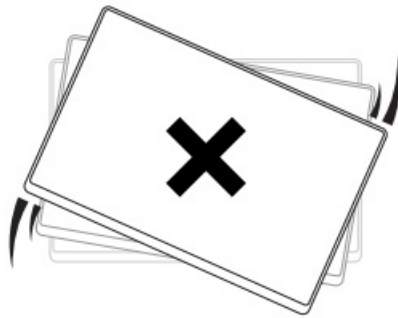
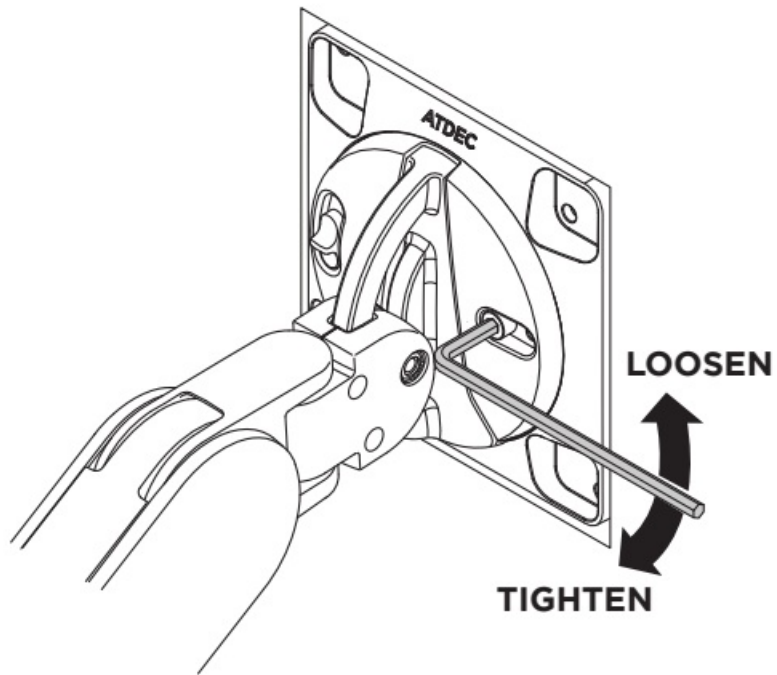

**DRIFTS**



**HOLDS POSITION**

### **Counterbalance Adjustment**

Using the 4mm hex key, adjust counterbalance to suit the monitor weight

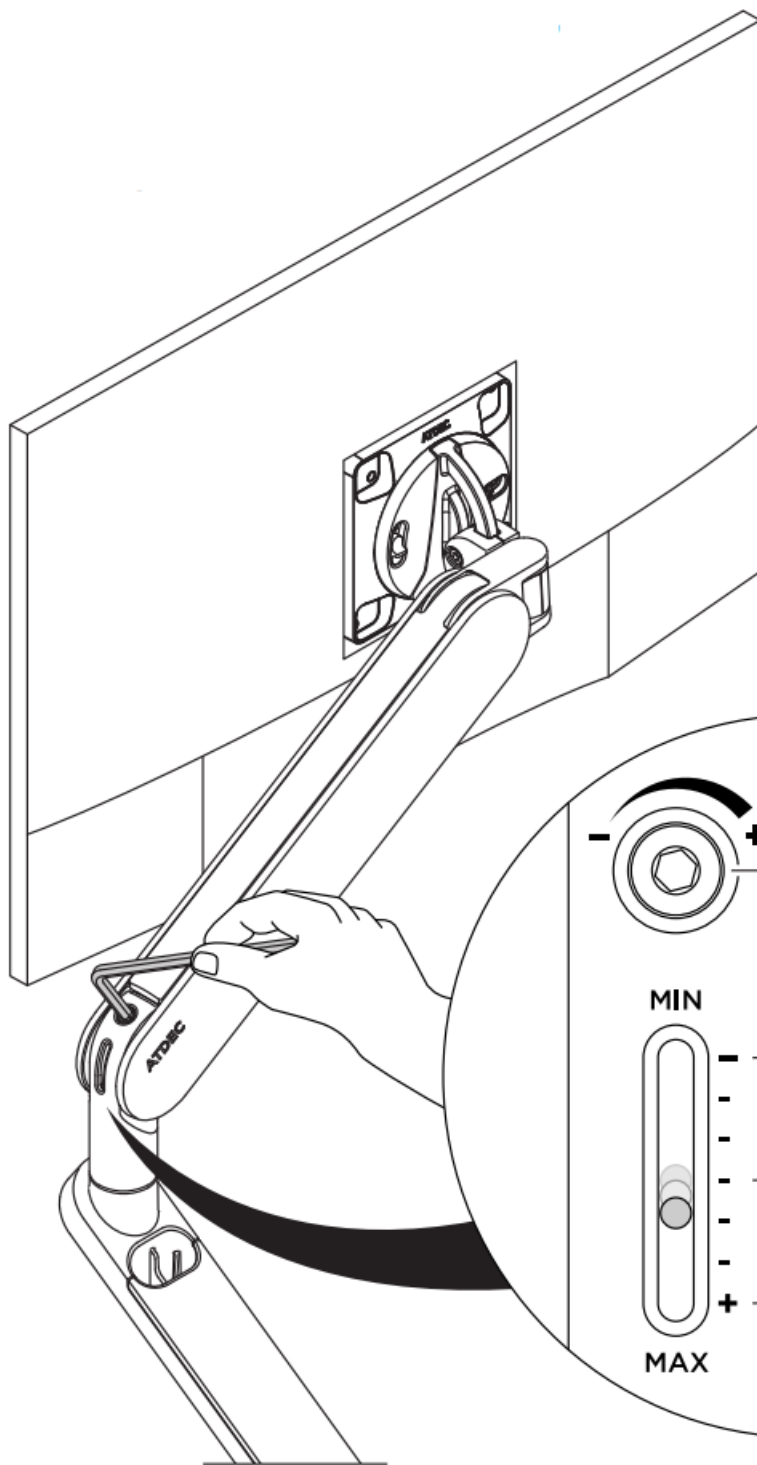

## TIP

For best results, adjust counterbalance with the arm and monitor in the position shown. Adjustment is easiest when the monitor is in the highest position.



**COUNTER-BALANCE  
ADJUSTMENT  
SCREW**

MIN

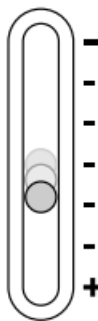

Lighter  
Monitors

**COUNTER-BALANCE  
ADJUSTMENT  
GAUGE**

Heavier  
Monitors

MAX

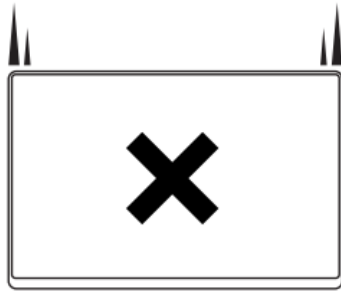

**DROOPS**

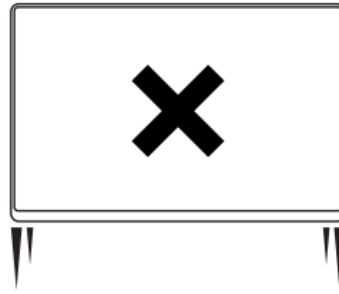

**BOUNCES UP**

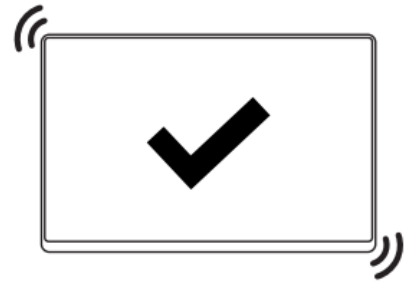

**HOLDS  
POSITION**

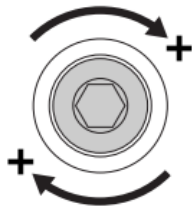

**Increase  
tension**

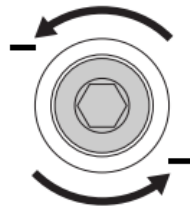

**Reduce  
tension**

**TIP**

When installing multiple arms with the same monitor, use the setting on the counterbalance adjustment gauge to quickly 'pre-set' other arms (fine-tuning may be required after pre-setting)

**Security Screw (optional)**

If desired, once monitor is attached to the arm, install the security screw. This disables the release switch, preventing theft.

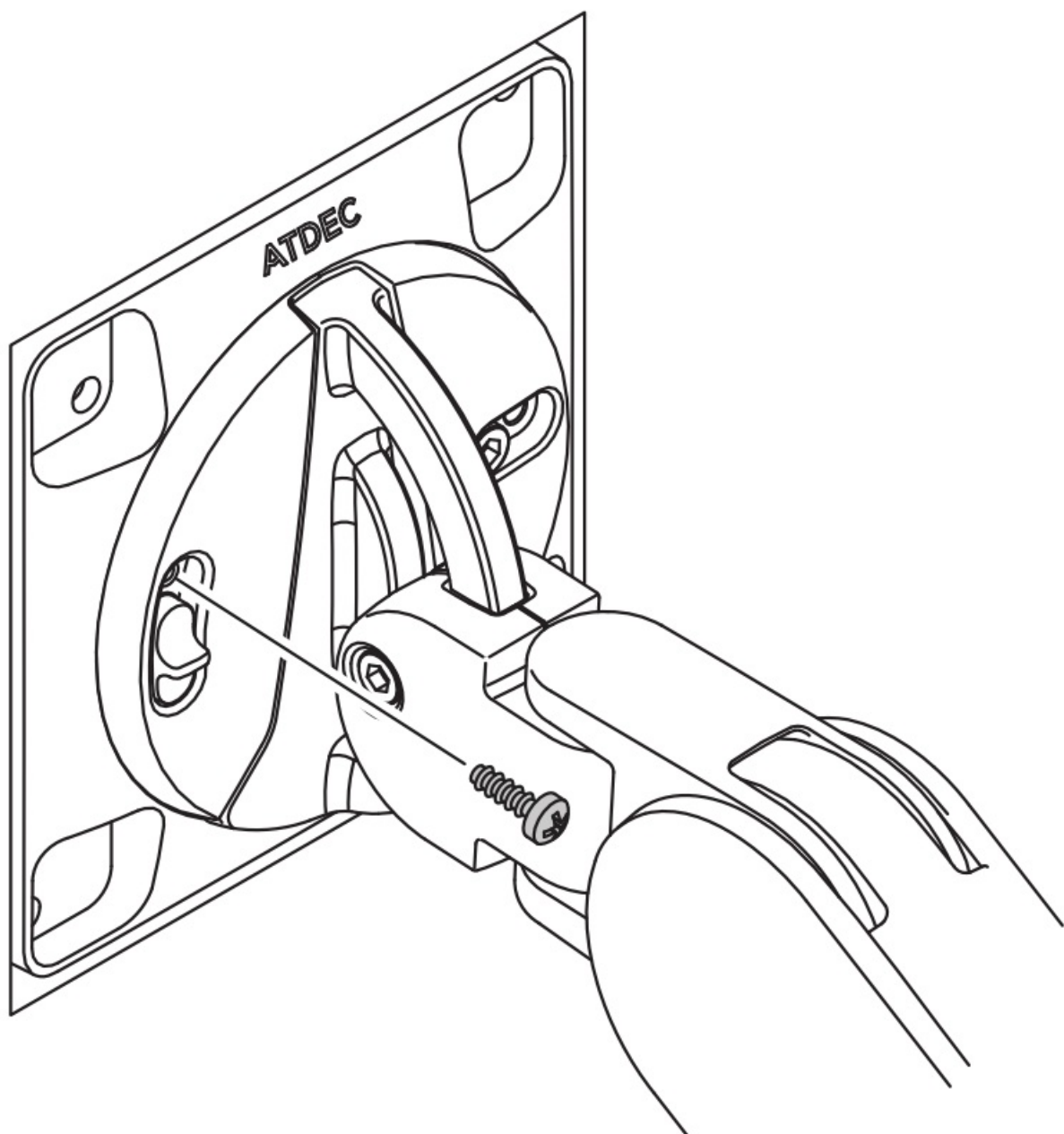

**Removing Monitor**

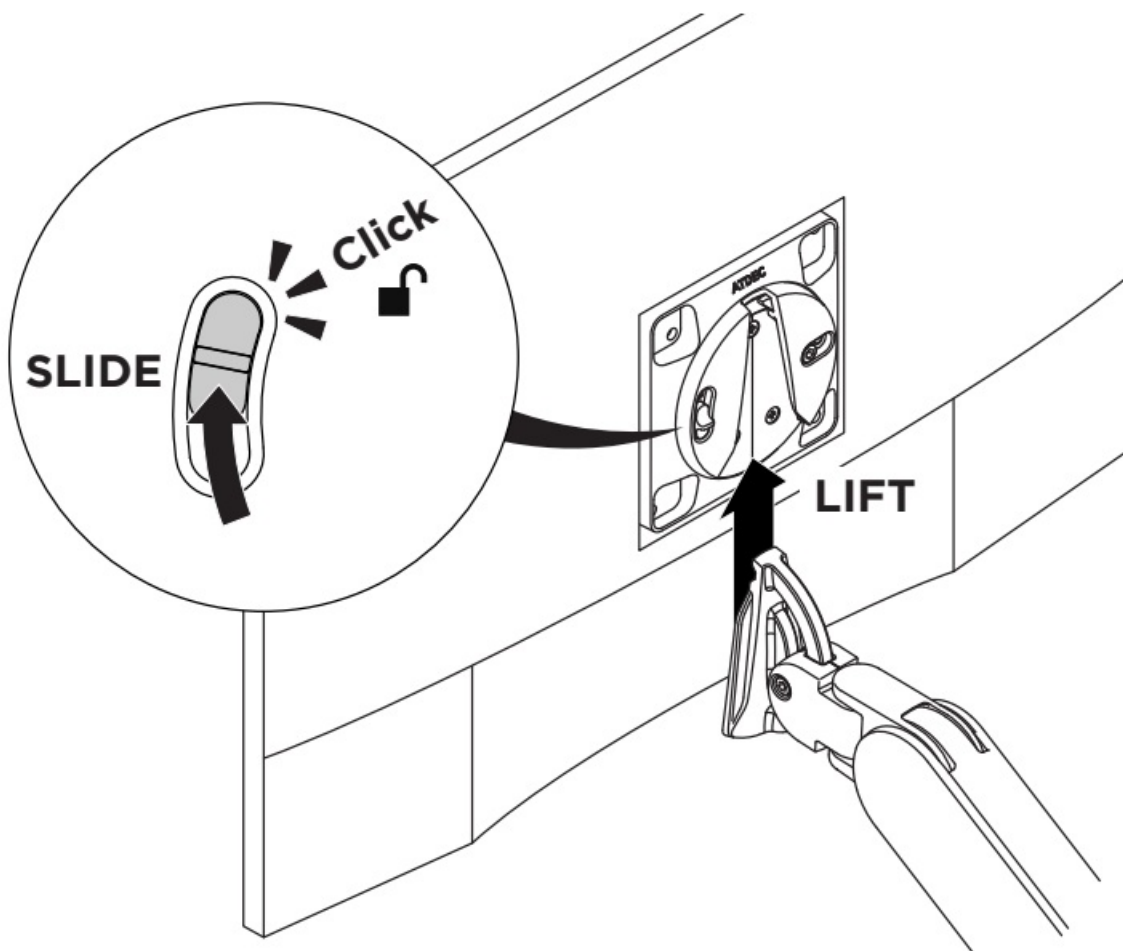

### **Positioning**

Do not position monitor beyond the rear edge of the desk.

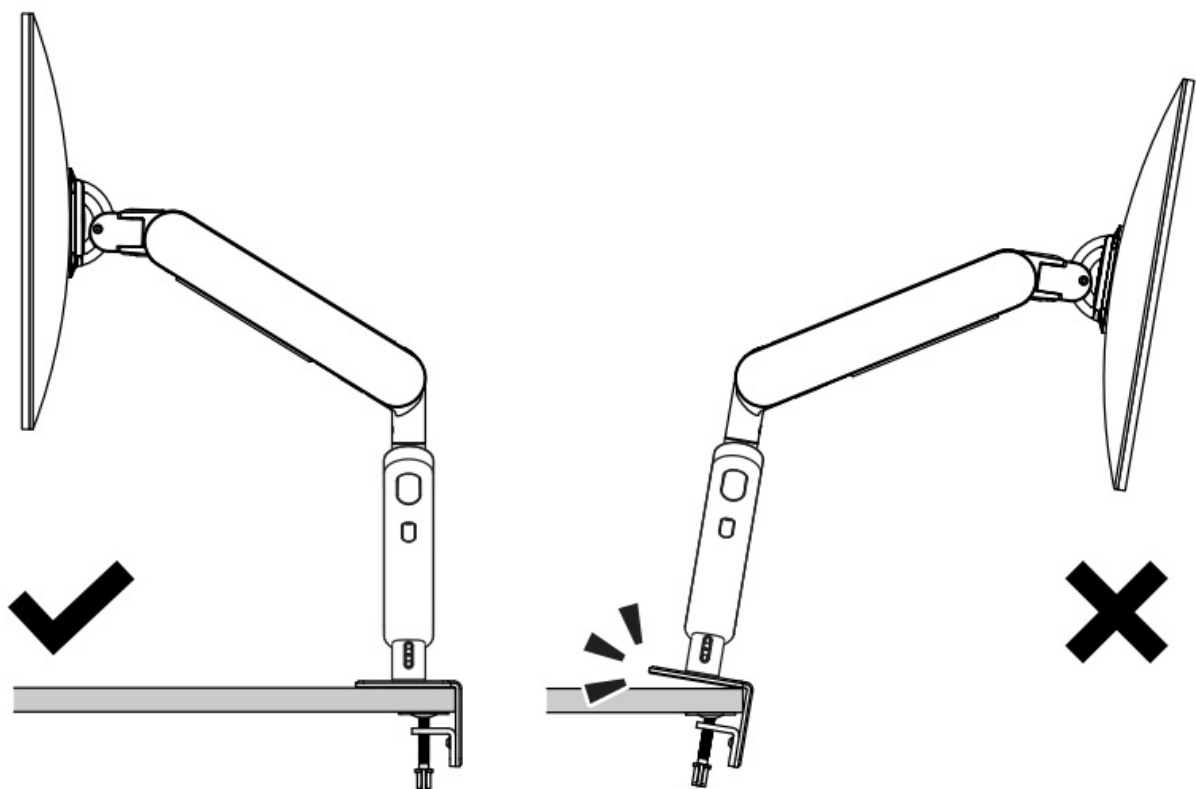

## Cable Management

### Overview

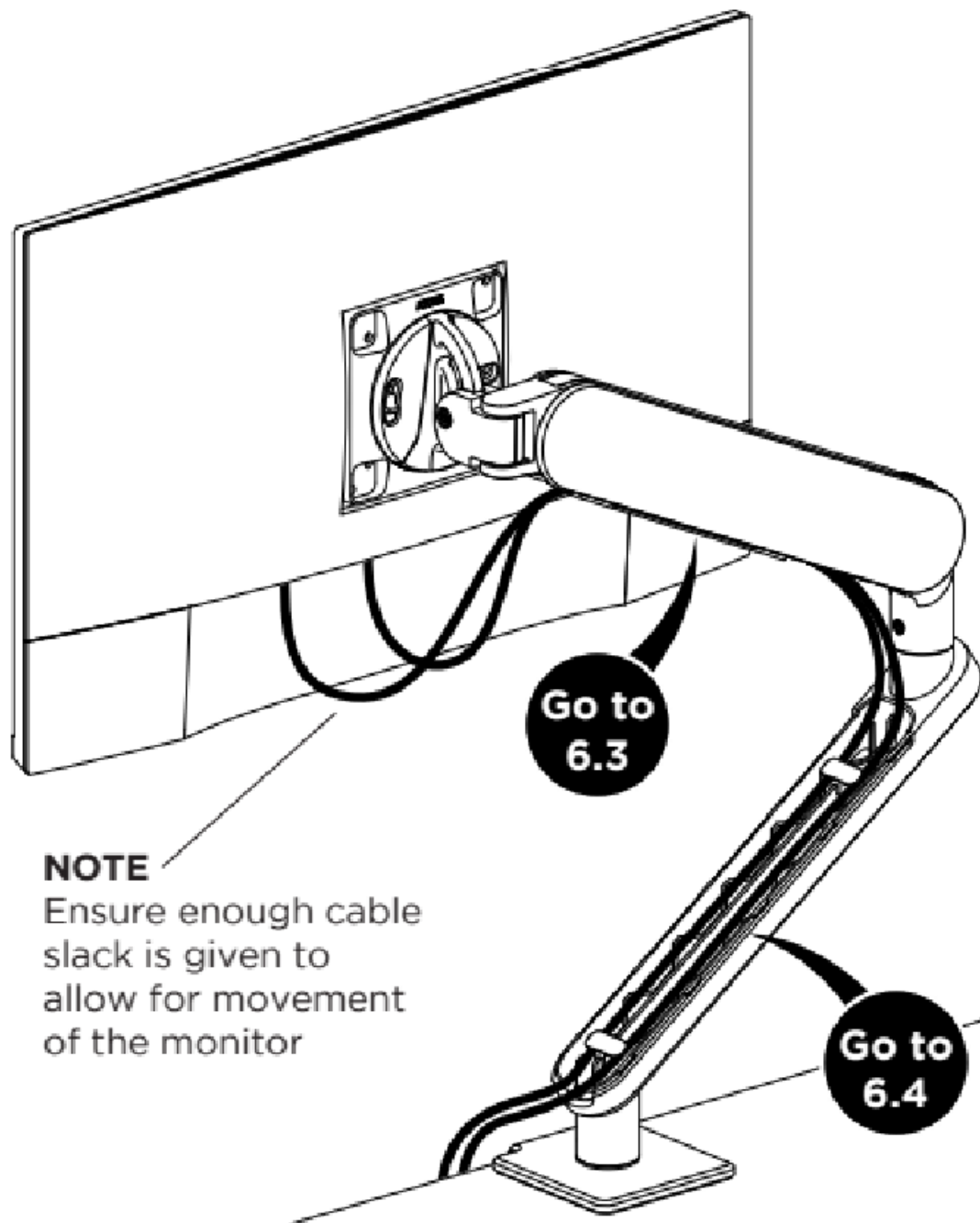

#### **NOTE**

Allow 1.2m of cable from the work surface to the monitor. Add additional cable length to route the cable from the work surface to the computer.

If desired, store hex key in lower link

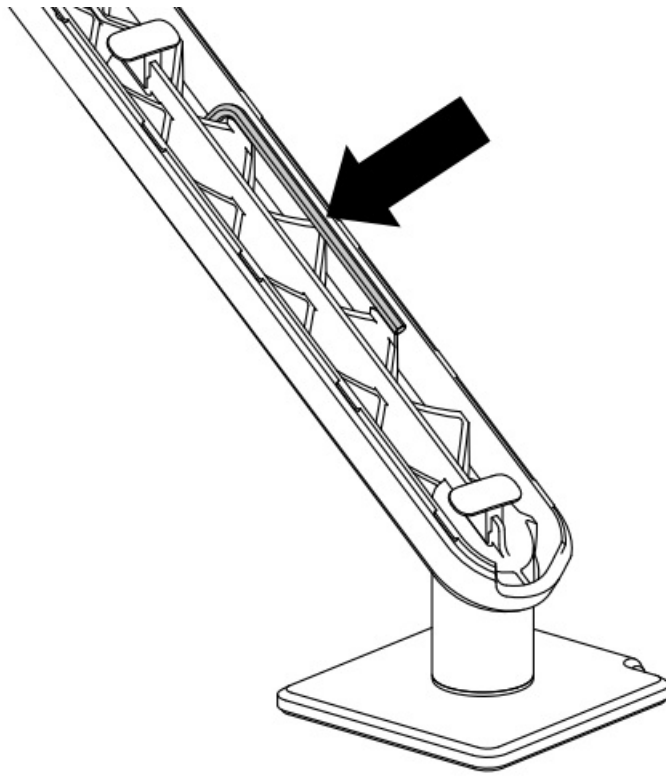

**Route Cables Through Upper Link**

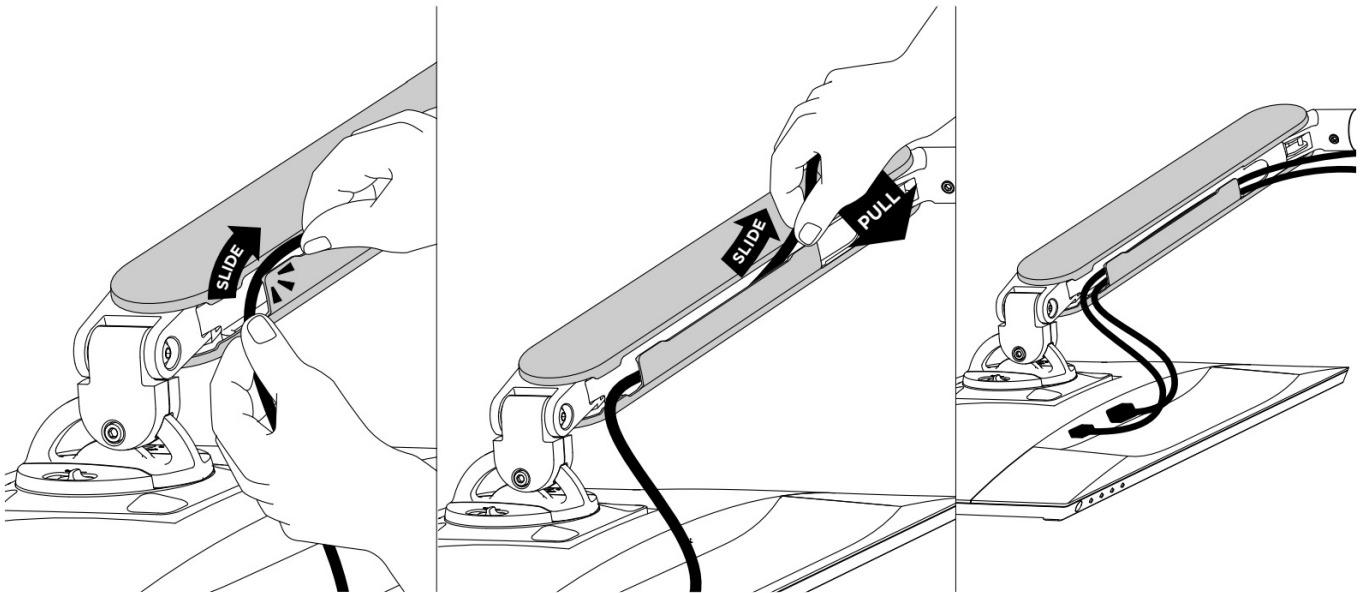

**Remove lower link cable cover.**

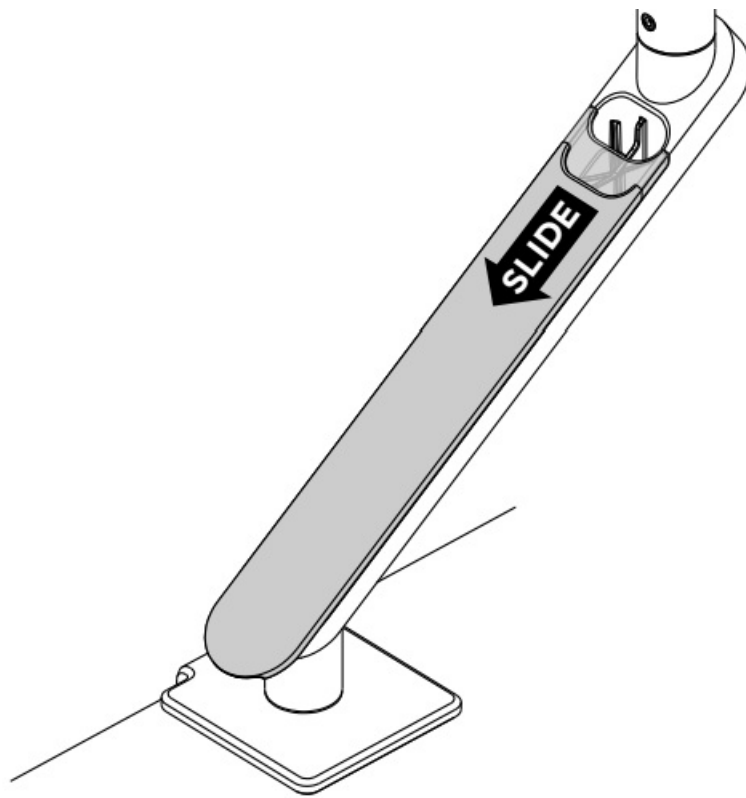

**Tuck cables behind tabs inside lower link.**

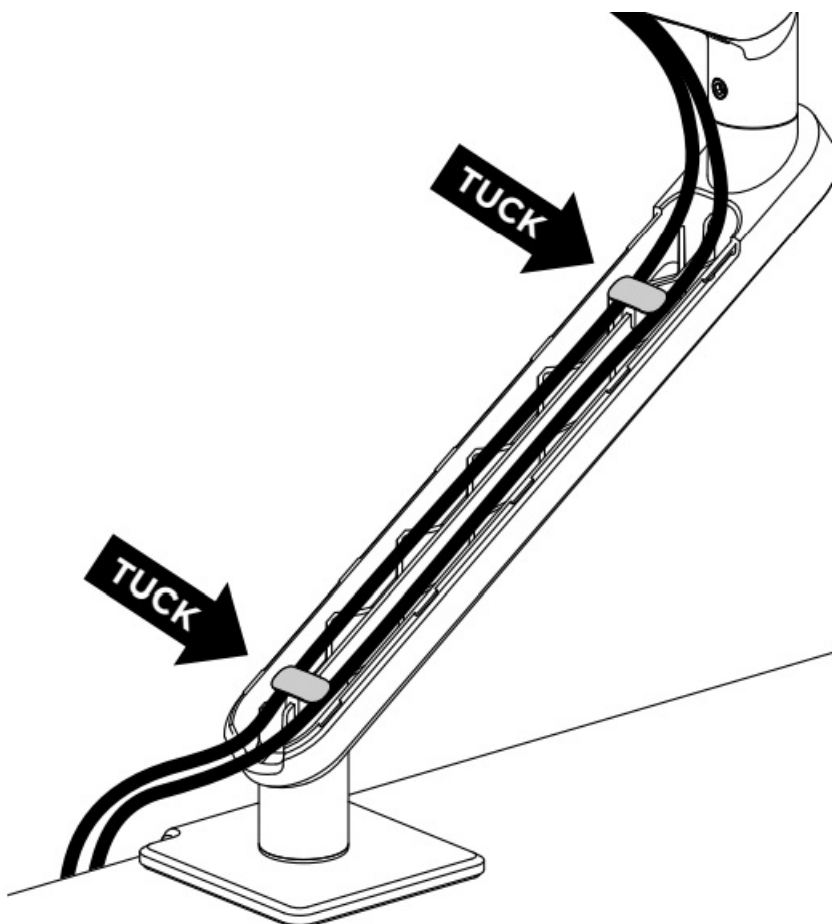

**Re-attach lower link cable cover.**

**NOTE**

Ensure cables do not interfere with sliding cover on.



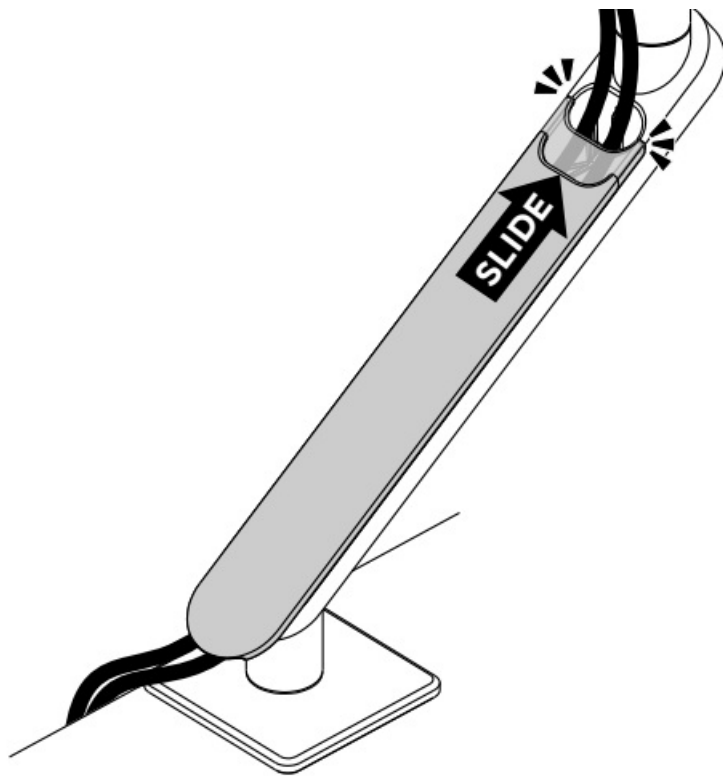

# ATDEC

---

## Documents / Resources

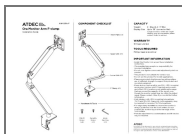

[ATDEC AW-ORA-F Ora Mounting Arm for Monitor](#) [pdf] Installation Guide  
AW-ORA-F-S, AW-ORA-F, AW-ORA-F Ora Mounting Arm for Monitor, AW-ORA-F, Ora Mountin  
g Arm for Monitor, Mounting Arm for Monitor, Arm for Monitor, Monitor

## References

- [User Manual](#)