



ATAG BCD75102AD Built In Fridge Instruction Manual

[Home](#) » [ATAG](#) » ATAG BCD75102AD Built In Fridge Instruction Manual 

Contents

- [1 ATAG BCD75102AD Built In Fridge](#)
- [2 Product Usage Instructions](#)
- [3 DIMENSION](#)
- [4 PARTS](#)
- [5 MOUNTING INSTRUCTIONS](#)
- [6 INSTRUCTION](#)
- [7 ASSEMBLY](#)
- [8 Documents / Resources](#)

ATAG

ATAG BCD75102AD Built In Fridge



Product Information:

The product is a mounting kit that includes various components for installation. It is available in different languages: English (EN), German (DE), French (FR), and Dutch (NL).

The kit includes components labeled with different symbols and letters, such as PP, L, \$, %, &, [, ' , (,), PLQFP, PLQ, *, +, ,, -, ., /, 8, 0, 1, 2, 3, 4, 5, 6, 7, 9, aPP, D, E.

Product Usage Instructions

1. Begin by identifying the components labeled with the symbols PP, L, \$, %, &, [, ' , (,), PLQFP, PLQ, *, +, ,, -, ., /, 8, 0, 1, 2, 3, 4, 5, 6, 7, 9, aPP, D, E.
2. Follow the mounting instructions provided in the user manual for proper installation.
3. Ensure that all components are securely attached using the provided instructions.
4. Pay attention to any specific instructions regarding the placement of components labeled with symbols such as \$ and %.
5. Take note of any additional symbols or letters mentioned in the user manual for specific steps.
6. If any components are labeled with symbols like *, +, ,, -, ., /, 8, 0, 1, 2, 3, 4, 5, 6, 7, 9, aPP, D, E, refer to the

user manual for their corresponding usage instructions.

7. Make sure to follow the recommended guidelines and safety precautions mentioned in the user manual.
8. If you encounter any difficulties during installation, refer to the troubleshooting section of the user manual or contact customer support.

Please note that the provided information is based on the text extract from the user manual. For more comprehensive and accurate instructions, refer to the complete user manual included with the product.

DIMENSION

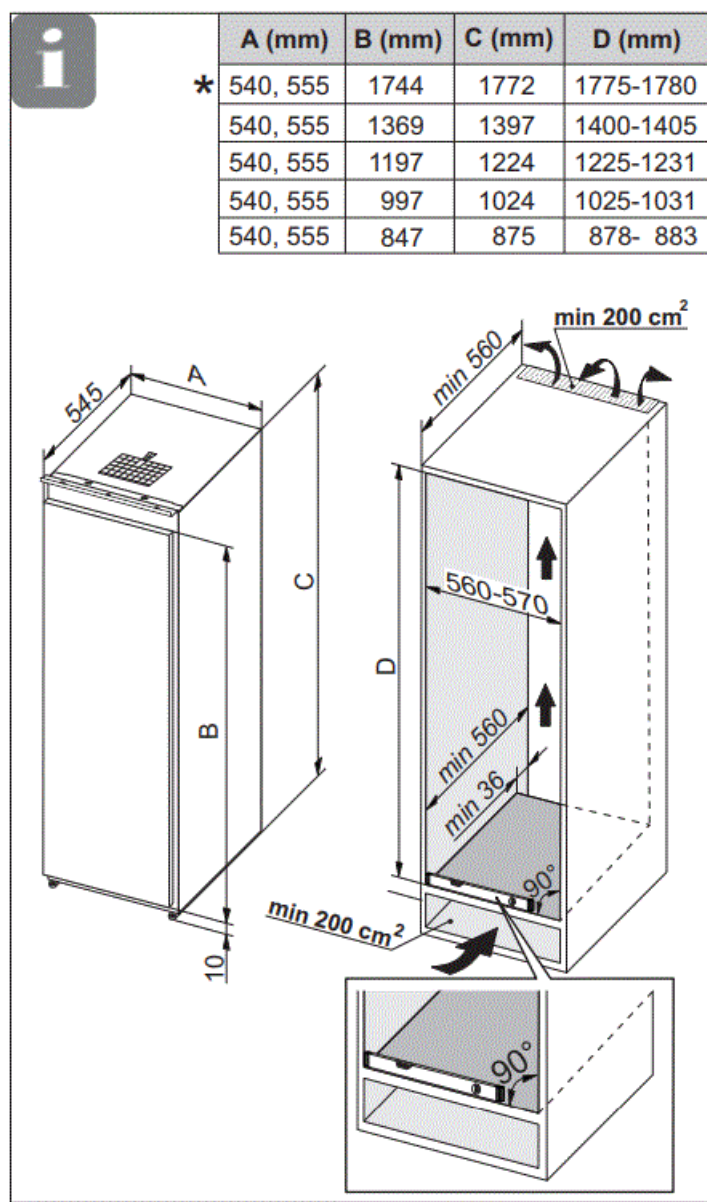

PARTS

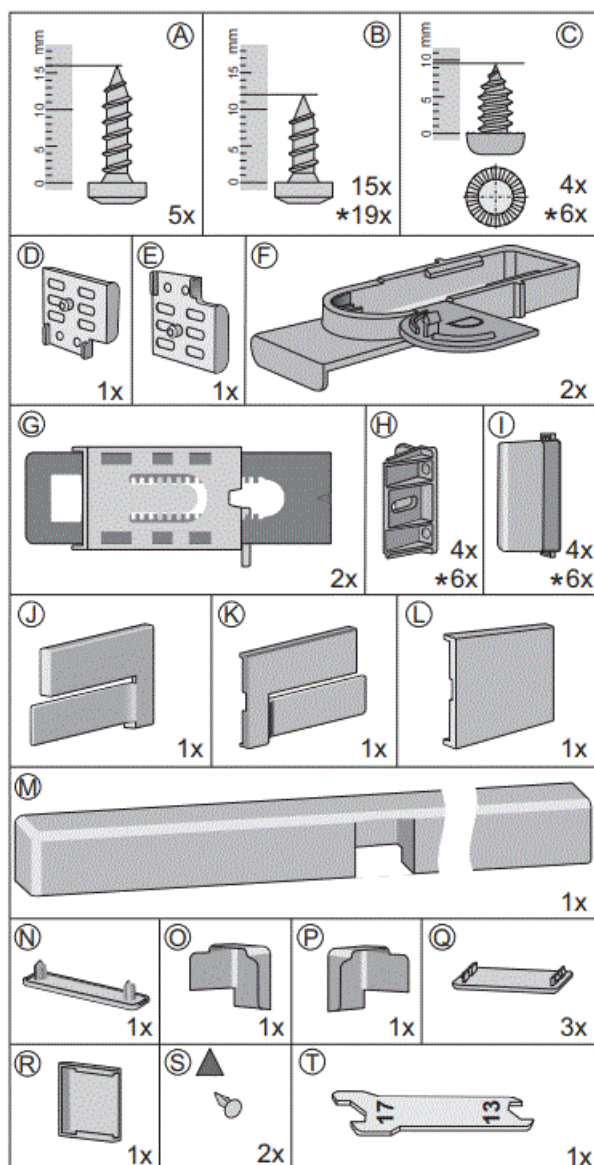
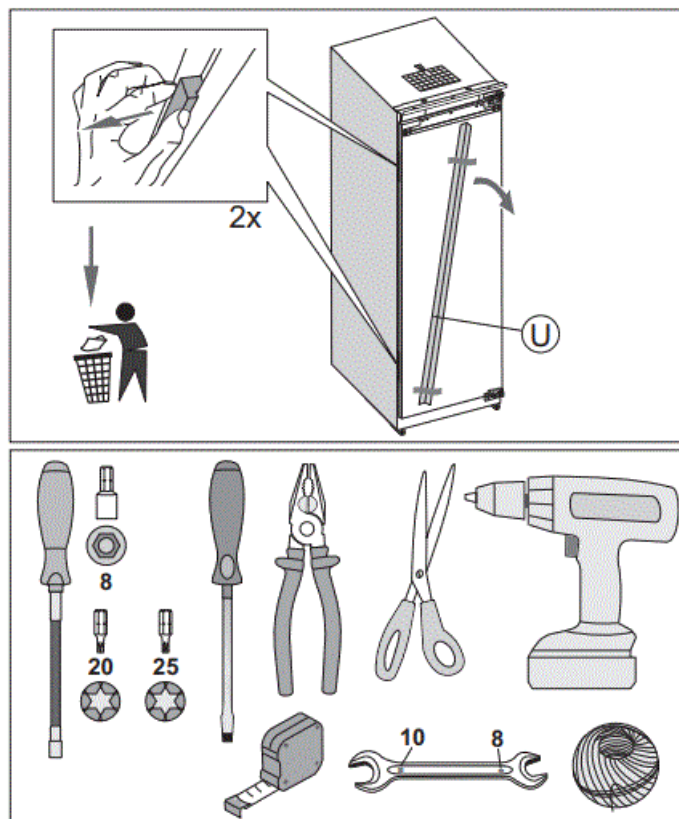

MOUNTING INSTRUCTIONS

(certain models only)

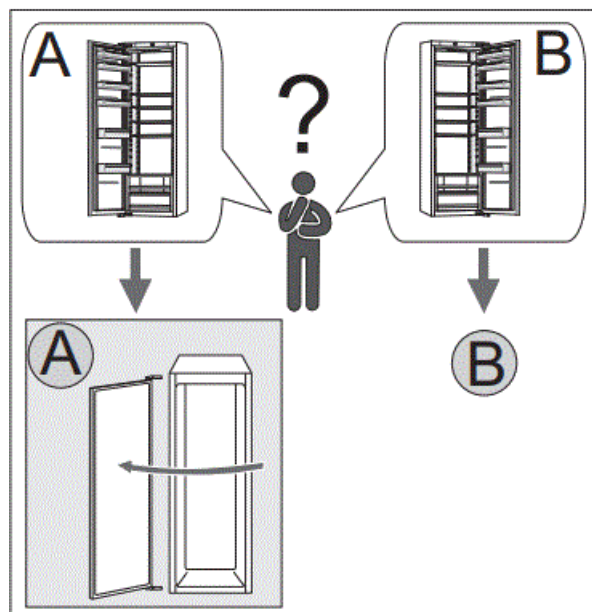
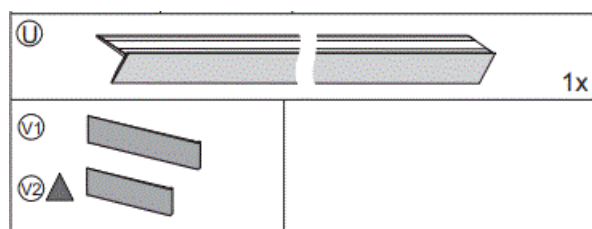

A

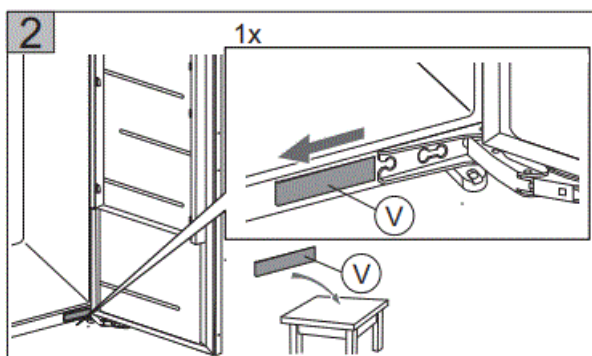
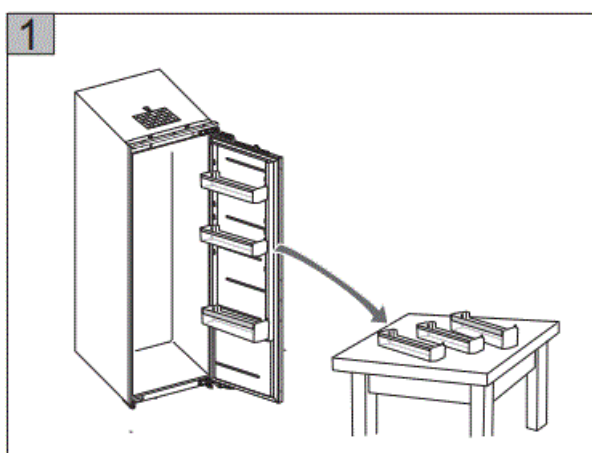

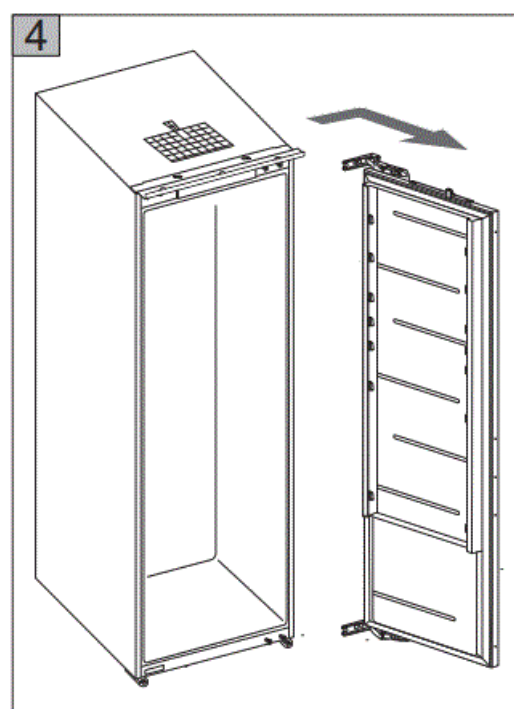
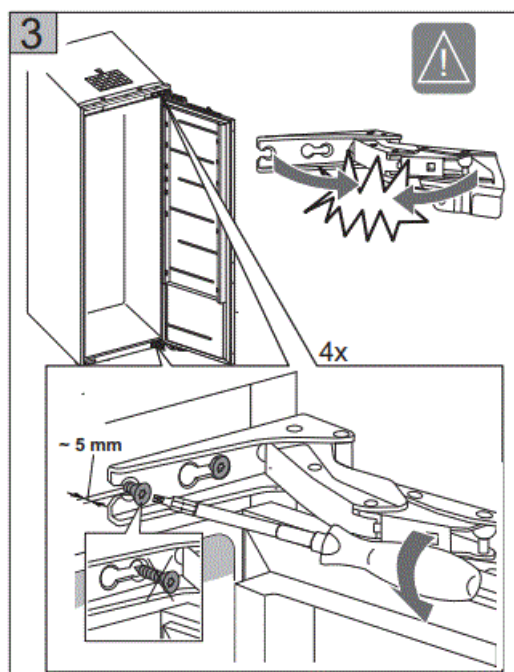

INSTRUCTION

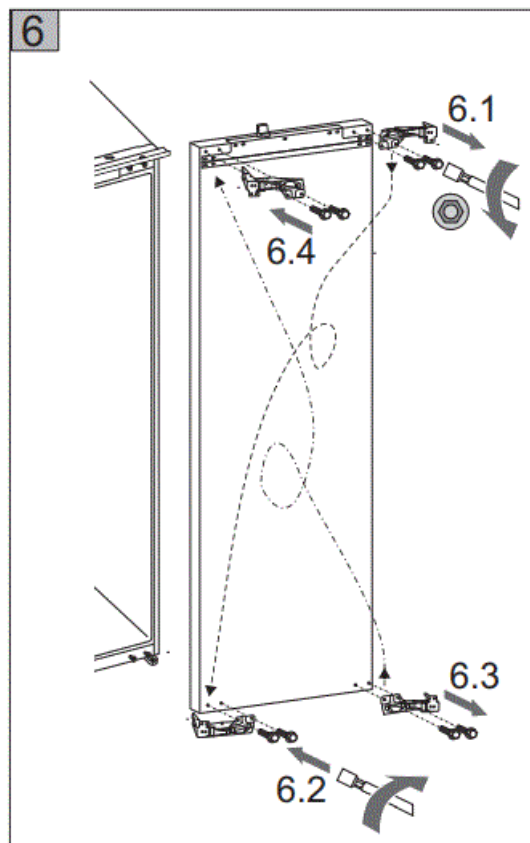
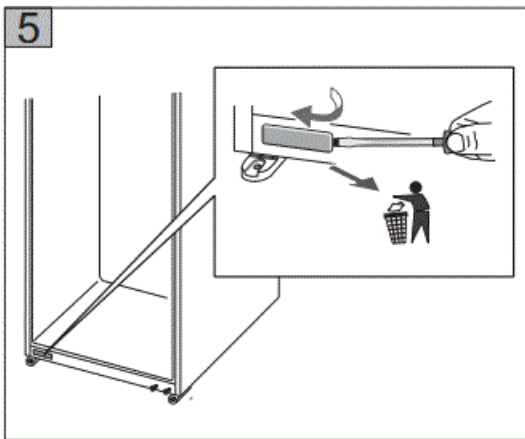

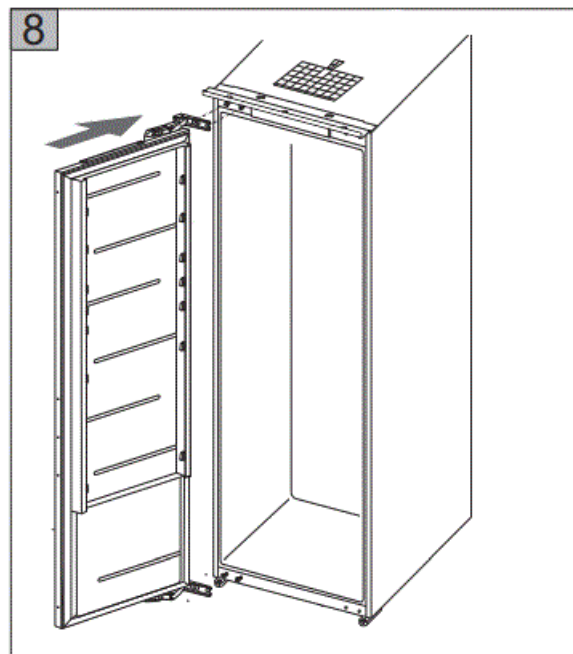
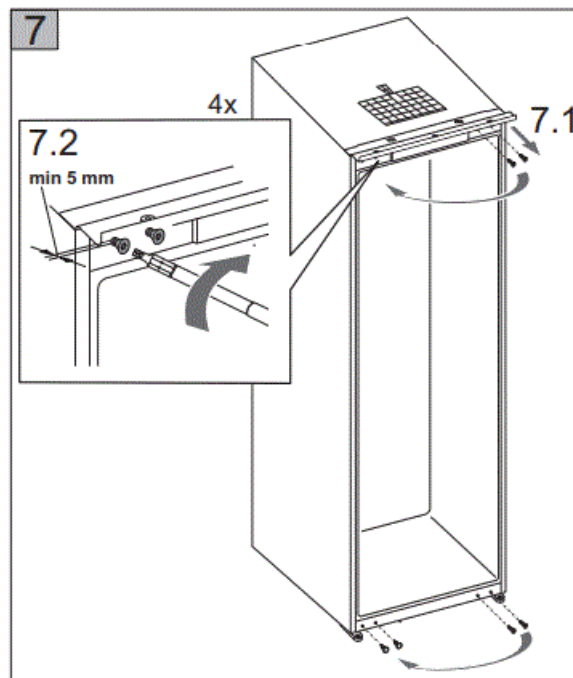

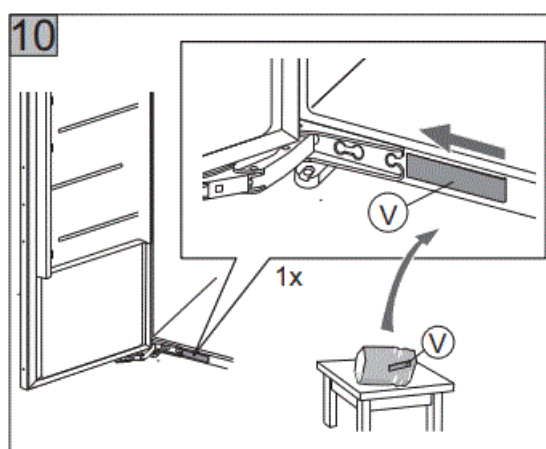
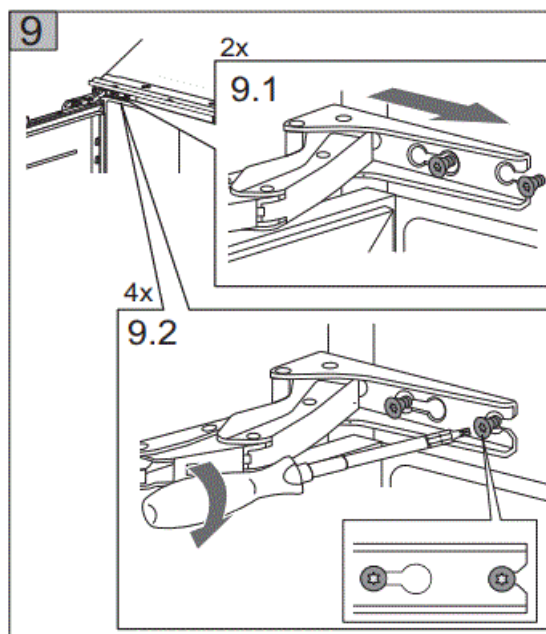

B

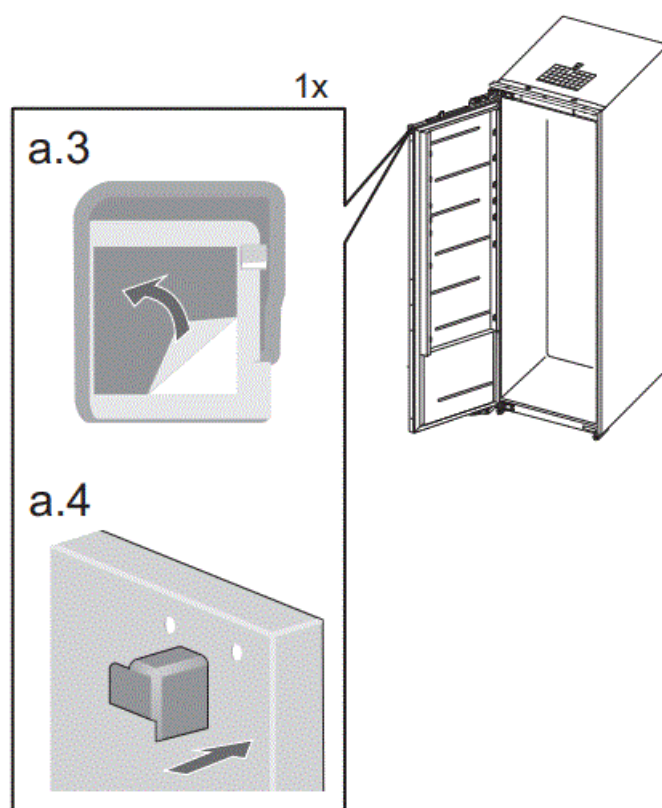
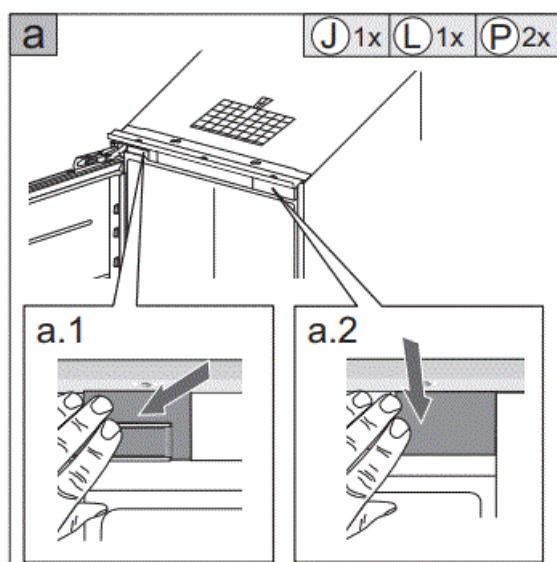
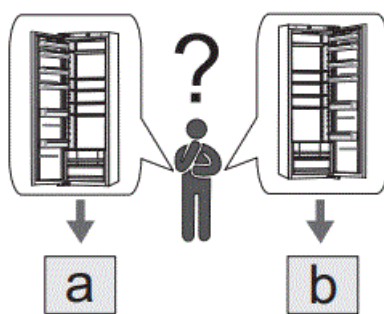

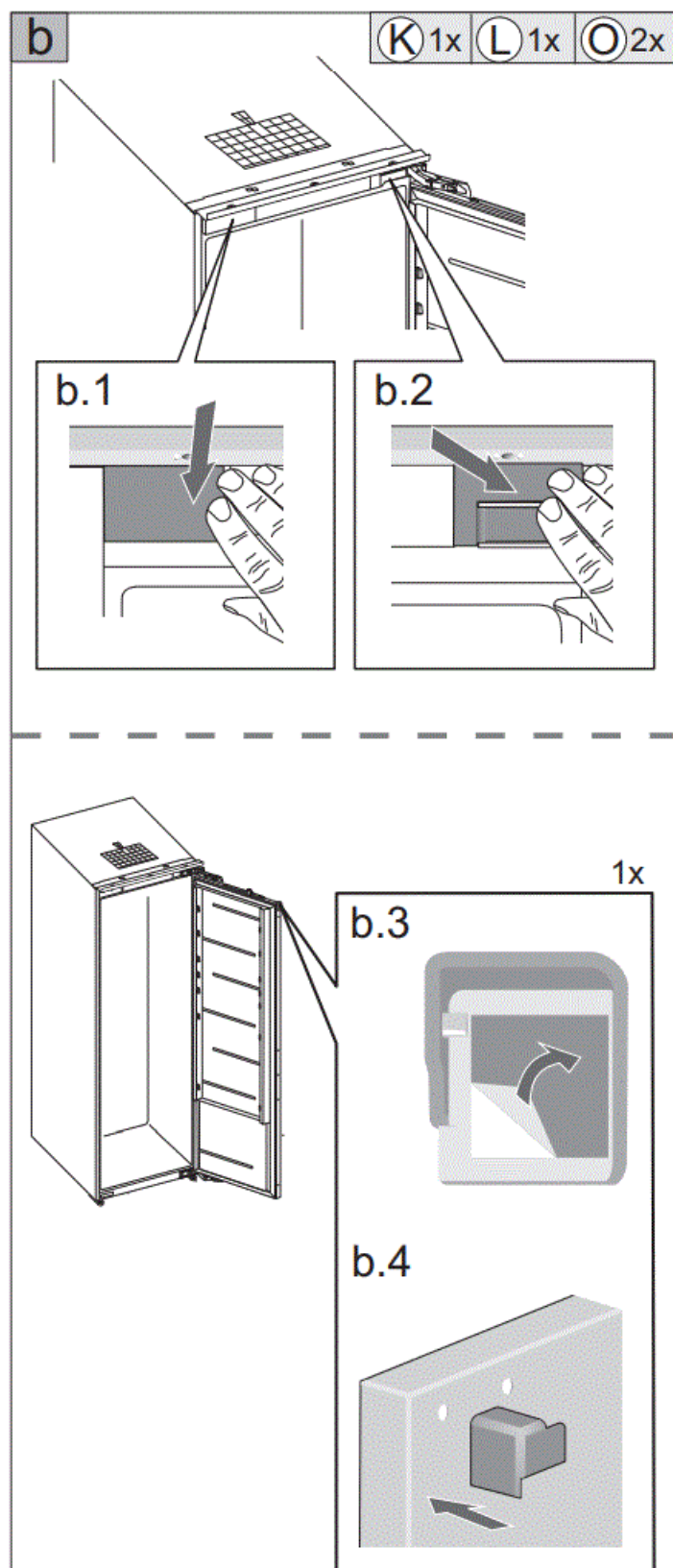

ASSEMBLY

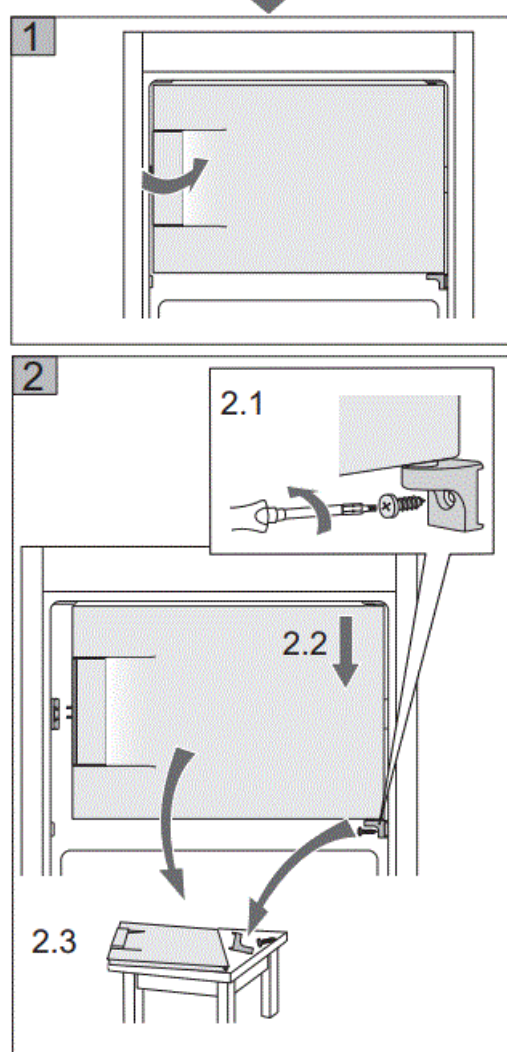
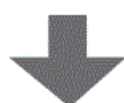
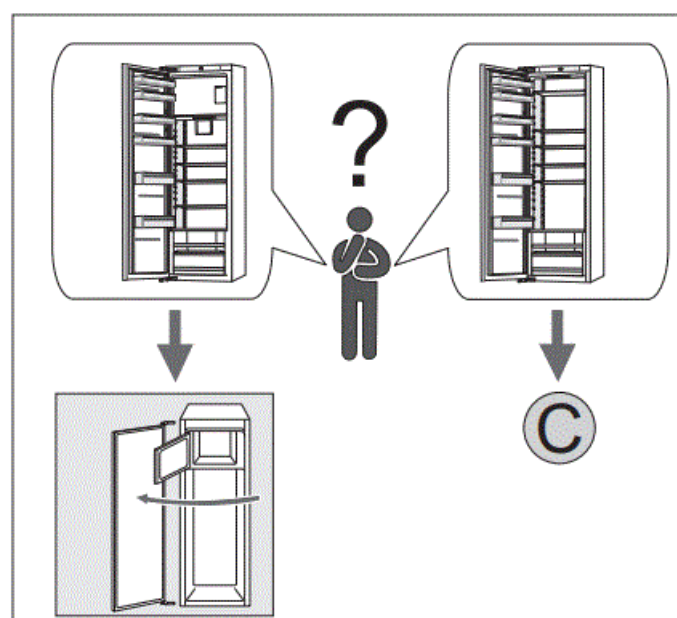

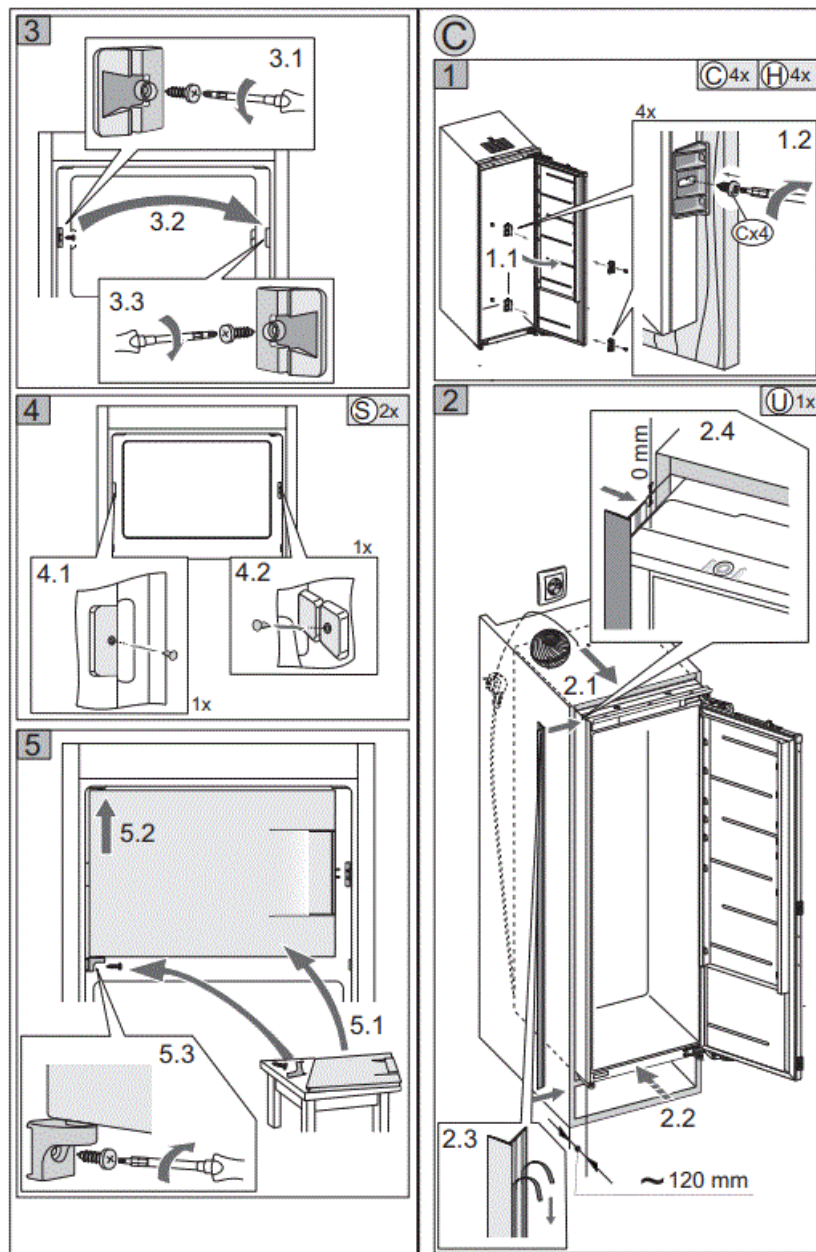

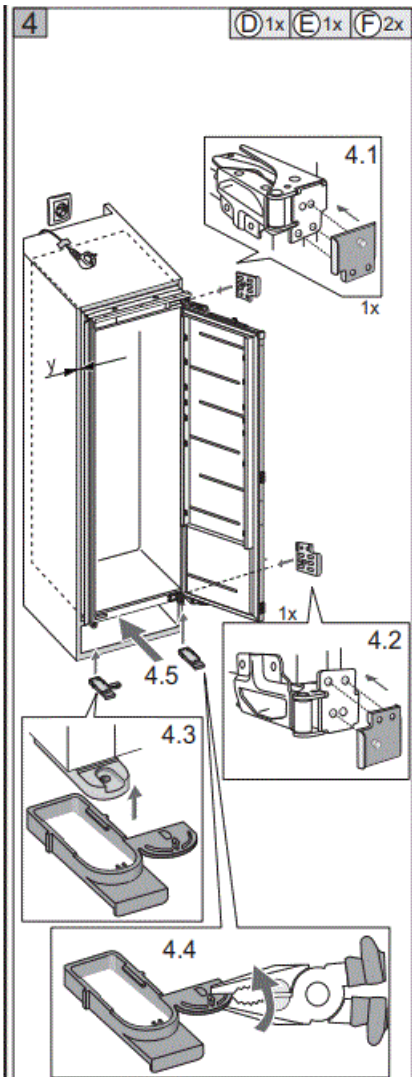
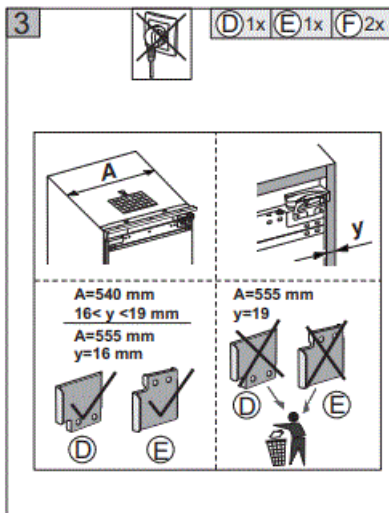

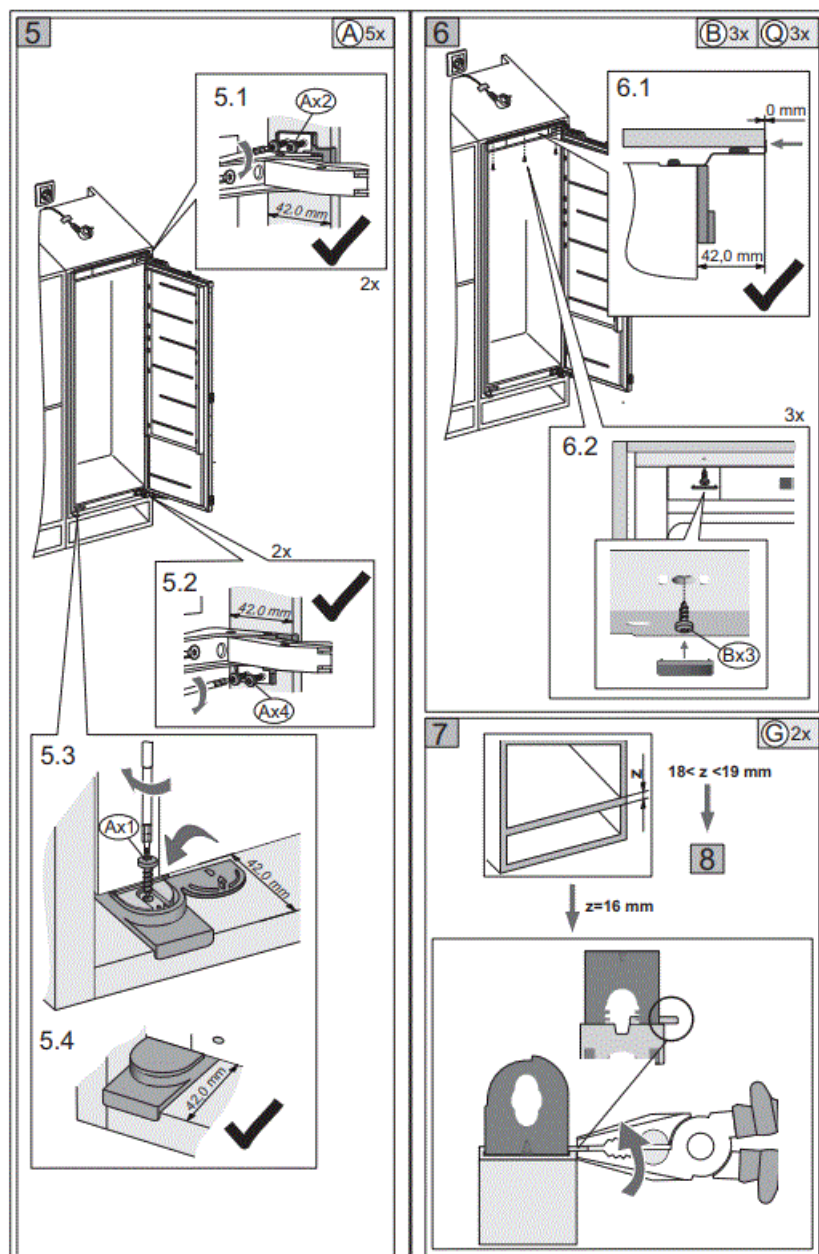

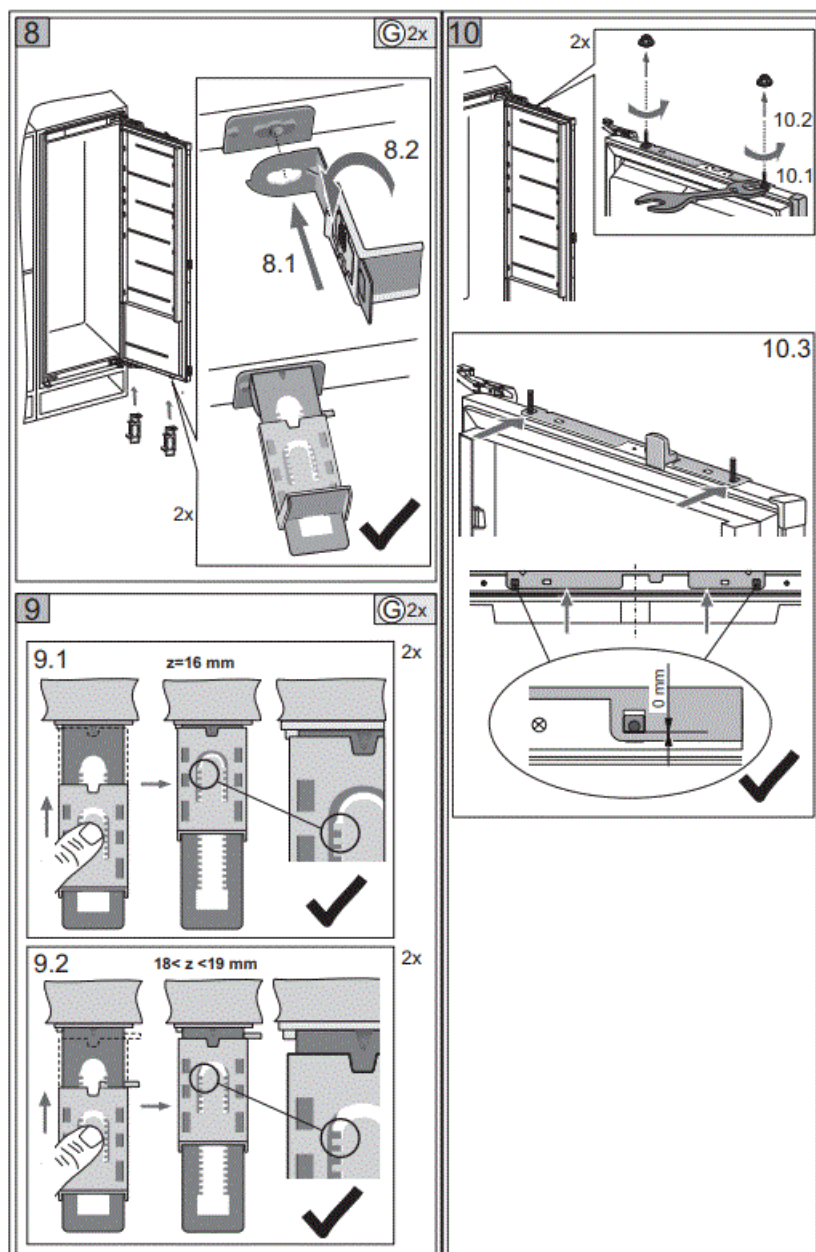

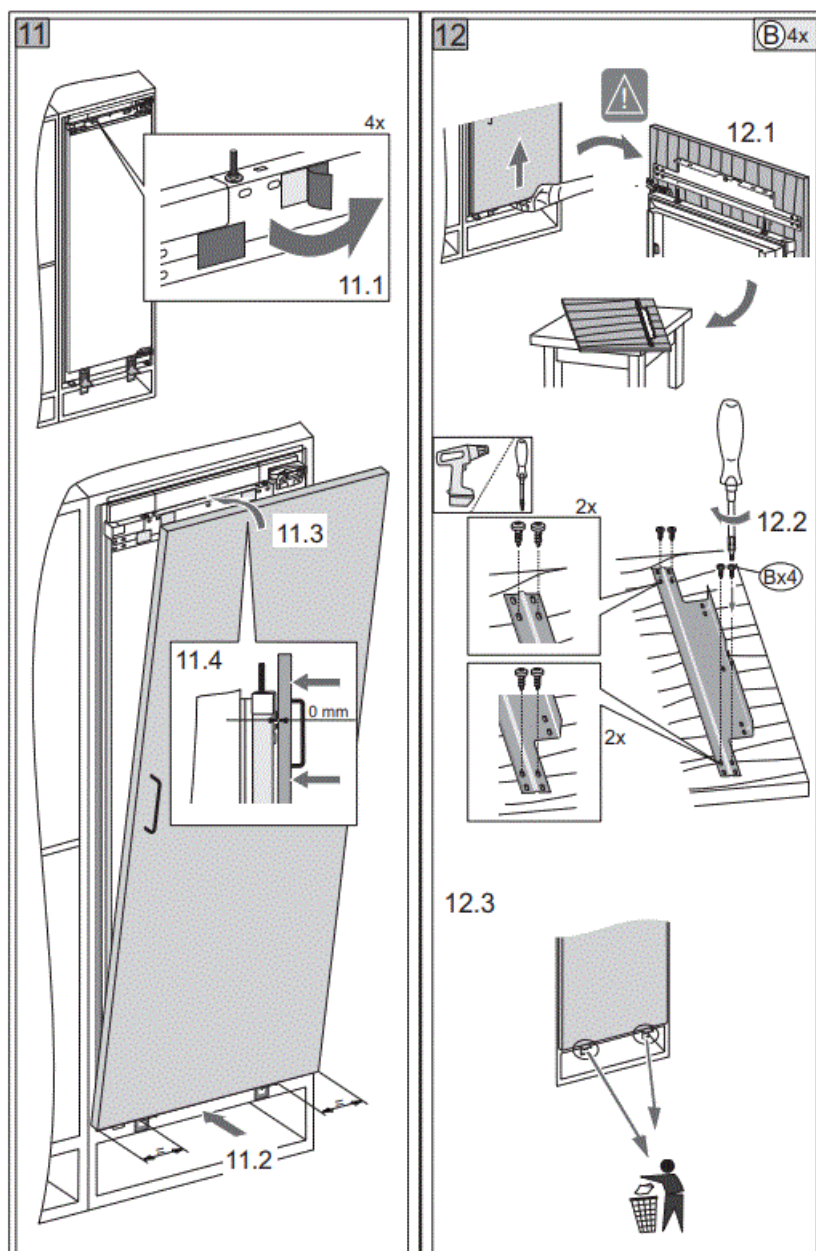

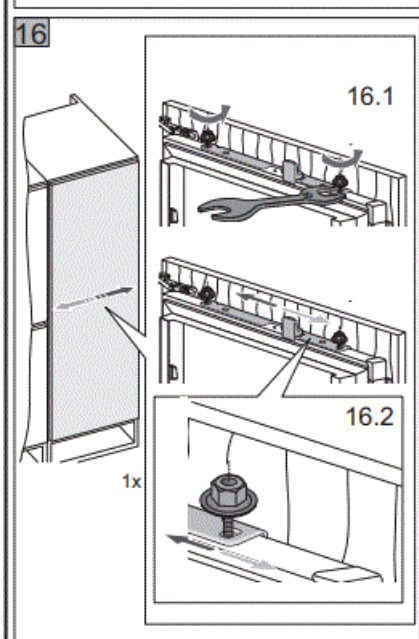
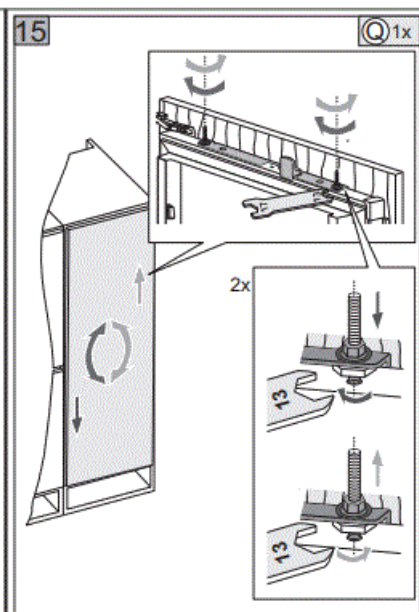
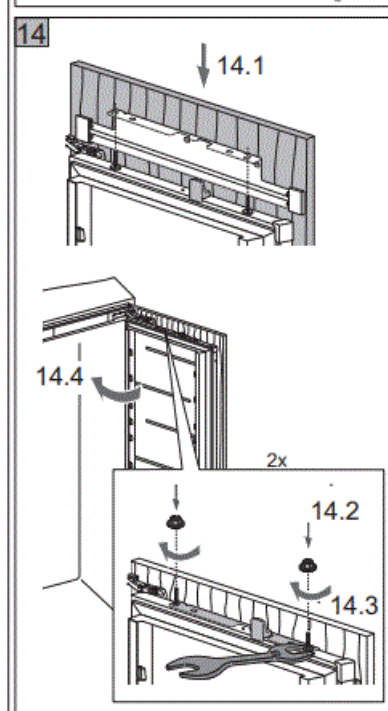
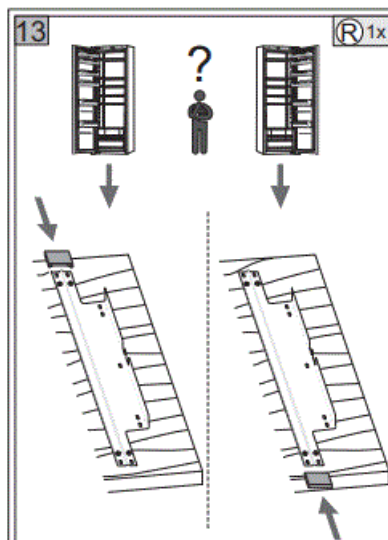

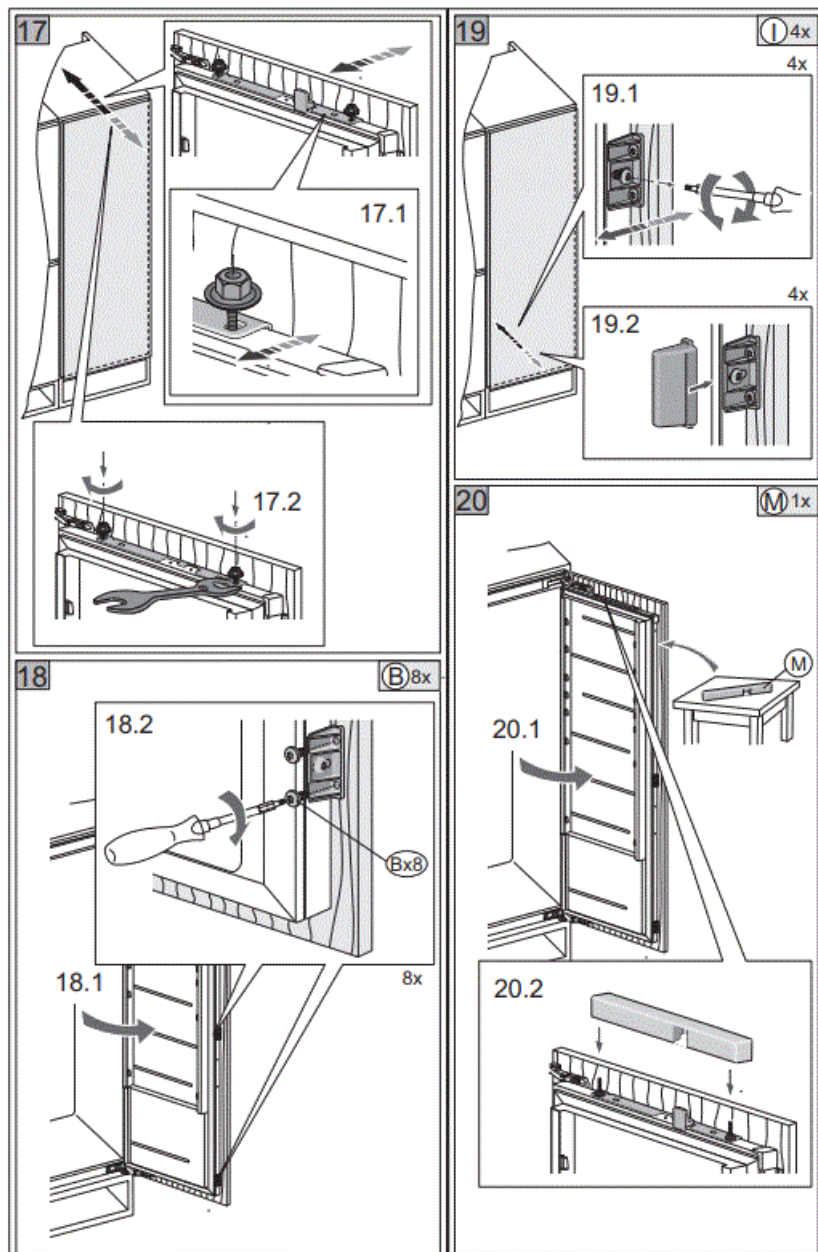

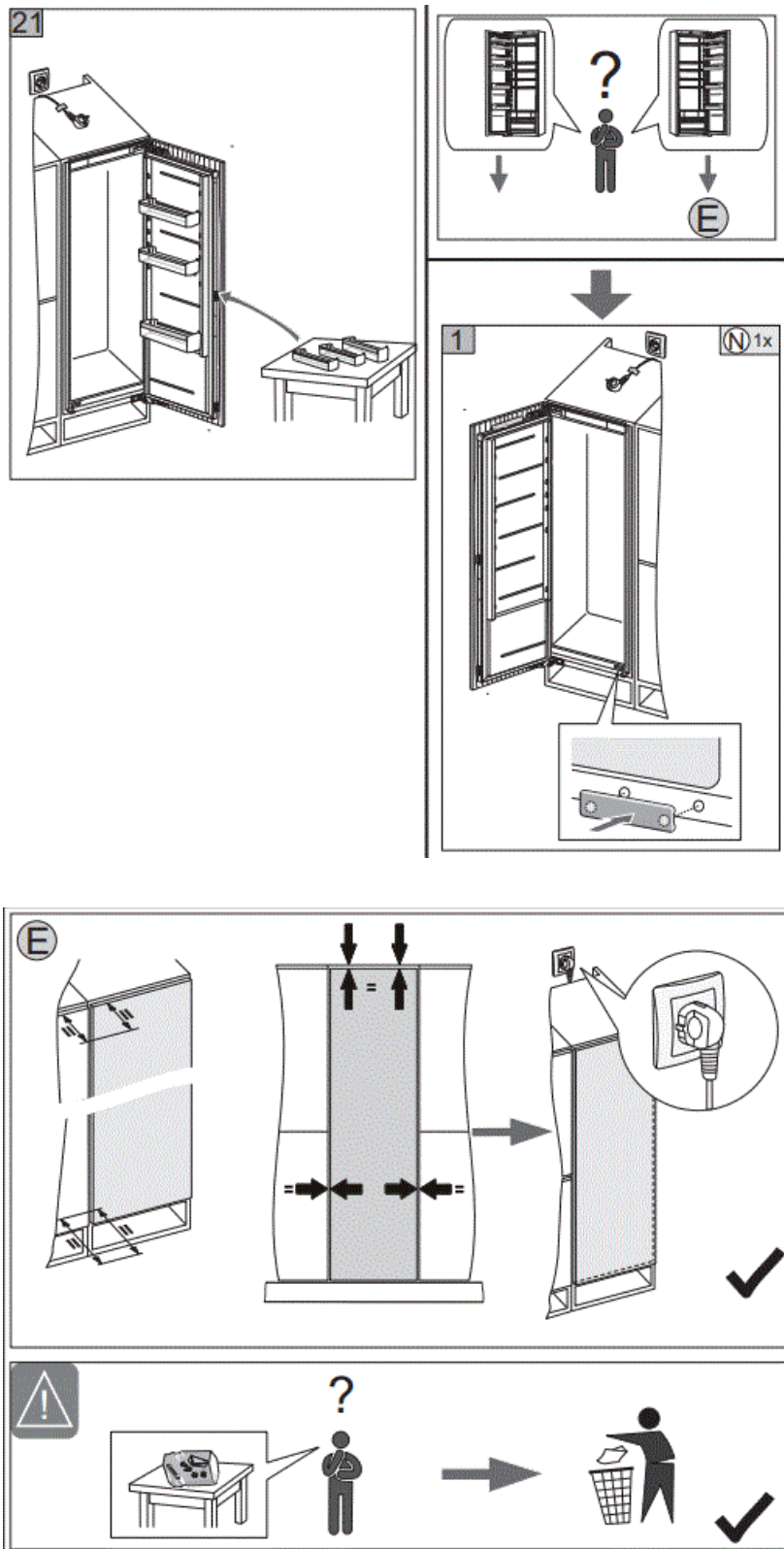

Documents / Resources

- QUICK START GUIDE
- INSTALLATION GUIDE
- USER MANUAL
- SERVICE MANUAL
- WARRANTY CARD
- ENERGY LABEL
- SAFETY INSTRUCTIONS
- REPAIR PARTS LIST
- ACCESSORIES
- OPTIONAL EQUIPMENT
- REPAIR PARTS LIST
- ACCESSORIES
- OPTIONAL EQUIPMENT

[ATAG BCD75102AD Built In Fridge](#) [pdf] Instruction Manual
BCD75102AD Built In Fridge, BCD75102AD, Built In Fridge, Fridge

