

**AstroAI AP639 DIGITAL TIRE PRESSURE GAUGE**



# AstroAI AP639 DIGITAL TIRE PRESSURE GAUGE User MANUAL

[Home](#) » [Support](#) » AstroAI AP639 DIGITAL TIRE PRESSURE GAUGE User MANUAL 

## Contents

- 1 [AstroAI AP639 DIGITAL TIRE PRESSURE GAUGE](#)
- 2 [WARNING](#)
- 3 [DIAGRAM](#)
- 4 [SPECIFICATIONS](#)
- 5 [OPERATION INSTRUCTIONS](#)
- 6 [CHANGING THE BATTERY](#)
- 7 [TROUBLESHOOTING](#)
- 8 [1-Year Warranty Limited Warranty from AstroAI](#)
- 9 [FAQs](#)
- 10 [References](#)
- 11 [Related Posts](#)



**AstroAI AP639 DIGITAL TIRE PRESSURE GAUGE**



Thank you for purchasing the 150 PSI Tire Pressure Gauge from AstroAI. For optimal performance and safety, please read and follow all of the instructions below before operating the device. Please keep this manual for future reference. We hope you enjoy your new Tire Gauge! If you experience the need for any kind of help or support from our Customer Service team, you are welcome to contact us with your question via [support@astroai.com](mailto:support@astroai.com).

## **WARNING**

- Do not use this product for applications outside of its intended use
- Read and follow all instructions before use
- Check the device for any damage
- Do not use this product if it is defective, please contact us for help
- Keep this product out of children's reach
- Do not expose this product to rain or water
- Keep this product away from fire, corrosive liquids, and magnetic substances
- This device only works with Schrader valves, will not work with Presta valves
- This product is not suitable for low temperature environments
- The maximum measurement range is 150psi, any higher pressure measurement will cause damage to this gauge.

## **DIAGRAM**

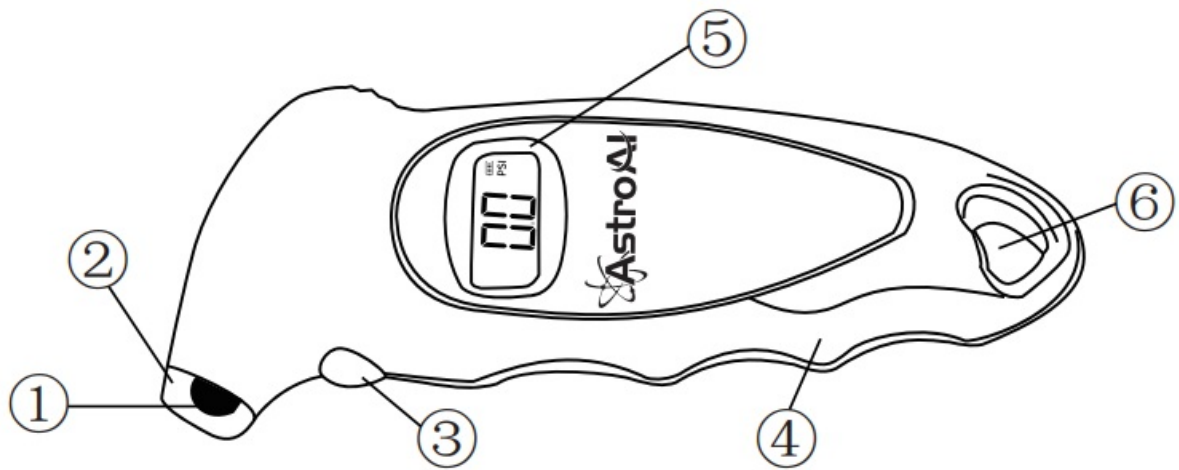

1. LED Light
2. Nozzle
3. Power/Unit Button Trigger
4. Handle
5. LCD Backlit Screen
6. Hang Hook

## SPECIFICATIONS

Parameter	Specification
<b>Range</b>	0-150 PSI / 0-10 BAR / 0-10 KG/CM <sup>2</sup> / 0-1000 KPA
<b>Display</b>	21 x 10mm LCD display
<b>Power</b>	2×AAA Batteries
<b>Operating Temperature</b>	23-122°F / -5-50°C

## OPERATION INSTRUCTIONS

1. Press the trigger to turn the tire pressure gauge on. The gauge will display “0.0” on the LCD Screen.

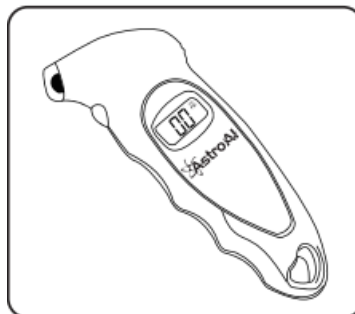

2. Place the nozzle straight on the tire valve you wish to measure. Press firmly to ensure a good seal and prevent air from leaking. Hold the gauge on the valve until the measurement display locks. It should only take a second if you have a good seal.

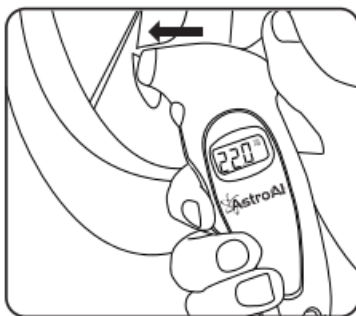

3. Remove the gauge to easily read the pressure.

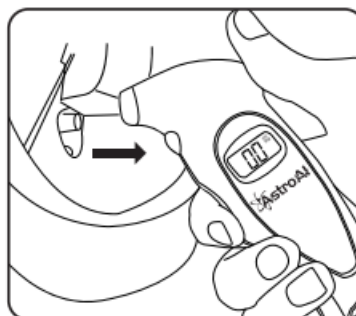

4. Click the button to switch units between PSI, BAR, KPA and KG/CM<sup>2</sup>. Press and hold the button for 3 seconds to turn this gauge off. The gauge will also automatically turn off shortly after use.

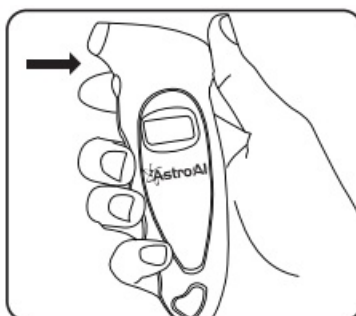

## CHANGING THE BATTERY

1. Locate the battery compartment on the back of the tire pressure gauge and remove back cover.

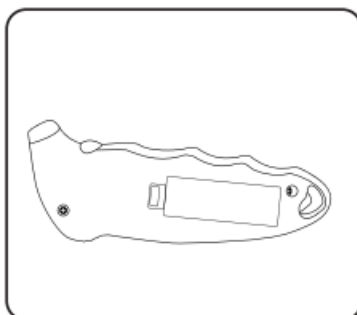

2. Locate the 2 x AAA Batteries, remove it from its place and replace it with new batteries.

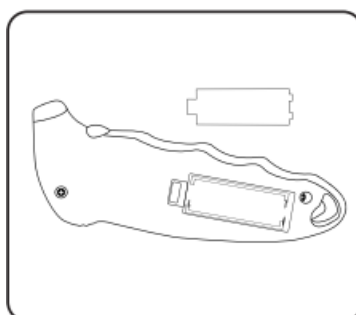

3. Take special care to place the battery with the correct polarity. Replace the back cover.

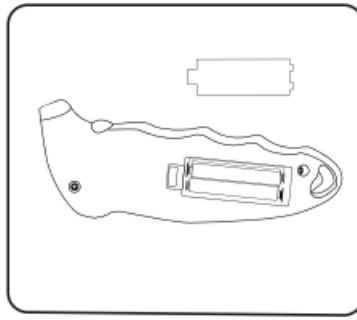

## TROUBLESHOOTING

Issue	Symptom	Solution
<b>Inaccurate Readings</b>	– Adjust angle between nozzle and tire valve	<ol style="list-style-type: none"> <li>1. Ensure the nozzle is straight on the tire valve.</li> <li>2. Check for a good seal.</li> <li>3. Contact support for maintenance or replacement.</li> </ol>
<b>Auto Power On/Off</b>	– Gauge shuts off after 20 seconds of inactivity	This feature conserves battery life by automatically shutting off the gauge when not in use.
<b>Flashing Screen</b>	– Display issues indicate battery or gauge problems	Replace the batteries or contact support for guidance.
<b>Display Abnormal Readings</b>	– Inaccurate display readings	<ol style="list-style-type: none"> <li>1. Ensure the gauge is stored indoors to avoid low temperatures.</li> <li>2. Avoid dropping the product.</li> <li>3. Compatible only with Schrader valves, not Presta.</li> </ol>
<b>Air Leaking</b>	– Air escapes during measurement	<ol style="list-style-type: none"> <li>1. Some air loss is normal upon connection.</li> <li>2. Ensure a proper seal.</li> <li>3. Adjust the nozzle angle to be straight on.</li> <li>4. Contact support if persistent.</li> </ol>
<b>Gauge Will Not Turn On</b>	– No power to gauge	<ol style="list-style-type: none"> <li>1. Replace dead batteries.</li> <li>2. Check for damage from dropping and contact support if necessary.</li> </ol>

## 1-Year Warranty Limited Warranty from AstroAI

Each AstroAI 150 PSI Tire Pressure Gauge is free from defects in material and workmanship. This warranty does not cover damages caused by negligence, misuse, contamination, alteration, accidents, or abnormal conditions of operation. This warranty only covers the original purchaser and can not be transferred.

AstroAI always wants to provide our customers with excellent products and customer service. To learn more about us, please visit us at [astroai.com](https://astroai.com).

## FAQs

What is the maximum pressure reading of the AstroAI AP639 Digital Tire Pressure Gauge?

The AstroAI AP639 Digital Tire Pressure Gauge can measure up to 150 PSI (10 bar or 1000 kPa) of pressure.

What type of display does the AstroAI AP639 have?

The AstroAI AP639 has a digital LCD display for precise pressure readings.

What type of battery does the AstroAI AP639 use?

The AstroAI AP639 uses a CR2032 lithium coin cell battery.

How accurate are the pressure readings of the AstroAI AP639?

According to customer reviews, the AstroAI AP639 provides accurate pressure readings that are very close to the actual tire pressure.

What is the resolution of the AstroAI AP639's pressure readings?

The AstroAI AP639 has a resolution of 0.1 PSI for precise pressure measurements.

Does the AstroAI AP639 come with any accessories?

The AstroAI AP639 includes a storage case and a CR2032 battery for immediate use.

What is the size of the AstroAI AP639?

The AstroAI AP639 measures 6.7 x 1.6 x 1.2 inches and weighs only 2.4 ounces, making it compact and portable.

Is the AstroAI AP639 suitable for use on all types of tires?

The AstroAI AP639 can be used on car, motorcycle, bicycle, and RV tires, as well as sports balls and other inflatables.

How long does the battery in the AstroAI AP639 last?

The battery life of the AstroAI AP639 varies depending on usage, but it is designed to provide long-lasting performance.

Does the AstroAI AP639 have any special features?

The AstroAI AP639 has a backlit display for easy reading in low light conditions and a swivel chuck for convenient tire valve access.

Is the AstroAI AP639 durable?

The AstroAI AP639 is made of high-quality materials and is designed to withstand everyday use in automotive and outdoor environments.

Does the AstroAI AP639 come with a warranty?

The AstroAI AP639 comes with a 1-year warranty against defects in materials and workmanship.

**Download this Manual: [AstroAI AP639 DIGITAL TIRE PRESSURE GAUGE User MANUAL](#)**

---

## References

- [User Manual](#)

[Manuals+](#), [Privacy Policy](#)

This website is an independent publication and is neither affiliated with nor endorsed by any of the trademark owners. The "Bluetooth®" word mark and logos are registered trademarks owned by Bluetooth SIG, Inc. The "Wi-Fi®" word mark and logos are registered trademarks owned by the Wi-Fi Alliance. Any use of these marks on this website does not imply any affiliation with or endorsement.