

asTech All-In-One Diagnostics Calibrations



asTech All-In-One Diagnostics Calibrations User Guide

[Home](#) » [asTech](#) » **asTech All-In-One Diagnostics Calibrations User Guide** 

Contents

- [1 asTech All-In-One Diagnostics Calibrations](#)
- [2 Product Information](#)
- [3 Product Usage Instructions](#)
- [4 FAQ](#)
- [5 Connect tablet to Wi-Fi](#)
- [6 Connect carside device](#)
- [7 Login to as Tech App](#)
- [8 Start New Request](#)
- [9 Documents / Resources](#)
 - [9.1 References](#)
- [10 Related Posts](#)

asTech

asTech All-In-One Diagnostics Calibrations



Product Information

Specifications:

- Product Name: All-In-One tablet with VCI Link
- Connectivity: Wi-Fi
- Compatibility: Works with asTech App and Link

Product Usage Instructions

Connect tablet to Wi-Fi:

On the device home screen, tap Settings > Network & Internet > Wi-Fi. Slide the Wi-Fi switch to ON.

Connect carside device:

Ensure your asTech app and Link have the most recent software update.

Login to asTech App:

1. Connect to the car and click Remote Diagnostic Mode.
2. Select WLAN.
3. Select your Wi-Fi network.
4. Login and connect to your Wi-Fi network.
5. Once the screen shows with 2 blue checks, you are ready to go!

Start New Request:

On your tablet, tap the center blue asTech button to open the app and log in using your credentials. You can now select your vehicle and click New Request.

FAQ

Q: How do I ensure my asTech app and Link have the most recent software update?

A: To update your asTech app and Link, check for updates in the respective app stores or contact customer support for assistance.

Q: What should I do if I encounter connectivity issues during the login process?

A: Make sure you are within range of a stable Wi-Fi connection and verify that the correct Wi-Fi network is selected on both the tablet and carside device. If issues persist, restart both devices and try the login process again.

Connect tablet to Wi-Fi



On the device home screen, tap Settings > Network & Internet > Wi-Fi. Slide the Wi-Fi switch to ON.

*Ensure your asTech app and Link have the most recent software update.

Connect carside device

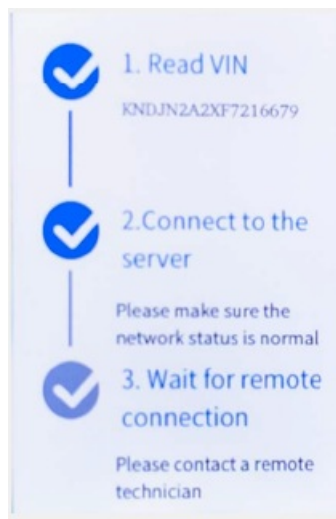

1. Connect to car and click Remote Diagnostic Mode.
2. Select WLAN.
3. Select your Wi-Fi network
4. Login and connect to your Wi-Fi network.
5. Once the screen shows 2 blue checks, you are ready to go!

Login to as Tech App

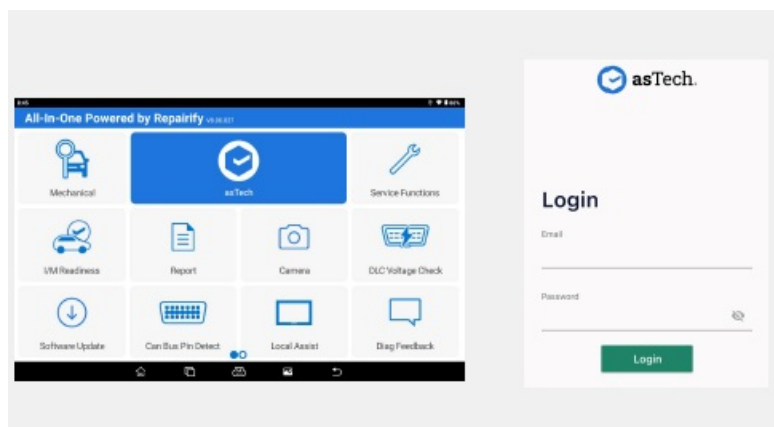

On your tablet, tap the center blue Tech button to open the app and log in using your credentials.

Start New Request



You are now able to go into the BasTech app, select your vehicle, and click New Request!

Documents / Resources

	asTech All-In-One Diagnostics Calibrations [pdf] User Guide All-In-One Diagnostics Calibrations, Diagnostics Calibrations, Calibrations
---	--

References

- [User Manual](#)

[Manuals+](#), [Privacy Policy](#)

This website is an independent publication and is neither affiliated with nor endorsed by any of the trademark owners. The "Bluetooth®" word mark and logos are registered trademarks owned by Bluetooth SIG, Inc. The "Wi-Fi®" word mark and logos are registered trademarks owned by the Wi-Fi Alliance. Any use of these marks on this website does not imply any affiliation with or endorsement.