



ASTATIC M2 Multipurpose 2-Channel Analog Mixer with Built-In USB Interface User Guide

[Home](#) » [ASTATIC](#) » ASTATIC M2 Multipurpose 2-Channel Analog Mixer with Built-In USB Interface User Guide



Contents

- [1 ASTATIC M2 Multipurpose 2-Channel Analog Mixer with Built-In USB Interface](#)
- [2 Precautions](#)
- [3 Connecting the Mixer](#)
- [4 Controls and Functions](#)
- [5 Specifications](#)
- [6 Two-Year Limited Warranty](#)
- [7 Documents / Resources](#)
- [8 Related Posts](#)

ASTATIC®

ASTATIC M2 Multipurpose 2-Channel Analog Mixer with Built-In USB Interface



Precautions

PLEASE READ CAREFULLY BEFORE PROCEEDING

Please keep this manual in a safe place for future reference

WARNING

Always follow the basic precautions listed below to avoid the possibility of serious injury or even death from electrical shock, short-circuiting, damages, fire or other hazards. These precautions include, but are not limited to, the following:

Do not open

This device contains no user-serviceable parts. Do not open the device or attempt to disassemble the internal parts or modify them in any way. If it should appear to be malfunctioning, discontinue use immediately and have it inspected by qualified service personnel

Water warning

- Do not expose the device to rain, use it near water or in damp or wet conditions, or place on it any containers (such as vases, bottles or glasses) containing liquids which might spill into any openings. If any liquid such as water seeps into the device, turn off the power immediately and disconnect the USB cable from the computer. Then have the device inspected by qualified service personnel.
- Never insert or remove a USB cable with wet hands

Fire warning

Do not put burning items, such as candles, on the unit. A burning item may fall over and cause a fire.

If you notice any abnormality

When one of the following problems occur, immediately turn off the power switch and disconnect the USB cable from the computer. Then have the device inspected by qualified service personnel.

- The USB cable becomes frayed or damaged.
- It emits unusual smells or smoke.
- Some object has been dropped into the device.
- There is a sudden loss of sound during use of the device

If this device should be dropped or damaged, immediately turn off the power switch, disconnect the USB cable from the computer, and have the device inspected by qualified service personnel

CAUTION

Always follow the basic precautions listed below to avoid the possibility of physical injury to you or others, or damage to the device or other property. These precautions include, but are not limited to, the following:

Location

- Do not place the device in an unstable position where it might accidentally fall over.
- Do not place the device in a location where it may come into contact with corrosive gasses or salt air. Doing so may result in malfunction.
- Before moving the device, remove all connected cables.

Connections

- Before connecting the device to other devices, turn off the power for all devices.
- Before turning the power on or off for all devices, set all volume levels to minimum.

Maintenance

Remove the USB cable from a computer when cleaning the device.

Handling caution

- Do not insert your fingers or hands in any gaps or openings on the device.
- Avoid inserting or dropping foreign objects (paper, plastic, metal, etc.) into any gaps or openings on the device.
If this happens, turn off the power immediately and disconnect the USB cable from the computer. Then have the device inspected by qualified service personnel.
- Do not rest your weight on the device or place heavy objects on it, and avoid use excessive force on the buttons, switches or connectors
- Do not use speakers or headphones for a long period of time at a high or uncomfortable volume level, since this can cause permanent hearing loss. If you experience any hearing loss or ringing in the ears, consult a physician.

CAD Audio cannot be held responsible for damage caused by improper use or modifications to the device, or data that is lost or destroyed

NOTICE

To avoid the possibility of malfunction/ damage to the product, damage to data, or damage to other property,

follow the notices below.

Handling and maintenance

- Do not use the device in the vicinity of a TV, radio, stereo equipment, mobile phone, or other electric devices. Otherwise, the device, TV, or radio may generate noise.
- Do not expose the device to excessive dust or vibration, or extreme cold or heat (such as in direct sunlight, near a heater, or in a car during the day), in order to prevent the possibility of panel disfiguration, unstable operation, or damage to the internal components.
- Do not place vinyl, plastic or rubber objects on the device, since this might discolor the panel.
- When cleaning the device, use a dry and soft cloth.
- Do not use paint thinners, solvents, cleaning fluids, or chemical-impregnated wiping cloths.
- Condensation can occur in the device due to rapid, drastic changes in ambient temperature – when the device is moved from one location to another, or air conditioning is turned on or off, for example. Using the device while condensation is present can cause damage. If there is reason to believe that condensation might have occurred, leave the device for several hours without turning on the power until the condensation has completely dried out.
- Avoid setting all equalizer controls and faders to their maximum. Depending on the condition of the connected devices, doing so may cause feedback and may damage the speakers.
- Do not apply oil, grease, or contact cleaner to the faders. Doing so may cause problems with electrical contact or fader function.
- When turning on the AC power in your audio system, always turn on the power amplifier LAST, to avoid speaker damage. When turning the power off, the power amplifier should be turned off FIRST for the same reason.
- Turn the power to the device off if it will not be used for an extended period of time.

Connectors

XLR-type connectors are wired as follows (IEC60268 standard):
pin 1: ground, pin 2: hot(+), and pin 3: cold(-).

Information about this manual

- The illustrations as shown in this manual are for instructional purposes only.
- The company names and product names in this manual are the trademarks or registered trademarks of their respective companies.

Connecting the Mixer

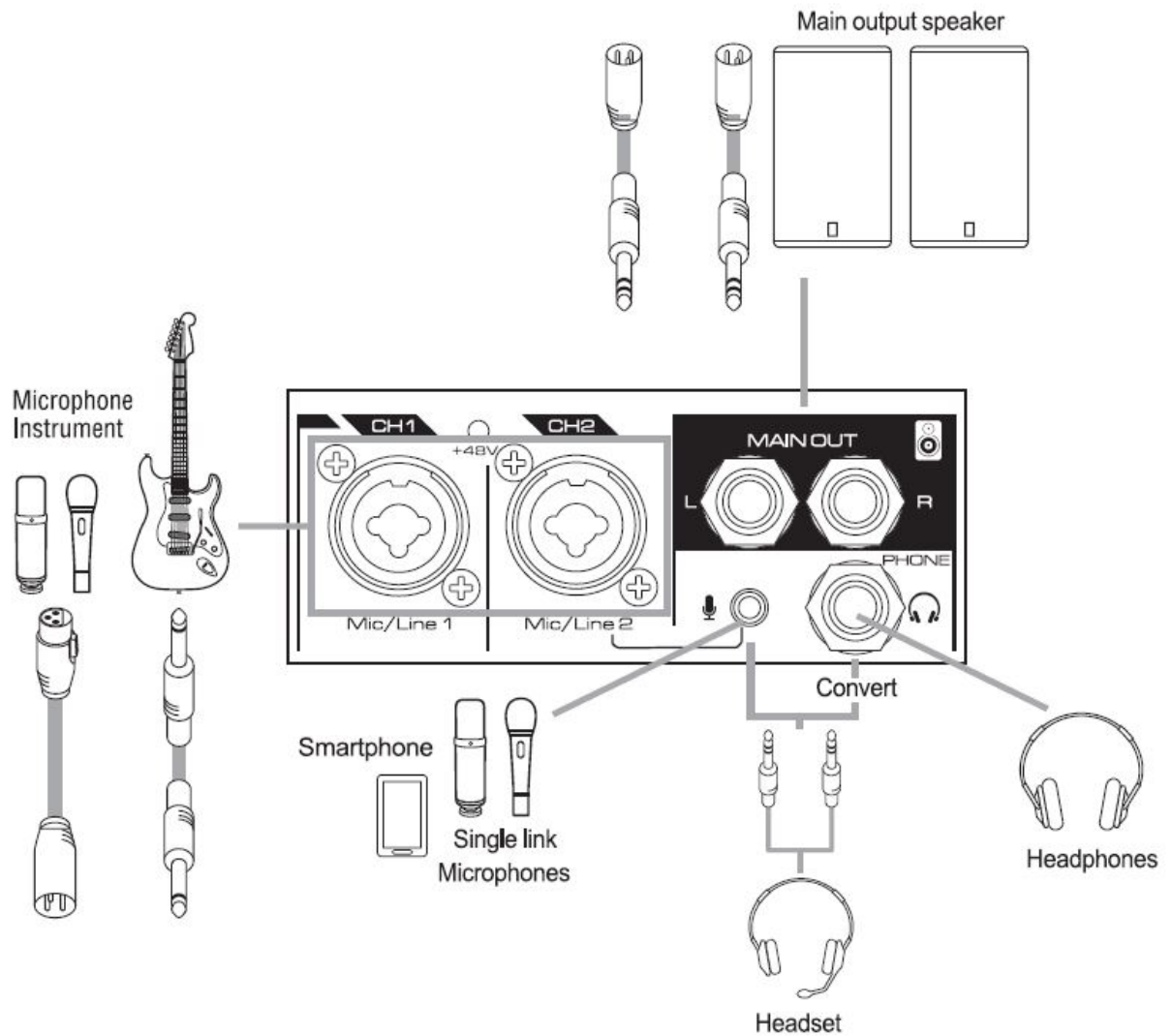

Astatic M2 is a multipurpose 2 channel (2mic/line) analog mixer with a built-in USB interface. USB connectivity and +48V phantom power make it an ideal compact option for live performance, broadcasting, podcasting or home recording. The M2 contains the following features:

- 2 XLR combo inputs for mic or instrument signal
- USB output connects to computer for easy recording or podcasting (24-bit/48kHz)
- Bus powered – no need for external power supply when using with a computer
- +48V phantom power for use with condenser microphones
- Output can be stereo or panned UR

Mixer Basics: Where Your Sound Goes

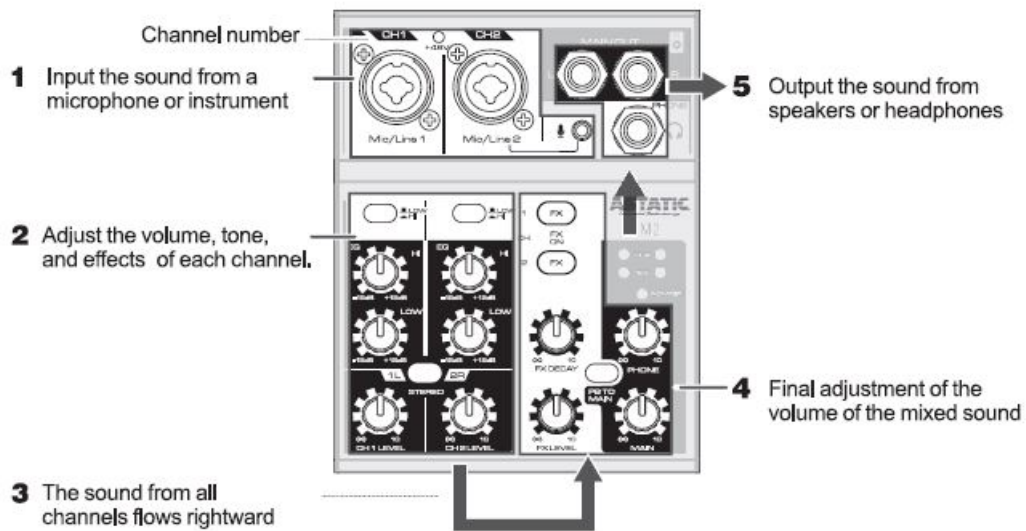

Basic Operation: Power Connection

1. Make sure that all switches on the device are not turned on and USB data line of the rear panel power is not inserted.
2. Connect the attached USB data line.
 1. **A.** Align the USB data cable plug with the device back panel interface and insert it.
 2. **B.** The USB data cable is connected to the USB power adapter.
 3. **C.** Plug the power adapter into the standard [-AC 100-240 50Hz/60Hz] power socket.

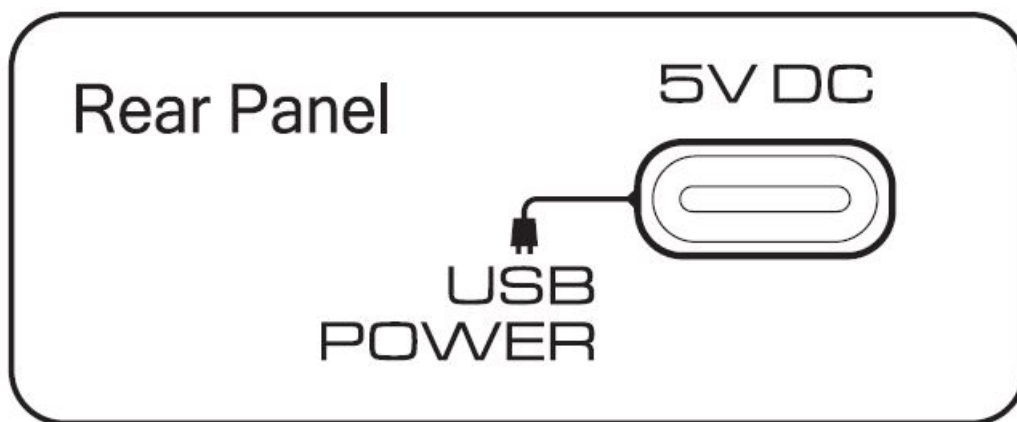

Controls and Functions

1. **Type-C power input socket** – It is used to connect the USB power adapter and Type-C data cable for power supply of the mixer.
 1. Read carefully the safety precautions for the USB power adapter and Type-C data cable you are using.
 2. USB power adapter and Type-C data line Voltage standard:
 3. **Output voltage:** 4.8V to 5.2V
 4. **Output current:** 3A or higher
2. **Phantom Switch/+48V Lamp** – When this switch is turned on, the [+48V] lights and DC +48V phantom power is supplied to the XLR plug on MIC/LINE input jack. Turn this switch on when using a phantom powered condenser microphone.

Note:

Be sure to leave this switch off if you do not need phantom power. Follow the important precautions below, in order to prevent noise and possible damage to external devices as well as the mixer if you turn this switch on .

1. Be sure to leave this switch off when you connect a device that does not support phantom power to channel 1.
2. Make sure to turn this switch off when connecting/disconnecting a cable to/from channel.
3. Slide the fader on channel 1 to minimum before turning this switch on/off.

3. Mic/Line Jacks –

For connecting to a microphone, an instrument, or an audio device. These jacks support both XLR and phone plugs.



4. **Main Out Jacks** – These are balanced TRS output jacks that output the mixed stereo signal. They output the signal adjusted by the L/R master Knob. Connect these jacks to the power amplifier that drive your main speakers.
5. **Phones Jack**– For connecting headphones. The socket supports stereo phone plug. If you need to connect headsets or earplugs with mini plugs, please use a switch device to connect.
6. **Headset Microphone (f) Input Jack** – For connecting to the microphone for your headset. The audio input here is sent to channel 2.
7. **Gain Switches** – Determines the basic volume for channel. Turn this switch OFF if you hear distortion.
8. **EQ Knob** – Use [HIGH] and [LOW] knobs to adjust sound quality. If you don't need to adjust sound quality, set the knob to "O" (flat).
9. **Link Stereo Pan Switch** – With this switch out, each mono channel feeds both the left and right sides of the main mix equally.

For example:

1. Playing a mono source: If you talk into a microphone connected to input 1, your sweet tones will be heard in both the left and right loudspeakers.
2. With this switch pressed in, channel 1 will play only in the left side of the main mix, and channel 2 will play in the right side.

For example:

Recording a stereo source: If you have a stereo microphone connected to the mic inputs, or if you are playing a stereo source into the line inputs, each side of the source can be recorded discretely onto a recorder connected to the main outputs. The pan switch does not affect the other channels.

10. **Level Knob** – Used to adjust the level of the channel signal.

Note: To minimize noise, adjust the knobs on unused channels to a minimum.

11. **FX Knob** – These buttons turn on the effects on channels, add a natural spaciousness to the sound. The default settings have reverb turned off.
12. **FX Decay Knob**– For adjusting the parameter (depth).
13. **FX Level Knob** – For adjust the effect level sent from the internal effector to the bus.
14. **Indicator Light** – CLIP LED indicates that the audio signal in the channel is too loud. Turn the corresponding GAIN counter-clockwise until the CLIP LED no longer illuminates. SIG LED indicates that an audio signal is present in the channel.
15. **Phone Knob** – Adjust the volume to headphones and powered monitor speakers connected to the

headphones' output jack.

16. **Play Back to Main Switch** -This switch(-) is used to enter signals via USB. If the signal is(-.), it will be sent to the MAIN channel.
17. **MAIN OUT Knob** – Used to adjust the signal level output to the [MAIN OUT] socket.

Specifications

- Inputs 2 XLR mic/line combo
- Outputs 1/4" TRS, balanced; USB
- Mic E.I.N (20Hz- 20kHz) -118dBu @100 n source resistance
- Distortion (THD) 0.02%

Noise

- Stereo out (fader at 0 dB) – 78 dBu
- Stereo out (fader at 00) -88 dBu
- Signal to noise ratio
- Mic input 80dB
- Line input 78dB
- Weight. 1.3lb (0.6kg)
- Dimensions 7" x 7" x 2.3" (18cm x 18cm x 6cm)

Two-Year Limited Warranty

CAD Audio hereby warrants that this product will be free of defects in material and workmanship for a period of two years from the date of purchase. In the unlikely event that a defect occurs, CAD will, at its option, either repair or replace with a new unit of equal or greater value. In the event that a suitable replacement is unavailable, CAD Audio may elect to reimburse owner for the cost of local repairs or issue a refund in the amount of the original purchase price. Items must be purchased from an authorized CAD Audio dealer, and the warranty is not transferable from the original owner.

Please retain proof of purchase to validate the purchase date and include it with any warranty claim. This warranty excludes exterior finish or appearance, damage from abuse, misuse of the product, use contrary to CAO's instructions or unauthorized repair. All implied warranties, merchantability, or fitness for a particular purpose is hereby disclaimed and CAD hereby disclaims liability for incidental, special or consequential damages resulting from the use or unavailability of this product. This warranty gives you specific legal rights and you may have other rights that vary from state to state. Some states do not allow the exclusion or limitation of incidental or consequential damages or limitations on how long an implied warranty lasts, so the above exclusions and limitations may not apply to you.

Note: No other warranty, written or oral is authorized by CAO Audio.

To initiate a warranty claim, please contact American Music and Sound at 1-800-431-2609 to obtain a return authorization number and shipping Instructions.

- A return authorization is required for all returns. RETURNS WITHOUT A PRE-APPROVED RETURN AUTHORIZATION NUMBER WILL BE REFUSED.
- Please use at least 3 inches of padding surrounding the product for protection

during shipment

- Retain your tracking number until your warranty claim has been resolved
- We recommend using an insured shipping method in case of loss or damage during shipment

If outside the United States, contact your local dealer or distributor for warranty details.

CAD Audio

6573 Cochran Rd., Bldg. I Solon, OH 44139 U.S.A. Tel: (440) 349-4900 Fax: (440) 248-4904 Sales: 800-762-9266
cadaudio.com Distributed Worldwide by American Music and Sound 925 Broadbeck Drive, Suite 220 Newbury Park, CA 91320 U.S.A. Tel: (800) 431-2609 Fax: (800) 431-3129 ©2022 CAD Audio Rev00 0522

Documents / Resources

	<p>ASTATIC M2 Multipurpose 2-Channel Analog Mixer with Built-In USB Interface [pdf] User Guide</p> <p>M2 Multipurpose 2-Channel Analog Mixer with Built-In USB Interface, M2, Multipurpose 2-Channel Analog Mixer with Built-In USB Interface, Built-In USB Interface, Multipurpose 2-Channel Analog Mixer, 2-Channel Analog Mixer, Analog Mixer, Mixer</p>
---	--

[Manuals+.](#)