



## ASSOCIATED RC10B6 Team Kit Installation Guide

[Home](#) » [ASSOCIATED](#) » ASSOCIATED RC10B6 Team Kit Installation Guide 



### RC10B6 Team Kit Installation Guide

#### **Builders Support Guide: RC10 B6 Builders Support Kit.**

The RC10B6 Builders Support Kit brings Team Associated race-winning technology to builders assembling dirt oval sprint cars, late models, and custom drag cars. The applications are endless. The Builders Support Kit has the major sub-assemblies builders need in a value-packed kit, without having to pay for excess 2WD off-road buggy parts. Scan the QR code to get to the TeamAssociated.com product page where you can download a detailed PDF manual showing each assembly included. Also look for a downloadable PDF of 3rd party conversion vendors who supply parts to complete your dirt oval, drag, or custom creation.

**Scan QR code for complete manual.**



[https://www.associatedelectrics.com/teamassociated/cars\\_and\\_trucks/RC10B6/RC10B6\\_Builders\\_Support/manuals\\_setups/](https://www.associatedelectrics.com/teamassociated/cars_and_trucks/RC10B6/RC10B6_Builders_Support/manuals_setups/)

## Contents

[1 :: Bag 5](#)

[2 :: Bag 9](#)

[3 Documents /  
Resources](#)

[4 Related Posts](#)

## :: Bag 5



**Build Tip:** The bottom side of the gear has 3 injection dots. This side faced down will keep the diff balls from falling thru the holes



**Build Tip:** Install the first washer and grease, then line up the 6 balls in your palm or on a lint-free towel and tough/spin to "roll" them onto the washer.

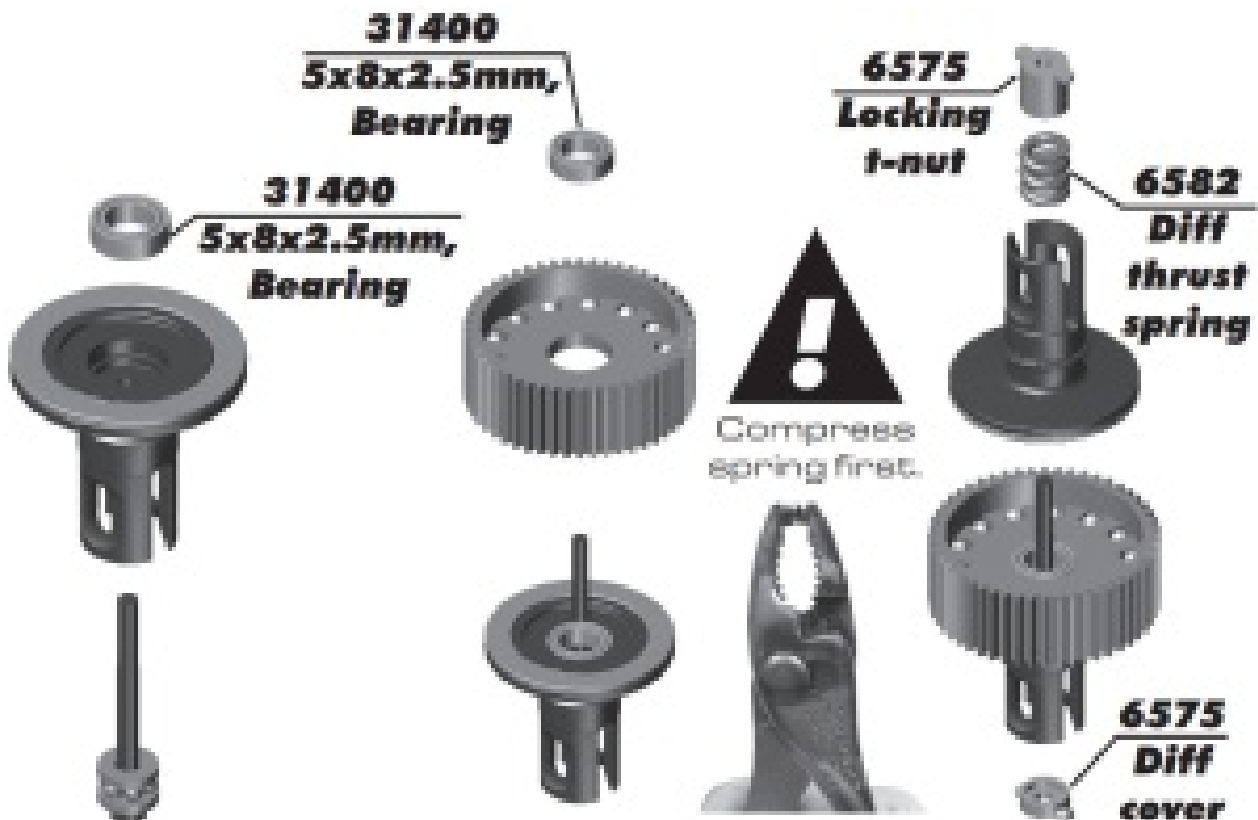

As you tighten the diff bolt, you will notice the T-nut ears moving closer to the bottom of the outdrive slot. This

compresses the spring behind the T-nut. The spring should be completely compressed at the time the T-nut reaches the end of the slot.

Caution! Pay close attention to the feeling when the spring is completely compressed. Do not overtighten the bolt. When you feel the spring completely compressed, loosen the diff bolt 1/8" of a turn. Your diff should now operate smoothly but with resistance as the outrives move in opposite directions. After you have driven the car once, re-check the diff setting. once, re-check the diff setting.

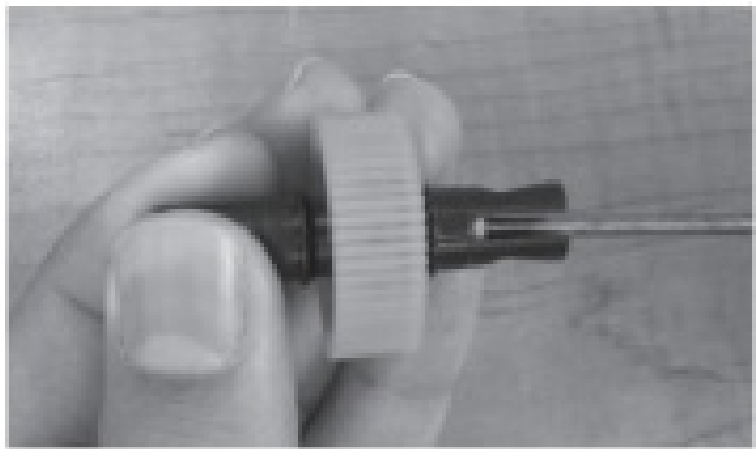

:: Bag 9

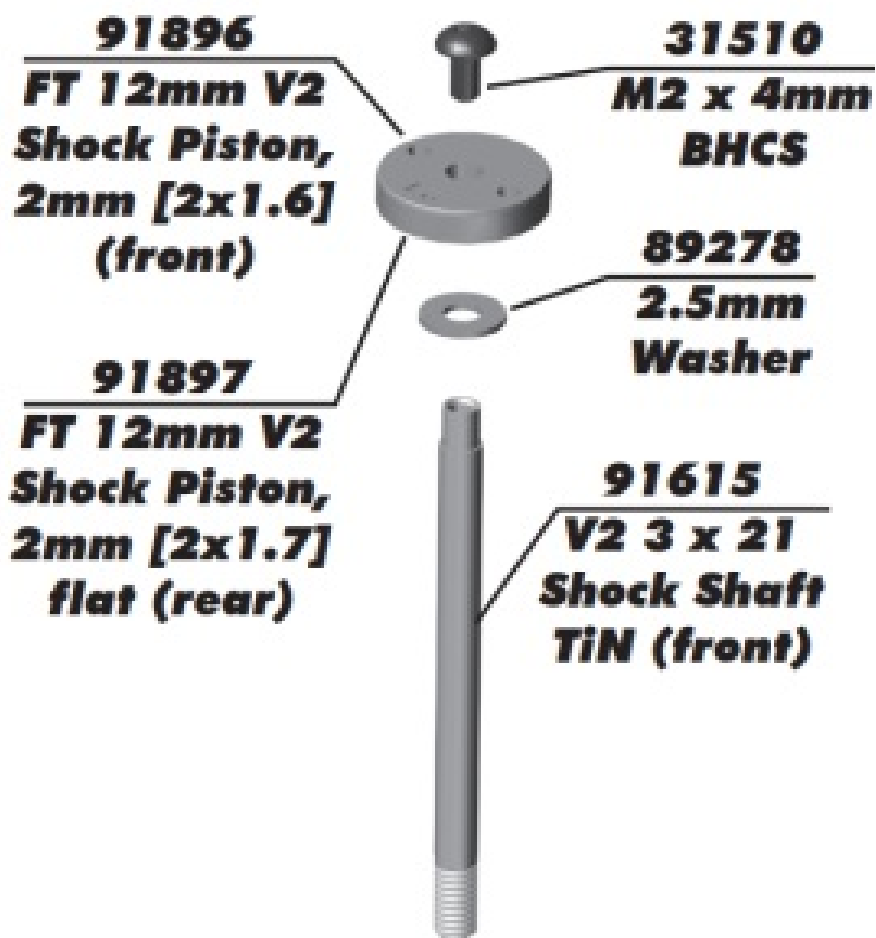

Mount the shock pistons with the number facing up!



**Racers Tip:** Use a marker over the numbers on the pistons to make them easily visible!

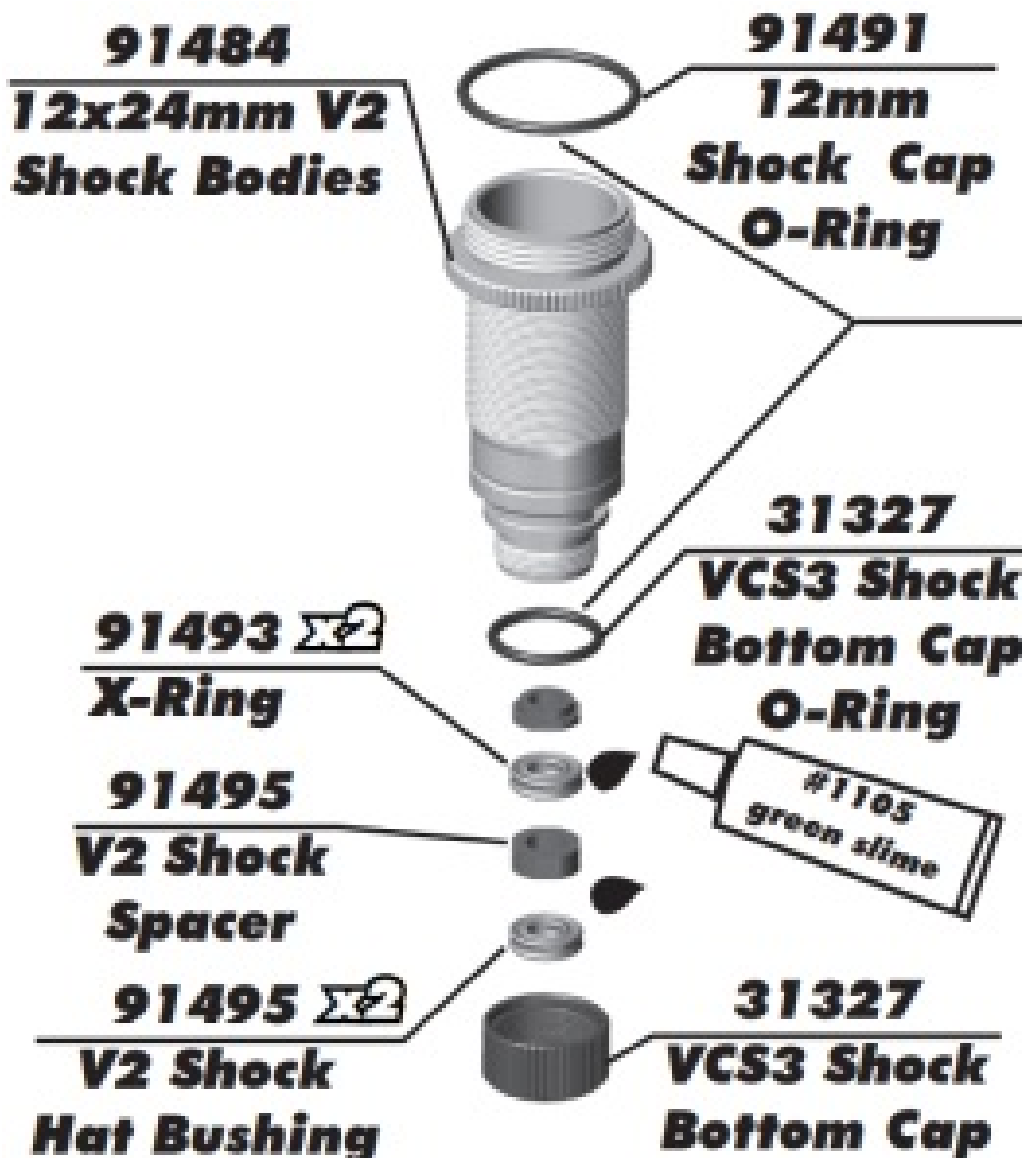

Lightly rub shock oil on the o-ring before installation!



**Racers Tip:** Coating the o-rings with green slime (#1105) helps seal & reduce o-ring swell! Green slime is not included in the kit!



Lightly rub shock oil or green slime on threads



There are 3 lengths of shock eyelet in the kit. Pay attention to length when building as these affect your droop and travel. droop and travel.



**Short   Long   Longer**  
**0mm   +2mm   +4mm**



**91820**

**Shock Eyelet**

**Front Shocks - Long**  
**Rear Shocks - Long**



**91819**

**Shock  
Pivot Ball**

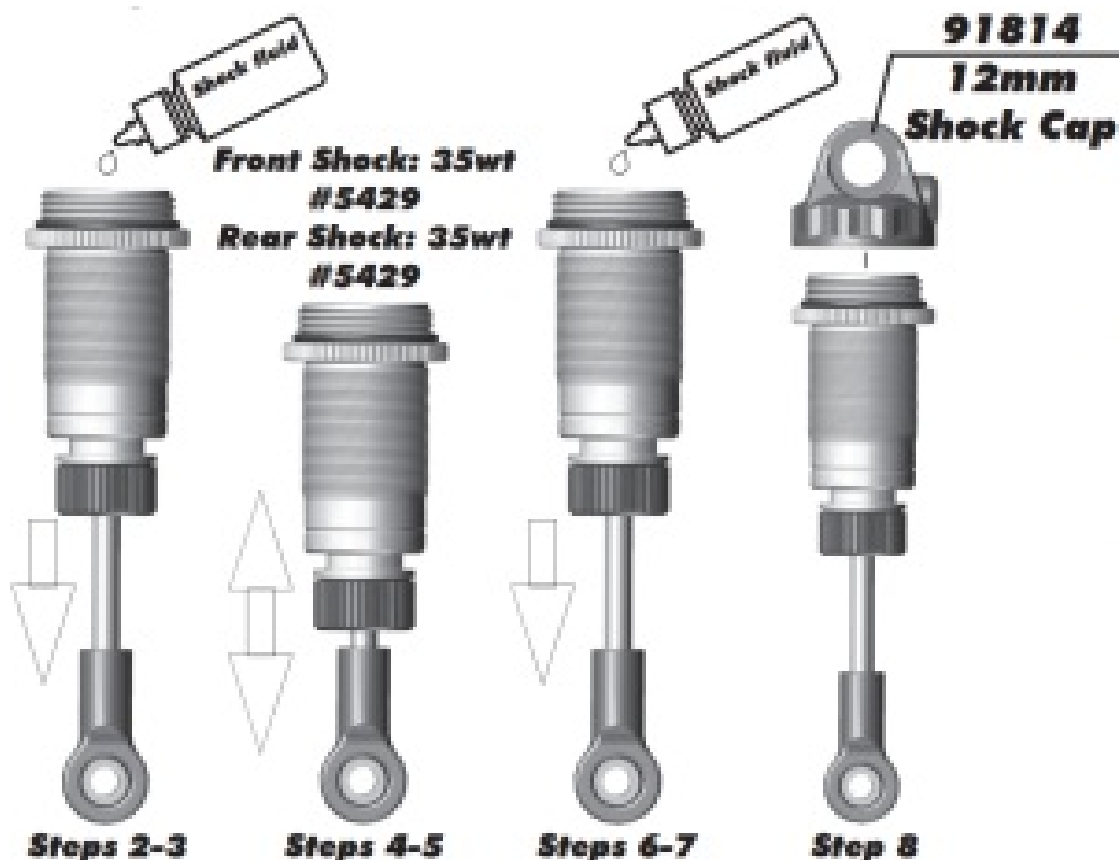

Shock Bleeding Steps:

1. Before assembly, get each bleed screw and thread it 1-2 turns into the shock cap, then remove the screw. This will make it easier when you are bleeding your shocks.
2. Pull shock shaft down.
3. Fill shock body 3/4 full with silicone shock fluid.
4. Slowly move the shock shaft up and down to remove air from under the piston.
5. Wait for bubbles to come to the surface.
6. Fill shock body to top with silicone shock fluid.
7. Place a drop of oil in the cap and on cap threads.
8. Install cap (without bleed screw) and tighten completely.
9. Slowly compress the shaft all the way to bleed excess silicone shock fluid out the hole in the cap (use rag around shock to catch excess fluid).
10. Install M2x4mm button head screw until snug while the shaft is fully compressed.

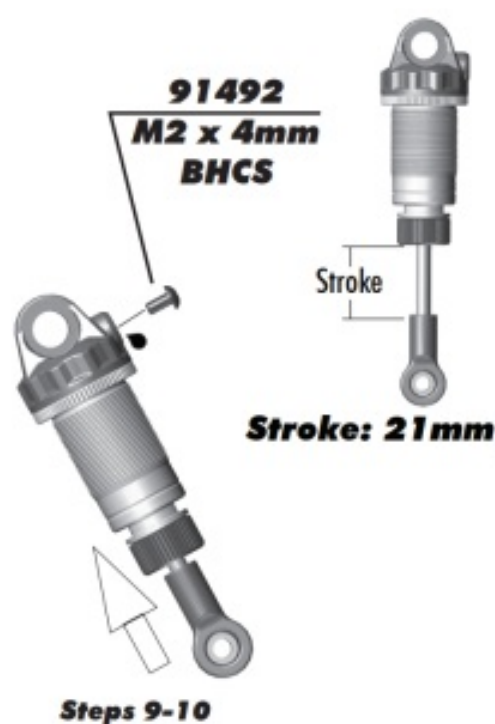

Refer to 3rd party conversion manual

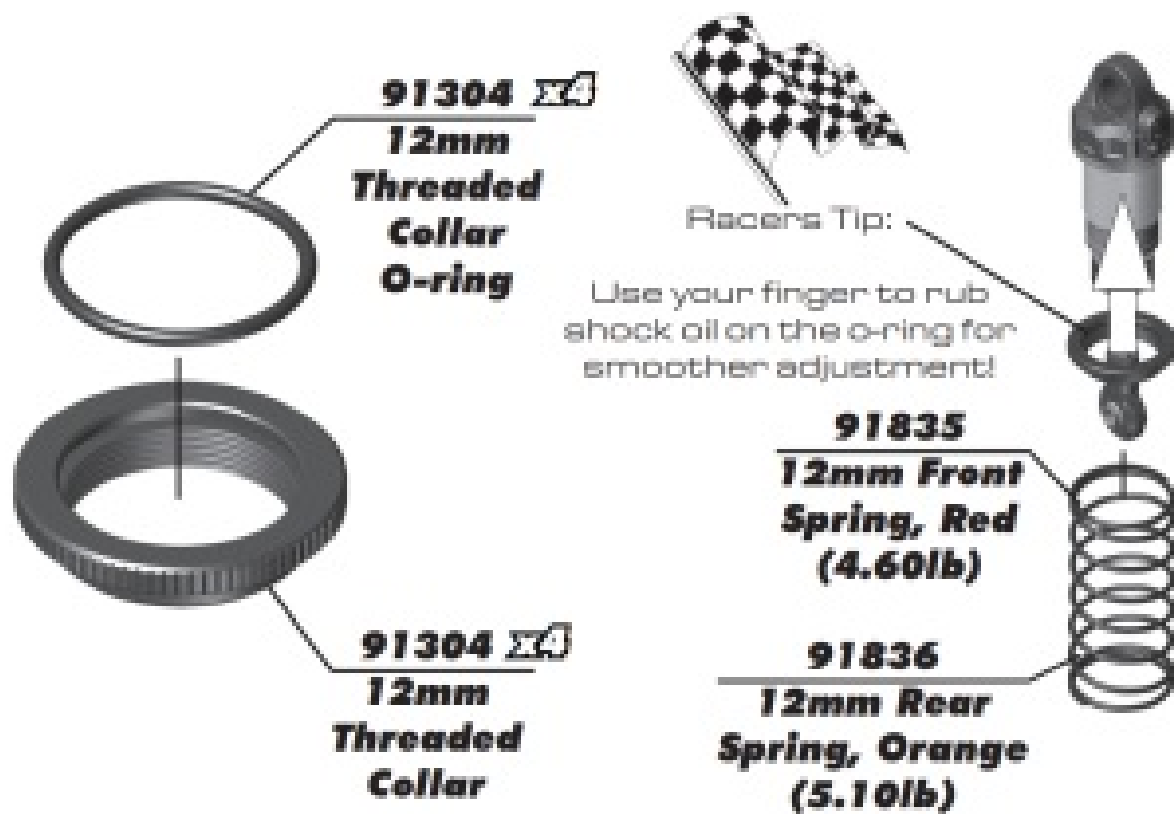

Refer to 3rd party conversion manual.



Slide spacers up. Install spring cup below up travel spacers.

**#91814 12mm Shock Spring Cups**



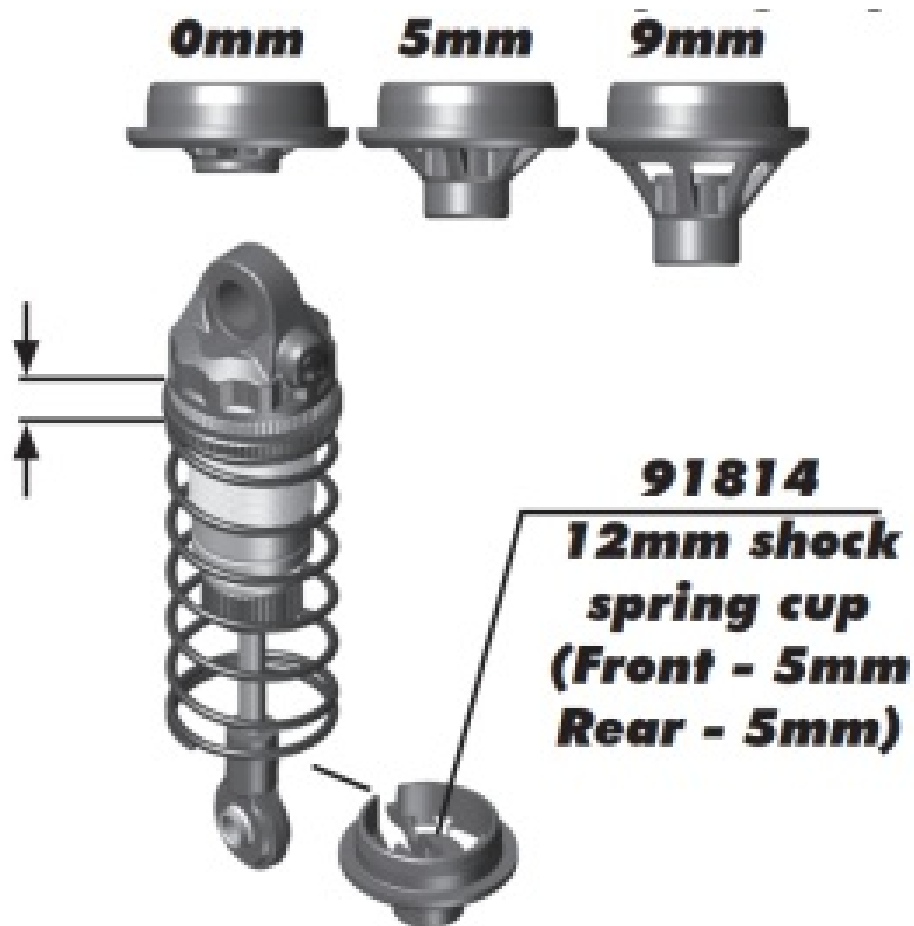

**Build x2 front and x2 rear shocks**

#### Documents / Resources

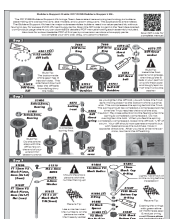

[ASSOCIATED RC10B6 Team Kit](#) [pdf] Installation Guide  
RC10B6, Team Kit