

20178 Team Associated Reflex Hoonicorn Instruction Manual



1:14 SCALE 4WD ON ROAD READY-TO-RUN



Contents

1 #20178 REFLEX 14R HOONICORN

- 1.1 :: Introduction
- 1.2 :: RC14R RTR Features
- 1.3 :: Notes
- 1.4 :: Additional
- 1.5 :: Other Helpful Items
- 1.6 :: Hardware – 1:1 Scale View
- 1.7 :: Quick Start Guide
 - 1.7.1 Battery Charging Steps and Safety:
 - 1.7.2 Battery Installation:
 - 1.7.3 Battery Notes and Tip:
 - 1.7.4 Radio System Tuning and Controls:
- 1.8 :: Step 1
- 1.9 :: Step 2
- 1.10 :: Step 3
- 1.11 :: Step 4
- 1.12 :: Step 5
- 1.13 :: Step 6
- 1.14 :: Step 7
- 1.15 :: Step 8
- 1.16 :: Step 9
- 1.17 :: Step 10
- 1.18 :: Step 11
- 1.19 :: Step 12
- 1.20 :: Step 13
- 1.21 :: Step 14
- 1.22 :: Step 15
- 1.23 :: Step 16
- 1.24 :: Step 17
- 1.25 :: Step 18
- 1.26 :: Step 19
- 1.27 :: Step 20
- 1.28 :: Step 21
- 1.29 :: Step 22
- 1.30 :: Step 23
- 1.31 :: Step 24
- 1.32 :: Step 25
- 1.33 :: Step 26
- 1.34 :: Step 27
- 1.35 :: Step 28
- 1.36 :: Step 29
- 1.37 :: Step 30
- 1.38 :: Step 31
- 1.39 :: Step 32
- 1.40 :: Step 33

2 Documents / Resources

2.1 References

3 Related Posts

#20178 REFLEX 14R HOONICORN





:: Introduction

Thank you for purchasing this Team Associated product. This assembly manual contains instructions and tips for building and maintaining your new vehicle. Please take a moment to read through the manual and familiarize yourself with the steps.

We are continually changing and improving our designs; therefore, actual parts may appear slightly different than the illustrations.

New parts will be noted on supplementary sheets located in the appropriate parts bags. Check each bag for these sheets before you start to build.

:: RC14R RTR Features

- Reflex 14R with licensed 1965 Ford Mustang Hoonigan Hoonicorn and officially licensed American Racing VF503 Wheels
- Injection molded brake calipers and rotors with 12mm hex
- 2.4GHz 2-channel radio system
- Reedy brushed speed control and 3-pole brushed motor
- High-Torque Digital Servo with spring-style servo saver
- Molded front universals and rear dog bones
- Sealed front and rear gear differentials
- Center spool with 58T spur (70T included) and protective cover
- Bushings with Oilite® coating
- Molded one-piece tie rods and steering links
- Adjustable body post height locations
- Molded front and rear shock towers with adjustable shock positions
- Fluid damped coilover shock absorbers
- Molded tub chassis with covered center driveshaft
- Adjustable battery tray
- Aluminum center driveshaft
- Serrated wheel screw with 2.0mm hex and 5.5mm nut drive
- Foam front bumper

:: Notes



There is a 1:1 hardware foldout page in the front of the manual. To check the size of a part, line up your hardware with the correct drawing until you find the exact size. Each part in the foldout has a number assigned to it for ordering replacement parts.



This symbol indicates a special note or instruction in the manual.

:: Additional

Your new Reflex 14R RTR comes assembled. The following items are needed for completion

- 6-cell NiMh or 2 LiPo battery
- Suitable battery charger
- (4) AA batteries

Tools included:

- Multi-wrench

:: Other Helpful Items

- Silicone Shock Fluid
- Reamer / Hole Punch (#1499)
- Wire Cutters
- Needle Nose Pliers
- FT Dual Turnbuckle Wrench (#1114)
- Silicone Diff Fluid
- Shock Pliers (#1681)
- Soldering Iron
- Hobby Knife
- FT Universal Tire Balancer (#1498)
- Body Scissors (AE Part # 1737)
- FT Hex/Nut Wrenches (AE Part # 1519)
- Green Slime shock lube (AE Part # 1105)
- Calipers or a Precision Ruler

**Associated Electrics, Inc.
21062 Bake Parkway
Lake Forest, CA 92630**



**Customer Service
Tel: 949.544.7500
Fax: 949.544.7501**

:: Hardware – 1:1 Scale View

Cap Head (shcs)

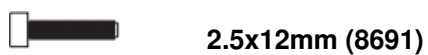

2.5x12mm (8691)

Button Head (bhcs)

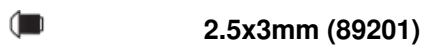

2.5x3mm (89201)

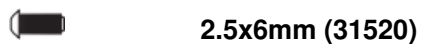

2.5x6mm (31520)



3x6mm (31531)

Button Head (bhst)

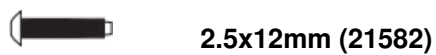

2.5x12mm (21582)



2.6x6mm (21546)

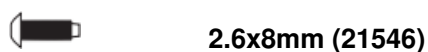

2.6x8mm (21546)

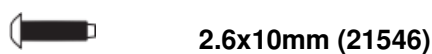

2.6x10mm (21546)

Pin



1.5x3.8 (21516)

Flat Head (fhcs)

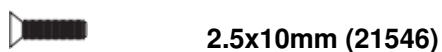

2.5x10mm (21546)

Flat Head (fhst)

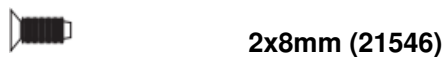

2x8mm (21546)

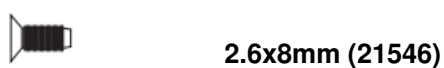

2.6x8mm (21546)

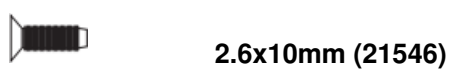

2.6x10mm (21546)

Set Screws

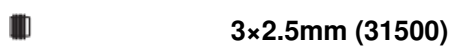

3x2.5mm (31500)



3x3mm (25225)



3x8mm (4670)

Nuts (lock/plain)



M2.5 Locknut (89215, 21546)

Bushings



4x7x2.5mm (21580)



4x8x3mm (21580)



7x11x3mm (21580)



8x12x3.5mm (21580)

Shims and Washers



2.7x6.7x0.5mm (21546)



4x8x0.5mm (21516)

Notes:

:: Quick Start Guide

Battery Charging Steps and Safety:

Remove the battery from the vehicle before charging.

Place battery on a fire resistant surface.

Avoid any contact with water or other liquids.

Be sure to select the correct charging mode for the type of battery you are charging.

ALWAYS use a compatible charger for charging your batteries.

Caution: Never leave the battery unattended while charging.

Always disconnect the charger from the power source when finished charging.

Caution: Always disconnect the battery when you are finished driving the vehicle.



**Peak Detection
Quick Charger**

Battery Installation:

1. Install the battery with the battery wires directed towards the rear of the vehicle.
2. Secure the battery strap using two body clips.

1

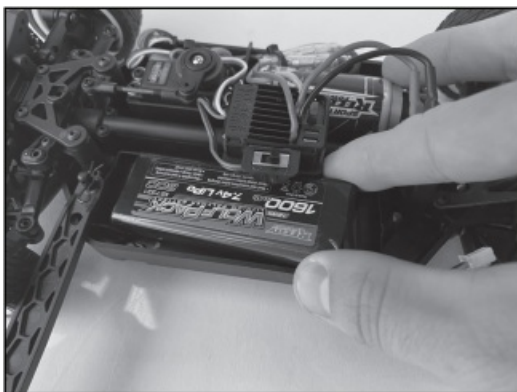

2

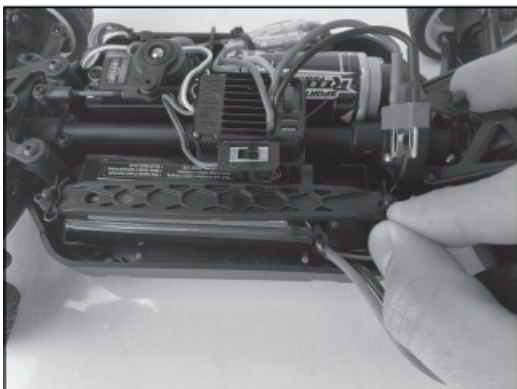

Battery Notes and Tip:

Connect the battery as shown.

Disconnect the battery when not in use!

LiPo: LiPo batteries (lithium polymer) are high current rechargeable batteries. LiPo batteries offer extended run time and peak performance over NiMH batteries. They require a peak detection charger designed specifically for LiPo batteries.

These batteries require special care and handling.

LiPo batteries are recommended for advanced users only!

ALWAYS charge a LiPo battery in LiPo mode.

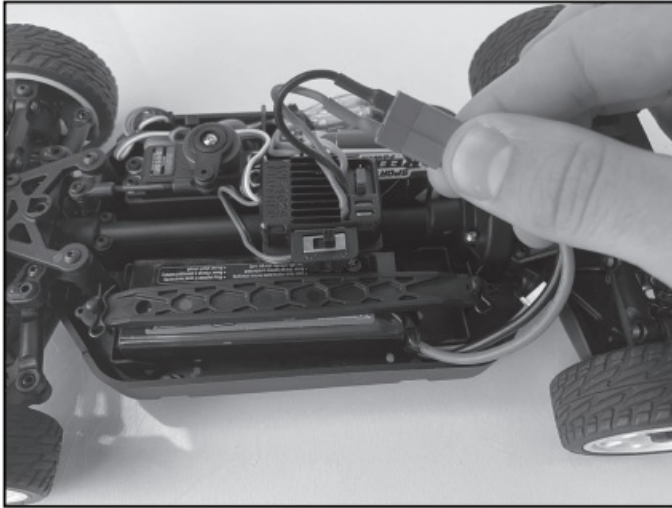

Radio System Tuning and Controls:

RULE: Transmitter on First/Vehicle on Second, Vehicle off First/ Transmitter off Last!

- 1) Slide the battery cover to remove cover.
- 2) Install alkaline or rechargeable AA size batteries into the battery holder.
- 3) Slide the battery cover back into place making sure it is completely closed and secure.
- 4) Turn the power ON. If the power indicator LED fails to light, check the batteries for insufficient contact or incorrect polarity.





On/Off Switch

DO NOT hold the trigger when turning on the radio.

If using optional battery for transmitter, be sure to plug it in correctly. Plugging in a battery backwards can cause damage.

Refer to Radio owners manual for more in-depth instructions on radio operation and functions.



Throttle set to Neutral!

1. **Push trigger for Brake**
2. **Neutral**
3. **Pull trigger for Throttle**



1. **Adjust steering trim with this knob so wheels point straight.**

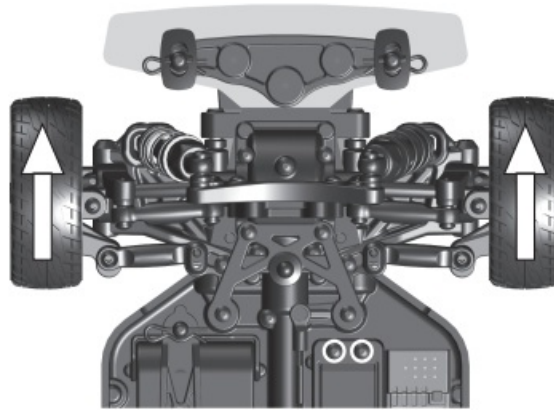

**Install body and body clips.
Ready to go!**

:: Step 1

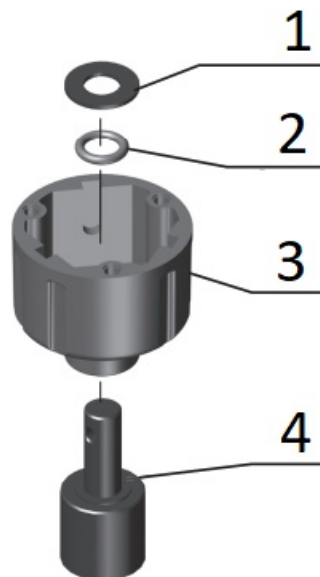

1. **21516**
Washer
4x8x0.5mm
2. **21530**
O-Ring
3.8 x 1mm
3. **21529**
Diff case
4. **21524**
Diff outdrive

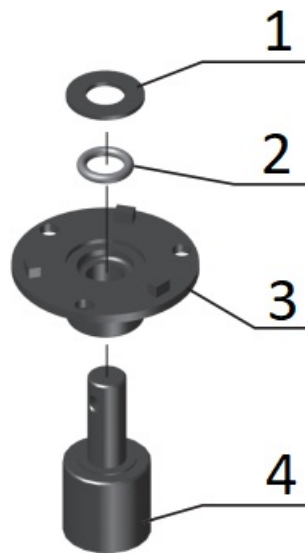

1. 21516
Washer
4x8x0.5mm
2. 21530
O-Ring
3.8 x 1mm
3. 21529
Diff cap
4. 21524
Diff outdrive

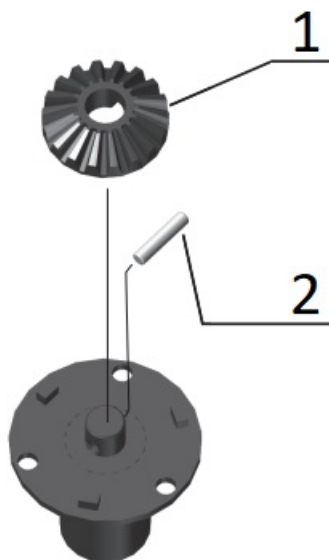

1. 21529
Diff sun gear
2. 21516
Pin
1.5 x 6mm

:: Step 2

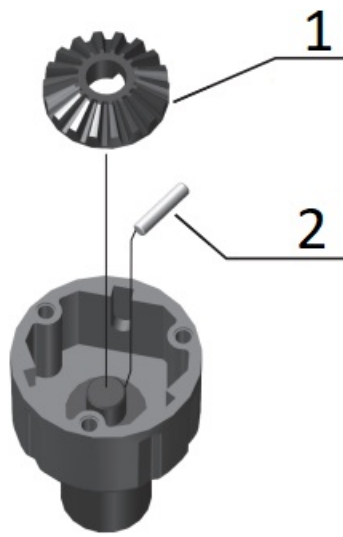

1. 21529
Diff sun gear
2. 21516
Pin
1.5 x 6mm



1. 21529
Diff cross pin
2. 21529 x3
Diff planetary gear



:: Step 3

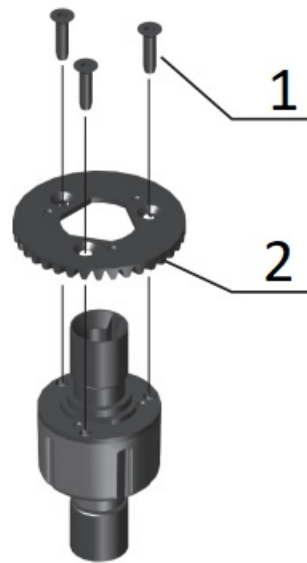

- 1. 21546 x3
M2x8mm
FHST
- 2. 21526
Diff ring gear (37T)

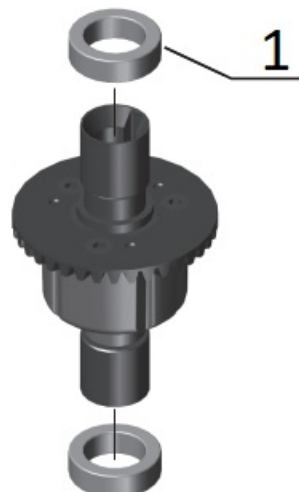

1. 21580 x2
8x12x3.5mm
bushing

Build 2 (1 front, 1 rear)

:: Step 4



Install pin before installing outdrive into spool mount!

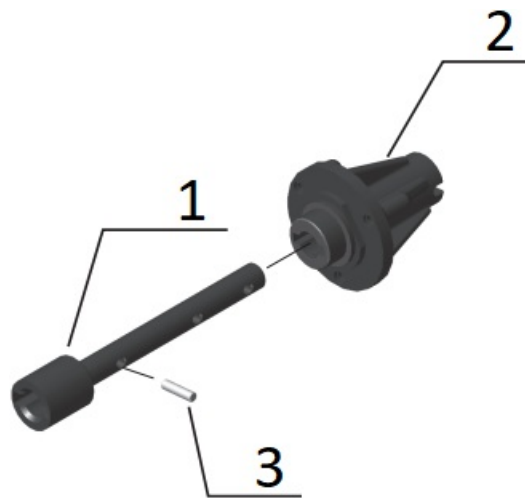

1. 21577
Center outdrive
2. 21573
Spur gear spool mount
3. 21516
Pin
1.5 x 6mm

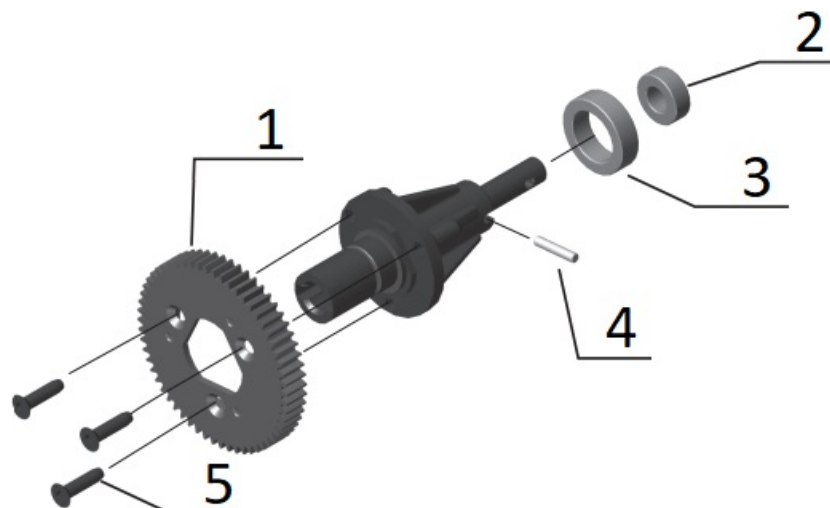

1. 21527
Spur gear, 58T (Kit)
Spur gear 70T (Included)
2. 21580
4x8x3mm
bushing
3. 21580
8x12x3.5mm
bushing
4. 21516
Pin
1.5 x 6mm
5. 21546 x3
M2x8mm
FHST



Install pin before bushing!

:: Step 5

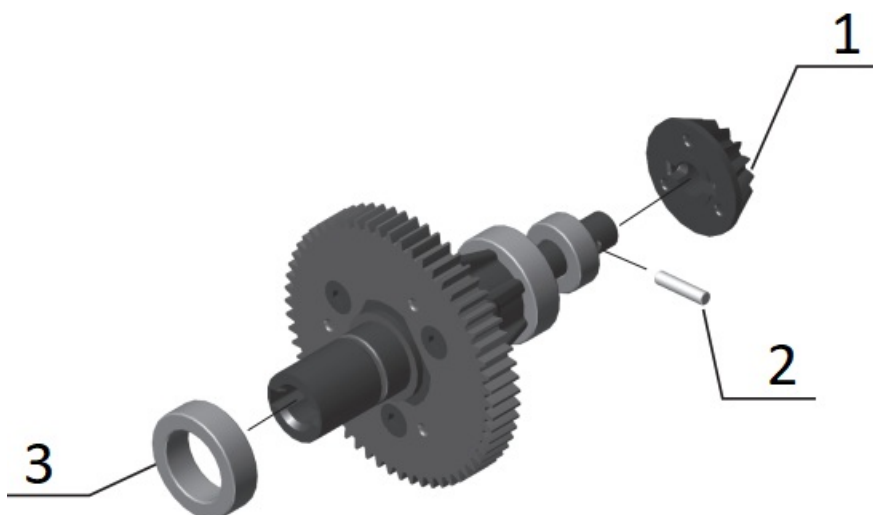

1. 21526
Pinion gear (15T)
2. 21516
Pin
1.5 x 6mm
3. 21580
8x12x3.5mm
bushing

:: Step 6



Top of set screw head should be flush with the top of the chassis

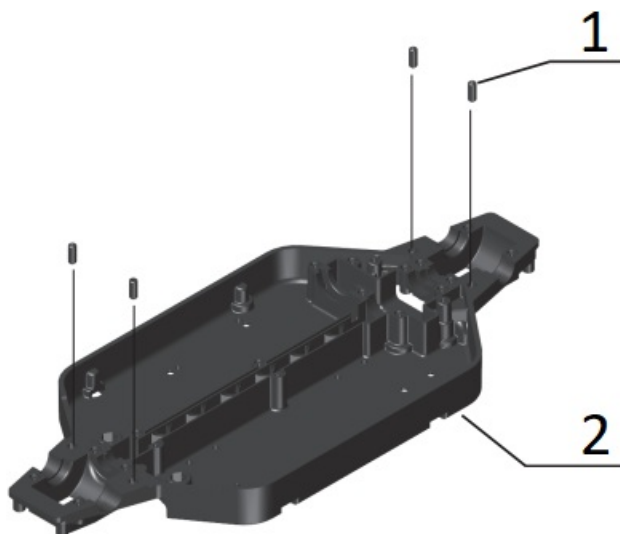

1. 4670 x4
3x8mm
set screw
2. 21570
Chassis

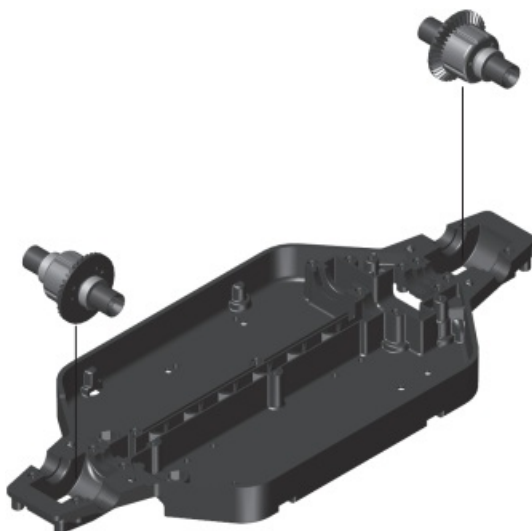

:: Step 7

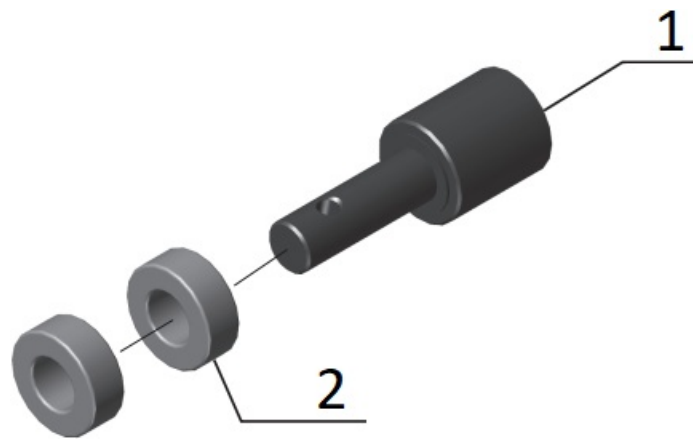

1. 21577
Outdrive center, front
2. 21580 x2
4x8x3mm
bushing

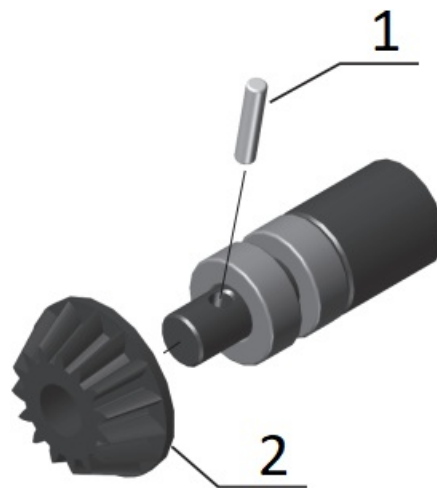

1. 21516
Pin
1.5 x 6mm
2. 21526
Pinion gear (15T)

:: Step 8

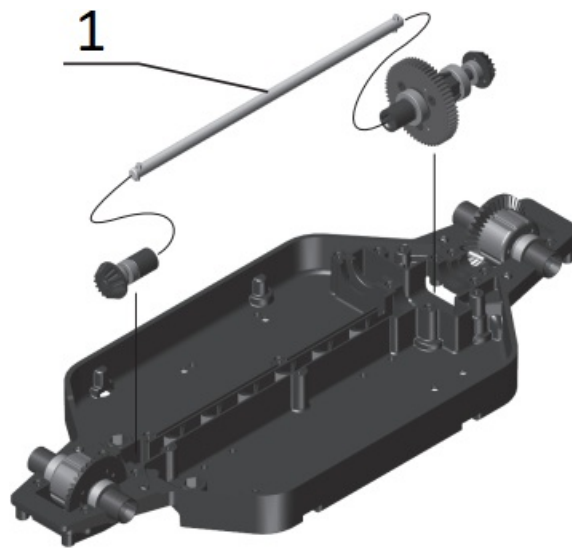

1. 21577
Drive shaft

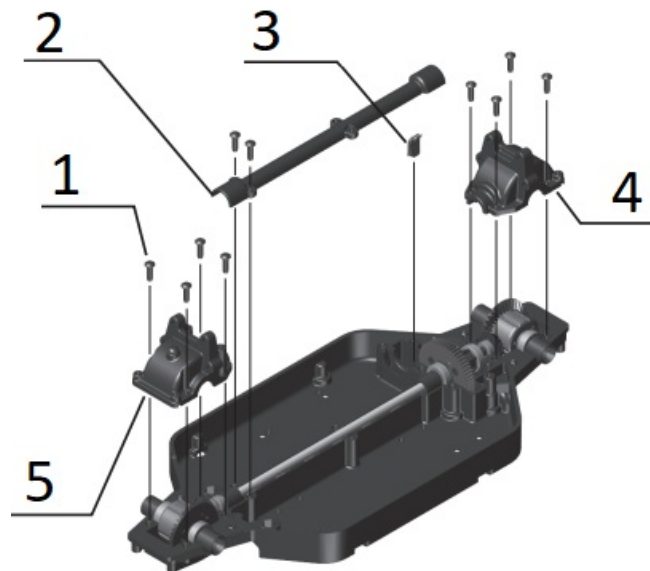

1. 21546 x10
M2.6x8mm
BHST
2. 21504
Drive shaft cover
3. 21504
Drive shaft cap
4. 21504
Gear box cap, rear
5. 21504
Gear box cap, front

:: Step 9

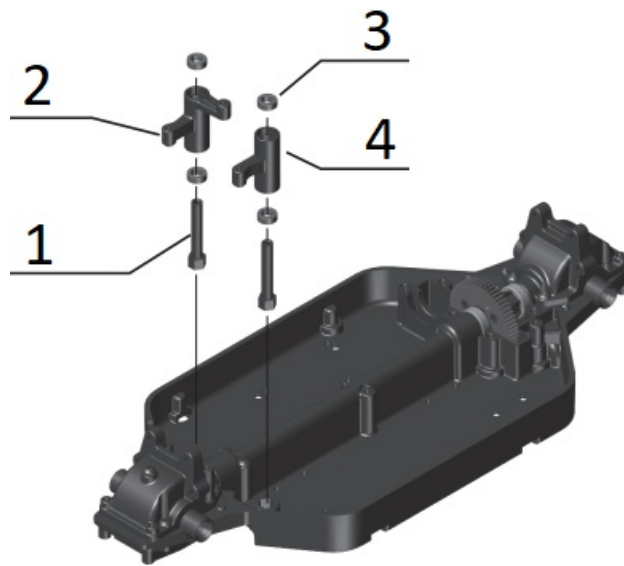

- 1. 21510 x2
Steering post
- 2. 21505
Steering bellcrank (right)
- 3. 31732 x4
4x7x2.5mm
bearing
- 4. 21505
Steering bellcrank (left)

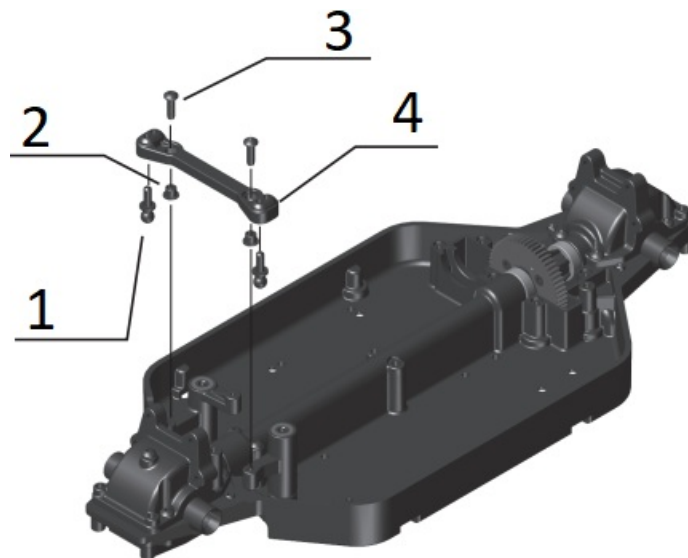

- 1. 21522 x2
Ball stud
12.5mm
- 2. 21509 x2
Hat bushing
- 3. 21546 x2
M2.6x8mm
BHST

4. 21573

Steering rack

:: Step 10

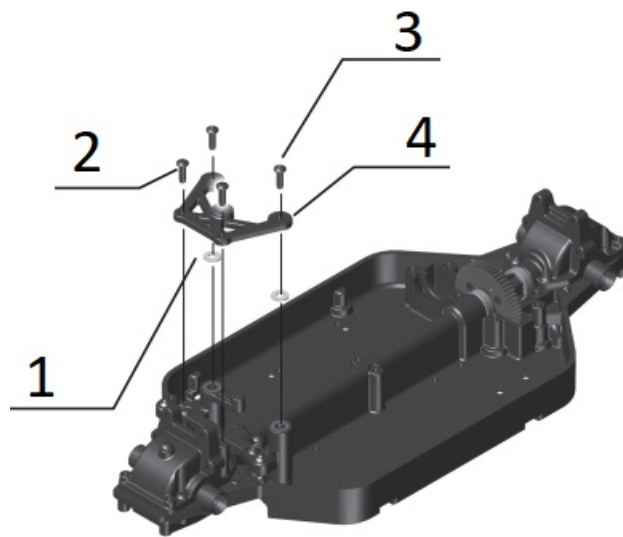

1. 21546 x2

Washer

2.7×0.5mm

2. 21546 x2

M2.6x8mm

BHST

3. 31520 x2

M2.5x6mm

BHCS

4. 21504

Top plate

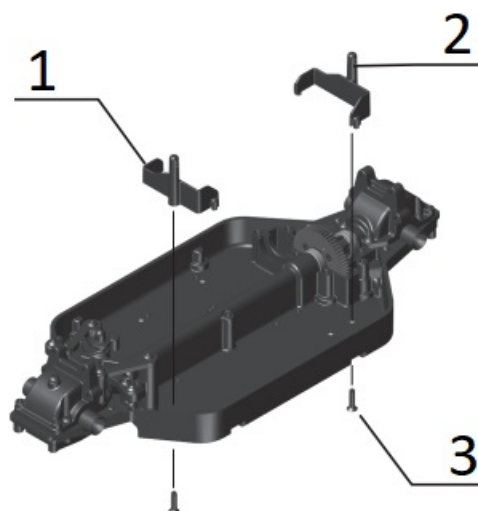

1. 21505

Battery Mount, (front)

2. 21505

Battery Mount, (rear)

3. 21546 x2

M2.5x10mm

FHCS

:: Step 11

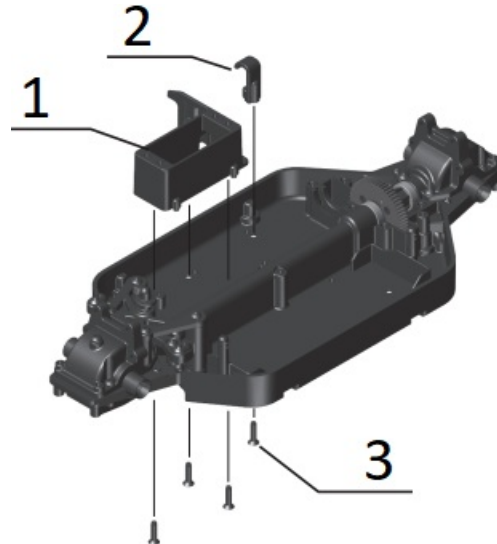

1. 21505

Servo Mount

2. 21505

Wire clip

3. 21546 x4

M2.5x10mm

FHCS

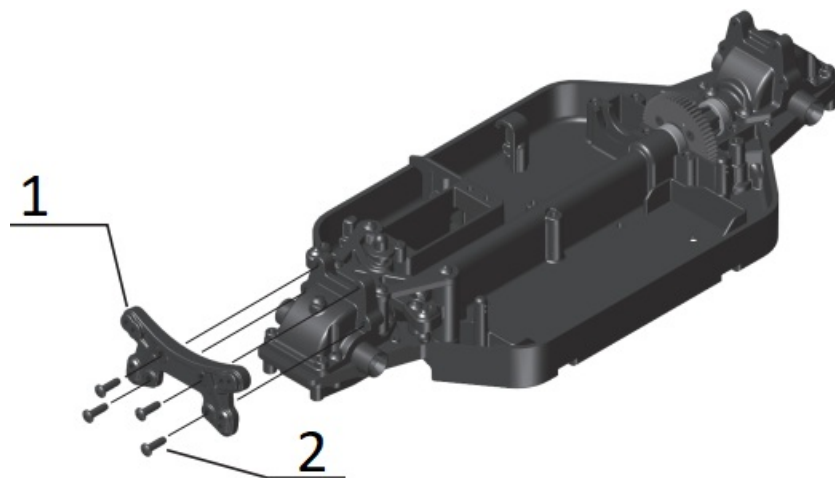

1. 21573

Shock tower, front

2. 21546 x4

M2.6x8mm

BHST

:: Step 12

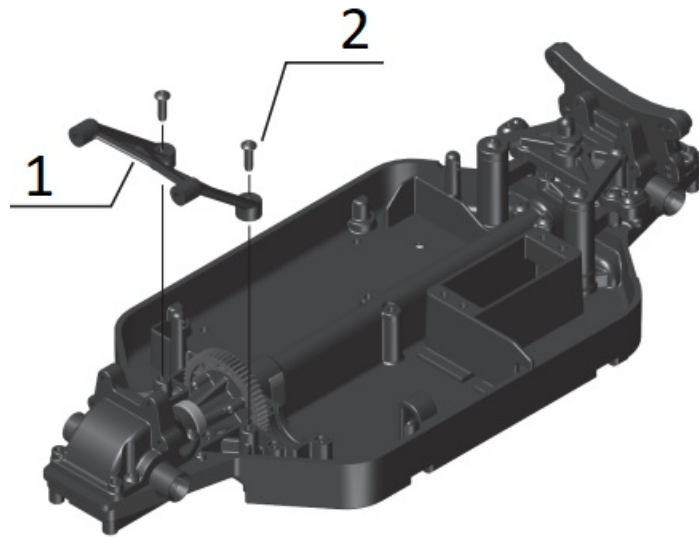

1. 21573
Shock tower support, rear
2. 21546 x2
M2.6x10mm
BHST

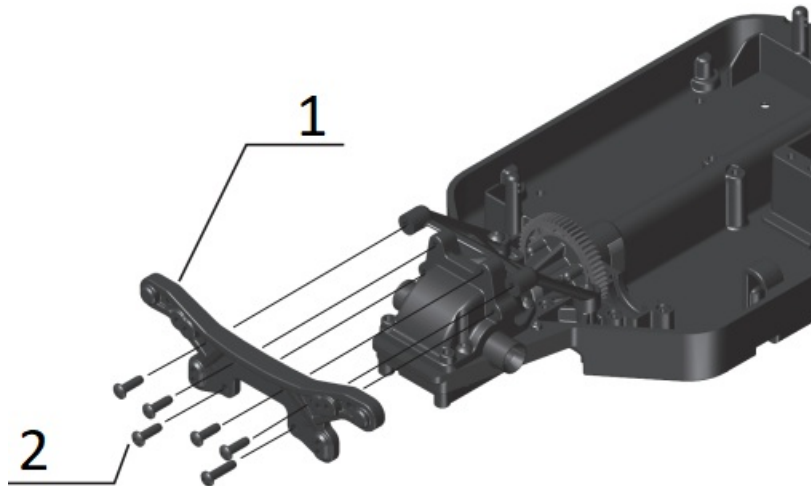

1. 21573
Shock tower, rear
2. 21546 x6
M2.6x8mm
BHST

:: Step 13

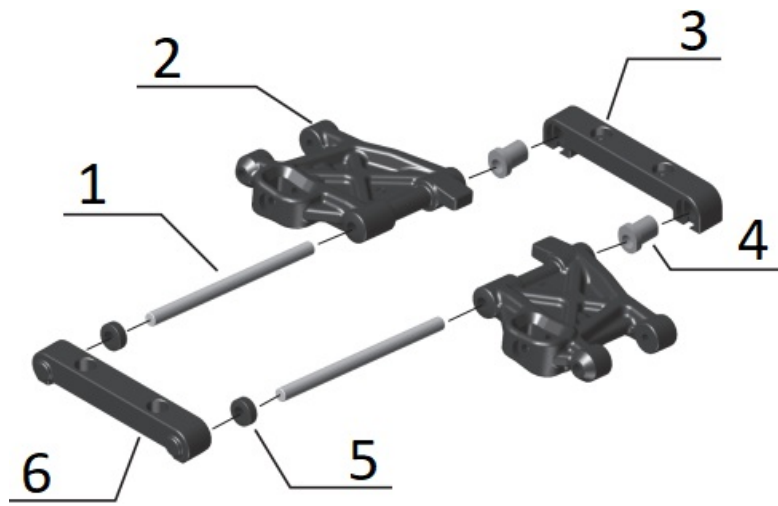

1. 21579 x2
Inner hinge pin, 3x47mm
2. 21574 x2
Front suspension arms
3. 21501
Arm mount, B
4. 21501 x2
Arm mount bushing
5. 21574 x2
Front arm spacers
6. 21501
Arm mount, A

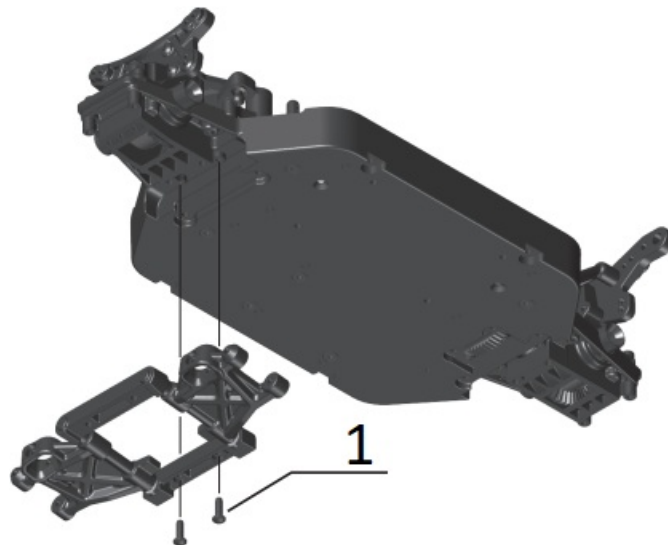

1. 21546 x2
M2.6x8mm
BHST

:: Step 14

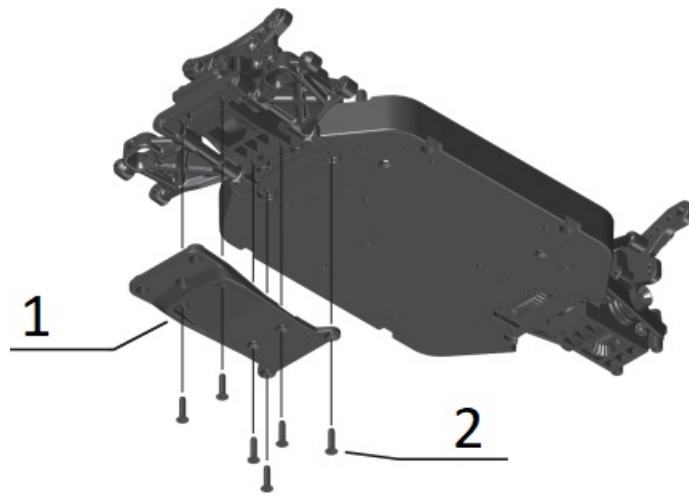

1. 21573
Skid plate, front
2. 21546 x6
M2.5x10mm
FHCS

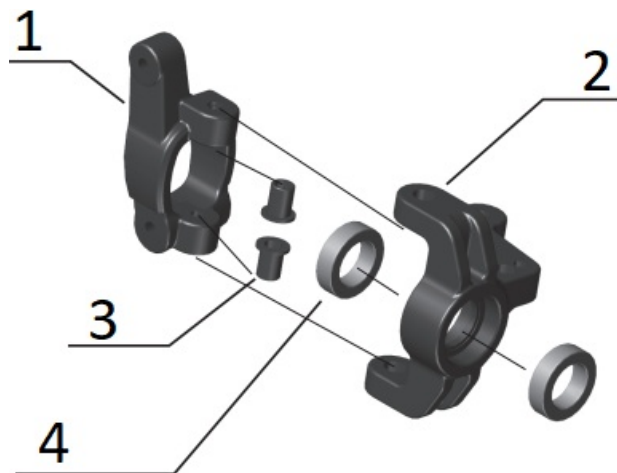

1. 21575
Caster block, left
2. 21575
Steering block, left
3. 21523 x2
Caster block bushings
4. 21580 x2
7x11x3mm
bushing

Build left and right sides!

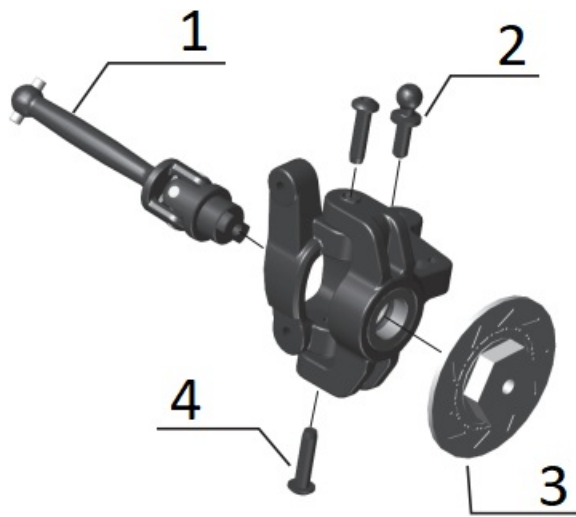

1. 21576
Universal drive shaft
2. 21522 x2
Ball stud
12.5mm
3. 21575
Wheel hex
4. 21546 x2
M2.6x10mm
BHST

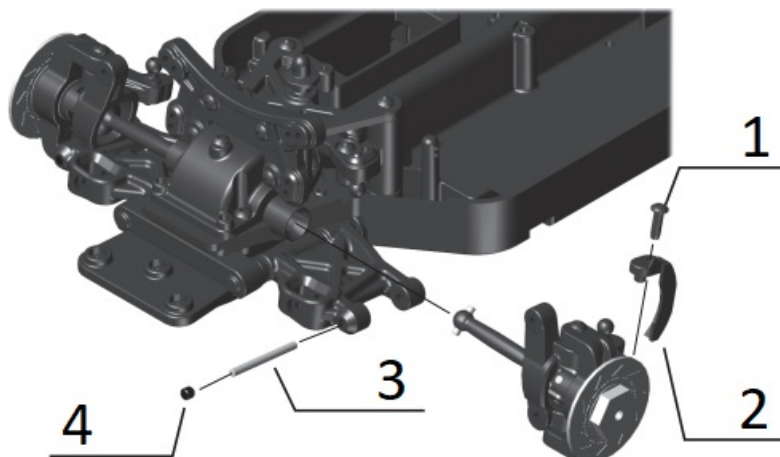

1. 21546
M2.6x8mm
BHST
2. 21575
Brake caliper
3. 21579
Outer hinge pin, 2x22mm
4. 25225
M3x3mm
set screw

:: Step 16

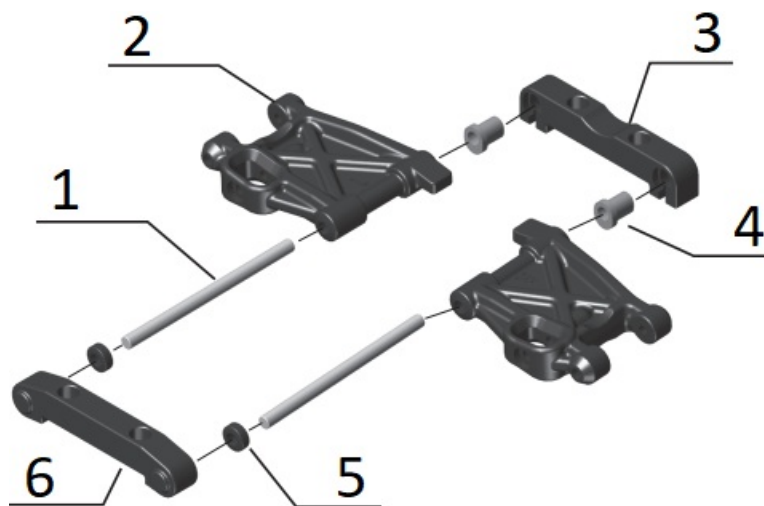

1. 21579 x2
Inner hinge pin, 3x47mm
2. 21574 x2
Rear suspension arms
3. 21501
Arm mount, C
4. 21501 x2
Arm mount bushing
5. 21574 x2
Rear arm spacers
6. 21501
Arm mount, D

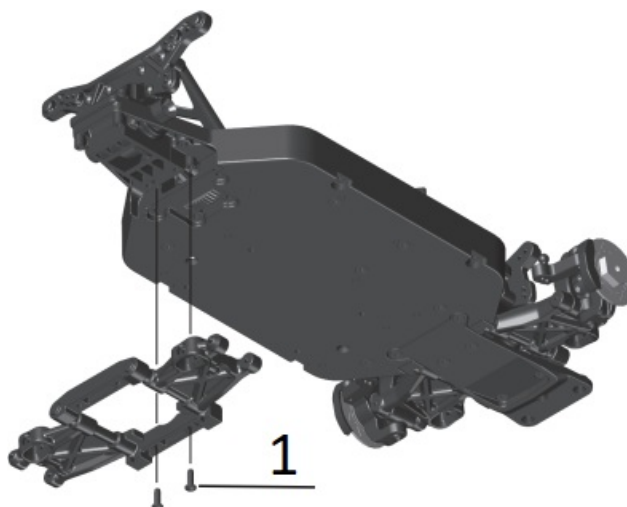

1. 21546 x2
M2.6x8mm
BHST

:: Step 17

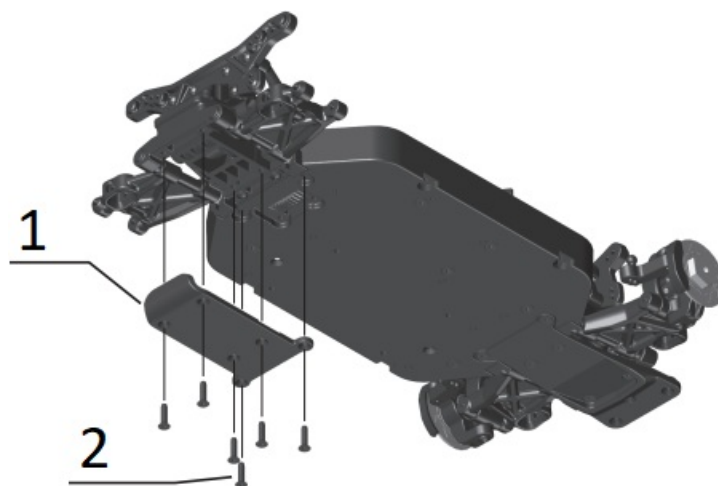

1. 21501
Skid plate, rear
2. 21546 x6
M2.5x10mm
FHCS

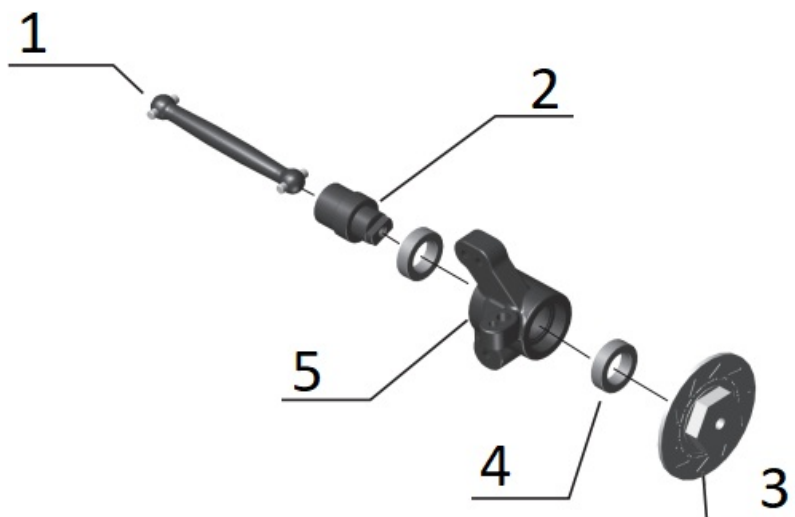

1. 21576
Dog bone, rear
2. 21577
Axle, rear
3. 21575
Wheel hex
4. 21580 x2
7x11x3mm
bushing
5. 21575
Rear hub, right

:: Step 18

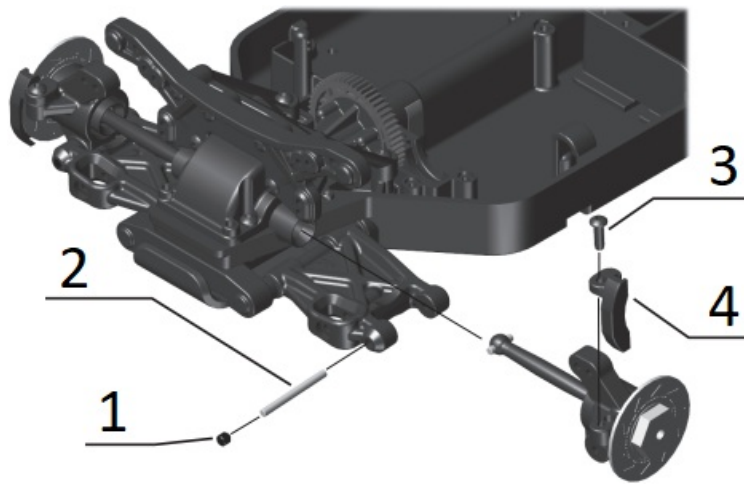

1. 25225
M3x3mm
set screw
2. 21579
Outer hinge pin, 2x22mm
3. 21546
M2.6x8mm
BHST
4. 21575
Brake caliper

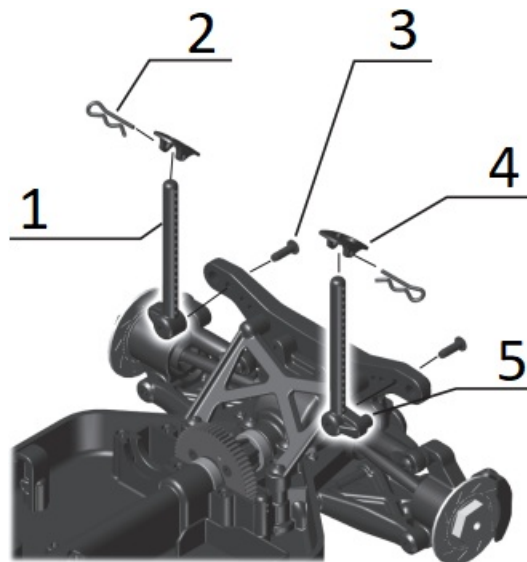

1. 21574 x2
Body post, rear, right
2. 21173 x2
Body clip
3. 21546 x2
M2.6x8mm
BHST
4. 21574 x2

Body post stand

5. 21574 x2

Body post, rear, left

Build left and right sides!

:: Step 19

Build x2 (right and left side)

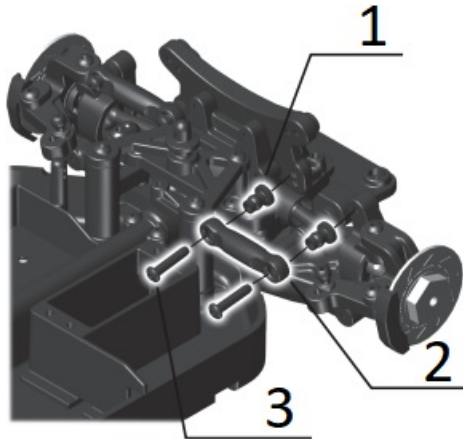

1. 21577 x2

Ballstud

4.3mm

2. 21574

Rod end link

3. 21582 x2

M2.5x12mm

BHST

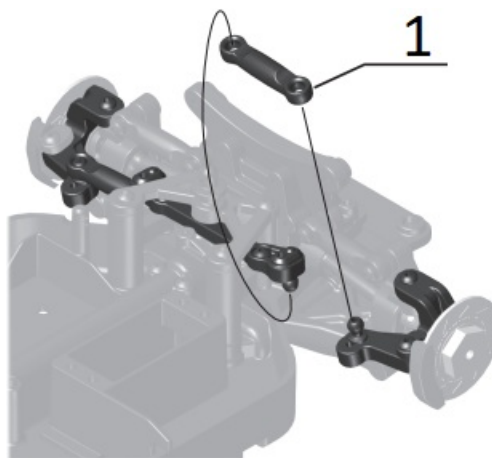

1. 21574

Rod end link

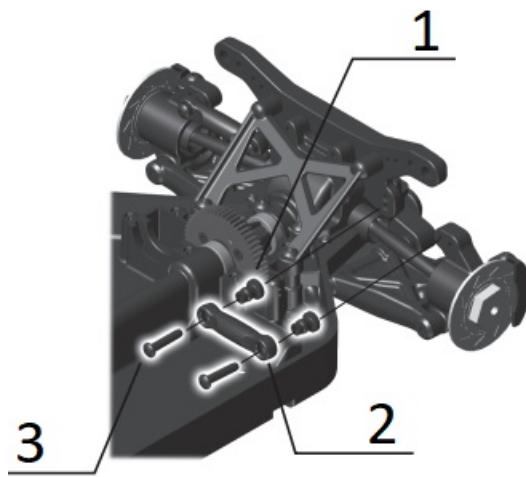

1. 21577 x2

Ballstud

4.3mm

2. 21574

Rod end link

3. 21582 x2

M2.5x12mm

BHST

:: Step 20

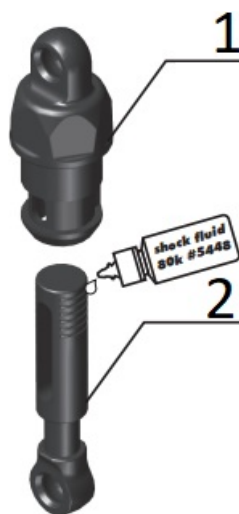

1. 21571

Shock body

2. 21571

Shock shaft

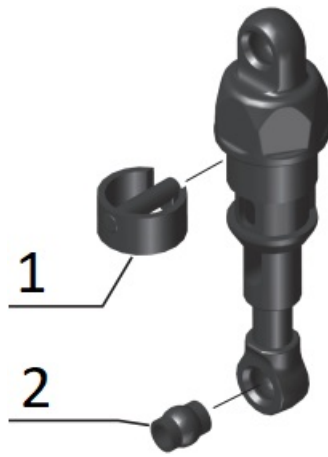

1. **21571**
Shock holder
2. **21577**
Rod end ball, 4.3mm



1. **21571**
Shock spring collar
2. **21572**
Shock spring



1. **21571**

Shock Spring cup

Build x4 (x2 front, x2 rear)

:: Step 21

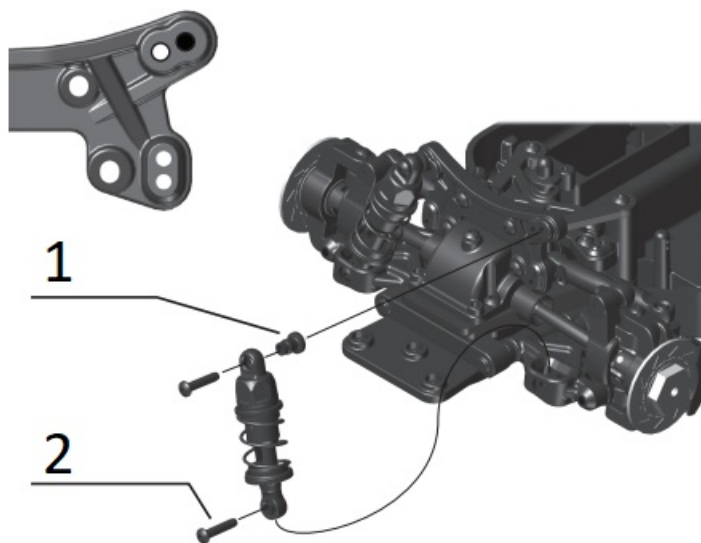

1. 21577
Ballstud, 4.3mm
2. 21582 x2
M2.5x12mm
BHCS

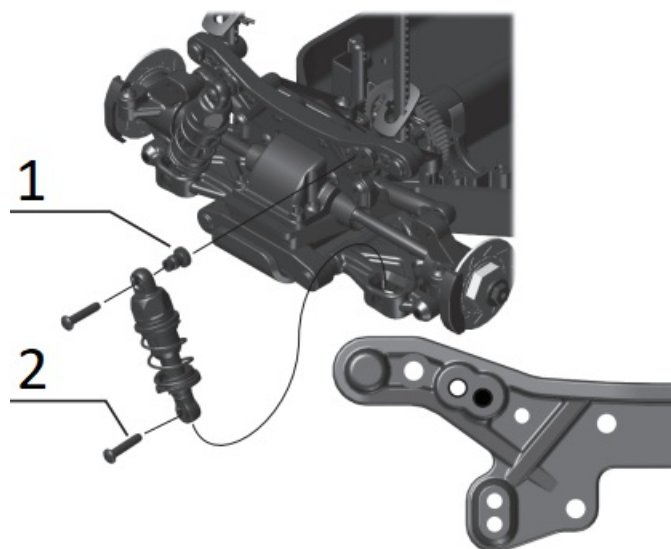

1. 21577
Ballstud, 4.3mm
2. 21582 x2
M2.5x12mm
BHCS

Build x2 (right and left side)

:: Step 22

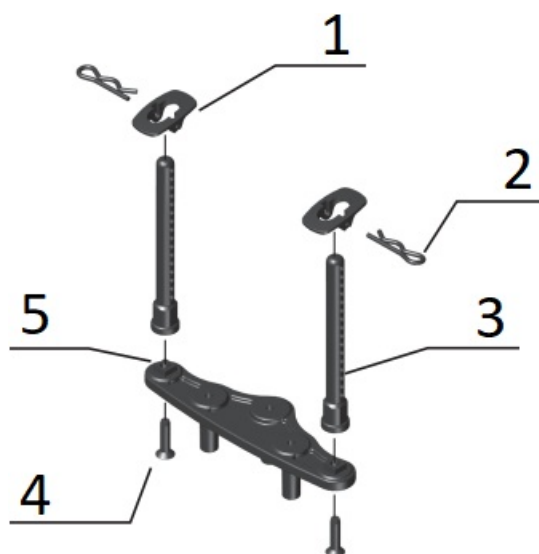

- 1. 21574 x2
Body post stand
- 2. 21173 x2
Body clip
- 3. 21574 x2
Body post, front
- 4. 21546 x2
**M2.5x10mm
FHCS**
- 5. 21573
Front bumper mount

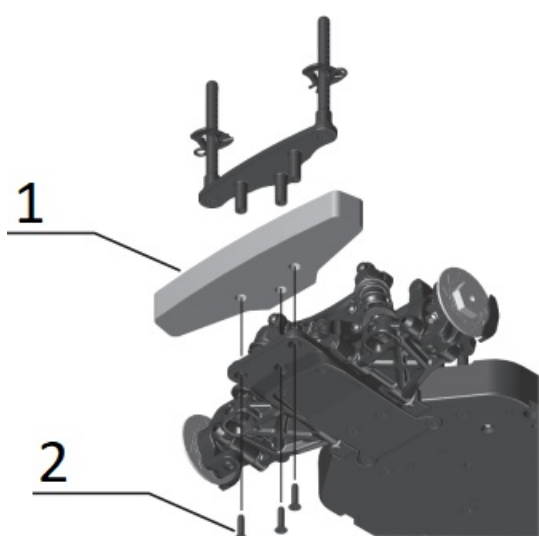

- 1. 21573
Front bumper foam
- 2. 21546 x3
M2.5x10mm

FHCS

:: Step 23

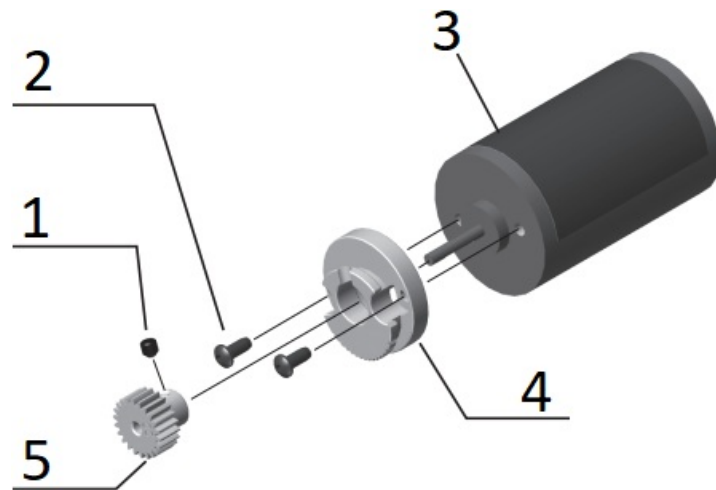

1. 31500
M3x2.5mm
set screw
2. 31520 x2
M2.5x6mm
BHCS
3. Brushed motor
4. 21531
Motor mount cam
5. 21532
Pinion gear, 16T

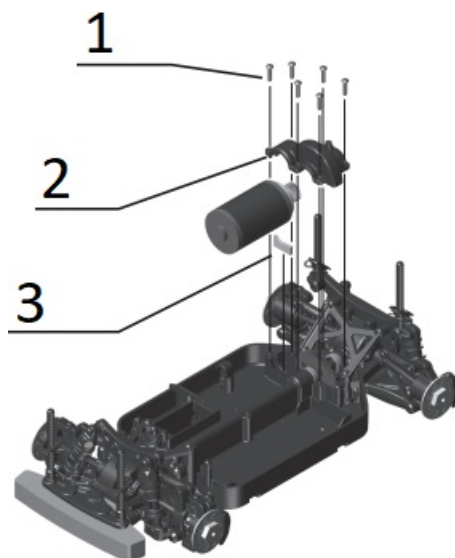

1. 21546 x6
M2.6x10mm
BHST, silver

2. **21504**

Center diff cap

3. **21531**

Motor mount insert

:: Step 24

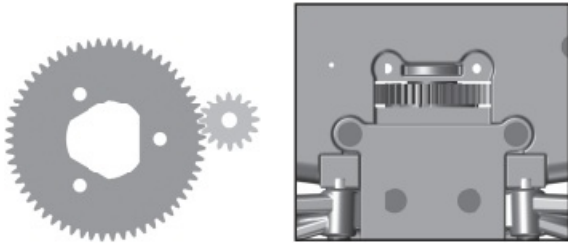

Set The Gear Mesh:

To set the gear mesh, push the teeth of the motor mount cam #21531 into the corresponding tooth pattern of the motor mount insert. Once the teeth are seated, you should be able to rock the spur gear back and forth without making the pinion gear move.

Excessive amounts of spur gear movement (loose gear mesh) will cause premature gear failure. If the spur gear mesh is tight, there will be no movement between the spur and pinion gears. A gear mesh that is too tight or too loose will reduce power and damage the gear teeth.

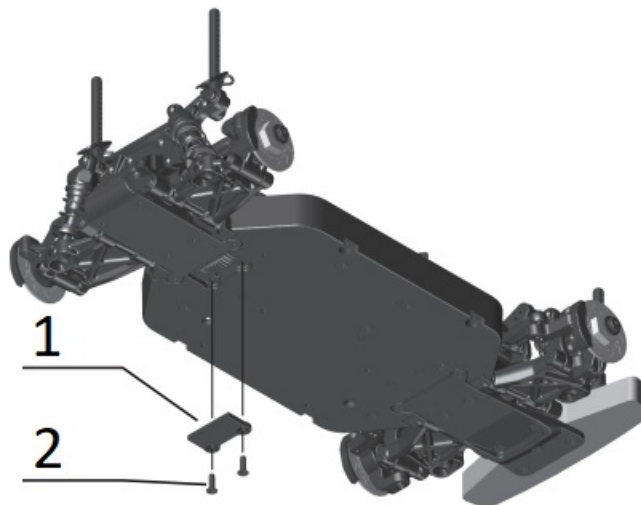

1. **21501**

Bottom spur cap (58T)

2. **21546** x2

M2.5x8mm

FHST

:: Step 25



1. **21514** x2
Steering link ball Cup
2. **21513**
Steering link rod

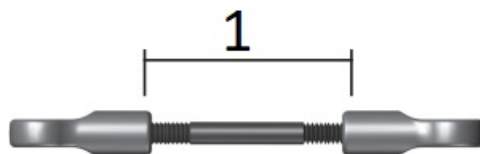

1. **Steering Link**
17.40mm

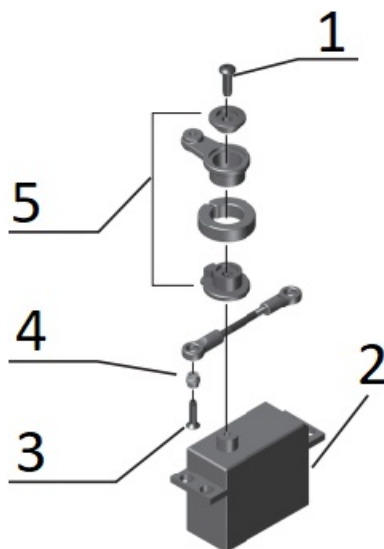

1. **21546**
M2.6x8mm
BHST
2. **Steering servo**
3. **21546**
M2x8mm
FHST
4. **21522**
Pivot ball
5. **21505**
Servo saver

:: Step 26

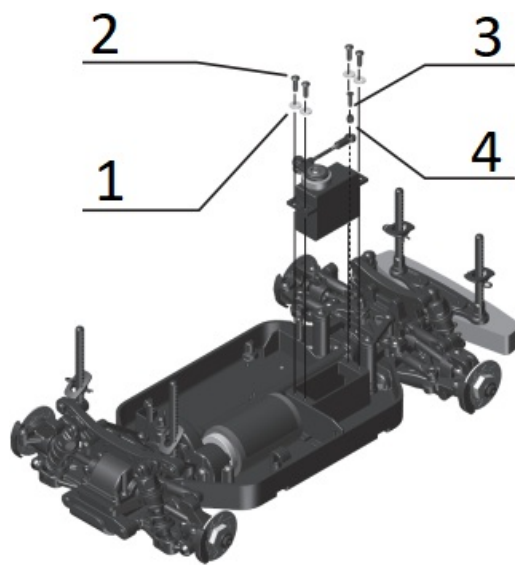

1. 21546 x4
Washer
2.7×0.5mm
2. 21546 x4
M2.6x8mm
BHST
3. 21546
M2x8mm
FHST
4. 21522
Pivot ball

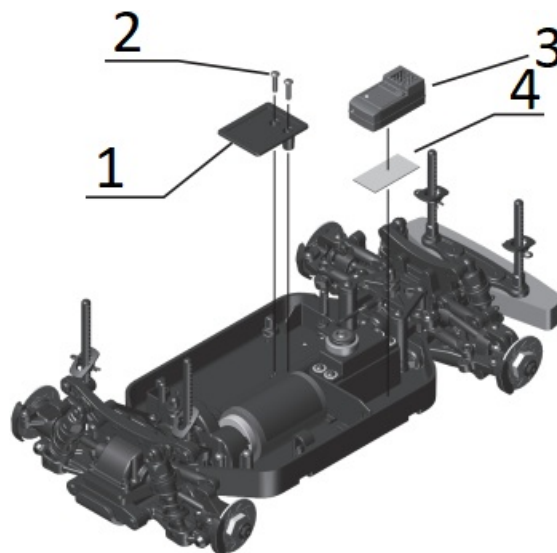

1. 21505
ESC mount
2. 21546 x2
M2.6x10mm
BHST
3. Receiver

4. 6727

Servo tape

:: Step 27

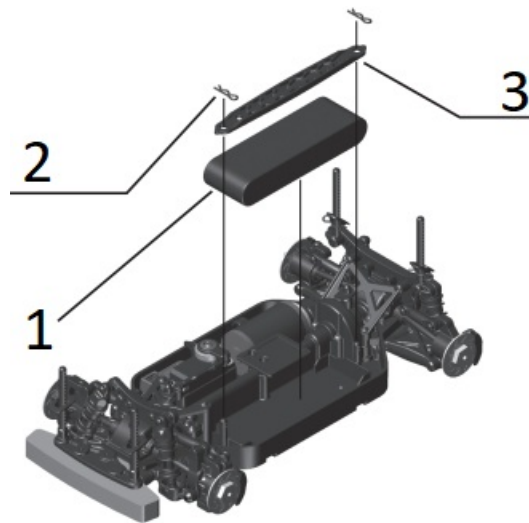

1. Battery

2. 21173 x2

Body clips

3. 21505

Battery strap

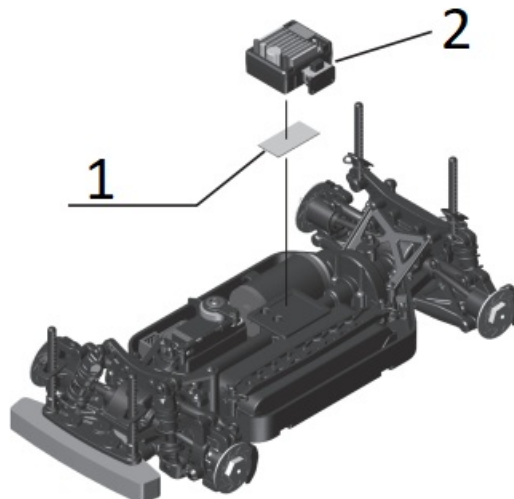

1. 6727

Servo tape

2. ESC

:: Step 28

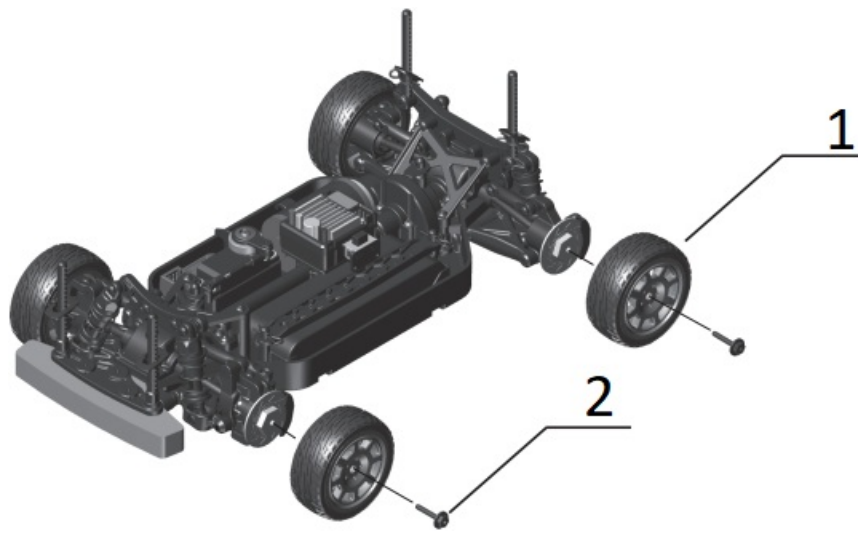

1. 21569 x2
Reflex 14R Hoonicorn mounted wheel and tire, rubber
2. 21583 x2
Wheel screw

Install x4 wheel/tires

:: Step 29

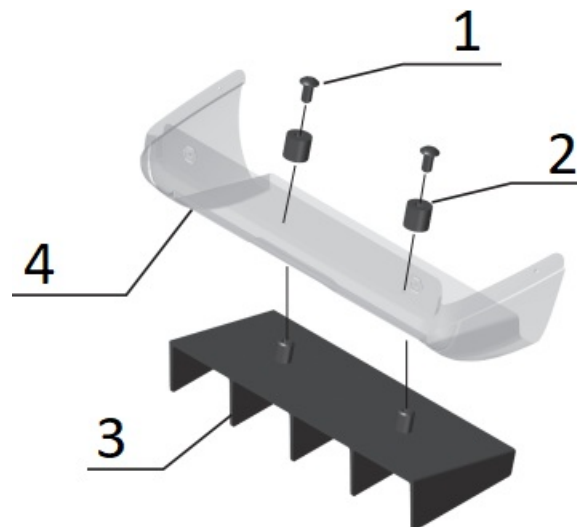

1. 31531 x2
M3x6mm
BHCS
2. 21568 x2
Spacer nut
3. 21568
Diffuser
4. 21566 – Printed
21567 – Clear
Hoonicorn body, bumper

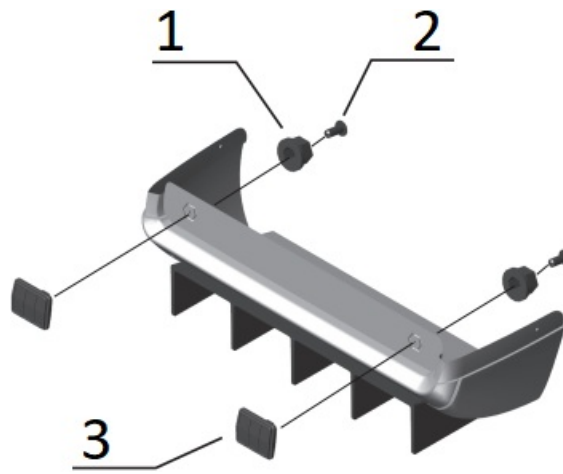

1. 21568 x2
Taillight nut
2. 31531 x2
M3x6mm
BHCS
3. 21568 x2
Taillight bucket

:: Step 30

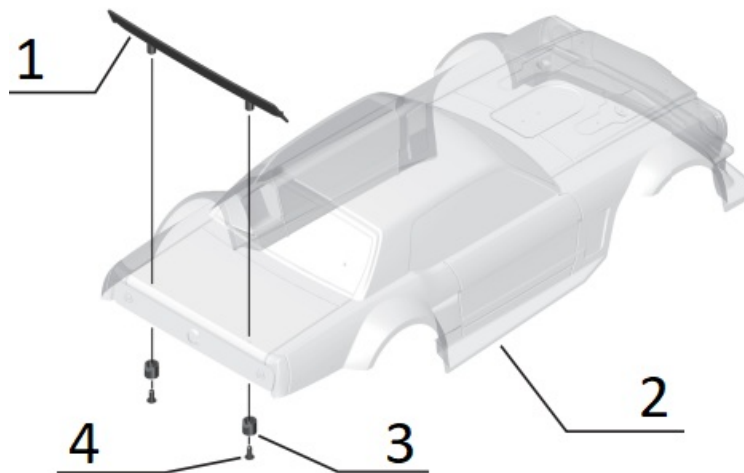

1. 21568
Spoiler
2. 21566 – Printed
21567 – Clear
Hoonicorn body
3. 21568 x2
Spacer nut
4. 31520 x2
M2.5x6mm
BHCS

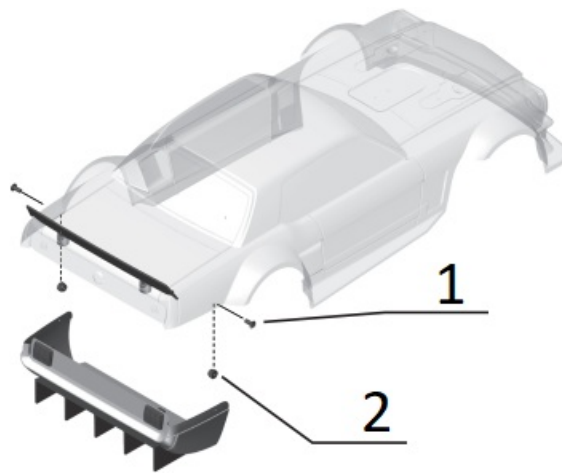

1. 31520 x2
M2.5x6mm
BHCS
2. 89215 x2
M2.5mm
Locknut

:: Step 31

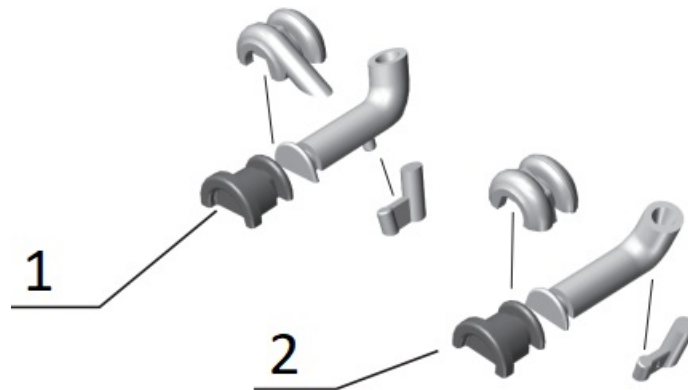

1. 21568
Turbo, right side
2. 21568
Turbo, left side

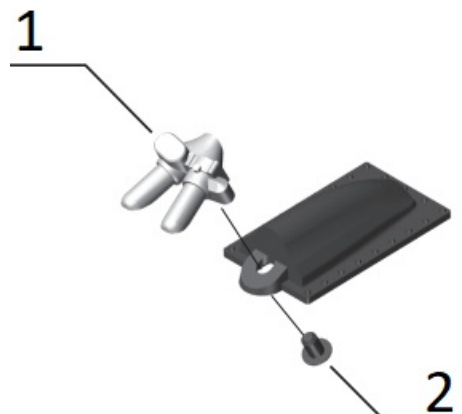

1. 31520

Manifold

2. 21568

M2.5x6mm

BHCS

:: Step 32

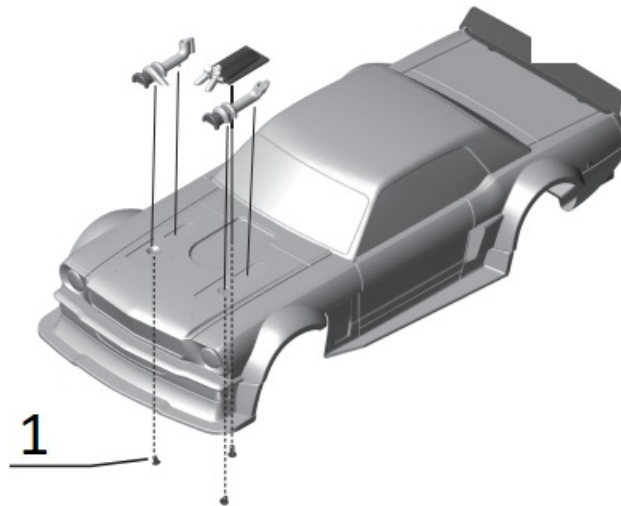

1. 89201 x3

M2.5x3mm

BHCS



1. 21173 x4

Body clips

:: Step 33

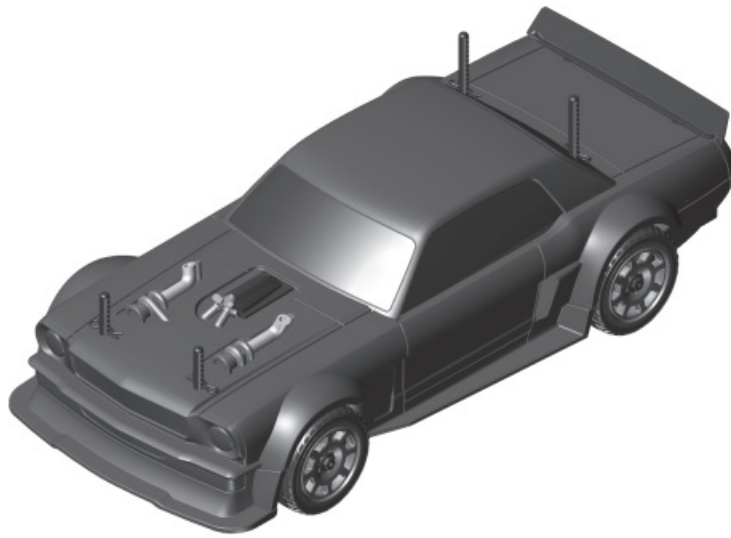

[HOONIGAN]



HOONIGAN (HŌŌN' • Î • GΞN) n.

A person who operates a motor vehicle in an aggressive and unorthodox manner, consisting of, but not limited to, drifting, burnouts, doughnuts as well as acts of automotive aeronautics.
One who hoons.

FIND IT ON ASSOCIATEDELECTRICS.COM

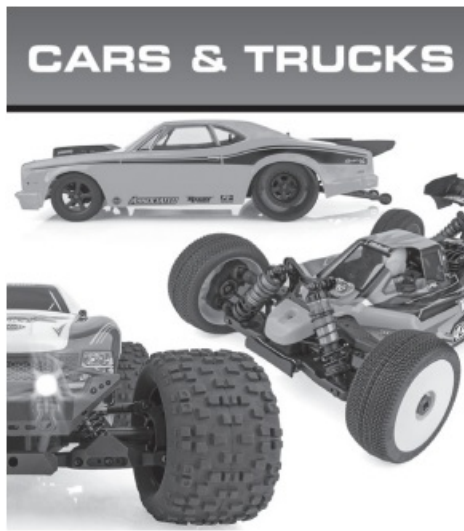

**Vehicle Spare Parts
GO TO:**

AssociatedElectrics.com

Team Associated tab

Cars & Trucks

Scroll to your vehicle

Parts & Accessories link



**Setups and Manuals
GO TO:**

AssociatedElectrics.com

Team Associated tab

Manuals & Setups

Scroll to your vehicle



Tuning Guides & Tips
GO TO:

AssociatedElectrics.com ➡

Support ➡
A-Team Apps



Associated Electrics, Inc.
21062 Bake Parkway Lake Forest, CA 92630 USA

call: [949-544-7500](tel:949-544-7500) – fax: [949-544-7501](tel:949-544-7501)

Check out the following web sites for all of our kits, current products, new releases, setup help, tips, and racing info!

www.AssociatedElectrics.com

FOLLOW US ON SOCIAL MEDIA



TeamAssociated
ReedyPower
ElementRC



@TeamAssociatedRC

@ReedyPower

@Element_RC



@Team_Associated

@ReedyPower

Documents / Resources



[ASSOCIATED 20178 Team Associated Reflex Hoonicorn](#) [pdf] Instruction Manual
20178 Team Associated Reflex Hoonicorn, 20178, Team Associated Reflex Hoonicorn,
Associated Reflex Hoonicorn, Reflex Hoonicorn, Hoonicorn

References

- [User Manual](#)

Manuals+, Privacy Policy

This website is an independent publication and is neither affiliated with nor endorsed by any of the trademark owners. The "Bluetooth®" word mark and logos are registered trademarks owned by Bluetooth SIG, Inc. The "Wi-Fi®" word mark and logos are registered trademarks owned by the Wi-Fi Alliance. Any use of these marks on this website does not imply any affiliation with or endorsement.