



[Manuals.plus](#) /

› [Loomie](#) /

› Loomie Baby Nursery Dresser (Model I870101781A1) Instruction Manual

## Loomie I870101781A1

# Loomie Baby Nursery Dresser Instruction Manual

Model: I870101781A1

## 1. INTRODUCTION

---

Thank you for choosing the Loomie Baby Nursery Dresser. This manual provides essential information for the safe assembly, operation, and maintenance of your new dresser. Please read these instructions carefully before beginning assembly and retain them for future reference.

This versatile unit functions as both a baby changing station and a children's bedroom dresser, designed to adapt as your child grows.

## 2. SAFETY INFORMATION

---

**WARNING: Failure to follow these safety instructions could result in serious injury or death.**

- Always use the provided anti-tip anchor kit to secure the dresser to a wall. This prevents tipping and potential injury to children.
- Never leave a child unattended on the changing table. Always keep one hand on your child while changing diapers.
- Keep all assembly hardware and small parts out of reach of children.
- Ensure all screws and fasteners are securely tightened before use. Periodically check and re-tighten as necessary.
- Do not allow children to climb on drawers or shelves.
- Place the dresser on a flat, level surface.



**Figure 2.1: Anti-Tipping Design.** This image shows the anti-tipping strap attached to the wall, preventing the dresser from falling forward if a child pulls on the drawers. The top panel illustrates correct installation, while the bottom panel shows the danger of not securing the dresser.

### 3. PACKAGE CONTENTS

---

Before beginning assembly, ensure all parts are present and undamaged. Refer to the parts list provided in your assembly guide. All parts are labeled for easy identification.

- Dresser panels (top, bottom, sides, back)
- Drawer components (fronts, sides, backs, bottoms)
- Drawer slides and hardware
- Cabinet door and hinges
- Adjustable shelves and shelf pins
- Door storage racks
- Knobs and handles
- Anti-tip anchor kit
- Assembly hardware (screws, dowels, cam locks, etc.)
- Instruction manual

## 4. SETUP AND ASSEMBLY

---

Assembly requires two adults. Follow the clear, step-by-step instructions provided in the separate assembly guide included with your product. Ensure you have a clear, spacious area for assembly.

1. **Unpack and Identify Parts:** Lay out all labeled parts and hardware. Compare them against the parts list in the assembly guide.
2. **Assemble the Main Frame:** Follow the guide to connect the side panels, bottom panel, and back panel to form the dresser's main structure.
3. **Install Drawer Slides:** Attach the drawer slides to the interior of the dresser frame according to the instructions.
4. **Assemble Drawers:** Construct each of the five drawers, ensuring the bottoms are securely inserted and slides are attached correctly.
5. **Install Cabinet Door and Shelves:** Attach the cabinet door with hinges and insert the adjustable shelves using the provided shelf pins. Install the door storage racks.
6. **Attach Changing Table Top:** Secure the top panel with the raised edges, which forms the changing station.
7. **Install Knobs:** Attach all drawer and cabinet door knobs.
8. **Secure with Anti-Tip Kit:** This is a critical step. Attach the anti-tip anchor kit to the back of the dresser and securely fasten it to a wall stud using appropriate hardware.

# Anti-tipping Design

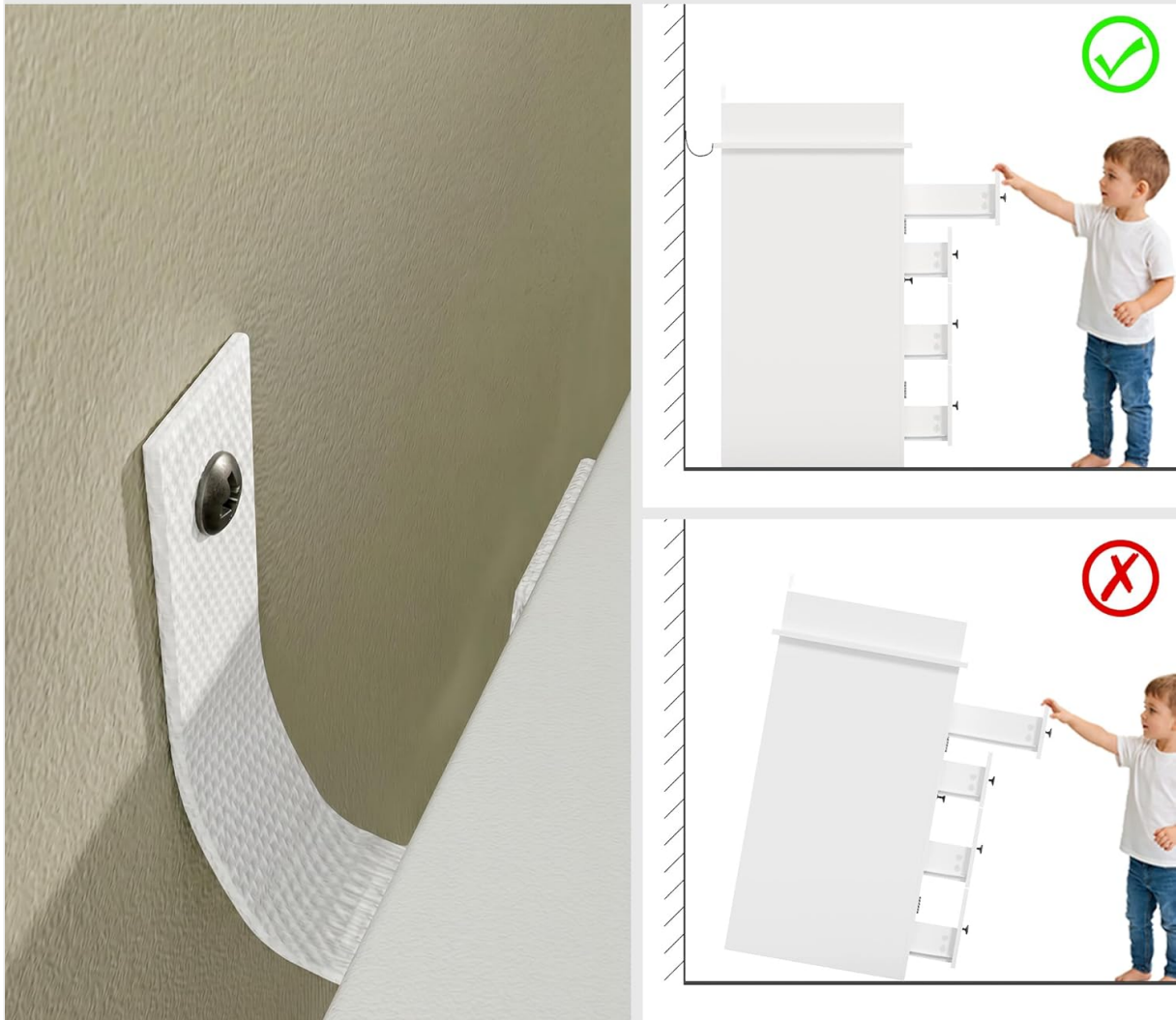

**Figure 4.1: Product Dimensions.** This image provides a detailed view of the dresser's measurements, including the changing table area and drawer sizes, which can be helpful during assembly and placement.

## 5. OPERATING INSTRUCTIONS

The Loomie Baby Nursery Dresser is designed for convenience and safety, offering multiple functionalities.

### 5.1. Changing Station Use

The top surface features a large, raised-edge changing pad area with tall safety rails. This design helps prevent accidental falls and keeps changing essentials contained.

- Place a standard changing pad (not included) within the designated area.
- Utilize the divided top tray to keep wipes, diapers, creams, and other necessities within easy reach.
- Always keep your child supervised while on the changing table.



**Figure 5.1: Organized Changing Station.** This image demonstrates how the divided top tray keeps essential baby care items neatly organized and accessible during diaper changes.

## 5.2. Storage Features

The dresser offers ample storage with five smooth-glide drawers and a side cabinet.

- **Drawers:** The five drawers provide flexible storage for baby clothes, blankets, and toys. The smooth-glide mechanism ensures easy opening and closing.
- **Side Cabinet:** The large side cabinet includes adjustable shelves, allowing you to customize the storage space for larger items like diaper packs or formula.
- **Door Storage Racks:** Built-in racks on the inside of the cabinet door are ideal for smaller items such as bottles, lotions, or smaller toys.

# Protect Your Back, Care for Your Baby

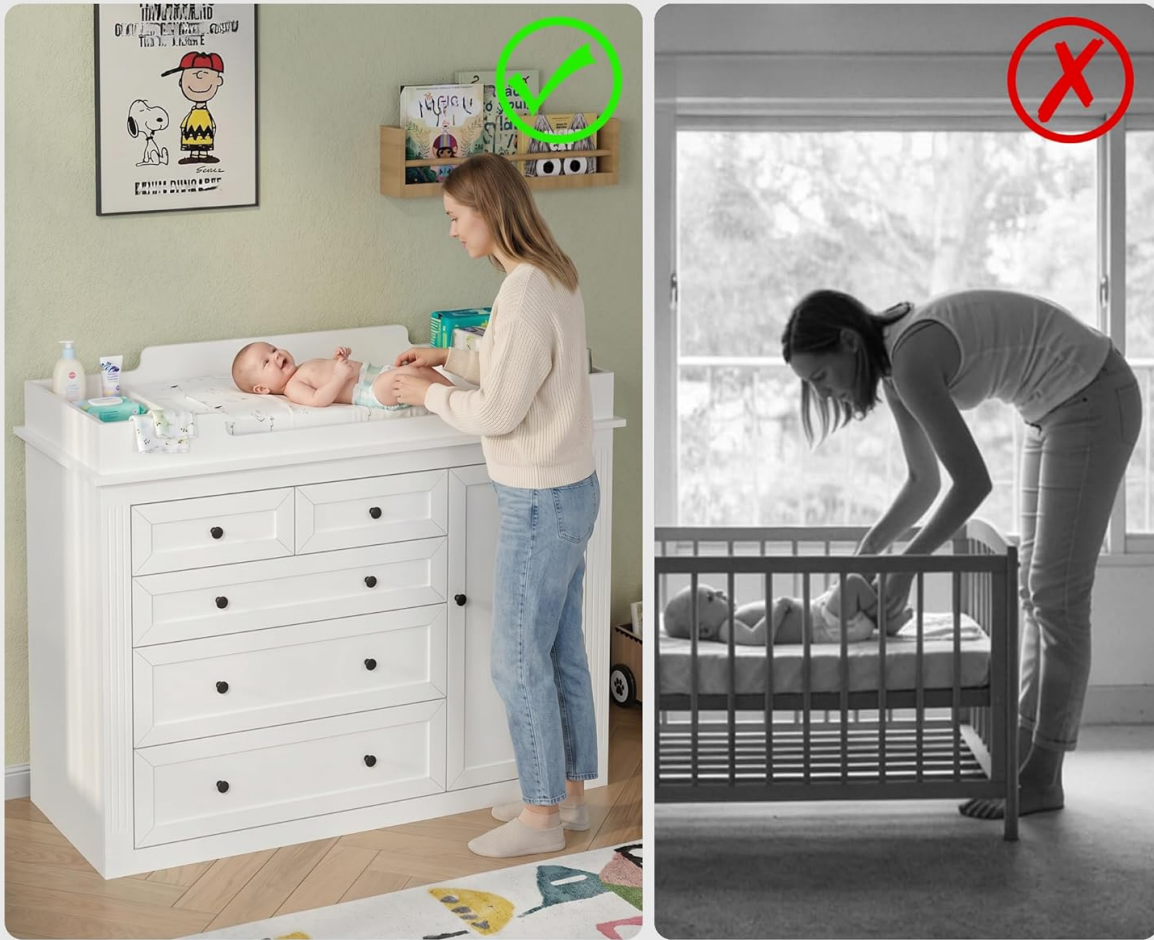

**Figure 5.2: Adjustable Storage.** This image highlights the adjustable shelves within the side cabinet and the convenient storage racks on the cabinet door, showcasing the dresser's versatile storage capabilities.

## 5.3. Ergonomic Design

The dresser is built at a comfortable working height to reduce the need for bending over during diaper changes, minimizing back strain for parents.



**Figure 5.3: Ergonomic Height Benefit.** This visual comparison demonstrates how the dresser's height allows for a more comfortable posture during baby care, reducing back strain compared to bending over a crib.

## 5.4. Multi-Functional Use

Beyond a changing station, this unit can be used for various baby care activities and transitions into a standard dresser as your child grows.

# Everything Within Arm's Reach



**Figure 5.4: All-in-One Baby Care Station.** This image illustrates the versatility of the dresser, showing it can be used for various activities beyond just diaper changing, such as tummy time and baby massage.

Your browser does not support the video tag.

**Video 5.1: Baby Nursery Dresser Features.** This video demonstrates the various features of the Loomie Baby Nursery Dresser, including the spacious drawers, adjustable cabinet shelves, and the overall functionality as a baby care station.

## 6. MAINTENANCE

---

Proper care will ensure the longevity of your Loomie Baby Nursery Dresser.

- **Cleaning:** Wipe surfaces with a soft, damp cloth. Avoid abrasive cleaners or harsh chemicals, which can damage the finish.
- **Spills:** Clean up spills immediately to prevent staining or damage to the wood.
- **Hardware:** Periodically check all screws and fasteners to ensure they remain tight. Re-tighten as needed to maintain stability.
- **Environment:** Avoid placing the dresser in direct sunlight or near heat sources, which can cause warping or fading. Maintain a stable room temperature and humidity.

## 7. TROUBLESHOOTING

---

If you encounter any issues with your dresser, refer to the following common solutions:

- **Drawers not sliding smoothly:** Check that the drawer slides are properly aligned and free of obstructions. Ensure all screws on the slides are tight.
- **Dresser feels unstable:** Verify that the dresser is on a level surface. Ensure the anti-tip anchor kit is correctly installed and securely fastened to the wall. Re-tighten all assembly hardware.
- **Cabinet door not closing properly:** Check the alignment of the hinges. Adjust if necessary according to the assembly guide. Ensure no items inside the cabinet are obstructing the door.
- **Missing or damaged parts:** If you discover any missing or damaged parts during assembly, do not proceed. Contact customer support for assistance.

## 8. SPECIFICATIONS

---

Feature	Specification
Brand	Loomie
Model Number	I870101781A1
Color	White
Item Dimensions (L x W x H)	47.24 x 19.69 x 36.02 inches
Item Weight	99.2 Pounds
Material	Engineered Wood
Number of Drawers	5
Additional Features	Adjustable Shelf, Door Shelf, Large Change Tabletop

## 9. CUSTOMER SUPPORT

---

For any questions, concerns, or assistance with your Loomie Baby Nursery Dresser, please contact Loomie customer support. Refer to your purchase documentation for specific contact details or visit the official Loomie website.