

Houselife HL-DST30A-0WR

Houselife 12-inch 3-in-1 Cordless String Trimmer Instruction Manual

Model: HL-DST30A-0WR | Brand: Houselife

1. INTRODUCTION

This manual provides essential information for the safe and effective operation, assembly, and maintenance of your Houselife 12-inch 3-in-1 Cordless String Trimmer. This versatile tool functions as a string trimmer, edger, and lawn mower, designed for use with DEWALT 20V MAX lithium-ion batteries (battery not included). Please read all instructions carefully before use.

2. SAFETY INFORMATION

WARNING: Always install the guard before use to protect from debris and flying objects. Do not use without the correct battery. Ensure the battery model is compatible (DCB200, DCB201, DCB203, DCB204, DCB205, DCB206, DCB207, DCB208, DCB210, DCB230, DCB240, etc.). Not compatible with DCBP034 or DCBP520.

- Wear appropriate personal protective equipment (PPE), including eye protection, long pants, and sturdy footwear.
- Keep children and bystanders at a safe distance from the operating area.
- Inspect the tool for any damage or loose parts before each use.
- Ensure the cutting line is properly installed and not excessively long.
- Avoid operating in wet conditions or near electrical wires.

3. PACKAGE CONTENTS

Verify that all components are present:

- Trimmer Head Assembly
- Main Shaft Sections (multiple, for assembly)

- Adjustable Auxiliary Handle
- Safety Guard
- Line Spool (pre-installed)
- Additional Line Spools (typically 4)
- Fasteners and Tools for Assembly (e.g., screwdriver)
- Instruction Manual

4. SETUP AND ASSEMBLY

Follow these steps to assemble your string trimmer:

1. **Connect Shaft Sections:** Align the two main shaft sections and push them together until they click securely into place.
2. **Attach Auxiliary Handle:** Slide the adjustable auxiliary handle onto the shaft. Secure it at a comfortable position using the provided fasteners.
3. **Install Safety Guard:** Position the safety guard over the trimmer head and secure it with the screws. Ensure it is firmly attached before operation.
4. **Insert Battery:** Slide a charged DEWALT 20V MAX battery into the battery slot on the handle until it locks into place.



Image: Step-by-step assembly of the Houselife Cordless String Trimmer.

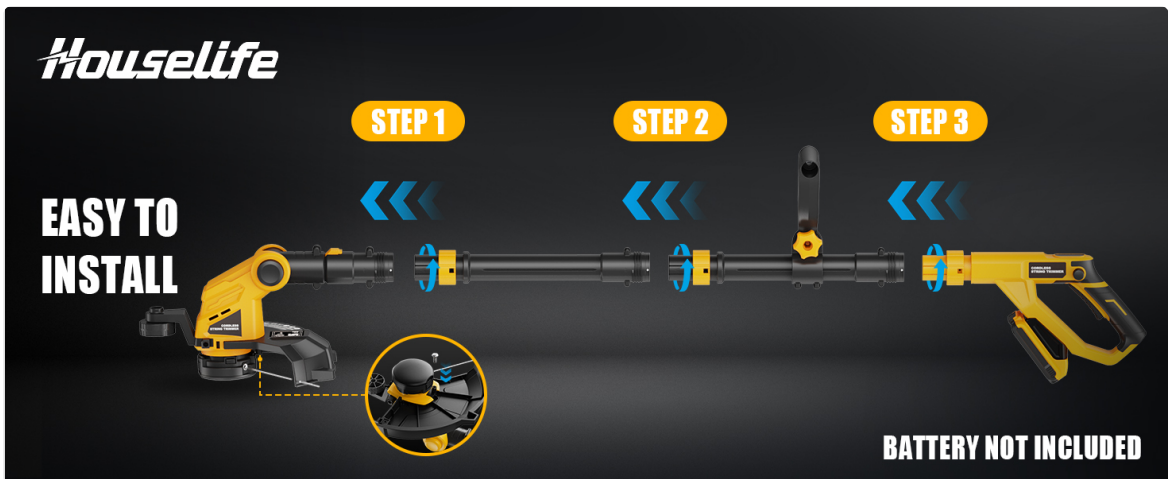

Image: Detailed visual guide showing the assembly process of the trimmer.

5. OPERATING INSTRUCTIONS

Your Houselife string trimmer offers multiple functions for various lawn care tasks.

5.1. Trimming Mode

Hold the trimmer with both hands, ensuring a firm grip on the main handle and the auxiliary handle. Press the safety button and then the trigger to start the motor. Move the trimmer in a sweeping motion across the area to be trimmed, keeping the cutting line parallel to the ground.



Image: The Housetlife trimmer demonstrating its 3-in-1 functionality as a trimmer, edger, and mower.



Image: A user operating the Housetlife Cordless String Trimmer in trimming mode.

5.2. Edging Mode

To switch to edging mode, rotate the trimmer head 90 degrees. The integrated wheel on the guard assists in maintaining a consistent cutting depth along edges. Walk along the edge of your lawn, guiding the trimmer to create a clean line.



Image: The Houeslife Cordless String Trimmer being used to create a clean edge along a pathway.

5.3. Mowing Mode

For light mowing tasks, adjust the cutting head to a suitable angle. The lightweight design allows for maneuverability in areas where a traditional lawnmower might be difficult to use, such as under benches or around obstacles.



Image: A user demonstrating the trimmer's capability as a mini-mower for hard-to-reach areas.

5.4. Automatic Line Feed

The trimmer features an auto-feed line system. To advance the line, simply tap the trimmer head on the ground while the motor is running. Ensure the guard shield is installed before use to prevent debris from jamming the feed mechanism. Keep the spool line extended to approximately 10cm (4 inches) for optimal auto-line feed.



Image: Close-up view of the automatic line feed system on the trimmer head.

5.5. Adjustable Features

- **180° Adjustable Handle:** The auxiliary handle can be adjusted 180 degrees to suit various trimming angles and user heights, reducing fatigue during extended use.
- **Adjustable Cutting Head:** The cutting head can be adjusted to different angles for versatile use in trimming, edging, and light mowing.

HouseLife



AUTOMATIC LINE FEED

Image: The trimmer demonstrating its flexible application with adjustable angles for various tasks.

6. MAINTENANCE

Regular maintenance ensures optimal performance and extends the life of your tool.

- **Cleaning:** After each use, remove any grass clippings, dirt, and debris from the trimmer head, guard, and ventilation openings. Use a dry cloth or soft brush. Do not use water or cleaning solvents.
- **Line Replacement:** When the cutting line is depleted, replace the spool with a new one. Refer to the product packaging for compatible line types and sizes.
- **Storage:** Store the trimmer in a dry, secure location away from direct sunlight and extreme temperatures. Remove the battery before storing.

7. TROUBLESHOOTING

If you encounter issues with your trimmer, refer to the following common solutions:

- **Tool does not start:** Ensure the battery is fully charged and correctly inserted. Check that the

safety button is pressed before engaging the trigger.

- **Cutting line does not feed:** Verify that the line is not tangled or jammed in the spool. Ensure the guard is properly installed. Tap the trimmer head on the ground while running to activate the auto-feed.
- **Reduced cutting performance:** The cutting line may be too short or worn. Replace the line spool. Ensure the battery has sufficient charge.

8. SPECIFICATIONS

Feature	Specification
Brand	Houselife
Model Number	HL-DST30A-0WR
Power Source	Battery Powered (DEWALT 20V MAX compatible)
Cutting Width	12 Inches
Product Dimensions	1"L x 1"W (Note: These dimensions appear to be placeholders and may not reflect actual product size.)
Battery Average Life	Approximately 30 minutes (depending on battery capacity and usage)
Weight	Approximately 4 lbs (1.8 kg)
Assembly Required	Yes

9. WARRANTY AND SUPPORT

For warranty information, product support, or to purchase replacement parts, please refer to the contact information provided with your product packaging or visit the official Houselife website. Keep your purchase receipt as proof of purchase.

10. PRODUCT VIDEO OVERVIEW

Watch this video for a quick overview of the Houselife Cordless Weed Eater and Leaf Blower Combo, demonstrating its features and ease of use. While this video showcases a combo, the weed eater functionality is directly applicable to your product.

Your browser does not support the video tag.

Video: Houselife-US provides an overview of the Cordless Weed Eater and Leaf Blower Combo, highlighting the weed eater's capabilities.

