

Greesum GS-316-0331

Greesum 5x4FT Plastic Outdoor Storage Shed User Manual

Model: GS-316-0331

1. PRODUCT OVERVIEW

The Greesum 5x4FT Plastic Outdoor Storage Shed is designed to provide a durable and weather-resistant storage solution for your outdoor space. Constructed from eco-friendly polyethylene resin plastic, this shed offers protection against water and UV rays, ensuring longevity and strength. Its versatile design allows it to function as a utility room or a pet house, helping to maintain a tidy outdoor environment.

- **Spacious Design:** Offers ample storage for garden tools, bicycles, toys, and other outdoor items.
- **Eco-Friendly Material:** Made from recyclable polyethylene resin plastic, resistant to weather, water, and UV.
- **Tilted Roof:** Prevents water and snow accumulation, maximizing internal space.
- **Translucent Window & Vents:** Provides natural lighting and promotes air circulation.
- **Lockable Door:** Enhances the security of stored items.

Double-layer Resin Material

Not easy to distort

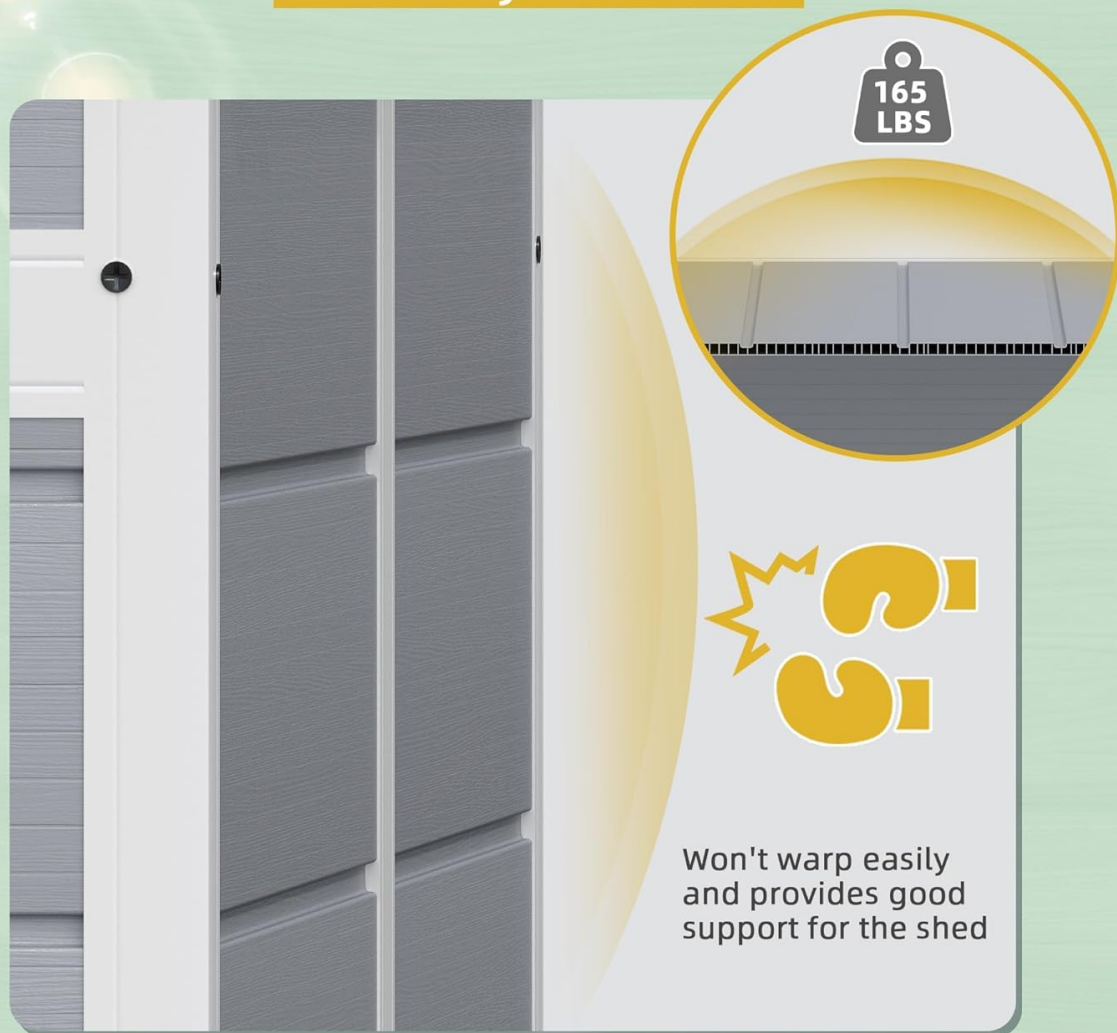

Image 1.1: Product dimensions of the Greesum 5x4FT Plastic Outdoor Storage Shed. The shed measures 54.3 inches wide, 43.5 inches deep, and 76.4 inches high, with a weight capacity of 165 lbs.



Image 1.2: Illustration of the shed's all-weather resin material, emphasizing its waterproof and UV protection features for outdoor durability.

2. SAFETY INFORMATION

This product requires careful handling and assembly. Always follow the instructions provided in the full assembly manual and wear appropriate protective gear during installation. It is recommended to have at least two people assist in the assembly process to ensure safety and proper construction.

- Always wear gloves to prevent injuries during assembly.
- Ensure the assembly area is clear of obstructions and hazards.
- Do not attempt to assemble the shed in strong winds or adverse weather conditions.
- Keep small parts away from children during assembly.
- Regular inspection is recommended, especially after severe weather conditions, to ensure structural integrity.

3. SETUP AND ASSEMBLY

The Greesum 5x4FT Plastic Outdoor Storage Shed is designed for straightforward assembly, though it requires attention to detail and typically 2-3 people for efficient setup. Each accessory is labeled with a corresponding number to guide you through the process.

3.1 Pre-Assembly Checks

- **Site Preparation:** Ensure the chosen location for the shed is a flat, level surface. Uneven ground can affect door alignment and overall stability.
- **Package Contents:** The shed is shipped in two boxes. Verify that all parts and accessories are present by checking against the parts list in your detailed instruction manual.
- **Local Regulations:** Check your local Homeowners Association (HOA) guidelines or municipal regulations regarding outdoor structures before beginning construction.

3.2 Assembly Steps

Refer to the detailed instruction manual included in your package for step-by-step assembly instructions. The general process involves:

1. Unpack all components and identify each part using the provided labels.
2. Assemble the base frame on your prepared level surface.
3. Attach the wall panels, ensuring they are securely fastened according to the instructions.
4. Install the roof structure, making sure it is properly aligned for water runoff.
5. Mount the door and window, ensuring smooth operation and proper sealing.
6. Install the lockable latch mechanism.



Image 3.1: Detailed view of the shed's design elements, including reinforced corner protection, a bright translucent window for natural light, a secure lockable latch, and the robust double-layer resin material that resists distortion.

4. OPERATION

The Greesum 5x4FT Plastic Outdoor Storage Shed is designed for simple and effective use as an outdoor storage unit.

- **Storage:** Utilize the interior space for organizing garden tools, lawn equipment, pool supplies, or other items that require protection from the elements.
- **Door Access:** The single hinged door provides easy access to the shed's contents. Ensure the door is fully closed and the latch is engaged to secure your items.
- **Ventilation and Light:** The translucent window and integrated vents allow for natural light penetration and air circulation, which can help prevent moisture buildup inside the shed.
- **Security:** Use the lockable door mechanism to secure the shed. A padlock (not included) can be added for enhanced security.

PRODUCT DIMENSION

Weight Capacity :165 LBS



Image 4.1: The Greesum 5x4FT Plastic Outdoor Storage Shed positioned in a backyard, demonstrating its practical use for storing various items and blending into an outdoor environment.

5. MAINTENANCE

Proper maintenance will extend the life and appearance of your Greesum storage shed.

- **Cleaning:** Clean the shed periodically with mild soap and water. Avoid abrasive cleaners or harsh chemicals that could damage the resin plastic.
- **Inspection:** Regularly inspect the shed for any signs of wear, damage, or loose fasteners, especially after severe weather conditions. Tighten any loose screws or bolts as needed.
- **Drainage:** Ensure that the area around the shed allows for proper water drainage to prevent water accumulation at the base.
- **Ventilation:** Keep the vents clear of debris to ensure continuous air circulation.

6. TROUBLESHOOTING

This section addresses common issues you might encounter with your storage shed.

- **Door Not Closing Properly:** Ensure the shed is installed on a completely flat and level surface. Uneven ground can cause the door frame to warp slightly, preventing proper closure. Adjust the shed's position or level the ground if necessary.
- **Water Leakage:** Check all roof and wall panel connections to ensure they are securely fastened and sealed. Verify that the roof is properly installed to allow for effective water runoff.
- **Missing Parts:** If you find any parts missing upon delivery, refer to the parts list in your assembly manual and contact Greesum customer support for assistance.

7. SPECIFICATIONS

Feature	Detail
Brand	Greesum
Model Number	GS-316-0331
Product Dimensions (D x W x H)	43.5" x 54.3" x 76.4"
Material	Polyethylene Resin Plastic
Color	Light Gray
Style	Modern
Door Style	Single Hinged, Lockable
Water Resistance Level	Waterproof
Assembly Required	Yes

8. WARRANTY INFORMATION

Specific warranty details for the Greesum 5x4FT Plastic Outdoor Storage Shed are not provided in the product information. For warranty inquiries, please contact Greesum customer support directly.

9. CUSTOMER SUPPORT

If you have any questions, require assistance with assembly, or need to report missing/damaged parts, please contact Greesum customer support. Refer to the contact information provided in your product packaging or visit the official Greesum website for support options.

For more information about Greesum products, you can visit the [Greesum Store on Amazon](#).