



[Manuals.plus](#) /

> [Baseus](#) /

> Baseus 70W Universal Travel Adapter & 30W USB C Charger Block User Manual

Baseus Enercore CG11, EnerFill FN22

Baseus 70W Universal Travel Adapter & 30W USB C Charger Block User Manual

Models: Enercore CG11 (Travel Adapter), EnerFill FN22 (Charger Block)

INTRODUCTION

This manual provides detailed instructions for the safe and efficient use of your Baseus 70W Universal Travel Adapter (Enercore CG11) and Baseus 30W USB C Charger Block (EnerFill FN22). Please read this manual thoroughly before operation and retain it for future reference.



Image: Baseus 70W Universal Travel Adapter (Enercore CG11) with its integrated retractable USB-C cable.



Image: Two Baseus 30W USB C Charger Blocks (EnerFill FN22) shown with accompanying USB-C cables.

PRODUCT COMPONENTS

The package includes:

- 1 x Baseus 70W Universal Travel Adapter (Enercore CG11) with built-in retractable USB-C cable
- 2 x Baseus 30W USB C Charger Block (EnerFill FN22)
- 2 x USB-C to USB-C Charging Cable

SETUP INSTRUCTIONS

Baseus 70W Universal Travel Adapter (Enercore CG11)

1. **Select the Correct Plug Type:** Identify the appropriate plug type for your destination country. The adapter supports Type C/A/G/I plugs. Slide the corresponding levers on the side of the adapter to extend the required prongs. Ensure the prongs are fully extended and locked into place before use.

All-in-One Travel Adapter

Works in 200+ countries and regions.

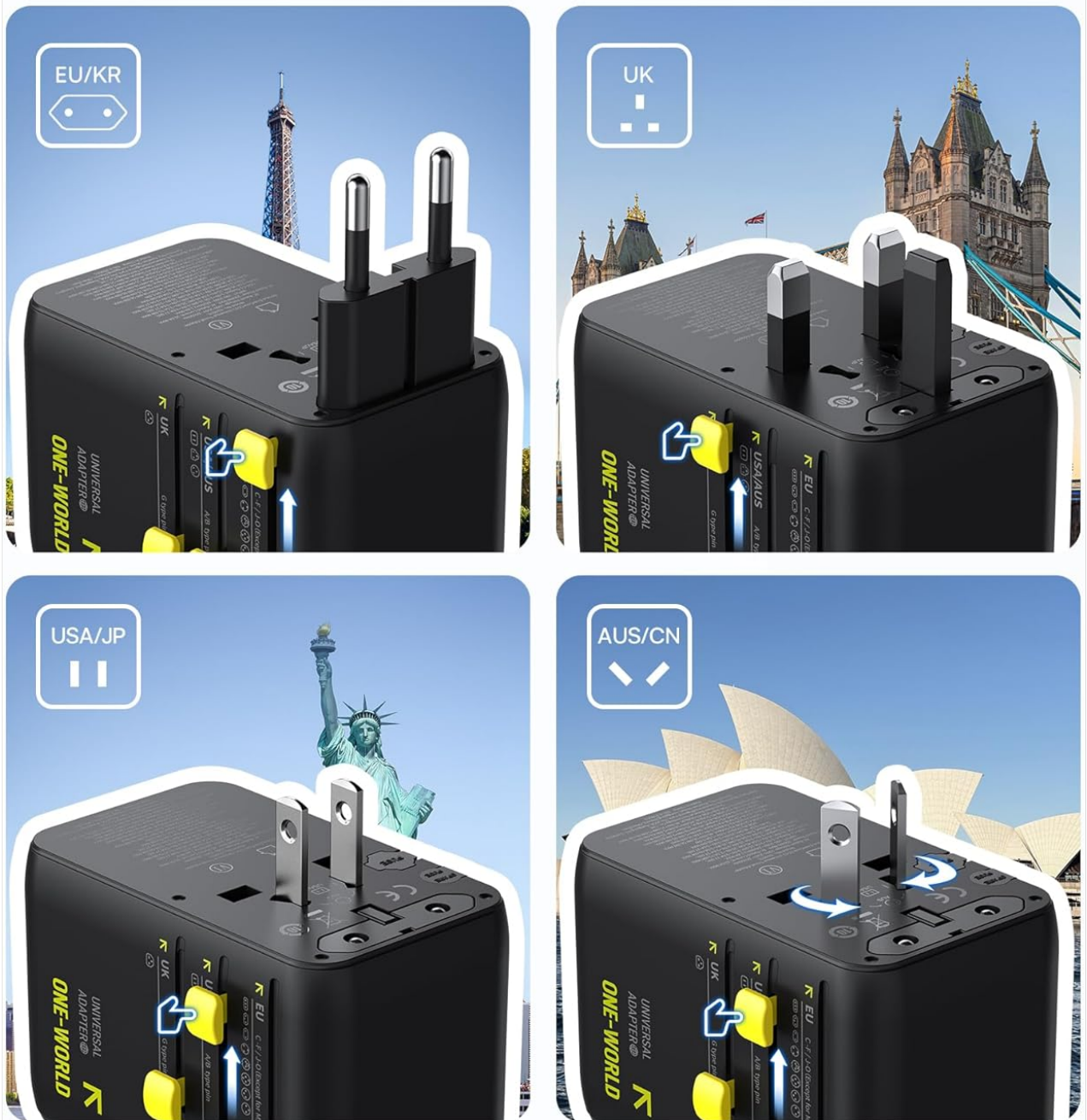

Image: Visual guide demonstrating the selection and extension of EU/KR, UK, USA/JP, and AUS/CN plug types on the universal travel adapter.

2. **Connect to Power Outlet:** Insert the extended prongs into the wall power outlet.

3. **Prepare Retractable USB-C Cable:** Gently pull the integrated USB-C cable from its housing to the desired length. The cable is braided for durability and extends up to 27 inches.



Image: A hand demonstrating the extension of the 70W fast charging retractable USB-C cable from the travel adapter, highlighting its braided material.

Baseus 30W USB C Charger Block (EnerFill FN22)

1. **Connect to Power Outlet:** Plug the charger block directly into a standard wall power outlet.

OPERATING INSTRUCTIONS

Baseus 70W Universal Travel Adapter (Enercore CG11)

- **Charging Devices:**
 - **AC Socket:** Plug your device's power cord into the universal AC socket on the adapter.
 - **USB-C Ports:** Connect your USB-C compatible devices using the integrated retractable USB-C cable or an external USB-C cable to the dedicated USB-C port.
 - **USB-A Ports:** Connect your USB-A compatible devices using an external USB-A cable to one of the two USB-A ports.
- **Simultaneous Charging:** The adapter allows charging up to 6 devices simultaneously: 1 universal AC socket, 1 Type-A socket, 1 USB-C port, 2 USB-A ports, and the 1 integrated 70W retractable USB-C cable.

Charge Up to 6 Devices at Once



1 X Universal
AC Socket

1 X USB C

1 X Type-A
Socket

2 X USB A

1 X 70W
Retractable
Cable

Image: The Baseus travel adapter plugged into a wall outlet, simultaneously charging a laptop, tablet, earbuds, and smartphone via its various ports and retractable cable.

- **Power Output:** The integrated retractable USB-C cable delivers up to 70W Max. The total output across all ports will be managed by the adapter's intelligent power distribution.
- **After Use:** Disconnect all devices. Gently retract the USB-C cable by pulling it slightly further and then releasing it to allow it to coil back into the housing. Remove the adapter from the wall outlet and retract the prongs by sliding the levers.

Baseus 30W USB C Charger Block (EnerFill FN22)

- **Charging Devices:** Connect your USB-C compatible device to the charger block using the provided USB-C to USB-C cable or another compatible USB-C cable.

- **Fast Charging:** The EnerFill FN22 charger block supports 30W fast charging, capable of charging devices like an iPhone 17 Pro up to 69% in 30 minutes or a Galaxy S25 Ultra 50% in 30 minutes.

30W Fast Charging

Full-speed USB-C power in seconds.



Image: An iPhone 17 Pro displaying 69% charge after 30 minutes, connected to the Baseus 30W fast charger.

30W Fast Charging

Full-speed USB-C power in seconds.

30 Min



Samsung Galaxy S25 Ultra

30W



*Data sourced from the Baseus Lab; results may vary due to environmental factors.

Image: A Samsung Galaxy S25 Ultra displaying 50% charge after 30 minutes, connected to the Baseus 30W fast charger.

- **After Use:** Disconnect your device and remove the charger block from the wall outlet.

MAINTENANCE

- **Cleaning:** Ensure both products are disconnected from power outlets and devices before cleaning. Use a soft, dry cloth to wipe the surfaces. Do not use liquid cleaners or abrasive materials.
- **Storage:** Store the adapters in a cool, dry place away from direct sunlight and moisture. Ensure the retractable cable

on the travel adapter is fully retracted before storage.

- **Inspection:** Periodically inspect the products and cables for any signs of damage, such as frayed wires, bent prongs, or cracked casings. Do not use if damaged.

TROUBLESHOOTING

- **Device Not Charging:**
 - Ensure the adapter is securely plugged into a live power outlet.
 - Verify that the device is properly connected to the adapter/charger.
 - Check if the cable is damaged. Try a different cable.
 - For the travel adapter, ensure the correct plug type is fully extended and locked.
- **Slow Charging:**
 - Ensure your device supports fast charging and that you are using a compatible cable.
 - For the travel adapter, charging multiple devices simultaneously may distribute power, potentially reducing individual port speeds.
 - Environmental factors can affect charging speed.
- **Adapter Overheating:**
 - While the 30W charger block features advanced GaN technology for improved heat dissipation, prolonged heavy use can cause warmth. If it becomes excessively hot, disconnect it immediately and allow it to cool.
 - Ensure adequate ventilation around the adapter/charger. Do not cover it.

SPECIFICATIONS

Baseus 70W Universal Travel Adapter (Enercore CG11)

- **Input:** AC 100-250V, 50/60Hz
- **Max Power Output:** 70W (via retractable USB-C cable)
- **Plug Types:** Type C/A/G/I (compatible with 200+ countries)
- **Ports:** 1 x Universal AC Socket, 1 x Type-A Socket, 1 x USB-C Port, 2 x USB-A Ports, 1 x Retractable USB-C Cable
- **Cable Length:** Retractable USB-C cable up to 27 inches (approx. 68 cm)

Baseus 30W USB C Charger Block (EnerFill FN22)

- **Max Power Output:** 30W
- **Technology:** GaN (Gallium Nitride) for compact size and efficient heat dissipation
- **Port:** 1 x USB-C Port
- **Size:** Approximately 30% smaller than original Apple 20W charger.

30% Smaller, Built to Travel

Ultra-compact that is easy to carry anywhere.



Image: The Baseus 30W charger block shown next to an iPhone and AirPods, emphasizing its ultra-compact design for travel.

SAFETY INFORMATION

- Do not expose the products to water, moisture, or extreme temperatures.
- Avoid dropping or subjecting the products to strong impacts.
- Do not attempt to disassemble, repair, or modify the products. This will void the warranty and may cause safety hazards.

- Keep out of reach of children.
- Ensure the total power consumption of connected devices does not exceed the adapter's maximum output.
- Use only with compatible devices and cables.

WARRANTY AND SUPPORT

Baseus products are designed for reliability and performance. For warranty information, technical support, or customer service inquiries, please refer to the official Baseus website or contact your retailer. Please retain your proof of purchase for warranty claims.

You can visit the [Baseus Store on Amazon](#) for more information and support.