



Manuals.plus /

› Fuzion /

› Fuzion Digital Shipping Scale UD-180 User Manual

Fuzion UD-180

Fuzion Digital Shipping Scale UD-180 User Manual

Model: UD-180

[Introduction](#)

[Package Contents](#)
[Troubleshooting](#)

[Features](#)
[Specifications](#)

[Setup](#)

[Operation](#)

[Maintenance](#)

[Warranty & Support](#)

1. INTRODUCTION

Thank you for choosing the Fuzion Digital Shipping Scale UD-180. This heavy-duty scale is designed for accurate weighing of packages, parcels, and other items up to 330 pounds (150 kg). Featuring a durable stainless steel platform and a separate LCD display, it offers convenience and precision for various applications, including postal services, commercial businesses, and personal use.

Please read this manual thoroughly before operating the scale to ensure proper use and to maximize its lifespan.

2. PACKAGE CONTENTS

Verify that all items are present in the package:

- Fuzion Digital Shipping Scale (Platform)
- LCD Display Unit with coiled cord
- AC Power Adapter
- 3 x AA Batteries
- User Manual (this document)

3. PRODUCT FEATURES

- **High Capacity:** Weighs items up to 330 lb (150 kg) with 0.1 lb (10 g) accuracy.
- **Durable Platform:** Large 15 x 12 inch stainless steel weighing platform.
- **Remote LCD Display:** Separate display unit with a coiled cord for flexible placement, featuring a blue backlight for clear readability.
- **Multiple Weighing Modes:** Easily switch between pounds (lb), ounces (oz), and kilograms (kg).
- **Tare Function:** Allows you to subtract the weight of a container to get the net weight of its contents.
- **Dual Power Supply:** Operates via the included AC adapter or 3 AA batteries.
- **Display Mounting Options:** The display unit can be used on a stand or wall-mounted.

Digital Shipping Scale

Minimum Weight : 150g / 5oz

Durable Stainless Steel Platform

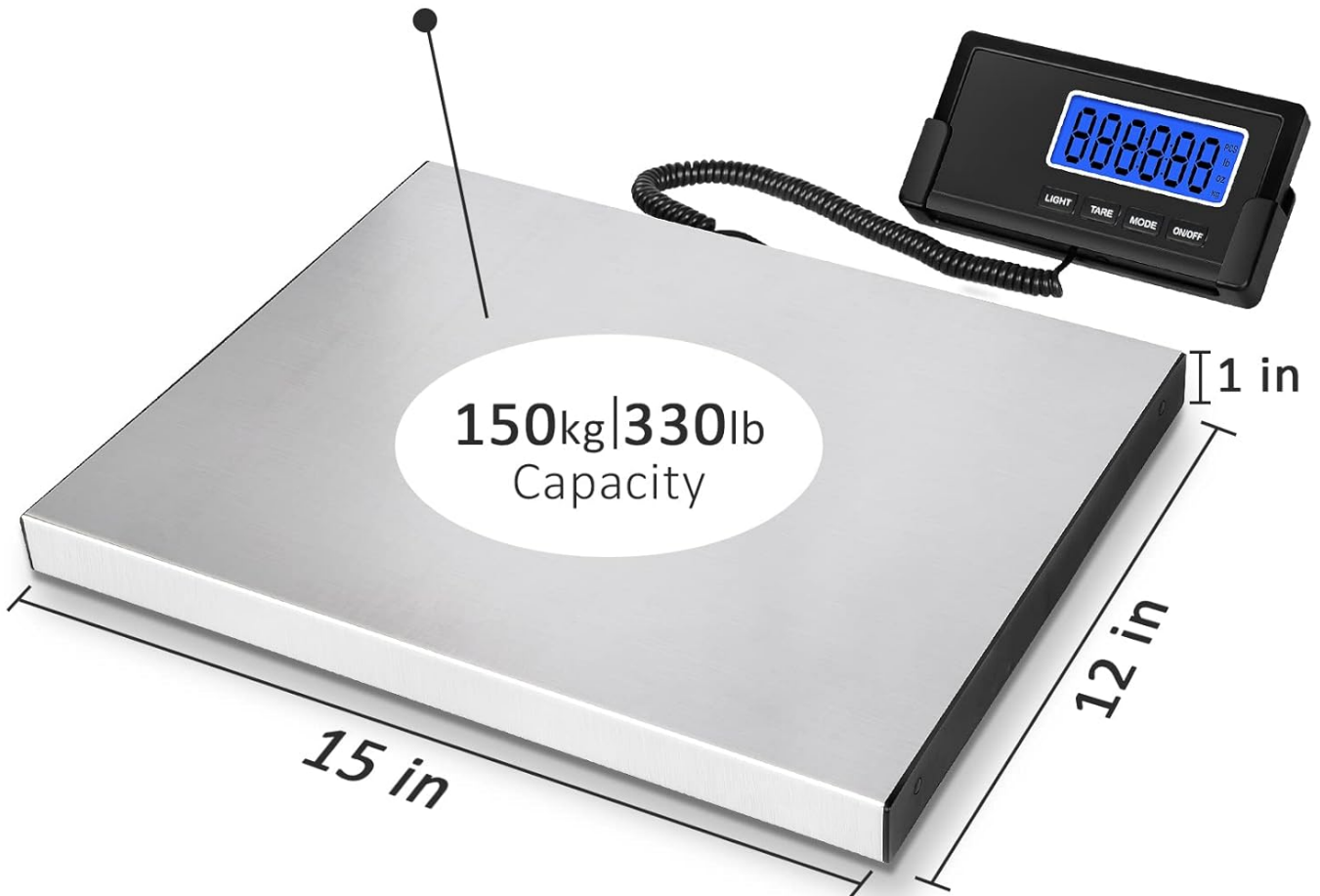

Image: Overview of the Fuzion Digital Shipping Scale, highlighting its 330lb capacity and 15x12 inch stainless steel platform.

4. SETUP

4.1 Powering the Scale

The scale can be powered by either the AC adapter or AA batteries.

1. **Using the AC Adapter:** Plug the AC adapter into the power port on the display unit and then into a standard electrical outlet.
2. **Using Batteries:** Open the battery compartment on the back of the display unit. Insert 3 AA batteries, ensuring correct polarity (+/-). Close the compartment securely.



AC Adaptor or 3AA battery power (include battery)

 AC Adapter

 AA Battery

Image: The display unit illustrating the connection for the AC adapter and the battery compartment for AA batteries.

4.2 Display Unit Placement

The remote LCD display unit offers flexible placement options:

- **Desktop Use:** Use the integrated stand on the back of the display unit to prop it up on a flat surface.
- **Wall Mounting:** The display unit includes mounting holes for secure attachment to a wall. Ensure appropriate fasteners are used for your wall type.

Stand or Wall Mounted Display

Wall mounted for nails



Stand with bracket viewing

Image: The display unit demonstrating its use with a stand for desktop viewing and wall-mounting capability.

Your browser does not support the video tag.

Video: An instructional video demonstrating the setup and basic functions of the Fuzion UD Shipping Scale.

5. OPERATING INSTRUCTIONS

5.1 Power On/Off

- Press the **ON/OFF** button to turn the scale on.
- Press and hold the **ON/OFF** button for a few seconds to turn the scale off.

5.2 Changing Weighing Units

The scale supports three weighing units: pounds (lb), ounces (oz), and kilograms (kg).

- With the scale on, press the **MODE** button to cycle through the available units (lb → oz → kg → lb).
- The selected unit will be displayed on the LCD screen.

3 Modes Weighing



Image: The display unit illustrating the three weighing modes: pounds (lb), ounces (oz), and kilograms (kg).

5.3 Using the Tare Function

The Tare function allows you to weigh items in a container by subtracting the container's weight.

1. Place the empty container on the weighing platform. The display will show the container's weight.
2. Press the **TARE** button. The display will reset to zero.
3. Place the items to be weighed into the container. The display will now show only the net weight of the items.
4. To clear the tare, remove all items from the platform and press **TARE** again, or turn the scale off and on.

Tare Function

Press 'TARE' to zero out the box weight, and easily get the net weight.

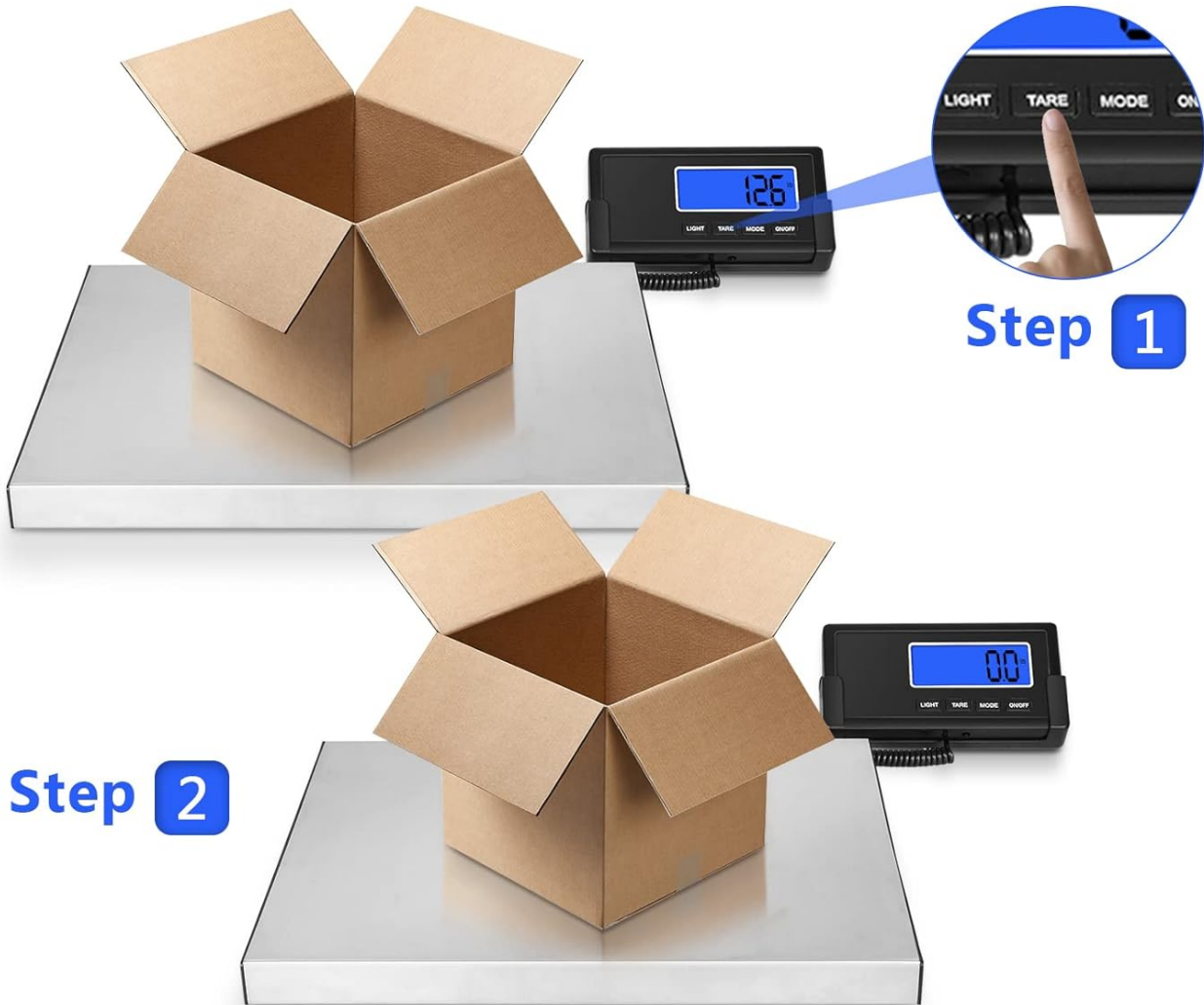

Image: Step-by-step visual guide on how to use the Tare function to weigh contents within a box.

5.4 General Weighing

To weigh an item:

1. Ensure the scale is on and displaying "0.0" in your desired unit.
2. Carefully place the item in the center of the stainless steel platform.
3. Wait for the reading to stabilize. The weight will be displayed on the LCD screen.

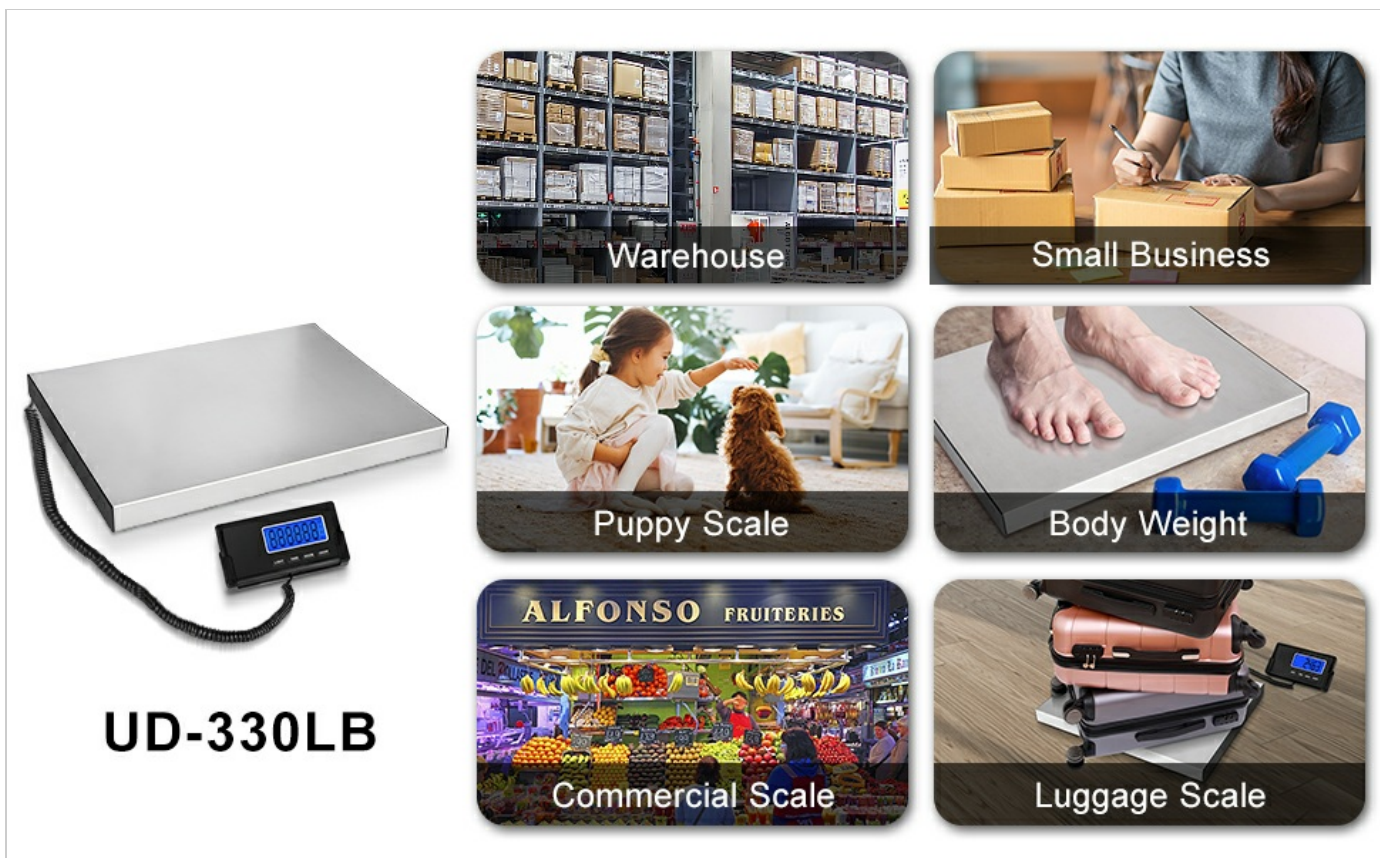

Image: Examples of the scale's versatility, showing its use in a warehouse, small business, for weighing small pets, and for personal body weight.

6. MAINTENANCE

- **Cleaning:** Wipe the scale platform and display with a soft, damp cloth. Do not use abrasive cleaners or immerse the unit in water.
- **Storage:** Store the scale in a clean, dry environment away from extreme temperatures and humidity.
- **Battery Replacement:** If using batteries, replace them when the low battery indicator appears on the display. Remove batteries if the scale will not be used for an extended period.
- **Calibration:** While the scale is factory-calibrated, if you suspect inaccuracies, refer to the troubleshooting section or contact support for calibration instructions.

7. TROUBLESHOOTING

Problem	Possible Cause	Solution
Scale does not turn on.	No power or low batteries.	Ensure AC adapter is securely plugged in, or replace AA batteries.
Inaccurate readings.	Scale not on a flat, stable surface; item not centered; calibration needed.	Place scale on a firm, level surface. Center the item on the platform. If issues persist, contact Fuzion support for calibration guidance.
Display shows "OVERLOAD" or "EEEE".	Weight exceeds maximum capacity.	Remove the item immediately to prevent damage. Do not exceed 330 lb (150 kg).
Display is dim or flickering.	Low battery power.	Replace batteries or use the AC adapter.

8. SPECIFICATIONS

Feature	Detail
Model Number	UD-180
Brand	Fuzion
Maximum Capacity	330 lb / 150 kg
Readout Accuracy	0.1 lb / 10 g
Minimum Readability	150 g / 5 oz
Platform Material	Stainless Steel
Platform Dimensions	15 in x 12 in
Display Type	LCD with Blue Backlight
Weighing Modes	lb, oz, kg
Power Supply	AC Adapter (included) or 3 x AA Batteries (included)
Item Weight	3.44 Kilograms

9. WARRANTY AND SUPPORT

Fuzion offers a **3-Year Warranty** for this digital scale, covering manufacturing defects and malfunctions under normal use. Additionally, we provide **Lifetime Support** to assist you with any questions or concerns you may have regarding your product. For warranty claims, technical assistance, or general inquiries, please contact the Fuzion support team. Our dedicated team is available to provide prompt and helpful service.

Contact information can typically be found on the Fuzion official website or through your purchase platform.

