



[Manuals.plus](#) /

> [Vehipa](#) /

> Vehipa Smart Fish Aquarium Kit (4.2 Gallon) - Model YYG300 Instruction Manual

## Vehipa YYG300

# Vehipa Smart Fish Aquarium Kit (4.2 Gallon) - Model YYG300 Instruction Manual

Your guide to setting up, operating, and maintaining your Vehipa Smart Fish Aquarium Kit.

[Introduction](#)

[Features](#)

[Setup](#)

[Operating](#)

[Maintenance](#)

[Troubleshooting](#)

[Specifications](#)

[Warranty &](#)

[Support](#)

## 1. INTRODUCTION

---

The Vehipa Smart Fish Aquarium Kit (Model YYG300) is a 4.2-gallon all-in-one aquatic ecosystem designed for desktop, office, or room use. This kit integrates essential features for fish keeping, including a 4-in-1 silent pump, an automated feeding system, adjustable lighting, a temperature display, and a built-in humidifier. It provides a sophisticated and convenient solution for both beginners and experienced enthusiasts.



Image: The Vehipa Smart Fish Aquarium Kit, highlighting its compact design and integrated features.

## 2. KEY FEATURES

- **All-in-One Smart Ecosystem:** This 4.2-gallon aquarium kit combines a 4-in-1 silent pump, automated feeding system, and built-in humidifier for a complete aquatic environment.
- **Multi-Layer Circulation Filtration System:** Features a 4-in-1 silent water pump (below 35dB) that handles filtration, oxygenation, water circulation, and wave creation. An extended rain pipe provides a visual waterfall effect.
- **Smart Automated Feeding:** An 80ml capacity auto-feeder allows customization of portion sizes and feeding intervals

(12h/24h/48h) to prevent overfeeding and simplify care during absences.

- **Immersive Lighting Experience:** Offers 8 customizable LED colors (white, gradient, green, blue, red, cyan, yellow, purple) with easy mode switching for various ambiance settings.
- **Crystal-Clear Panoramic Viewing:** Constructed with ultra-clear glass, providing 93% light transmittance and 360° HD visibility without green tints.
- **Convenient Integrated Maintenance Design:** A detachable lid facilitates routine water changes and thorough cleaning.
- **Smart Upgrade:** Includes an integrated temperature probe with an LCD display for real-time aquarium temperature monitoring. The built-in humidifier features an independent aromatherapy compartment for diffusing essential oils without contaminating the water.



Image: Overview of the aquarium's multi-functional capabilities.

### 3. SETUP INSTRUCTIONS

Follow these steps to correctly assemble and set up your Vehipa Smart Fish Aquarium Kit:

1. Unpack all components and ensure all parts are present.
2. Open the top lid of the aquarium.
3. Place the filter stones into the designated filter box compartments.
4. Insert the filter sponge into the filter box, ensuring it sits correctly above the filter stones.
5. Assemble the water pump inlet and suction pipe, then attach it to the pump unit.
6. Install the airflow control valve onto the pump unit.
7. Hang the assembled water pump unit securely within the designated area inside the aquarium lid.
8. Connect the rainwater drain pipe to the pump unit and position it over the filter sponge.
9. Place the aromatherapy humidifier box into its slot.
10. Close the top lid.
11. Place the automatic feeder and cover it.
12. Connect the aquarium adapter to a power outlet to complete the installation.

# HOW TO INSTALL FISH TANK?

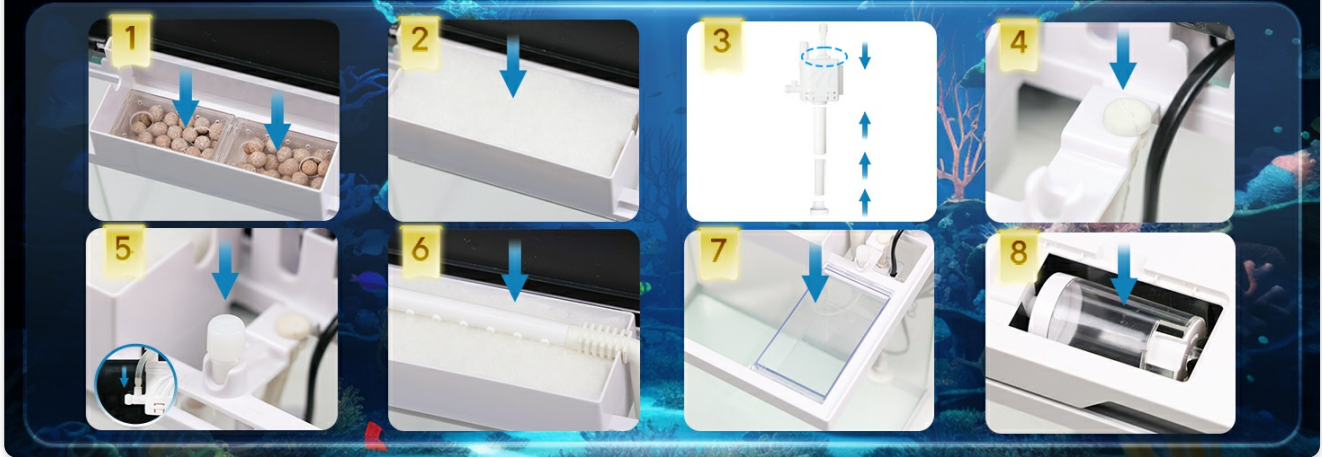

Image: Visual guide for the installation process.

Your browser does not support the video tag.

Video: Detailed installation steps for the Vehipa Smart Fish Aquarium Kit.

## 4. OPERATING INSTRUCTIONS

### 4.1 Automated Feeding System

The auto-feeder has an 80ml capacity. You can program feeding intervals and customize portion sizes:

- **Setting Intervals:** Use the control panel to select feeding intervals of 12 hours, 24 hours, or 48 hours.
- **Customizing Portions:** Adjust the opening on the feeder to control the amount of food dispensed per feeding.



Image: Control panel and auto-feeder details for timed feeding.

### 4.2 Adjustable Lighting

The aquarium features 8 customizable LED colors and adjustable brightness:

- **Changing Colors:** Tap the 'Lighting' button on the control panel to cycle through white, gradient, green, blue, red, cyan, yellow, and purple.
- **Adjusting Brightness:** Use the '+' and '-' buttons to select from 10 brightness levels.
- **Timed Lighting:** Long press the 'Timed Lighting' button to enter timer mode, then tap to switch between 8h, 12h, or 16h durations.

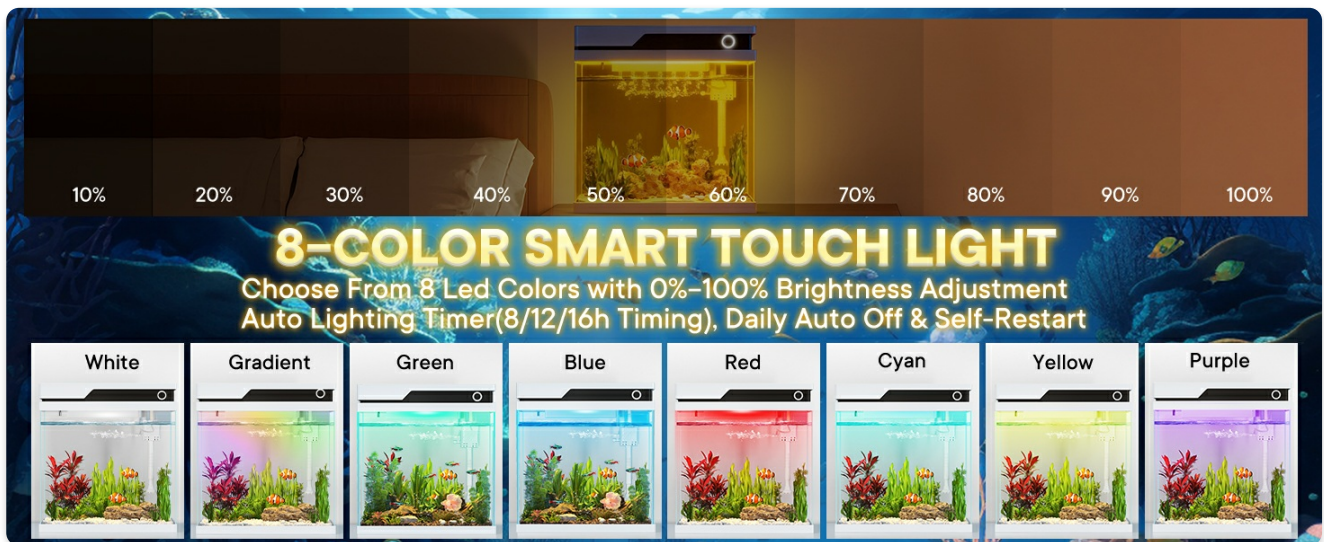

Image: Lighting control and color options.

### 4.3 Humidifier and Aromatherapy

The built-in humidifier can be activated via the control panel. It includes a separate aromatherapy compartment:

- **Activating Humidifier:** Press the 'Humidifier' button on the control panel.
- **Adding Aromatherapy:** Add pure water for humidity or essential oils to the independent aromatherapy compartment. This compartment is designed to prevent oils from mixing with the aquarium water.



Image: Humidifier and aromatherapy feature.

## 5. MAINTENANCE

Regular maintenance ensures a healthy environment for your fish and prolongs the life of your aquarium.

### 5.1 Water Changes and Cleaning

The detachable lid simplifies access for cleaning:

- **Detachable Lid:** The lid can be easily removed or flipped for convenient access during water changes or thorough cleaning of the tank interior and components.
- **Filter Sponge:** The filter sponge is replaceable. Regularly check and replace it to maintain optimal water quality.



Image: Maintenance features for easy cleaning.

## 6. TROUBLESHOOTING

Here are some important notes and tips to prevent common issues:

- **Pump Burnout Prevention:** Always ensure the water pump is fully submerged in water before connecting it to power. Operating the pump dry can lead to damage.
- **Adjusting Water Flow:** Use the built-in airflow control valve to adjust the water flow according to your needs. This is particularly useful for creating a gentle current suitable for delicate fish species like bettas.

## 7. SPECIFICATIONS

Feature	Detail
Brand	Vehipa
Model Number	YYG300
Tank Volume	4.2 Gallons
Material	Glass
Product Dimensions (L x W x H)	11.8"L x 8.26"W x 12.8"H
Color	White
Special Feature	Transparent, Auto Feeder, Adjustable Lighting, Humidifier, Temperature Display
Included Components	Fish Tank Kit (with accessories)
Vivarium Type	Aquarium

# 4.2 GALLON FISH TANK



Image: Product dimensions and humidifier feature.

## 8. WARRANTY & SUPPORT

For detailed warranty information and customer support, please refer to the documentation included with your product or visit the official Vehipa website. Contact information for support services can typically be found in the product packaging or on the manufacturer's website.

