



Manuals.plus /

› CHIQ /

› CHIQ CW8728X 8 KG Front Load Washing Machine User Manual

CHIQ CW8728X

CHIQ CW8728X 8 KG Front Load Washing Machine User Manual

Model: CW8728X

INTRODUCTION

Thank you for choosing the CHIQ CW8728X Front Load Washing Machine. This manual provides essential information for the safe installation, operation, and maintenance of your appliance. Please read it thoroughly before use and keep it for future reference.

SAFETY INFORMATION

Always follow basic safety precautions when using electrical appliances to reduce the risk of fire, electric shock, or injury.

- Ensure the appliance is properly grounded.
- Do not allow children to play with or operate the washing machine.
- Keep packaging materials out of reach of children.
- Do not wash items that have been cleaned in, washed in, soaked in, or spotted with combustible or explosive substances.
- Never force the door open during operation.
- Unplug the appliance before cleaning or performing any maintenance.
- Do not install or store the appliance where it will be exposed to the weather or freezing temperatures.

PRODUCT OVERVIEW

The CHIQ CW8728X is an 8 KG front load washing machine designed for efficiency and convenience. It features a Pure Flat Design for seamless integration into modern living spaces.



Image: CHI Q CW8728X 8 KG Front Load Washing Machine in a modern setting, highlighting its Pure Flat Design.

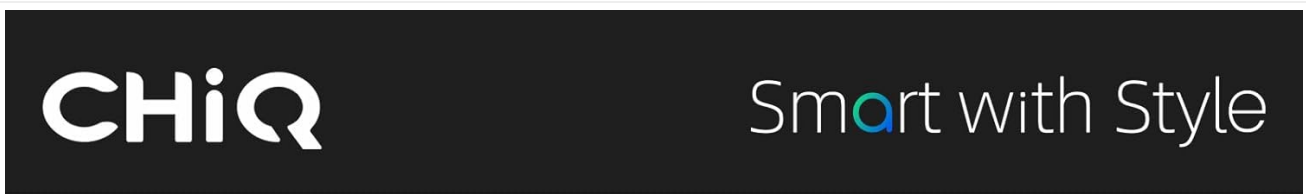





- 
Classe energetica
A -15%
- 
PureFlat
- 
16 programmi
professionali
- 
Doppia autopulizia



Image: CHI Q CW8728X Washing Machine with its key dimensions: 850mm height, 600mm width, and 513mm depth.

SETUP AND INSTALLATION

1. Unpacking and Removing Transport Bolts

Before using the washing machine, it is crucial to remove all transport bolts and brackets from the rear panel. Failure to do so can cause excessive vibrations and noise during operation, potentially damaging the appliance.

Importanti note di installazione

Rimuovere tutte le viti e le staffe dal pannello posteriore prima dell'uso. L'omissione di questa operazione puocaузare eccessive vibrazioni e danni da rumori.

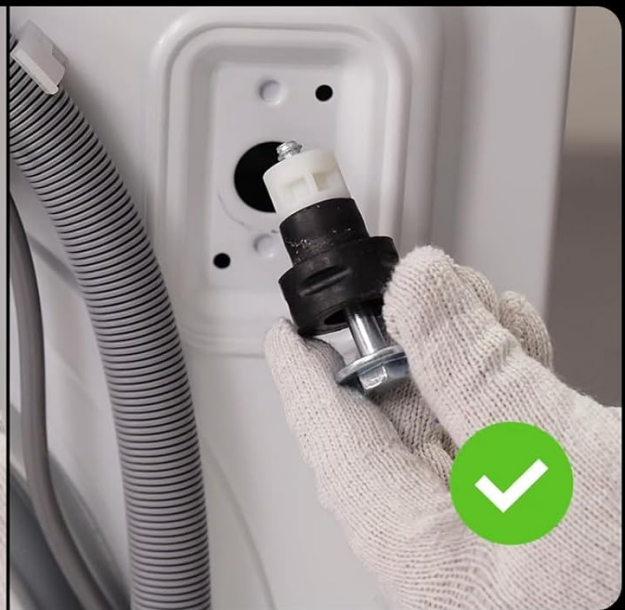

Image: Illustration showing the location of transport bolts on the rear of the washing machine and the correct method for removal.

1. Locate the transport bolts on the rear of the machine.
2. Using an appropriate wrench, loosen and remove all bolts.
3. Remove any plastic spacers or brackets.
4. Insert the plastic caps provided into the holes.

2. Leveling the Machine

Proper leveling prevents excessive vibration and ensures stable operation. Adjust the leveling feet at the bottom of the machine until it is perfectly stable on the floor.

3. Water Connection

Connect the water inlet hose to a cold water tap with a 3/4-inch thread. Ensure all connections are tight to prevent leaks.

4. Drain Hose Installation

Position the drain hose correctly into a standpipe or over the edge of a sink, ensuring it is securely fastened to prevent dislodgement during the wash cycle.

5. Electrical Connection

Plug the power cord into a grounded electrical outlet. Do not use extension cords or adapters.

OPERATING INSTRUCTIONS

1. Control Panel Overview

The washing machine features an intuitive control panel with an ergonomic dial and touch buttons for program selection and settings adjustment.



Image: Close-up of the washing machine's control panel, showing the program dial, digital display, and touch-sensitive buttons.

2. Loading Laundry

Open the door and load laundry into the drum. Do not overload the machine; ensure there is enough space for clothes to move freely. The extra-large 530mm drum is designed for optimal movement.



Image: Diagram illustrating the spacious 530mm drum interior, designed for effective stain removal and gentle fabric care.

3. Adding Detergent

Pull out the detergent drawer and add the appropriate amount of detergent and fabric softener to the designated compartments. Refer to detergent packaging for dosage recommendations.

4. Program Selection

Turn the program dial to select one of the 16 available wash programs. The display will show the default settings for the chosen program. You can adjust temperature and spin speed as needed.



Image: The control panel showing various wash programs and options, including Cotton, Mix, Anti-allergy, Wool, Baby Care, and Steam.

5. Special Functions

- **Steam Care SPA:** This function uses high-temperature steam to penetrate fabric fibers, effectively removing odors and keeping garments soft and pleasant to the touch. It provides gentle care without direct water usage.



Image: Visual representation of the Steam Care SPA feature, showing steam enveloping a white shirt inside the drum.

- **One-Touch Smart Wash:** The washing machine automatically detects the load size and optimizes water consumption and cycle duration for efficient cleaning. This simplifies program selection.



Lavaggio smart One-Touch

La lavatrice rileva automaticamente il carico e ottimizza le impostazioni, rendendo l'utilizzo semplice per tutti ed eliminando ogni incertezza nella scelta del programma.

Image: The washing machine in a laundry room with an 'AI One Touch' icon, indicating the smart wash feature.

- **Smart Delay Start:** Program your wash cycle to start up to 24 hours in advance, allowing you to take advantage of off-peak electricity rates or have laundry ready at a convenient time.



Avvio ritardato intelligente

Fino a 24 ore di avvio ritardato, per programmare i lavaggi nelle fasce orarie più convenienti e adattarli facilmente alla tua routine.

Image: The washing machine at night with a '24h' overlay, illustrating the delay start function.

- **15-Minute Quick Wash:** Ideal for small loads of lightly soiled items or for when you need clothes quickly. This program completes a wash and rinse cycle in just 15 minutes.



Lavaggio rapido in 15 minuti

Ideale per piccoli carichi di capi quotidiani, completa rapidamente lavaggio e risciacquo per esigenze dell'ultimo minuto o sporco leggero.

Image: Dynamic graphic showing water and clothes inside the drum with a '15 MIN' timer, representing the quick wash cycle.

- **Multi-Temperature Options:** Select the ideal temperature for each fabric type or stain, from cold washes for delicate items to high temperatures for deep hygiene.

Opzioni multi-temperatura

Scegli la temperatura ideale per ogni tessuto o tipo di macchia, dai lavaggi a freddo per i capi delicati a quelli ad alta temperatura per un'igiene profonda.

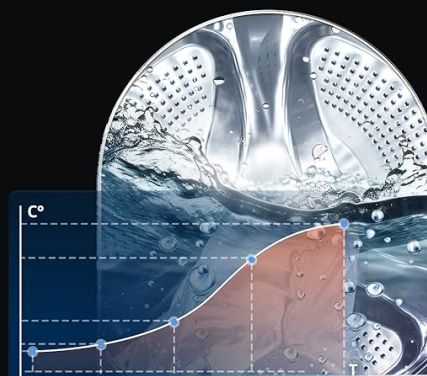

Image: A graph illustrating temperature progression during a wash cycle, highlighting multi-temperature capabilities.

- **PureDrum Technology:** Features plasma welding and a special droplet texture to significantly reduce fabric wear and fiber snagging, protecting garments with delicacy.

PureDrum

Grazie alla saldatura al plasma e alla speciale texture a goccia d'acqua, riduce in modo significativo l'usura dei tessuti e l'aggancio delle fibre, proteggendo i capi con delicatezza.



Image: Stylized representation of the PureDrum interior with water droplets, emphasizing its gentle washing action.

6. Starting a Wash Cycle

Press the 'Start/Pause' button to begin the selected wash cycle. The machine will automatically proceed through the washing, rinsing, and spinning phases.

MAINTENANCE

Regular maintenance ensures optimal performance and extends the lifespan of your washing machine.

1. Cleaning the Detergent Drawer

Remove the detergent drawer and rinse it under running water to remove any detergent residue. Clean the housing of the drawer with a brush if necessary.

2. Dual Self-Cleaning

The machine features a dual self-cleaning function for both the drum and the door gasket. High-temperature, high-velocity water jets clean the inner and outer drum, preventing recontamination. High-pressure rinses during the cycle prevent mold formation on the door gasket.

Doppia autopulizia

Pulizia di porta e guarnizione:
Risciacqui ad alta pressione durante il ciclo prevengono la formazione di muffa.

Autopulizia del cestello: Getti d'acqua ad alta temperatura e velocità puliscono cestello interno ed esterno, evitando la ricontaminazione.



Image: Diagram illustrating the dual self-cleaning process, showing water jets cleaning the drum and the door gasket.

3. Cleaning the Pump Filter

Periodically clean the pump filter, usually located at the bottom front of the machine, to remove lint, coins, or other small objects that may have accumulated.

4. Cleaning the Exterior

Wipe the exterior of the washing machine with a soft, damp cloth. Do not use abrasive cleaners or solvents.

TROUBLESHOOTING

If you encounter any issues, refer to the table below for common problems and their solutions.

Problem	Possible Cause	Solution
Machine does not start	Power cord unplugged; Door not closed properly; Program not selected; Start/Pause button not pressed.	Check power connection; Close door firmly; Select a program; Press Start/Pause.
Excessive vibration/noise	Transport bolts not removed; Machine not level; Overloaded drum; Laundry unevenly distributed.	Remove transport bolts; Adjust leveling feet; Reduce load size; Redistribute laundry.
Water leakage	Inlet/drain hose loose; Detergent drawer clogged; Too much detergent.	Tighten hose connections; Clean detergent drawer; Use less detergent.
Water not draining	Drain hose kinked/blocked; Pump filter clogged.	Straighten drain hose; Clean pump filter.
Door will not open	Cycle still running; Water in drum; Child lock activated.	Wait for cycle to finish; Select drain program; Deactivate child lock.

SPECIFICATIONS

Technical details for the CHIQ CW8728X Washing Machine.

Feature	Detail
Model Name	CW8728X
Brand	CHiQ
Capacity	8 Kilograms
Dimensions (DxWxH)	51.3P x 60l x 85H cm
Max Spin Speed	1400 Revolutions per minute
Energy Efficiency Class	A-15%
Motor Type	BLDC Inverter Motor
Drum Material	Stainless Steel
Weight	60 Kilograms
Special Features	Delay Start, Child Lock, Steam Care, One-Touch Wash
Installation Type	Free-standing

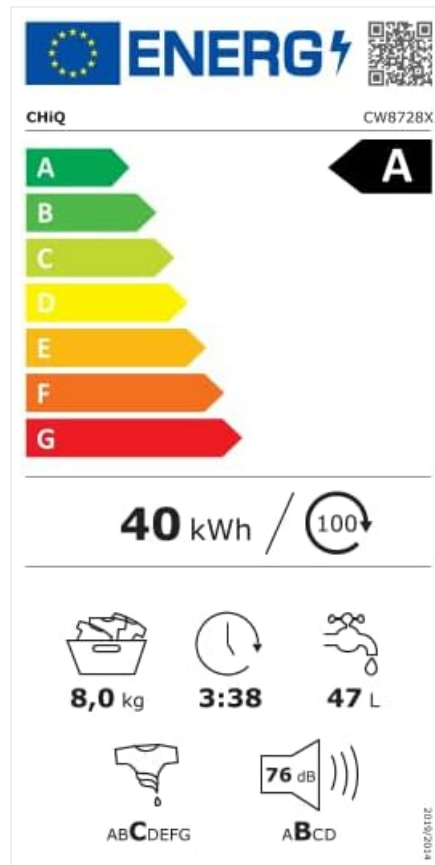

Image: The official EU Energy Label for the CHiQ CW8728X, detailing its energy consumption, water usage, capacity, and noise levels.

Motore Inverter BLDC

Potente, con un ampio intervallo di velocità (500-1400 RPM) per prestazioni silenziose ed efficienti dal punto di vista energetico.

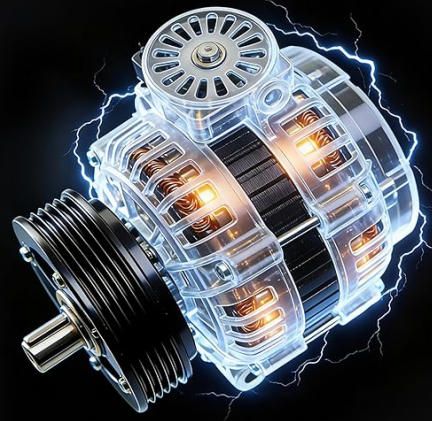

Image: An illustration of the BLDC Inverter Motor, highlighting its internal components and emphasizing its quiet and efficient operation.

WARRANTY AND SUPPORT

Warranty Information

This CHiQ CW8728X Washing Machine comes with a **2-year manufacturer warranty**. Please retain your proof of purchase for any warranty claims. The motor is covered by a 12-year warranty.

CHiQ

Smart with Style



Image: The CHI Q CW8728X washing machine displayed with a prominent '12 years motor warranty' emblem.

Customer Support

For technical assistance, spare parts, or service requests, please contact CHI Q customer support. You can find contact details on the official CHI Q website or through your retailer.

Visit the official CHI Q store for more information: [CHI Q Store](#)