

VUBBJCRS F6040

VUBBJCRS F6040 AC 220V COB LED Chip Instruction Manual

Model: F6040 | Brand: VUBBJCRS

1. INTRODUCTION

Thank you for choosing the VUBBJCRS F6040 AC 220V COB LED Chip. This product is designed for various lighting applications, offering high brightness and efficiency without the need for an external driver. This manual provides essential information for safe installation, operation, and maintenance of your LED chip.

2. SAFETY INFORMATION

- **Electrical Hazard:** This product operates on AC 220V. Always ensure the power supply is disconnected before installation, maintenance, or troubleshooting to prevent electric shock.
- **Professional Installation:** Installation should only be performed by qualified personnel or under the supervision of an electrician.
- **Heat Dissipation:** The LED chip generates heat during operation. Ensure adequate heat dissipation by mounting it on a suitable heat sink or in a fixture designed for proper thermal management. Overheating can reduce lifespan and performance.
- **Eye Protection:** Do not stare directly into the illuminated LED chip, as the intense light can cause eye strain or damage.
- **Environmental Conditions:** Do not expose the chip to excessive moisture, extreme temperatures, or corrosive environments unless specifically rated for such conditions.

3. PRODUCT OVERVIEW

The VUBBJCRS F6040 COB LED Chip integrates advanced technology for superior performance and ease of use. It features a Smart IC for intelligent temperature control and direct AC 220V operation.



Figure 3.1: A VUBBJCRS F6040 50W COB LED Chip, shown as part of a 6-piece set, emitting white light.

Key Features:

- **Smart IC:** Intelligently controls the heat dissipation of the lamp body, extending the product's lifespan.
- **COB Chip:** Super bright, offering brightness three times that of ordinary lamp beads.
- **Highly Sensitive Circuit Board:** Utilizes a stable circuit design for consistent lighting performance.
- **Aviation Cooling Aluminum:** High-quality heat dissipation materials ensure efficient cooling.

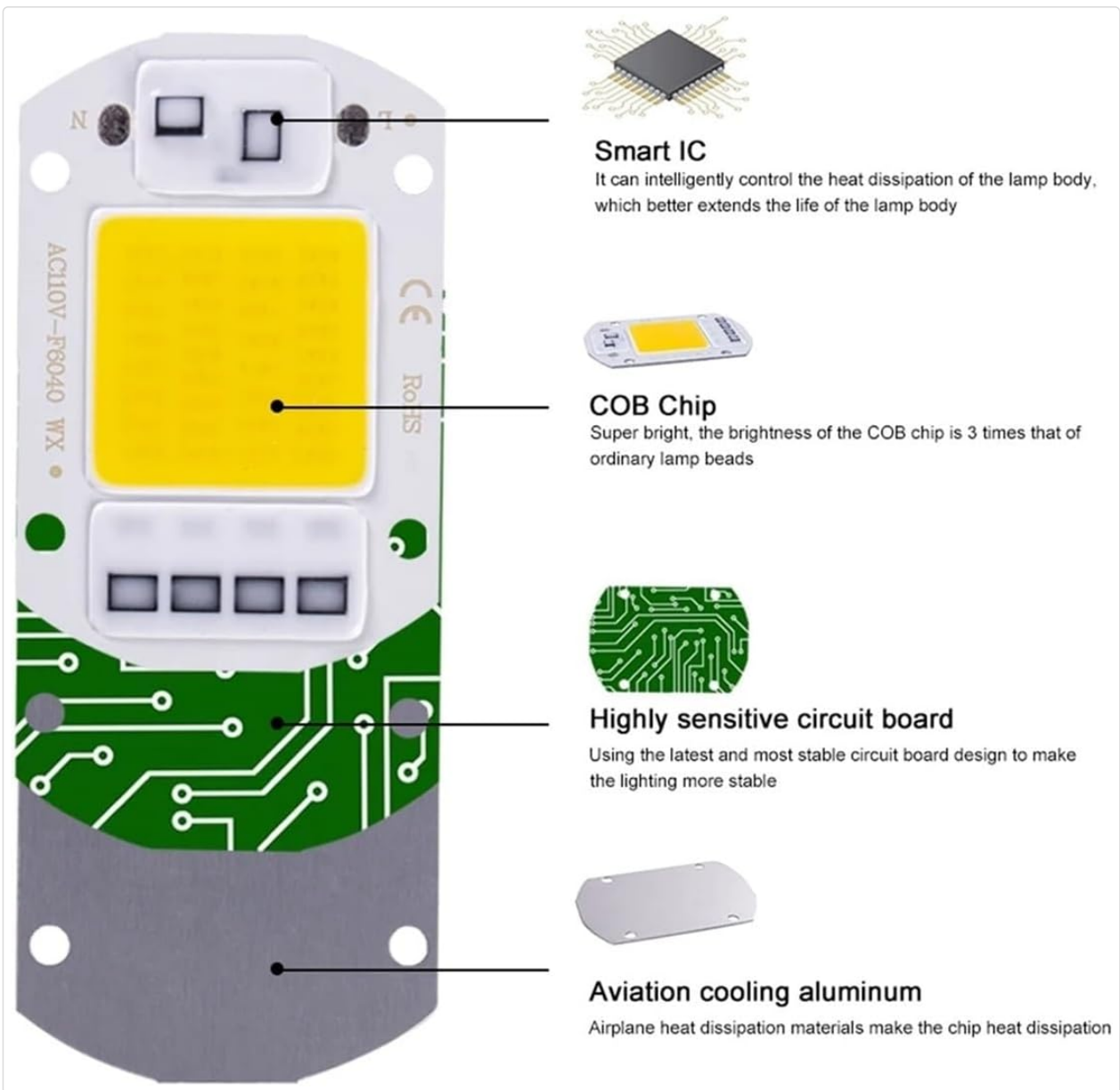

Figure 3.2: Detailed view of the F6040 COB LED chip highlighting its internal components and features.

The F6040 series is available in various wattages, including 20W, 30W, and 50W, to suit different lighting requirements.



Name : COB Chip	Power : 20W/30W/50W
Material : Aluminum	Voltage : AC110/220V
Color : Warm white/White	Chip : COB Chip
Life :30000h	Size : 60MM*40MM*0.8MM

Figure 3.3: Visual comparison of the 50W, 30W, and 20W VUBBJCRS F6040 COB LED chips.

4. SETUP AND INSTALLATION

The VUBBJCRS F6040 COB LED Chip is designed for direct connection to an AC 220V power supply, eliminating the need for an external driver. Follow these steps for proper installation:

1. **Disconnect Power:** Ensure the main power supply is turned off at the circuit breaker before beginning any installation work.
2. **Prepare Mounting Surface:** Mount the LED chip onto a suitable heat sink or fixture that can effectively dissipate heat. Use thermal paste if recommended for your specific application to ensure optimal heat transfer.
3. **Wiring:** Connect the 'L' (Live) terminal of the LED chip to the Live wire of your AC 220V power supply. Connect the 'N' (Neutral) terminal of the LED chip to the Neutral wire of your AC 220V power supply. Ensure all connections are secure and insulated.
4. **Secure the Chip:** Fasten the LED chip securely to the heat sink or fixture using appropriate screws or mounting hardware.
5. **Test:** Once all connections are secure and the chip is properly mounted, restore power and test the functionality of the LED chip.

Smart IC Fit No Driver

AC220V

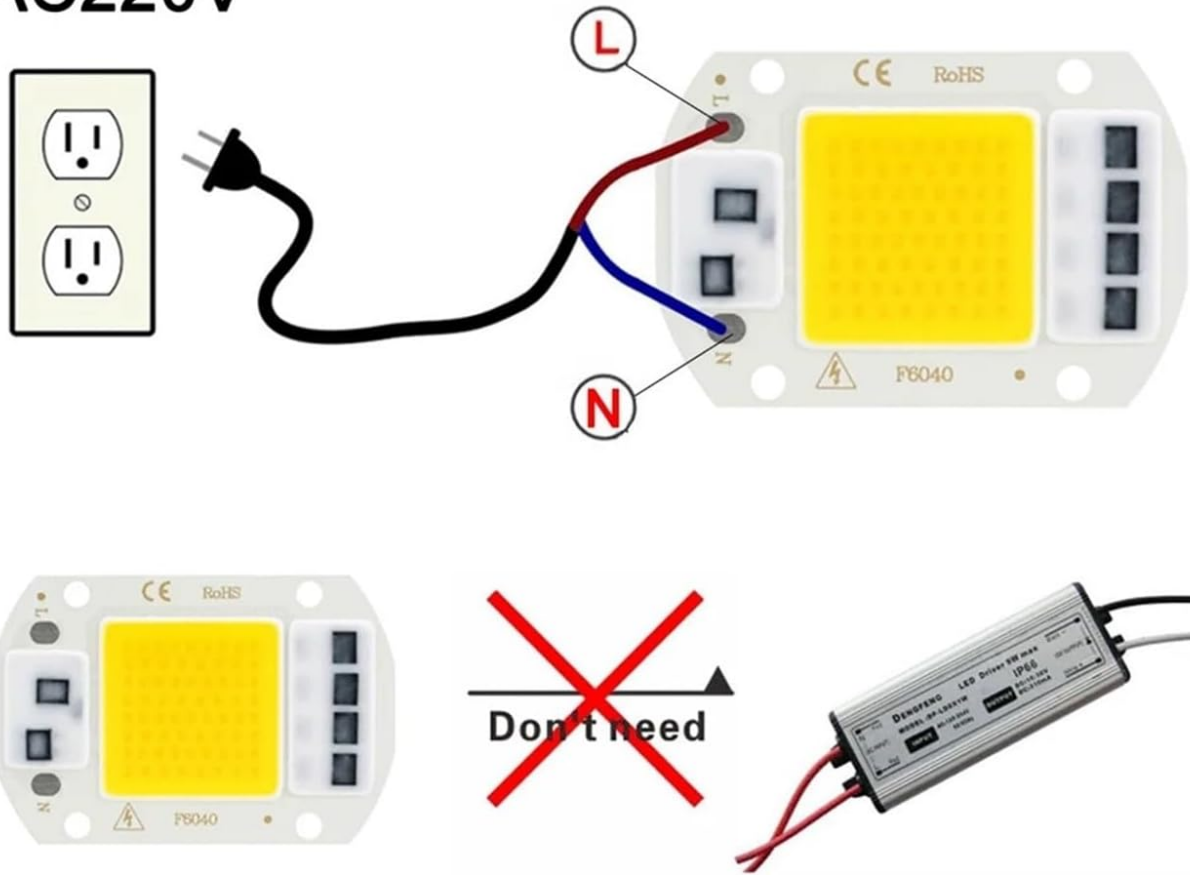

Figure 4.1: Wiring diagram showing direct connection of the F6040 COB LED chip to an AC 220V power source.

5. OPERATING INSTRUCTIONS

Once properly installed and connected to a compatible AC 220V power supply, the VUBBJCRS F6040 COB LED Chip will illuminate when power is applied. No additional controls or drivers are required for basic operation.

- Ensure the power supply voltage matches the chip's requirement (AC 220V).
- Avoid frequent power cycling, which can reduce the lifespan of the LED.

6. MAINTENANCE

The VUBBJCRS F6040 COB LED Chip requires minimal maintenance. Follow these guidelines to ensure optimal performance and longevity:

- **Cleaning:** Periodically clean the surface of the LED chip and any associated heat sink to remove dust and debris. Use a soft, dry cloth. Do not use abrasive cleaners or solvents.
- **Inspection:** Regularly inspect the wiring and connections for any signs of wear, damage, or loose contacts.
- **Thermal Management:** Ensure that the heat sink or fixture remains unobstructed to allow for proper airflow and heat dissipation.

- **Power Off:** Always disconnect power before performing any cleaning or inspection.

7. TROUBLESHOOTING

If you encounter issues with your VUBBJCRS F6040 COB LED Chip, refer to the following troubleshooting guide:

- **LED does not light up:**
 - Check if the power supply is connected and active.
 - Verify that the 'L' and 'N' connections are correctly wired and secure.
 - Ensure the input voltage is AC 220V.
 - Inspect the chip for any visible damage.
- **LED flickers or has unstable light:**
 - Check for loose wiring connections.
 - Ensure the power supply is stable and free from voltage fluctuations.
 - Verify that the chip is not overheating due to insufficient heat dissipation.
- **Reduced brightness or premature failure:**
 - Ensure proper heat dissipation. Prolonged overheating significantly reduces LED lifespan.
 - Verify that the operating voltage is within the specified range.

If problems persist after following these steps, contact customer support for further assistance.

8. SPECIFICATIONS

Feature	Specification
Brand	VUBBJCRS
Model	F6040
Power Options	20W, 30W, 50W
Voltage	AC 220V
Chip Type	COB (Chip On Board)
Material	Acrylonitrile Butadiene Styrene (ABS), Aluminum
Color Temperature	White (also available in Warm White)
Lifespan	Approx. 30,000 hours
Dimensions (50W)	60mm * 40mm * 0.8mm (approx.)
Driver Requirement	No external driver needed (Smart IC integrated)

9. WARRANTY AND SUPPORT

For warranty information and customer support, please refer to the seller's policies or contact the retailer

where the product was purchased. Keep your purchase receipt as proof of purchase.