

[Manuals.plus](#) /

> [UIRWAY](#) /

> Uirway 600D Heavy Duty 10ft Round Pool Cover Instruction Manual

UIRWAY 10ft Round Pool Cover (Model: Poolabdeckplane)

Uirway 600D Heavy Duty 10ft Round Pool Cover Instruction Manual

Model: Poolabdeckplane (Part No. 557816_1-JJEU)

1. PRODUCT OVERVIEW

The Uirway 600D Heavy Duty Round Pool Cover is designed to protect above-ground pools from environmental elements such as rain, snow, leaves, dust, and debris. Constructed from upgraded 600D thickened Oxford fabric, it offers enhanced durability, tear resistance, and UV protection. The cover features a robust windproof system, including a 4-point side lace-up drawstring with ratchet locking, reinforced edge loops, and anti-slip straps to ensure a secure fit.



Image: The Uirway 600D pool cover highlights its upgraded 600D fabric, tear-resistant properties, and reinforced double stitching for durability. It contrasts with a torn cover, emphasizing its strength.

Your browser does not support the video tag.

Video: This video demonstrates the general features and application of Uirway pool covers for above-ground pools, showcasing its protective qualities.

2. SAFETY INFORMATION

- **Water Accumulation:** Promptly drain any water that accumulates on the cover to prevent excessive weight, which can cause the cover to slide or become damaged.
- **Secure Fastening:** Always ensure the cover is securely fastened using all provided straps, drawstrings, and the ratchet locking system to prevent accidental entry by children or pets.
- **Nighttime Visibility:** The reflective straps enhance visibility during nighttime, reducing the risk of accidental trips or falls around the covered pool area.

WINDPROOF 4-POINT SIDE TIE-DOWN

Triple Wind-Resistant Protection



Drain accumulated water promptly to prevent cover sliding caused by excess weight.



Normal Only Single Strap

Image: This image illustrates the windproof 4-point side tie-down system and includes a crucial reminder to drain accumulated water promptly to prevent cover sliding due to excess weight.

3. SETUP AND INSTALLATION

3.1 Choosing the Correct Size

Measure the longest outer diameter of your pool. The cover size should match or slightly exceed your pool's outer diameter. If using a pool pillow, consider choosing one size larger for optimal fit.

UV RESISTANT FADE-RESISTANT

Prevent Your Pool from
Turning Green

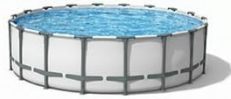

Image: A diagram illustrating how to measure the outer diameter of a round pool to select the correct cover size. It also shows the included accessories: anti-slip straps and ratchet locking.

3.2 Installation Steps

1. **Prepare the Pool:** Ensure the pool area is clear of sharp objects that could damage the cover.
2. **Attach Anti-Slip Straps:** Secure the anti-slip straps to the pool frame. These straps help prevent the cover from slipping during installation and use.
3. **Drape the Cover:** Carefully drape the pool cover over the pool, ensuring it is centered and evenly distributed.
4. **Tighten Ratchet Locking:** Engage the 4-point side lace-up drawstring with the ratchet locking system. Tighten the ratchets to create a snug fit around the pool.
5. **Adjust Drawstring:** Pull and tighten the full-circle drawstring to further secure the cover, reducing movement and lifting, especially in windy conditions.

POOL TYPE COMPATIBILITY



Cover Size	Frame Pools	Inflatable Pool	Wall Pools
10 ft	10 ft	10 ft	12 ft
12 ft	12 ft	12 ft	14 ft
13-14 ft	14 ft	14 ft	15 ft
15 ft	15 ft	15 ft	16 ft
16 ft	16 ft	16 ft	18 ft
18 ft	18 ft	18 ft	/

Installation Steps



Remove Plastic Film



Tie-Down Anti-Slip Straps



Cover The Pool

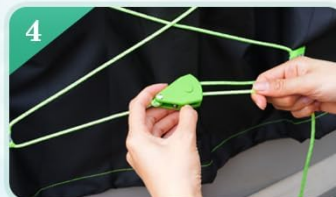

Tighten with ratchet locking



Tighten the Drawstring

Image: A step-by-step visual guide demonstrating the installation process of the pool cover, from attaching anti-slip straps to tightening the drawstring and ratchet locking.

4. OPERATING INSTRUCTIONS

Once installed, the Uirway pool cover provides continuous protection. Its primary function is to keep debris out of the pool and reduce water evaporation. The UV-resistant material with a PU coating helps prevent the pool water from turning green by blocking sunlight and slowing color fading of the cover itself.

- **Debris Protection:** The cover effectively blocks leaves, dust, and other debris from entering the pool, keeping the water cleaner.
- **UV Protection:** The material provides UV protection, which helps inhibit algae growth and reduces the need for frequent chemical treatments.
- **Evaporation Reduction:** The cover minimizes water evaporation, conserving water and maintaining pool temperature.

CHOOSE THE RIGHT SIZE

Measure Your Pool's Longest Outer Diameter



Match or slightly exceed your pool's outer diameter.

INCLUDES ACCESSORIES



12 x Anti-slip Straps



4x Locking Ratchet Pre-installed the Cover



If using a Pool Pillow, choose a larger cover size.

Image: This image illustrates the UV-resistant and fade-resistant properties of the pool cover, showing how it prevents the pool from turning green and reduces water evaporation.

Your browser does not support the video tag.

Video: This video provides a detailed look at the 600D Pool Cover, showcasing its material quality, secure fit, and overall effectiveness in protecting the pool.

5. MAINTENANCE

- **Regular Cleaning:** Periodically clean the top surface of the cover to remove accumulated leaves, dirt, and other debris. A soft brush or hose can be used.
- **Drain Water:** As mentioned in safety, always drain accumulated rainwater promptly to prevent stress on the cover and pool structure.
- **Inspect Straps and Ratchets:** Regularly check the anti-slip straps, drawstrings, and ratchet locking system for any signs of wear or damage. Ensure they are functioning correctly to maintain a secure fit.
- **Storage:** When not in use for extended periods, clean the cover thoroughly, allow it to dry completely, and store it in a cool, dry place away from direct sunlight to prolong its lifespan.

HEAVY-DUTY LOAD-BEARING

Helps distribute weight
and reduce strain.



Anti-Slip Straps
Widened 2.5cm



Tear-Resistant
Reinforced Seams



Image: This image illustrates the heavy-duty load-bearing capability of the cover, highlighting the anti-slip straps and tear-resistant reinforced seams, which are important for maintenance checks.

6. TROUBLESHOOTING

- **Issue: Water pooling on the cover.**

Solution: This is normal with heavy rainfall. Promptly drain the water using a pump or by carefully lifting an edge. Failure to do so can lead to cover damage or sliding.

- **Issue: Cover does not feel secure or lifts in wind.**

Solution: Ensure all anti-slip straps are properly attached to the pool frame. Verify that the ratchet locking system is fully tightened and the drawstring is pulled taut. Inspect for any loose connections.

- **Issue: Ratchet mechanism not tightening properly.**

Solution: Check the threading of the rope through the ratchet. Some ratchets may be threaded backwards from the factory. If so, pull out the rope and reverse its direction through the ratchet mechanism. An indicator may be stamped on the ratchet for correct direction.

- **Issue: Cover appears to be tearing at stress points.**

Solution: While the cover features extra-strength stitching, ensure that water accumulation is regularly drained

to prevent undue stress. If tears occur, small repair kits for Oxford fabric may be used for minor damage.

7. SPECIFICATIONS

Size	10' (Round)
Color	Black
Material	600D Oxford Fabric
Product Dimensions	120"L x 120"W
Model Name	swimming pool cover
Model Number	Poolabdeckplane
Manufacturer Part Number	557816_1-JJEU
Closure Type	Drawstring

8. WARRANTY AND SUPPORT

- **Warranty:** This product comes with a 1-year warranty against manufacturing defects.
- **Returns:** A 30-day return policy is available for this product.
- **Customer Support:** For any inquiries or support needs, please contact UIRWAY customer service. We aim to respond within 24 hours.

For more information or to contact support, please visit the [UIRWAY Store on Amazon](#).