

[Manuals.plus](#) /

› [ASMAX](#) /

› ASMAX F1s Motorcycle Bluetooth Headset Instruction Manual

ASMAX F1s

ASMAX F1s Motorcycle Bluetooth Headset Instruction Manual

Model: F1s

INTRODUCTION

The ASMAX F1s Motorcycle Bluetooth Headset is designed to enhance your riding experience with advanced communication and entertainment features. This manual provides detailed instructions for setup, operation, and maintenance to ensure optimal performance and safety.

Key features include Mesh 5.0 intercom for up to 10 riders, CloudTalk Mode for up to 50 riders, natural AI voice control, smart app integration, audio multitasking, 7-layer noise cancellation, fast charging, and a quick-release mount.

WHAT'S IN THE BOX

- F1s Motorcycle Bluetooth Headset (Main Unit)
- Wired Mic & Boom Mic
- 40mm Speakers
- Quick-Release Mount
- User Manual
- 3M Glue Plate
- Metal Clamp
- Velcro for Speaker Unit
- Speaker Pads
- Extra Microphone Sponge
- Velcro for Hybrid Microphone
- Velcro for Wired Microphone
- Type-C Charging Cable
- Cleaning Pack

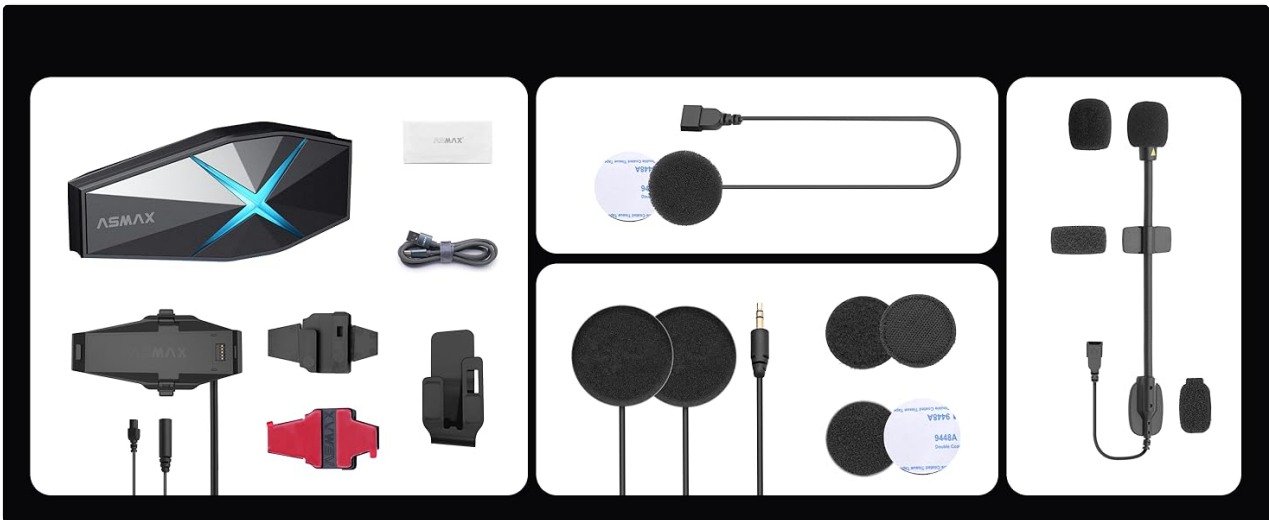

Figure 1: All components included in the ASMAX F1s package.

SETUP

1. Mounting the Device to Your Helmet

Choose between the metal clamp or the 3M glue plate for mounting. If your helmet's edge thickness is greater than 5mm, the 3M glue plate is recommended. For this demonstration, we will use the metal clamp.

1. Attach the magnetic mount to your chosen metal clamp or 3M glue plate.
2. Securely attach the mount to the outside of your helmet.

Your browser does not support the video tag.

Video 1: Demonstration of attaching the magnetic mount to the helmet using the metal clamp (01:51 - 02:30).

2. Speaker Installation

Remove the helmet's internal padding to access the speaker placement area. Apply the Velcro pads to the helmet interior where your ears will be positioned. Attach the speakers, ensuring the shorter cord side is closer to the mount.

Your browser does not support the video tag.

Video 2: Step-by-step guide for installing the speakers into the helmet (02:30 - 04:02).

3. Microphone Installation

Attach the wired microphone's Velcro to the inside of your helmet, as close to the front as possible without obstructing your vision. Connect the microphone wire to the magnetic base.

Your browser does not support the video tag.

Video 3: Instructions for installing the wired microphone and connecting it to the magnetic base (04:02 - 04:43).

4. Wire Management

Connect the longer speaker wire to the magnetic base. Carefully tuck all wires underneath the helmet's top padding. Ensure no wires are hanging out before reinserting the padding.

Your browser does not support the video tag.

Video 4: Guide on routing and securing internal wires for a clean installation (05:26 - 06:39).

5. Attaching the Main Unit

Once all internal components are installed, attach the F1s main unit to the magnetic base on the outside of your helmet. It will click securely into place.

Your browser does not support the video tag.

Video 5: Demonstrating the quick and secure attachment of the main unit to the helmet (06:46 - 07:01).

6. Power On/Off

To power on the device, press and hold both the Function and Intercom buttons simultaneously until you hear the power-on prompt. To power off, repeat the same action.

Your browser does not support the video tag.

Video 6: How to power on and off the ASMAX F1s device (07:30 - 07:49 and 09:50 - 10:06).

7. Bluetooth Pairing & App Connection

Open your phone's Bluetooth settings. On the ASMAX F1s, long-press the Function key to enter pairing mode. Select the ASMAX F1s device on your phone. Once connected, open the ASMAX World app, tap the plus sign, and select your device to connect.

Your browser does not support the video tag.

Video 7: Detailed steps for Bluetooth pairing with your phone and connecting to the ASMAX World app (07:49 - 08:35).

OPERATING MODES

1. Free Mode Intercom

Free Mode is a public communication channel that anyone can join without needing to create a group. Up to 10 people can join your Free Mode communication channel at once. To activate/deactivate, short press the Intercom button or use the voice command "Hi Max, Free Mode".

Your browser does not support the video tag.

Video 8: Explanation and demonstration of Free Mode intercom (00:00 - 00:53).

2. Group Mode Intercom (Mesh)

Group Mode uses Mesh 5.0 and Bluetooth 5.3 technology for stable connections over longer distances (up to 1.8 km). Up to 10 riders can join. Pairing is a one-time setup. To start Group Mode, press and hold the Intercom button. The knocking function allows you to join a group by double-clicking the Function key and then knocking on the device.

Your browser does not support the video tag.

Video 9: Demonstration of starting Group Mode and using the knocking function (00:53 - 01:55).

3. Switching Between Modes

Once different rooms (modes) are created, you can switch from Group Mode to Free Mode or return to standby with a simple press of the Intercom button.

Your browser does not support the video tag.

Video 10: How to switch between different intercom modes (01:55 - 02:09).

4. Universal Pairing with Other Brands

The F1s supports universal pairing, allowing you to intercom with other brands' headsets. Place the other brand's headset into pairing mode, then long-press the Function key on your ASMAX F1s to enter pairing mode. Double-click the Intercom key to connect. To leave, double-click the Function key again.

Your browser does not support the video tag.

Video 11: Guide on universal pairing with non-ASMAX headsets (02:09 - 03:01).

5. Multi-Device Intercom

To connect another ASMAX Bluetooth device after setting up a bridge network, simply establish a new team network with the additional ASMAX Bluetooth device to create a three-way intercom.

Your browser does not support the video tag.

Video 12: Instructions for setting up a multi-device intercom (03:01 - 03:14).

VOICE CONTROL

The ASMAX F1s supports intelligent voice operations for controlling basic functions like music, calls, and GPS. Offline voice commands work even without a network. For a complete list of basic voice commands, refer to page 13 of your user manual.

Your browser does not support the video tag.

Video 13: Overview of voice control features and basic commands (03:14 - 04:00).

1. Music Control

When music is playing, short press the Function button to play/pause. Hold the Volume Down button for the next track, or Volume Up for the previous track. You can also tap Volume Up/Down to adjust the volume. Alternatively, use voice commands like "Hi Max, Next Track" or "Hi Max, Volume Up/Down".

Your browser does not support the video tag.

Video 14: Controlling music playback using physical buttons and voice commands (10:40 - 11:32).

2. Call Management

To pick up an incoming call, press any button. To hang up, press the Intercom button. If you wish to hang up a call you are dialing or receiving, long press the Intercom button. You can also enable auto-answer for incoming calls or "calling join in mesh" for calls to automatically join your team intercom chat via the ASMAX World app.

Your browser does not support the video tag.

Video 15: Managing phone calls and using auto-answer features (11:32 - 12:33).

ASMAX WORLD APP FEATURES

The ASMAX World app allows you to control various functions of your F1s headset. You can adjust sound and volume settings, personalize LED colors and flash frequency, and turn the knocking function on or off. The app also facilitates OTA firmware updates to keep your headset up-to-date.

Your browser does not support the video tag.

Video 16: Exploring the ASMAX World app for customization and control (08:35 - 09:50).

MAINTENANCE

- **Cleaning:** Use the provided cleaning pack to gently wipe the device. Ensure the charging port cover is securely closed to prevent water damage.
- **Battery Care:** The 1250mAh battery charges fully in approximately 50 minutes. Avoid extreme temperatures to prolong battery life. The device supports use while charging.
- **Water Resistance:** The F1s is IP67 waterproof and dustproof. Ensure all ports are sealed when exposed to water or dust.

TROUBLESHOOTING

Factory Reset

To restore the device to factory settings, long press the Function key and the Volume Up key simultaneously. The device will reboot for about 30 seconds and reset.

Your browser does not support the video tag.

Video 17: How to perform a factory reset on your ASMAX F1s (10:06 - 10:32).

For other issues, please refer to the detailed user manual or contact ASMAX customer support.

SPECIFICATIONS

Feature	Detail
Brand	ASMAX
Model Name	F1s
Connectivity Technology	Wireless (Bluetooth 5.3, Mesh)
Intercom Capacity	Mesh: Up to 10 riders (1.8 km); CloudTalk: Up to 50 riders (unlimited range)

Voice Control	Smart AI Voice Control (Offline & Online)
Noise Control	7-Layer Noise Cancellation (ENC, DSP, CVC)
Battery Capacity	1250mAh
Battery Charge Time	50 minutes
Battery Average Life	22 hours talk, 35 hours music, 192 hours standby
Water Resistance Level	IP67 Waterproof
Audio Driver Size	40 Millimeters
Item Weight	50 Grams

WARRANTY & SUPPORT

The ASMAX F1s Motorcycle Bluetooth Headset comes with a **2-year warranty**. For any product inquiries, technical assistance, or warranty claims, please contact ASMAX customer support through the ASMAX World app or visit the official ASMAX website.

Regular firmware updates are available via the ASMAX World app to ensure your device always has the latest features and performance enhancements.