

Epson ET-2980

Epson EcoTank ET-2980 Wireless All-in-One Printer User Manual

Model: ET-2980

INTRODUCTION

This manual provides detailed instructions for the setup, operation, maintenance, and troubleshooting of your Epson EcoTank ET-2980 Wireless All-in-One Printer. Please read this manual thoroughly to ensure proper use and optimal performance of your device.

UNPACKING AND INITIAL SETUP

What's in the Box

Carefully remove all components from the packaging. Ensure all items listed below are present:

- Epson EcoTank ET-2980 Printer
- Power Cord
- 1 bottle of 502 Black Ink (127 mL)
- 1 bottle each of 502 Cyan, Magenta, Yellow Ink (70 mL)
- Setup Guide / Manual

What's in the Box

EcoTank® ET-2980

All-in-One Supertank Printer



Power Cord (USB not included)

Start Here Guide

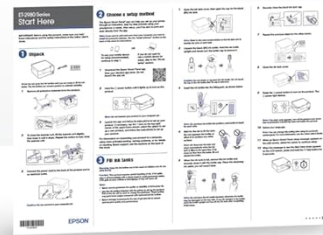

EcoTank 502® Ink Bottles

* We recommend genuine Epson® ink for the best print quality and performance.

Image: Contents of the Epson EcoTank ET-2980 box, including the printer, power cord, ink bottles, and documentation.

Powering On

1. Connect the power cord to the printer and then to an electrical outlet.
2. Press the power button to turn on the printer.
3. Follow the on-screen instructions on the 1.44-inch color display for initial setup.

Filling the Ink Tanks

The EcoTank ET-2980 uses refillable ink tanks. Use only genuine Epson 502 ink bottles for optimal performance and to prevent damage.

1. Open the ink tank unit cover on the side of the printer.
2. Open the cap for the black ink tank.
3. Uncap the black ink bottle and insert it into the filling port. The ink will automatically stop flowing when the tank is full.
4. Remove the bottle and securely close the ink tank cap.
5. Repeat the process for the Cyan, Magenta, and Yellow ink tanks using the corresponding color ink bottles.
6. Close the ink tank unit cover.



Image: Illustration of the ink refilling process for the Epson EcoTank ET-2980, showing the uniquely keyed EcoFit bottles preventing mix-ups.

Connecting to a Computer or Network

The ET-2980 supports both Wi-Fi and USB connectivity.

- **Wi-Fi Setup:** Follow the on-screen instructions on the printer's control panel to connect to your wireless network. You may need your network name (SSID) and password.
- **USB Connection:** Connect a USB cable (not included) from the printer to your computer.

Software Installation

After connecting the printer, install the necessary drivers and software from the Epson website or the included CD (if applicable). The Epson Smart Panel app is available for mobile devices to facilitate printing and scanning from smartphones and tablets.

BASIC OPERATIONS

Printing Documents

To print from a computer or mobile device:

1. Load paper into the rear paper tray.
2. Open the document or image you wish to print on your computer or mobile device.
3. Select the print option from your application.
4. Choose the Epson ET-2980 as your printer.
5. Adjust print settings (e.g., paper size, print quality, color/grayscale, duplex printing) as needed.
6. Click Print.

Copying Documents

To make a copy using the printer's control panel:

1. Place the document face-down on the scanner glass.
2. On the printer's 1.44-inch color display, select the 'Copy' option.
3. Adjust settings such as number of copies, paper size, and quality.
4. Press the Start button to begin copying.

Scanning Documents

To scan a document:

1. Place the document face-down on the scanner glass.
2. From your computer, open the Epson Scan software or use the Epson Smart Panel app on your mobile device.
3. Select the scan settings (e.g., document type, resolution, destination folder).
4. Initiate the scan. The scanned image will be saved to your specified location.

Using the Control Panel

The 1.44-inch color display allows for easy navigation through printer functions, including copy, scan, and network settings. Use the directional buttons and 'OK' button to make selections.



Image: Overview of Epson EcoTank ET-2980 features, highlighting print speeds (15 ppm black, 8 ppm color), Wi-Fi connectivity, auto 2-sided printing, 100-sheet paper capacity, and the 1.44-inch color display.

MAINTENANCE

Refilling Ink Tanks

Monitor ink levels regularly. When an ink tank is low, refill it using the appropriate Epson 502 EcoFit ink bottle. The unique keying of the bottles prevents accidental filling of the wrong color.

Zero Cartridge Waste

Join the club with the millions of EcoTank® owners who've already helped to reduce millions of pounds¹ of plastic from going into landfills

¹ Based on product and replacement ink bottle sales in North America 2015 – June 2021.

² Individual cartridges estimate based on print yields of a replacement set of black and color ink bottles as compared to Epson® standard-capacity ink cartridges for similarly featured printers as of October 2024.



Each replacement ink bottle set is equivalent to about
80 individual cartridges²



Image: A set of Epson 502 EcoFit ink bottles (Black, Yellow, Magenta, Cyan) designed for mess-free refilling of EcoTank printers.

Cleaning the Printer

- **Print Head Cleaning:** If print quality declines (e.g., missing lines, streaking), perform a print head cleaning cycle through the printer's control panel or printer software.
- **Scanner Glass Cleaning:** Regularly wipe the scanner glass with a soft, lint-free cloth to ensure clear scans.

Loading Paper

The printer features a 100-sheet rear paper tray. Ensure paper is loaded correctly and the paper guides are adjusted to prevent jams. Supported media sizes include 4 x 6 inches, 5 x 7 inches, Legal (8.5 x 14 inches), and Letter (8.5 x 11 inches).

TROUBLESHOOTING

If you encounter issues with your printer, refer to the following common solutions:

- **Print Quality Issues:** Perform a nozzle check and print head cleaning. Ensure genuine Epson ink is used.

- **Connectivity Problems:** Verify Wi-Fi connection status on the printer and your device. For USB, ensure the cable is securely connected.
- **Paper Jams:** Follow on-screen instructions or refer to the online manual for clearing paper jams. Always remove jammed paper carefully to avoid damaging internal components.
- **Error Messages:** Consult the printer's display for specific error codes and refer to the Epson support website for detailed solutions.

For more comprehensive troubleshooting, visit the official Epson support website or use the Epson Smart Panel app.

PRODUCT SPECIFICATIONS

Feature	Specification
Product Dimensions	13.7"D x 14.8"W x 7.4"H
Item Weight	11.5 pounds
Printing Technology	Inkjet
Connectivity Technology	Wi-Fi, USB
Maximum Black Print Speed	15 ppm (ISO)
Maximum Color Print Speed	8 ppm (ISO)
Maximum Print Resolution	4800 x 1200 DPI
Scanner Type	Flatbed
Max Input Sheet Capacity	100 sheets
Maximum Media Size	8.5 x 14 inch
Supported Media Sizes	4x6, 5x7, Letter, Legal
Duplex Printing	Automatic
Display	1.44" Color Screen
Compatible Cartridge	Epson 502 ink
Power Consumption	13 Watts

WARRANTY AND SUPPORT INFORMATION

Warranty

The Epson EcoTank ET-2980 printer comes with a Limited Warranty. For specific terms and conditions, please refer to the warranty documentation included with your product or visit the official Epson website.

Epson® Genuine Ink Promise

Epson is committed to delivering the highest-quality and most reliable inks for your printing experience. Epson's Promise is backed by our outstanding Service & Support and Warranty Programs.



Epson strongly recommends the use of Genuine Epson Inks for a quality printing experience. Non-Epson inks and inks not formulated for your specific printer may cause damage that is not covered by the Epson warranty.

SCROLL DOWN TO "FROM THE MANUFACTURER" TO LEARN MORE.

Image: The Epson Genuine Ink Promise logo, indicating Epson's commitment to quality when using genuine Epson inks.

Customer Support

For further assistance, technical support, or to download the latest drivers and software, please visit the official Epson support website. You can also utilize the Epson Smart Panel app for convenient access to support resources and printer management from your mobile device.

Epson Support Website: epson.com/support