

[Manuals.plus](#) /

› [Epson](#) /

› [Epson EcoTank ET-2980 Wireless All-in-One Color Supertank Printer User Manual](#)

Epson ET-2980

Epson EcoTank ET-2980 Wireless All-in-One Color Supertank Printer User Manual

Model: ET-2980

[Setup](#)

[Operation](#)

[Maintenance](#)

[Troubleshooting](#)

[Specifications](#)

[Warranty & Support](#)

1. SETUP

1.1 Unpacking the Printer

Carefully remove the printer from its packaging. Ensure all protective materials, tapes, and films are removed from the exterior and interior of the printer. Check the box contents against the packing list.

- Printer unit
- Power cord
- Setup guide
- Ink bottles (Black, Cyan, Magenta, Yellow)

What's in the Box

EcoTank® ET-2980 All-in-One Supertank Printer



Start Here Guide

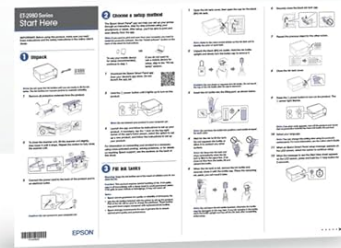

Power Cord (USB not included)



EcoTank 502® Ink Bottles

* We recommend genuine Epson® ink for the best print quality and performance.

Image: Contents of the Epson EcoTank ET-2980 box, showing the printer, ink bottles, and power cord.

1.2 Filling the Ink Tanks

The EcoTank ET-2980 uses refillable ink tanks. Follow these steps to fill the tanks:

1. Open the ink tank unit cover on the side of the printer.
2. Open the cap for the corresponding color ink tank.
3. Uncap the ink bottle and insert it into the filling port. The unique keyed bottles ensure you fill the correct tank.
4. Allow the ink to drain into the tank. Do not squeeze the bottle.
5. Once the tank is full, remove the ink bottle and securely close the tank cap and unit cover.
6. Repeat for all colors.

Stress-Free, Cartridge-Free Printing

Use Epson's exclusive **EcoFit® bottles** to easily refill the high-capacity ink tanks, with up to **3 years of ink included in the box**—and with every replacement ink set¹



100 MILLION SOLD

Worldwide 2011 – 10/2024



¹ Based on average monthly document print volumes of about 125 pages.

Image: Detailed view of the ink tank system, showing the individual color tanks and how ink bottles are inserted for refilling.

Important: Use only genuine Epson ink bottles designed for this printer model. Using non-Epson ink may cause damage not covered by the warranty.

1.3 Initializing the Printer

After filling the ink tanks, connect the power cord and turn on the printer. Follow the on-screen instructions on the 1.44" color display to complete the initial setup, including language selection and ink initialization. This process may take several minutes.

1.4 Loading Paper

The printer features a 100-sheet paper tray. Load paper into the rear paper feed slot, adjusting the paper guides to fit the width of your paper. Ensure the paper is loaded correctly to prevent jams.

EcoTank® ET-2980

Wireless | Print | Copy | Scan

HOME

HOME OFFICE

SMALL BUSINESS

PHOTO/GRAPHICS

Print Speeds[†]

15
BLACK
ISO PPM

8
COLOR
ISO PPM



Mobile device
not included.



Wi-Fi® 5 & Mesh
Connectivity



Auto 2-Sided
Printing



100-Sheet
Paper
Capacity



High-Quality
Photo Printing



1.44" Color
Display



Smart
Mobile
Printing¹

[†] Black and color print speeds are measured in accordance with ISO/IEC 24734. Actual print times will vary based on factors including system configuration, software, and page complexity. For more information, visit epson.com/printspeed

¹ Most features require an Internet connection to the printer, as well as an Internet- and/or email-enabled device. For a list of Epson Connect™ enabled printers and compatible devices and apps, visit epson.com/connect

Image: The printer with paper being loaded into the rear paper feed, demonstrating the paper handling capabilities.

1.5 Connecting to a Computer or Mobile Device

The ET-2980 supports Wi-Fi and USB connectivity.

- **Wi-Fi Setup:** Use the printer's control panel to navigate to the Wi-Fi setup menu. Select your network and enter the password.
- **USB Connection:** Connect the printer to your computer using a USB cable (not included). Install the necessary drivers from the Epson website.
- **Mobile Printing:** Download the Epson Smart Panel app for easy printing and scanning from your smartphone or tablet. The printer also supports Apple AirPrint.

Your browser does not support the video tag.

Video: This video demonstrates the key features of the Epson EcoTank ET-2980, including its ink system, print speeds, and mobile connectivity.

2. OPERATION

2.1 Printing Documents

To print, select the Epson ET-2980 from your device's print dialog. Adjust settings such as paper type, print quality, and color options as needed. The printer offers fast print speeds of 15 ISO ppm for black and 8 ISO ppm for color.

Zero Cartridge Waste

Join the club with the millions of EcoTank® owners who've already helped to reduce millions of pounds¹ of plastic from going into landfills

¹ Based on product and replacement ink bottle sales in North America 2015 – June 2021.

² Individual cartridges estimate based on print yields of a replacement set of black and color ink bottles as compared to Epson® standard-capacity ink cartridges for similarly featured printers as of October 2024.



Each replacement ink bottle set is equivalent to about **80 individual cartridges²**



Image: The Epson EcoTank ET-2980 actively printing a document, showcasing its output tray.

2.2 Scanning Documents

Place your document face-down on the scanner glass. Use the printer's control panel or the Epson Smart Panel app to initiate a scan. You can choose to save the scan to your computer, mobile device, or cloud services.

2.3 Copying Documents

Place the document on the scanner glass. On the printer's control panel, select the "Copy" function. You can adjust settings like the number of copies, paper size, and quality before pressing the start button.

2.4 Auto 2-Sided Printing

The ET-2980 supports automatic two-sided printing. Enable this feature in your printer settings before sending a print job to save paper.

3. MAINTENANCE

3.1 Checking Ink Levels

Monitor ink levels visually through the transparent ink tanks on the front of the printer. The printer's display also provides ink level indicators. Refill tanks before they run completely empty to prevent air from entering the ink system.

Stress-Free, Cartridge-Free Printing

Use Epson's exclusive **EcoFit® bottles** to easily refill the high-capacity ink tanks, with up to **3 years of ink included** in the box—and with every replacement ink set¹

100 MILLION SOLD
Worldwide 2011 – 10/2024



¹ Based on average monthly document print volumes of about 125 pages.

Image: The transparent ink tanks on the side of the printer, allowing for easy visual monitoring of ink levels for each color.

3.2 Print Head Cleaning

If print quality declines (e.g., missing lines, faded colors), perform a print head cleaning. This can be done through the printer's control panel or the Epson printer utility on your computer. Refer to the on-screen instructions for the cleaning process.

3.3 Print Head Alignment

If your prints appear blurry or misaligned, perform a print head alignment. This utility adjusts the print head position for optimal print quality. Access this function through the printer's maintenance menu.

3.4 Cleaning the Scanner Glass

Regularly clean the scanner glass with a soft, lint-free cloth and a mild glass cleaner. Dust or smudges on the glass can affect scan quality.

4. TROUBLESHOOTING

4.1 Printer Not Responding

- Check power connections and ensure the printer is turned on.
- Verify Wi-Fi connection or USB cable connection.
- Restart the printer and your computer/mobile device.
- Ensure printer drivers are up to date.

4.2 Poor Print Quality

- Check ink levels and refill if necessary.
- Perform a print head cleaning and nozzle check.
- Perform a print head alignment.
- Ensure you are using appropriate paper settings for your print job.

4.3 Paper Jams

- Turn off the printer and carefully remove any jammed paper from the paper tray or output slot.
- Open the printer cover and remove any paper fragments from inside.
- Ensure paper is loaded correctly and not overfilled in the paper tray.

5. SPECIFICATIONS

Feature	Detail
Brand	Epson
Model Name	EcoTank ET-2980

Feature	Detail
Printing Technology	Inkjet
Connectivity Technology	Wi-Fi, USB
Special Features	Auto-Duplex, Borderless Printing, Energy Star, Refillable Ink Tank
Printer Output	Color
Max Print Speed (Black)	15 ppm
Max Print Speed (Color)	8 ppm
Scanner Type	Flatbed
Display	1.44" Color Screen
Paper Tray Capacity	100 sheets
Maximum Print Resolution	4800 x 1200 DPI
Item Dimensions (D x W x H)	13.7"D x 14.8"W x 7.4"H
Item Weight	11.5 Pounds

6. WARRANTY & SUPPORT

6.1 Warranty Information

The Epson EcoTank ET-2980 comes with a **1-Year Limited Warranty**. This warranty covers defects in materials and workmanship under normal use. For full details, please refer to the warranty documentation included with your product or visit the official Epson support website.



Image: The Epson Genuine Ink Promise, emphasizing the use of authentic Epson inks for optimal performance and warranty coverage.

6.2 Customer Support

For technical assistance, troubleshooting, or warranty claims, please contact Epson Customer Support. You can find

contact information and additional resources on the official Epson website.

- **Online Support:** Visit [epson.com/support](https://www.epson.com/support) for FAQs, drivers, and manuals.
- **Phone Support:** Refer to your product documentation for regional contact numbers.

