

## LIKIMIO HK-XST24-YN14

# LIKIMIO 24 Inch Bathroom Vanity with Sink Instruction Manual

Model: HK-XST24-YN14 | Brand: LIKIMIO

## 1. INTRODUCTION

Welcome to the LIKIMIO 24 Inch Bathroom Vanity with Sink instruction manual. This guide provides essential information for the safe assembly, proper use, and effective maintenance of your new bathroom vanity. Please read all instructions carefully before beginning assembly or use to ensure optimal performance and longevity of your product.

## 2. PRODUCT OVERVIEW

The LIKIMIO 24 Inch Bathroom Vanity with Sink (Model HK-XST24-YN14) is designed to offer a compact yet functional solution for small bathrooms. Its modern aesthetic, featuring an olive green and wood tone finish, complements various interior styles.

### Key Features:

- **Integrated Ceramic Sink:** A seamless white ceramic sink with an overflow drain, pre-drilled for a standard 1.4-inch faucet (faucet sold separately).
- **Compact Design:** Measuring 24"W x 33.9"H x 18.1"D, ideal for tight spaces.
- **Arched Fluted Glass Door:** A stylish cabinet door that softly conceals contents while adding a modern texture.
- **Adjustable Shelf:** Customize storage space within the cabinet to fit your needs.
- **Open Side Shelves:** Five convenient open shelves for easy access to daily essentials.
- **Towel Bar & Toilet Paper Holder:** Integrated right-side towel bar and left-side toilet paper holder with two metal hooks for added utility.
- **Sturdy Construction:** Supported by solid wood legs for stability and elevated for easy floor cleaning.
- **Soft-Close Hinges:** Ensures quiet and gentle closing of the cabinet door.

# Compact Design Dimensions

24"W x 33.9"H x 18.1"D

Ideal for Bathrooms Under 50 sq.ft



An illustration of the LIKIMIO 24-inch bathroom vanity, highlighting its compact dimensions (24"W x 33.9"H x 18.1"D) and various storage features including the sink, cabinet, and side shelves.

## 3. SAFETY INFORMATION

To ensure safe use and prevent injury or damage, please observe the following safety guidelines:

- Always follow the assembly instructions carefully and ensure all fasteners are securely tightened before using the vanity.
- Do not overload the shelves or cabinet. Distribute weight evenly to maintain stability.
- Keep small parts and assembly hardware away from children during assembly to prevent choking hazards.
- Avoid standing or climbing on the vanity.
- Use appropriate tools for assembly as specified in the instructions.
- Exercise caution when handling the ceramic sink and glass door to prevent breakage or injury.

## 4. SETUP AND ASSEMBLY

---

Simple assembly is required for this vanity. Please ensure you have all parts and tools before you begin. An estimated assembly time is approximately 2 hours.

### Assembly Steps:

1. Unpack all components and verify them against the provided parts list.
2. Assemble the main cabinet structure according to the detailed diagrams in your instruction booklet.
3. Attach the solid wood legs to the base of the cabinet using the provided heavy-duty 90-degree brackets to ensure stability.
4. Install the soft-close hinges onto the arched fluted glass door and then attach the door to the cabinet.
5. Insert the adjustable shelf into the cabinet at your desired height. The shelf can be adjusted in 2.5-inch increments.
6. Carefully place the integrated ceramic sink onto the top of the cabinet. The sink features a 1.4-inch pre-drilled faucet hole and an anti-overflow hole.
7. Install the towel bar on the right side and the toilet paper holder with two metal hooks on the left side of the vanity.



An image illustrating the process of placing the integrated ceramic sink onto the vanity cabinet, showing the connection points.



**Soft Closing Hinges**



**Rubber Wood Legs**



**Frosted Glass Door**

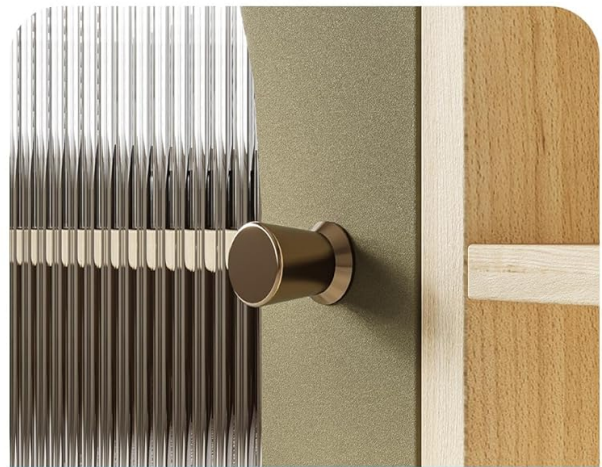

**Metal Handle & Knob**

Close-up images detailing the soft-close hinges, sturdy rubberwood legs, the textured fluted glass door, and the metal handle and knob of the vanity.



A detailed view of the adjustable shelf inside the vanity cabinet, indicating its 2.5-inch adjustment increments.

Your browser does not support the video tag.

An official product video from LIKIMIO Home showcasing the features and design of the Silva Series 24 Inch Bathroom Vanity with Sink, including its various components and overall aesthetic.

## 5. OPERATING INSTRUCTIONS

---

Using your LIKIMIO bathroom vanity is straightforward:

- **Sink Usage:** The integrated ceramic sink is ready for use once plumbing is connected. Ensure the drain is clear for proper water flow.
- **Storage:** Utilize the cabinet behind the arched glass door for larger items, adjusting the shelf height as needed. The five open side shelves are ideal for frequently used items or decorative displays.
- **Accessories:** Hang hand towels or washcloths on the right-side towel bar. The left-side holder is designed for toilet paper rolls, and the two metal hooks can be used for additional hanging storage.

## 6. MAINTENANCE

---

Regular maintenance will help preserve the appearance and functionality of your vanity.

## Cleaning:

- **Ceramic Sink:** The seamless design of the ceramic sink makes it easy to clean. Use a soft cloth and a mild, non-abrasive cleaner. Avoid abrasive pads, harsh chemicals, or strong acids, which can damage the finish.
- **Cabinet Surfaces:** For the engineered wood and fluted glass surfaces, wipe with a damp cloth and a small amount of mild soap. Dry immediately with a clean, soft cloth to prevent water spots or damage.
- **Hardware:** Clean metal handles, towel bar, and hooks with a soft, dry cloth. Avoid chemical cleaners that may tarnish the finish.

## Adjustments:

- **Hinge Adjustment:** If the cabinet door becomes misaligned or does not close smoothly over time, the soft-close hinges can be adjusted. Refer to the hinge adjustment diagram in your assembly instructions for specific details on how to adjust the door gap, height, and overlap.

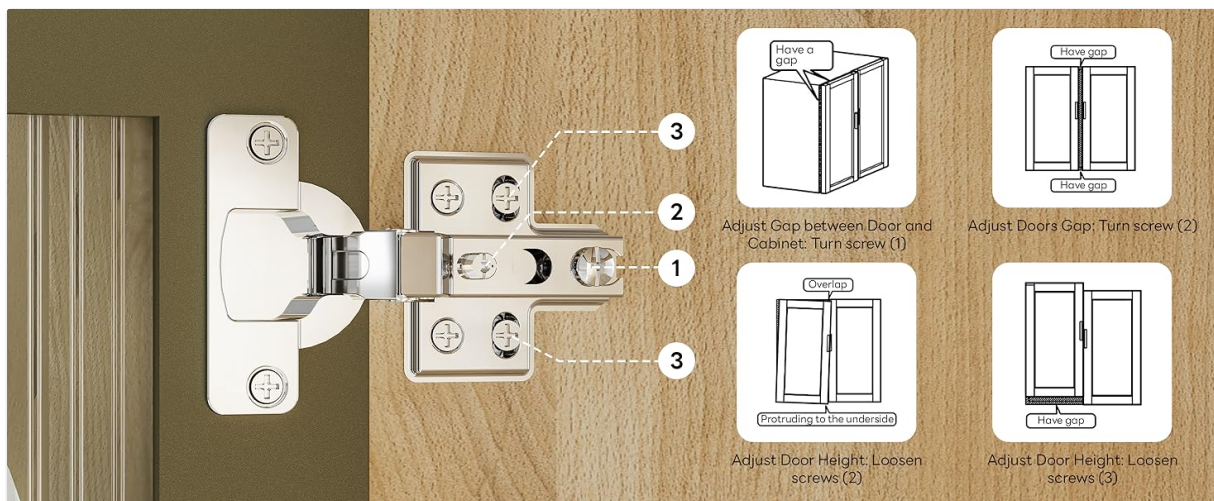

A diagram illustrating the soft-close hinges and how to adjust them for proper door alignment.

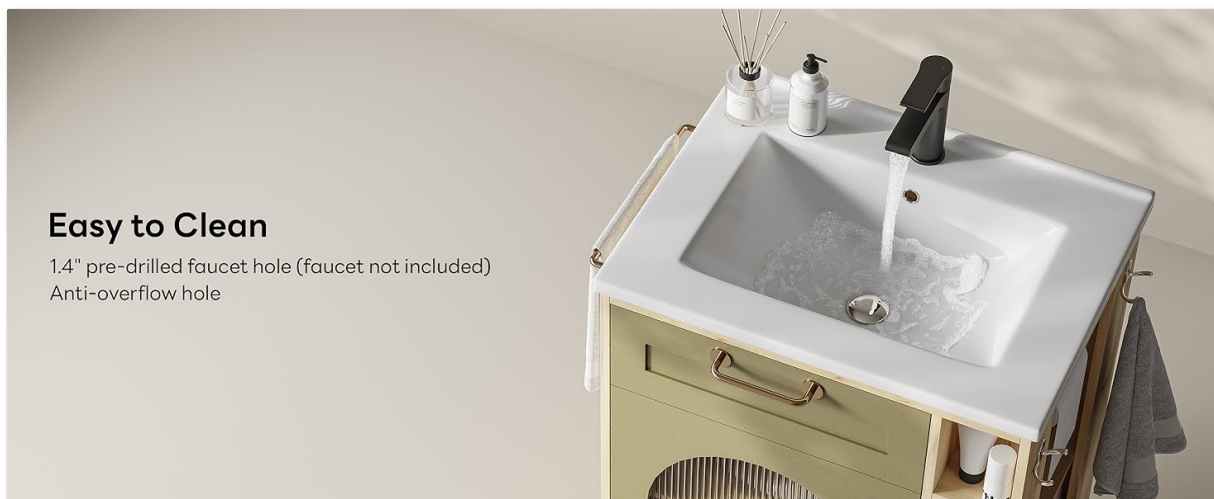

### Easy to Clean

1.4" pre-drilled faucet hole (faucet not included)  
Anti-overflow hole

A close-up view of the easy-to-clean ceramic sink, highlighting the 1.4-inch pre-drilled faucet hole and anti-overflow feature.

## 7. TROUBLESHOOTING

If you encounter any issues with your LIKIMIO bathroom vanity, please refer to the following common solutions:

- **Door Misalignment:** If the cabinet door does not close properly or appears uneven, adjust the soft-close hinges as described in the Maintenance section.
- **Wobbly Vanity:** Ensure all leg brackets and cabinet fasteners are securely tightened. Check that the vanity

is placed on a level surface.

- **Water Leakage:** If you observe any water leakage from the sink or plumbing, immediately turn off the water supply. Check all plumbing connections under the sink for tightness. If issues persist, it is recommended to consult a professional plumber.
- **Missing or Damaged Parts:** If any parts are missing or damaged upon arrival, please contact LIKIMIO customer support for assistance.

## 8. SPECIFICATIONS

---

<b>Brand</b>	LIKIMIO
<b>Model Number</b>	HK-XST24-YN14
<b>Color</b>	Olive Green & Wood Tone
<b>Material</b>	Engineered Wood, Fluted Glass, Ceramic
<b>Product Dimensions (D x W x H)</b>	18.1" x 24" x 33.9"
<b>Item Weight</b>	65.7 Pounds
<b>Mounting Type</b>	Floor Mount
<b>Number of Doors</b>	1
<b>Number of Shelves</b>	6 (including open side shelves)
<b>Additional Features</b>	Adjustable Shelf, Removable Shelf, Soft Close Hinges, Towel Bar, Toilet Paper Holder
<b>Required Assembly</b>	Yes

## 9. WARRANTY AND SUPPORT

---

Your LIKIMIO 24 Inch Bathroom Vanity with Sink is designed for quality and durability.

- **Returns:** This product is eligible for 30-day easy returns through Amazon.com. Please refer to Amazon's return policy for detailed information.
- **Customer Support:** For any questions, technical assistance, or to report missing or damaged parts, please contact LIKIMIO customer support. Our team is available to help you with any concerns regarding your product.