

AECOJOY 16019

AECOJOY 20x10FT Retractable Patio Awning Instruction Manual

Model: 16019 | Brand: AECOJOY

INTRODUCTION

This manual provides detailed instructions for the safe and efficient assembly, operation, and maintenance of your AECOJOY 20x10FT Retractable Patio Awning. Please read all instructions carefully before installation and use to ensure proper function and longevity of your product.

SAFETY INSTRUCTIONS

- Always ensure the awning is securely mounted to a stable surface (concrete, solid brick, or wooden wall) using appropriate hardware.
- Do not operate the awning in strong winds (above 30mph) or heavy rain. Retract the awning to prevent damage.
- Keep children and pets away from the awning during operation.
- Regularly inspect all bolts, screws, and moving parts for tightness and wear. Tighten as necessary.
- Do not hang objects from the awning frame or fabric.
- Ensure adequate clearance when extending or retracting the awning to avoid obstructions.

PACKAGE CONTENTS

Before beginning assembly, verify that all components listed below are present and undamaged. Refer to the included parts diagram for visual identification.

- Awning Frame Components (Aluminum, powder-coated)
- 280g Polyester Fabric with PU coating (Main canopy and valance)
- Manual Crank Handle
- Mounting Brackets (Heavy-duty, double strand steel rope for retractable arms)

- Installation Hardware (Expansion bolts for concrete/brick, screws for wood)
- Plastic Tubing (for fabric insertion)
- End Caps and Rollers

SETUP AND INSTALLATION

1. Pre-Installation Checks

Identify your wall type (concrete, brick, or wood) to use the correct mounting hardware. Ensure the installation area is clear of obstructions and provides sufficient space for the awning's dimensions (20ft W x 10ft D). Recommended installation height is 8FT-13FT from the ground. If mounting above a patio door, ensure at least 8 inches clearance above the door frame.



Image Description: A diagram illustrating the recommended installation height of 8-13 feet from the ground, with a note about maintaining 8 inches clearance above doors. It also shows two types of wall mounting: expansion bolts for concrete/brick and screws for wooden walls.

2. Assembling the Frame

Connect the main frame sections. Ensure all bolts are tightened securely. The retractable arms should be handled with care; do not cut any zip ties or restraints until the entire assembly is complete and ready for final installation.

3. Attaching the Fabric

Slide the plastic tubing, which is sewn into the fabric, into the designated grooves on the main metal tube and the valance bar. This process requires careful feeding to ensure the fabric is evenly distributed and taut. Once the fabric is in place, secure the end pieces onto the tubes.



Image Description: A close-up view of the awning's fabric and frame, highlighting the connection points and the material texture.

4. Wall Mounting

Mark the positions for the mounting brackets on your wall. For the 20x10FT model, three brackets are typically used: one on each end and one in the center. Drill pilot holes and securely fasten the brackets using the provided heavy-duty hardware suitable for your wall type. Ensure the brackets are level and aligned.



Image Description: An AECOJOY retractable awning installed on the exterior of a house, providing shade over a patio area.

5. Attaching the Awning to Brackets

With assistance, carefully lift the assembled awning and slide it into the wall-mounted brackets. Secure the awning to the brackets using the provided bolts. Ensure all connections are tight and stable.

6. Adjusting the Angle

The awning's pitch can be adjusted between 40 and 90 degrees. Locate the adjustment bolts on the retractable arms. Loosen these bolts, adjust the angle to your desired position, and then tighten the bolts securely to lock the angle in place. This allows for optimal sun protection throughout the day.

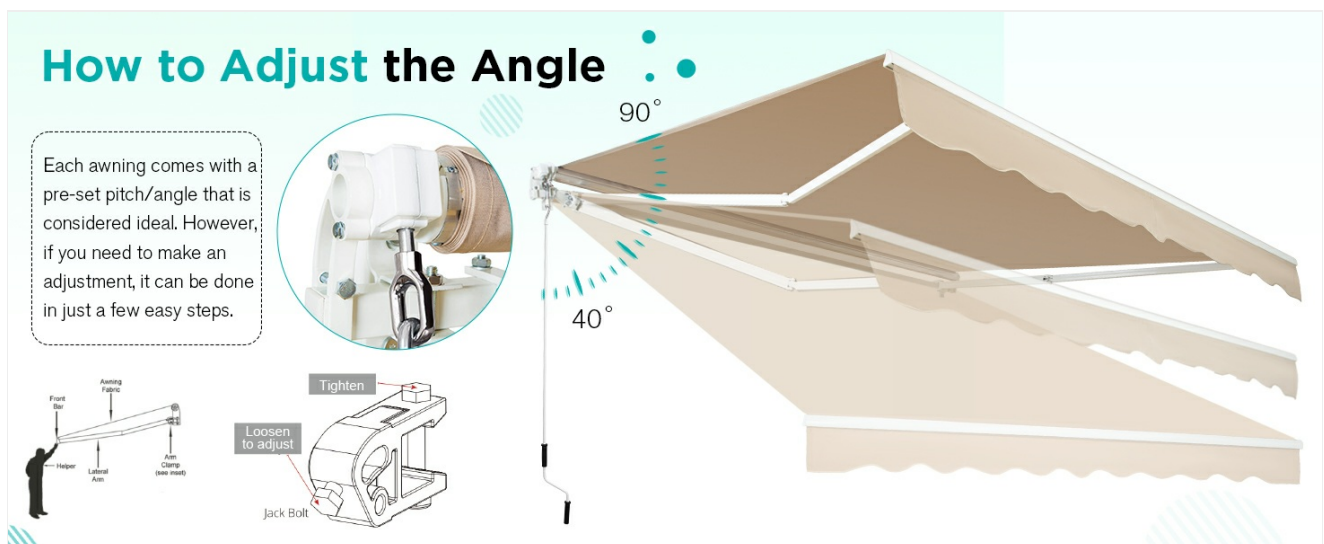

Image Description: A diagram showing an awning with an adjustable angle, illustrating how it can be set between 40 and 90 degrees for varying shade needs.

OPERATING INSTRUCTIONS

Your AECOJOY Retractable Patio Awning operates manually using the provided crank handle.

- **To Extend:** Insert the manual crank handle into the loop on the side of the awning. Turn the handle clockwise to extend the awning to your desired length.
- **To Retract:** Turn the manual crank handle counter-clockwise to retract the awning fully. Ensure it is completely retracted when not in use or during adverse weather conditions.

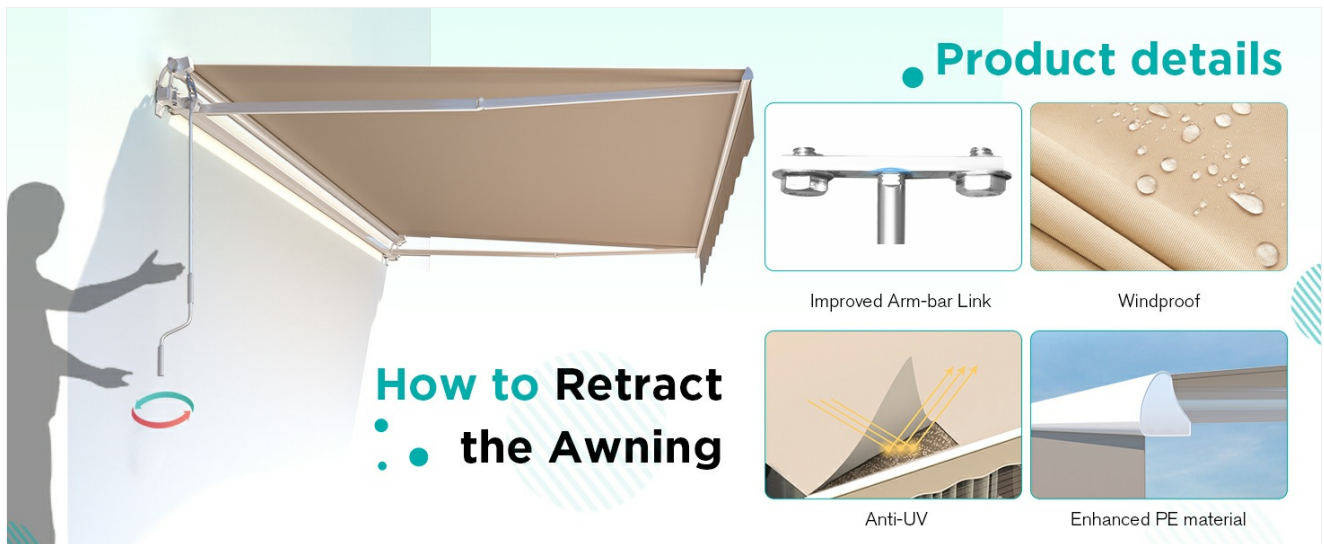

Image Description: A person using the manual crank handle to retract the AECOJOY patio awning, demonstrating the ease of operation.

MAINTENANCE

- **Fabric Care:** The 280g polyester fabric with PU coating is water-resistant and UV-resistant. Clean the fabric periodically with mild soap and water. Rinse thoroughly and allow to air dry completely before retracting to prevent mildew.
- **Frame Care:** The rust-resistant, powder-coated aluminum frame should be wiped clean with a damp cloth as needed.
- **Hardware Inspection:** Annually inspect all nuts, bolts, and moving parts for any signs of loosening or corrosion. Tighten loose fasteners and apply a silicone-based lubricant to moving joints if necessary to ensure smooth operation.

TROUBLESHOOTING

Problem	Possible Cause	Solution
Awning does not extend/retract smoothly.	Obstruction in the arms or track; stiff joints.	Check for debris. Lubricate moving parts with silicone spray.
Awning appears uneven when extended.	Uneven tension in the arms or improper angle adjustment.	Adjust the pitch bolts on the retractable arms to level the awning. Ensure mounting brackets are level.
Fabric sags or is loose.	Fabric not properly inserted into the grooves or stretched over time.	Re-insert fabric into grooves, ensuring it is taut. Consult customer support if sagging persists.

SPECIFICATIONS

- **Model:** 16019
- **Size:** 20x10FT (240"W x 120"D)
- **Color:** Beige
- **Fabric Type:** 280g/ polyester fabric with PU coating

- **Frame Material:** Rust-resistant, powder-coated aluminum
- **Adjustable Angle:** 40-90 degrees
- **Wind Resistance:** Up to 30mph (retract in higher winds)
- **Assembly Required:** Yes

WARRANTY AND SUPPORT

For warranty information, replacement parts, or technical assistance, please contact AECOJOY customer service. Keep your purchase receipt and model number (16019) handy for faster service. Visit the [AECOJOY Store](#) for more products and support.