

Restmo O-LS-10-GN

Restmo Heavy Duty Oscillating Sprinkler O-LS-10-GN Instruction Manual

Model: O-LS-10-GN | Brand: Restmo

[Introduction](#)

[Setup](#)

[Operation](#)

[Maintenance](#)

[Specifications](#)

[Troubleshooting](#)

1. INTRODUCTION

This manual provides detailed instructions for the proper use and maintenance of your Restmo Heavy Duty Oscillating Sprinkler, Model O-LS-10-GN. Designed for efficient and uniform watering, this sprinkler features a stable metal base, 18 durable nozzles, and adjustable settings for flow, width, and coverage. Please read this manual thoroughly before first use to ensure optimal performance and longevity of your product.

Key Features:

- **Heavy-Duty Metal Base:** Ensures stability on various terrains, preventing tipping during operation.
- **Expansive & Uniform Coverage:** Efficiently waters up to 4200 square feet with 18 high-performance nozzles for even distribution.
- **Sand Protection:** Built-in sand prevention flake filters out sediment, extending the sprinkler's lifespan.
- **Adjustable Flow & Spray Width:** Integrated flow control dial and sliding tabs allow precise management of water volume and spray pattern.
- **Easy Maintenance:** Includes a cleaning pin for clearing nozzle debris, ensuring consistent performance.

2. SETUP

Follow these steps to set up your oscillating sprinkler:

1. **Position the Sprinkler:** Place the sprinkler on a flat, stable surface in the area you wish to water. The heavy-duty metal base is designed to provide stability.

2. **Connect the Hose:** Attach your garden hose to the inlet connection on the sprinkler. Ensure a tight fit to prevent leaks. The inlet includes a sand filter to protect internal components.
3. **Turn on Water:** Slowly turn on the water supply from your spigot.



Figure 2.1: The Restmo Oscillating Sprinkler connected to a hose and watering a lawn.

18 Spray Nozzles

At 60 PSI, it can cover up to 4,200 sq.ft., ideal for large lawns or gardens.



Cleaning Pin

Insert into the watering nozzles to unclog and clear blocked outlets, extending the product's service life.

Aluminum Alloy Base

Durable and sturdy, it helps stabilize the sprinkler for efficient and precise watering.



Figure 2.2: Detailed view of the sprinkler's components, including the aluminum alloy base for stability, 18 spray nozzles, and the cleaning pin for maintenance.

3. OPERATION

The Restmo Oscillating Sprinkler offers multiple adjustment options for precise watering:

3.1 Adjusting Water Flow and On/Off:

- Locate the green flow control knob at the hose connection end of the sprinkler.
- Turn the knob towards the "+" symbol for wider coverage and increased flow, or towards the "-" symbol for narrower watering and reduced flow.
- This knob also functions as an on/off valve, allowing you to stop water flow directly at the sprinkler without turning off the main spigot.

Precise Flow Control: Wide, Narrow & Off



Figure 3.1: Adjusting the flow control knob to manage water volume and coverage. Turning towards '+' increases flow, towards '-' decreases it.

3.2 Adjusting Spray Width and Coverage:

- The sprinkler features two sliding tabs along the nozzle bar.
- To adjust the spray width, press down on the tabs and slide them inwards to narrow the spray pattern, or outwards to widen it. This allows you to target specific areas like flower beds or narrow pathways.
- The nozzle angle can also be controlled to adjust the overall spray coverage, from full area to left, right, or middle sections.



Figure 3.2: Demonstrates how to adjust the spray width by manipulating the sliding tabs on the nozzle bar.

Adjustable Spray Coverage

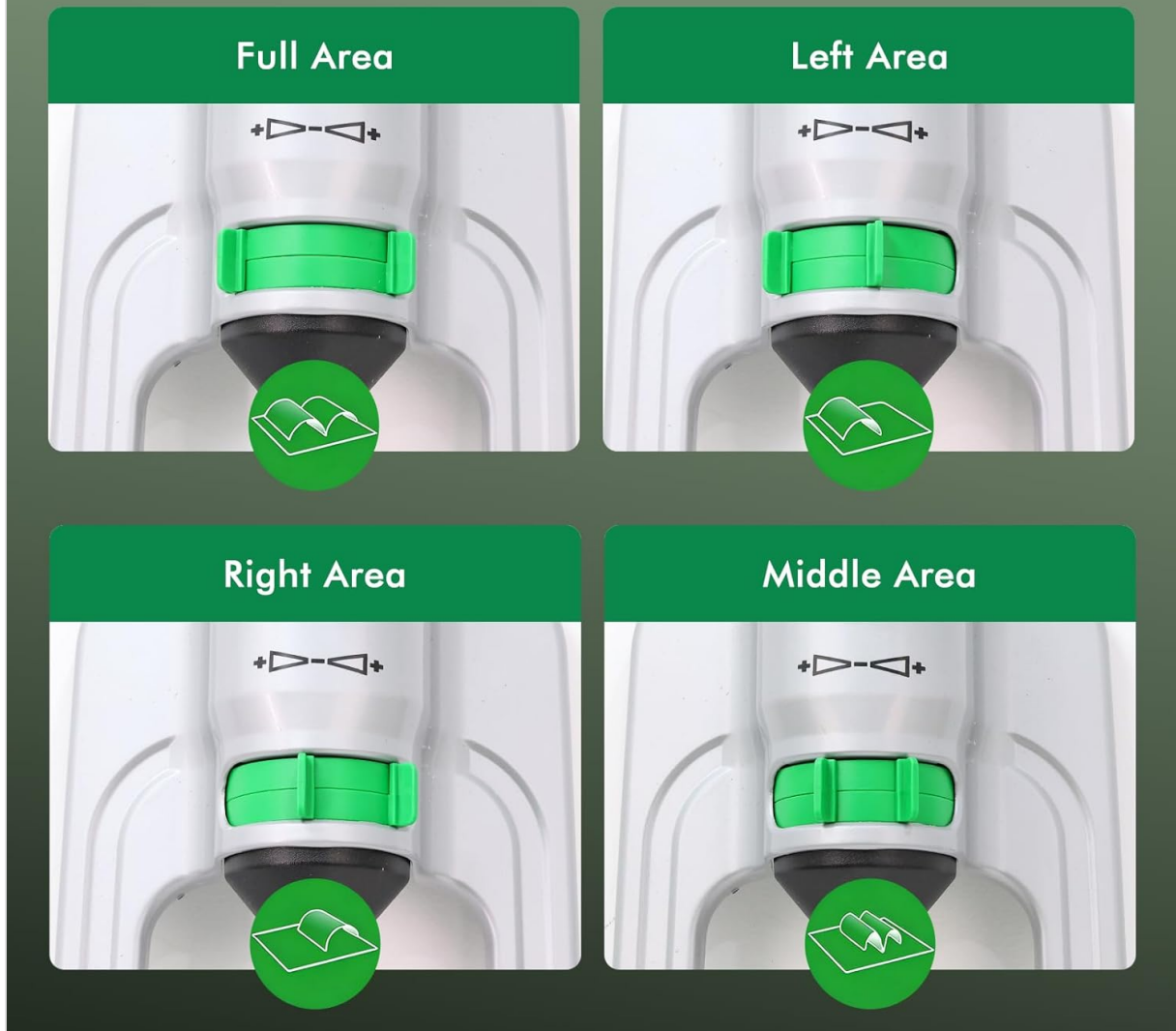

Figure 3.3: Visual guide to adjusting spray coverage for full, left, right, or middle areas.

3.3 Product Video:

Your browser does not support the video tag.

Video 3.1: Official product video demonstrating the setup, range, and cleaning features of the Restmo Heavy Duty Oscillating Sprinkler.

4. MAINTENANCE

Regular maintenance ensures optimal performance and extends the life of your sprinkler:

4.1 Cleaning Nozzles:

- The sprinkler comes with a dedicated cleaning pin.
- If any nozzles become clogged with debris, insert the cleaning pin into the affected nozzle to clear the obstruction. This helps maintain consistent water flow and spray pattern.

18 Spray Nozzles

At 60 PSI, it can cover up to 4,200 sq.ft., ideal for large lawns or gardens.



Cleaning Pin

Insert into the watering nozzles to unclog and clear blocked outlets, extending the product's service life.

Aluminum Alloy Base

Durable and sturdy, it helps stabilize the sprinkler for efficient and precise watering.



Figure 4.1: Using the cleaning pin to clear debris from the sprinkler nozzles.

4.2 Sand Filter:

- The inlet connection includes a sand filter to prevent sediment from entering the sprinkler mechanism.
- Periodically check and clean this filter to ensure unrestricted water flow and prevent internal damage.



Unique Anti-Sand Design

Prevents Gear Clogs & Extends Service Life

5X Lifespan

Figure 4.2: The unique anti-sand design with a built-in filter to prevent gear clogs and extend service life.

5. SPECIFICATIONS

Brand	Restmo
Model Number	O-LS-10-GN
Material	Aluminum, Brass
Color	Green
Coverage Area	Up to 4,200 sq. ft.
Number of Nozzles	18
Item Dimensions (L x W x H)	20.6 x 3.7 x 7.2 inches

6. TROUBLESHOOTING

If you encounter issues with your sprinkler, consider the following common solutions:

- **Uneven Spray or Reduced Flow:** Check for clogged nozzles and use the included cleaning pin to clear them. Also, inspect the sand filter at the hose connection for debris and clean if necessary.
- **Sprinkler Tipping Over:** Ensure the sprinkler is placed on a flat, stable surface. The heavy metal base is designed for stability, but extreme unevenness or high water pressure might affect it.
- **Leaks at Hose Connection:** Verify that the garden hose is securely tightened to the sprinkler inlet. Check the rubber washer inside the connection for proper seating and any damage.
- **Limited Coverage:** Adjust the flow control knob towards the '+' symbol and ensure the sliding tabs are set for the desired width. Confirm adequate water pressure from your spigot.

For further assistance, please contact Restmo customer support.