

## MIZUDO WCIU-HW199A1G-NG-M0

# MIZUDO 199K Tankless Water Heater Instruction Manual

Model: WCIU-HW199A1G-NG-M0

## 1. SAFETY INFORMATION

---

Read all instructions thoroughly before installation and operation. Failure to follow these instructions could result in property damage, personal injury, or death. Keep this manual for future reference.

### General Safety Guidelines

- Installation and service must be performed by a qualified installer or service agency.
- Ensure proper ventilation as specified in the installation instructions.
- Do not store or use gasoline or other flammable vapors and liquids in the vicinity of this or any other appliance.
- Verify that the gas supply matches the appliance's requirements (Natural Gas).
- Maintain clear access to the appliance for servicing.

### Integrated Safety Mechanisms

The MIZUDO 199K Tankless Water Heater is equipped with over 16 integrated safety mechanisms to ensure reliable and safe operation. These include:

- Freeze Protection (operational down to -13°F)
- Anti-dry Firing Protection
- Flame Failure Detection
- Exhaust Blockage Monitoring
- Automatic Shutdown Systems
- Over-Pressure Protection
- Current Stabilization
- Overheat Prevention
- CPU Self-Check

# 2+10 Safety Protection

✓ 2 Years Unit Quality Protection    ✓ 5 Years Heat Exchanger Quality Protection



Image: Overview of the 2+10 Safety Protection features, including flameout, ignition failure, flame overflow, grounding, power-outage memory, dry-fire prevention, over-pressure protection, current stabilization, overheat prevention, and CPU self-check.

## 2. PRODUCT OVERVIEW

The MIZUDO 199K Tankless Water Heater provides on-demand hot water for residential use. This indoor, direct vent unit is designed for high efficiency and consistent performance, capable of supplying hot water to multiple fixtures simultaneously.

### Key Features

- **High Capacity:** Max 10.3 GPM flow rate, suitable for 5-7 fixtures.
- **Powerful Heating:** 199,000 BTU for instant hot water.
- **Precision Temperature Control:** Maintains water temperature within  $\pm 1^{\circ}\text{F}$  accuracy using 6-stage gas modulation.
- **Smart Control:** WiFi and mobile application for remote management.
- **Sealed Direct Vent System:** Draws external air for combustion, preserving indoor air quality.

- **Compact Design:** Space-saving dimensions (24.8" x 15.9" x 10.4").
- **Durable Construction:** Phosphorous-deoxidized copper heat exchanger and stainless steel combustion chamber.





Image: The MIZUDO 199K Tankless Water Heater unit, showcasing its compact design.

## 199,000 BTU Powerful Heating

Fast Heating | High Efficiency | Safe Operation



Image: Diagram illustrating the internal components, including the heat exchanger, smart control system, fan motor assembly, water flow sensor, 6-stage sectional burners, and gas control assembly.

### 3. INSTALLATION

Proper installation is crucial for the safe and efficient operation of your tankless water heater. This unit is designed for indoor, wall-mounted installation with a direct vent system. Consult a qualified professional for installation.

#### Pre-Installation Considerations

- **Location:** Choose a location that allows for proper venting, access for maintenance, and protection from freezing temperatures.
- **Ventilation:** The sealed direct vent system requires specific venting components to draw external air for combustion and exhaust flue gases.
- **Utilities:** Ensure access to a natural gas supply, 120V 60Hz electrical power, and 3/4" NPT water connections (hot water outlet, cold water inlet).
- **Mounting:** The unit is designed for wall mounting. Ensure the wall structure can support the unit's weight (approximately 50 lbs).

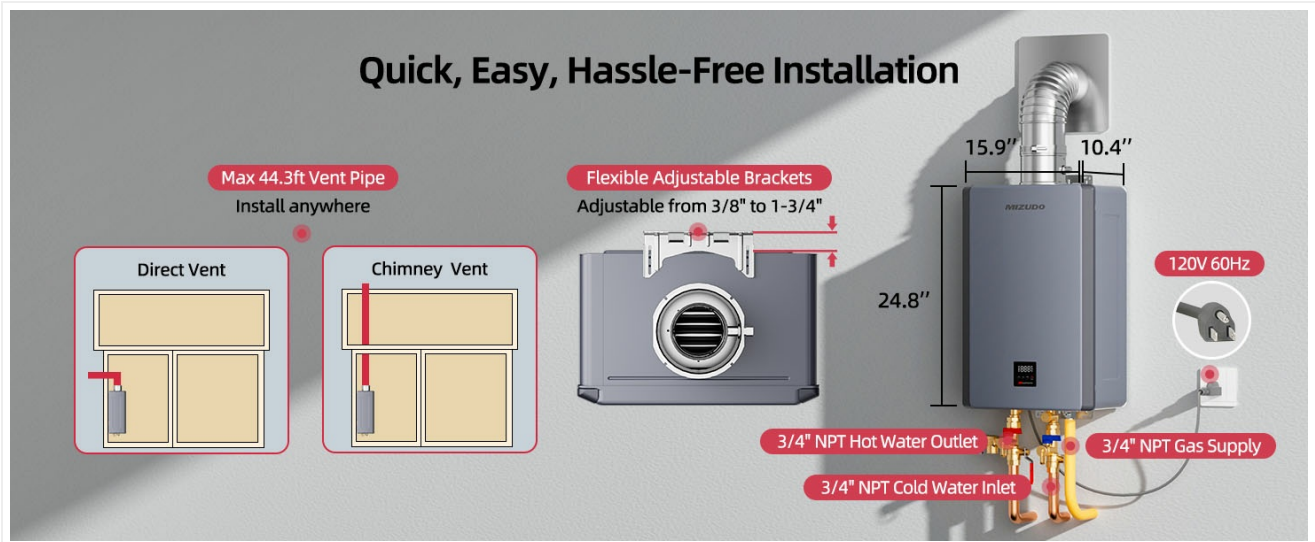

Image: Installation diagram showing direct vent and chimney vent options, flexible adjustable brackets, and connection points for hot water outlet, cold water inlet, gas supply, and 120V power.

## Connection Points

- **Hot Water Outlet:** 3/4" NPT
- **Cold Water Inlet:** 3/4" NPT
- **Gas Supply:** 3/4" NPT (Natural Gas)
- **Electrical:** 120V 60Hz

# On-Demand Endless Hot Water

MAX 10.3 GPM Supply for 5-7 Faucets

199,000 BTU Instant Heating

2+10 Safety Protection



APP Connection



120V 60Hz



3/4" NPT Hot Water Outlet

3/4" NPT Gas Supply

3/4" NPT Cold Water Inlet

Image: The MIZUDO water heater with clearly labeled 3/4" NPT hot water outlet, 3/4" NPT cold water inlet, 3/4" NPT gas supply, and 120V 60Hz electrical connection. Also shows QR codes for app connection.

## 4. OPERATION

The MIZUDO 199K Tankless Water Heater is designed for user-friendly operation, offering precise temperature control and smart connectivity.

### Temperature Control

The unit features advanced 6-stage gas modulation technology to maintain water temperature within  $\pm 1^\circ\text{F}$  of your set point, preventing sudden temperature fluctuations. The adjustable temperature range is 95°F to 149°F.

# Enjoy Instant Unlimited Hot Water

Intelligently adjust the water temperature difference within  $\pm 1^{\circ}\text{F}$



Image: A graph illustrating the MIZUDO water heater's ability to maintain a stable water temperature within  $\pm 1^{\circ}\text{F}$ , compared to a traditional product with wider temperature variations.

## 2+10 Safety Protection

- ✓ 2 Years Full Unit Quality Protection
- ✓ 5 Years Heat Exchanger Quality Protection



Image: Diagram explaining the 6-stage heating precision, from instant start to whole-home peak demand, ensuring precise flame control and stable water temperature.

## Smart WiFi and App Control

Manage your water heater remotely using the dedicated mobile application. Connect your device to WiFi to access features such as:

- Adjusting temperature settings.
- Creating custom schedules.
- Receiving maintenance alerts and error codes.
- Tracking energy usage.
- Switching operation modes.
- Checking real-time activity logs.



Image: A smartphone displaying the MIZUDO app interface, showing options to adjust temperature, view consumption reports, and manage settings remotely. Download the app from [a.smart321.com/fogattiandroidletsmart](https://a.smart321.com/fogattiandroidletsmart).

## 5. MAINTENANCE

---

Regular maintenance ensures the longevity and optimal performance of your MIZUDO tankless water heater. While the unit is designed for minimal maintenance, periodic checks are recommended.

### Routine Checks

- **Visual Inspection:** Periodically inspect the unit for any signs of leaks, corrosion, or damage.
- **Vent System:** Ensure the direct vent system is clear of obstructions and properly sealed.
- **Water Quality:** In areas with hard water, consider periodic descaling of the heat exchanger. Consult a professional for this service.
- **Freeze Protection:** The unit has built-in freeze protection (down to -13°F) with a 100W heating element. Ensure continuous power supply for this feature to function.

# Eco Heating, Certified Clean



VS



## Our Ultra-Low NOx Water Heater

### Advanced Pre-Mix Technology

Clean & even flame

### Ultra-Low Emissions

Meets SCAQMD Ultra-Low NOx Standard

### Zero Indoor Air Consumption

Maintains healthy indoor air quality

### High Efficiency

Full heat utilization, maximum savings

### Approved Everywhere

Certified for all U.S. communities

## Traditional Heater

### Basic Burner

Inefficient & high emissions

### High Pollutant Output

Pollutes indoor and outdoor air

### Potential Health Risk

Can release pollutants into living spaces

### Energy Waste

Incomplete burning, poor efficiency

### Installation Restrictions

Banned in many areas due to high NOx

Image: The MIZUDO water heater in a winter setting, highlighting its advanced anti-freeze protection, including all-around protection, 100W heating upgrade, and -13°F cold resistance. Continuous power supply is required for full functionality.

## 6. TROUBLESHOOTING

If you encounter issues with your MIZUDO tankless water heater, refer to the following general troubleshooting steps. For detailed diagnostics and solutions, consult the full user manual or contact customer support.

### Common Issues and Solutions

#### • No Hot Water:

- Check if the unit has power and the gas supply is open.
- Ensure water flow is sufficient to activate the heater.
- Verify temperature settings on the unit or via the app.

#### • Fluctuating Water Temperature:

- Confirm that the cold water inlet temperature is within the operational range.

- Check for proper water flow and pressure.

- **Error Codes:**

- Refer to the mobile application for specific error code explanations and recommended actions.
- Consult the comprehensive manual for a complete list of error codes.

- **Low Hot Water Flow:**

- Check for sediment buildup in water filters or aerators.
- Ensure adequate water pressure to the unit.

If problems persist, contact MIZUDO customer support or a qualified service technician.

## 7. SPECIFICATIONS

---

Detailed technical specifications for the MIZUDO 199K Tankless Water Heater.

Feature	Specification
Model Number	WCIU-HW199A1G-NG-M0
Brand	MIZUDO
Product Dimensions (W x H x D)	15.9" x 24.8" x 10.4"
Item Weight	50 pounds
Power Source	Natural Gas
Maximum Flow Rate	10.3 Gallons Per Minute (GPM)
Heat Output	199,000 BTU
Maximum Temperature	149 Degrees Fahrenheit
Voltage	120 Volts
Wattage	44 watts
Maximum Operating Pressure	150 Pound per Square Inch (PSI)
Mounting Type	Wall
Special Features	Advanced Sealed Combustion System, Automatic Anti-Freeze Protection, High Energy Efficiency, Smart WiFi and App Control, Supports 5 to 7 usage points

# Space-Saving Design Fits Anywhere

Perfect for large homes & estates with high water demand



Image: The MIZUDO water heater with its dimensions (24.8" H x 15.9" W x 10.4" D) shown, illustrating its compact, space-saving design.

## North America Ground Water Temperature Map

Model: 199,000 BTU			Application Key		
Inlet Temp (°F)	GPM	Approx Usage	Description	GPM	Symbol
77°F	10.3		Faucet	0.5	
72°F	8.9		Shower	1.5	
67°F	7.9		80-Gallon Bathtub	4.0	
<b>Outlet Water Temperature</b>					
62°F	7.1		110°F		
57°F	6.4		The flow rate for each symbol is represented in the GPM column of the Application Key.		
52°F	5.9		The Range column indicates variations in GPM for faucets and showers based on manufacturer and style.		
47°F	5.4				
42°F	5.0				
37°F	4.7				

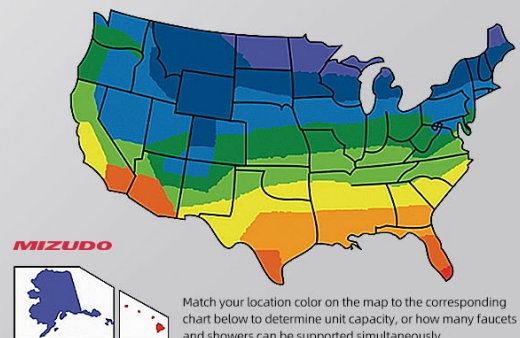

Image: A map of North America showing ground water temperatures and a chart indicating the approximate GPM and number of fixtures supported based on inlet water temperature and BTU output.

## 8. WARRANTY & SUPPORT

---

MIZUDO is committed to product quality and customer satisfaction. Your tankless water heater is backed by comprehensive warranty coverage.

### Warranty Coverage

- **Full Unit Warranty:** 2 years from the date of purchase.
- **Heat Exchanger Coverage:** 5 years from the date of purchase.

This warranty covers defects in materials and workmanship under normal use and service. Please retain your proof of purchase for warranty claims.

### Customer Support

For technical assistance, troubleshooting, warranty claims, or general inquiries, please contact MIZUDO customer support. Refer to the contact information provided in the packaging or on the official MIZUDO website.

You can also visit the official MIZUDO store on Amazon for more product information and support resources: [MIZUDO Store](#).