

[Manuals.plus](#) /

> [AVERA](#) /

> AVERA HEL30 30L Electric Oven Toaster Instruction Manual

AVERA HEL30

AVERA HEL30 30L Electric Oven Toaster Instruction Manual

Model: HEL30 | Brand: AVERA

1. PRODUCT OVERVIEW

The AVERA HEL30 is a 30-liter electric oven toaster designed for versatile cooking. It features four primary functions: toasting, baking, broiling (gratinar), and roasting. With a temperature range of 100°C to 250°C and a 60-minute timer, it offers precise control for various culinary tasks. Its 1500W power ensures efficient and uniform cooking.



Image 1.1: The AVERA HEL30 30L Electric Oven Toaster, showcasing its compact design and front controls.

Key Features:

- **30 Liter Capacity:** Suitable for preparing meals for the entire family.
- **1500W Power:** Ensures quick and even cooking results.
- **Adjustable Temperature:** Control from 100°C to 250°C for precise cooking.
- **Four Cooking Functions:** Toast, Bake, Broil (Gratinar), and Roast.
- **60-Minute Timer:** Features an audible alert and automatic shut-off for convenience.
- **Dual Heating Elements:** Options for upper, lower, or dual heating.
- **Included Accessories:** Baking tray, wire rack, and safety tongs.

2. IMPORTANT SAFETY INSTRUCTIONS

Please read all instructions carefully before using the appliance to ensure safe operation and prevent damage.

- Always place the oven on a stable, heat-resistant surface, away from walls and other appliances to allow for proper ventilation.
- Do not touch hot surfaces. Use oven mitts or safety tongs when handling hot items.
- Ensure the power cord is not damaged and is kept away from hot surfaces.
- Do not immerse the appliance, cord, or plug in water or other liquids.
- Close supervision is necessary when any appliance is used by or near children.
- Unplug from the outlet when not in use and before cleaning. Allow to cool before putting on or taking off parts.
- Do not operate any appliance with a damaged cord or plug, or after the appliance malfunctions or has been damaged in any manner.
- Do not insert oversized foods or metal utensils into the oven as they may create a fire or risk of electric shock.
- Do not store any materials, other than manufacturer's recommended accessories, in this oven when not in use.
- Do not place paper, cardboard, plastic, or other flammable materials in the oven.

3. PACKAGE CONTENTS

Carefully unpack the oven and check for the following items:

- AVERA HEL30 Electric Oven Toaster
- Baking Tray (Charola para alimentos)
- Wire Rack (Rejilla)
- Safety Tongs (Pinza de seguridad)
- Instruction Manual

Your browser does not support the video tag.

Video 3.1: Unboxing and accessory placement for the AVERA HEL30 Electric Oven Toaster. This video demonstrates how to safely remove the oven from its packaging and correctly position the included baking tray, wire rack, and safety tongs inside the oven cavity.

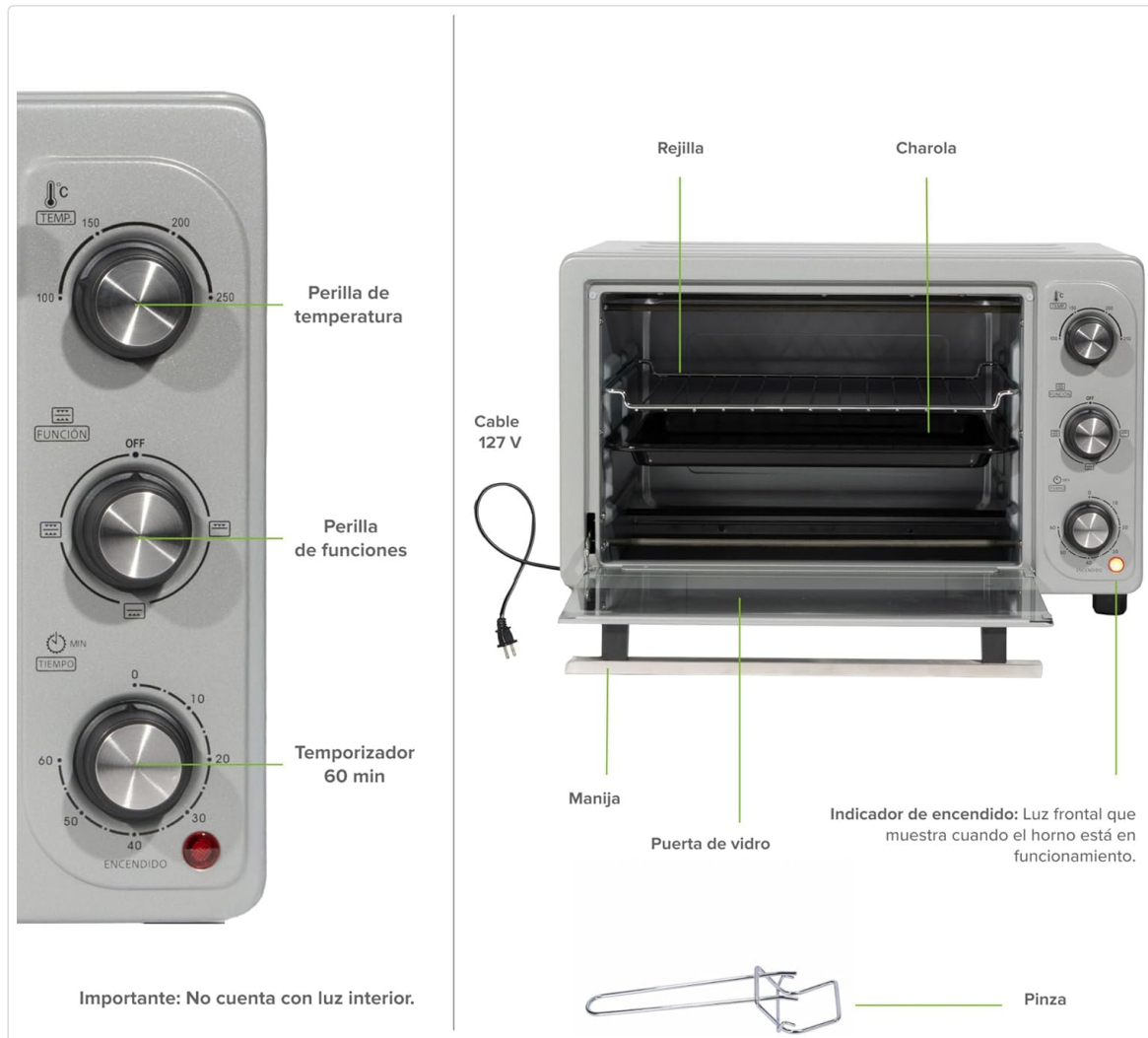

Image 3.2: Detailed view of the AVERA HEL30 oven's internal components, including the wire rack, baking tray, and safety tongs. This image highlights the placement of each accessory within the oven.

4. PRODUCT COMPONENTS

Familiarize yourself with the main parts of your AVERA HEL30 Electric Oven Toaster:

- **Temperature Control Knob:** Adjusts oven temperature from 100°C to 250°C.
- **Function Selector Knob:** Selects cooking mode (Off, Upper Heating, Lower Heating, Dual Heating).
- **Timer Knob:** Sets cooking time up to 60 minutes.
- **Power Indicator Light:** Illuminates when the oven is operating.
- **Glass Door:** Transparent door for monitoring cooking progress.
- **Handle:** For opening and closing the oven door.
- **Heating Elements:** Upper and lower heating elements for various cooking methods.

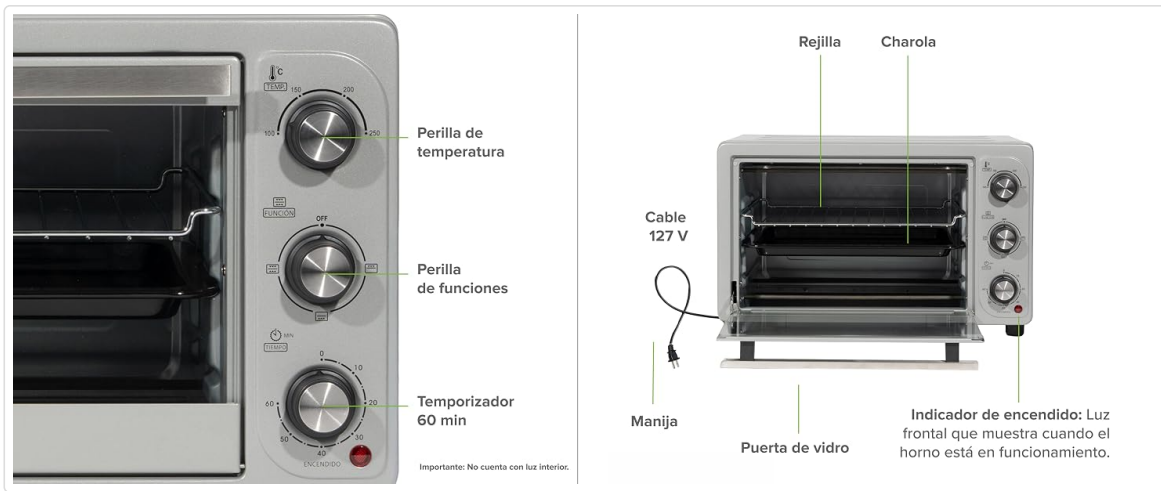

Image 4.1: Diagram illustrating the various components and control knobs of the AVERA HEL30 Electric Oven Toaster, including the temperature, function, and timer controls.

5. SETUP AND FIRST USE

1. **Placement:** Place the oven on a flat, stable, and heat-resistant surface. Ensure there is at least 10-15 cm (4-6 inches) of space on all sides for proper ventilation. Do not place it near flammable materials.
2. **Power Connection:** Plug the oven into a grounded 127V, 60Hz electrical outlet.
3. **Initial Burn-Off:** Before first use, operate the oven empty for approximately 15 minutes at the maximum temperature (250°C) using the dual heating function. This will burn off any manufacturing residues and odors. A slight smoke or odor is normal during this process. Ensure the area is well-ventilated.
4. **Cleaning:** After the initial burn-off and cooling, wipe the interior with a damp cloth. Wash the baking tray, wire rack, and tongs with warm, soapy water, rinse, and dry thoroughly.

6. OPERATING INSTRUCTIONS

Follow these steps to operate your AVERA HEL30 Electric Oven Toaster:

6.1. Setting Temperature

1. Turn the **Temperature Control Knob** (top knob) to your desired temperature, ranging from 100°C to 250°C.

6.2. Selecting Function

Turn the **Function Selector Knob** (middle knob) to choose one of the following cooking modes:

- **OFF:** Oven is off.
- **Upper Heating:** Activates only the top heating elements, ideal for broiling or browning.
- **Lower Heating:** Activates only the bottom heating elements, suitable for gentle baking or

reheating.

- **Dual Heating:** Activates both upper and lower heating elements, perfect for baking, roasting, and toasting.

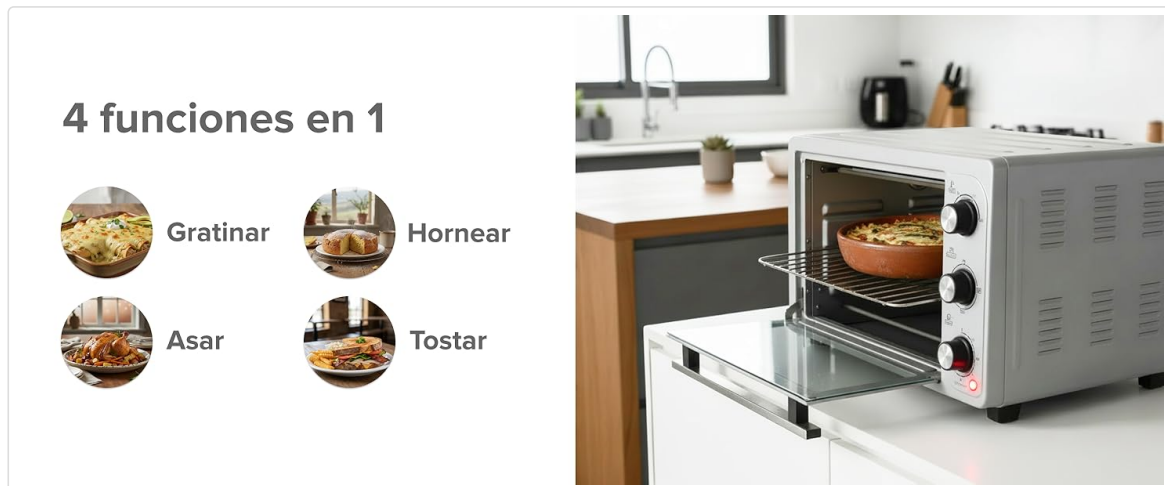

Image 6.1: Visual representation of the four cooking functions (Bake, Toast, Broil, Roast) available on the AVERA HEL30 oven, demonstrating their versatility for different dishes.

6.3. Setting Timer

1. Turn the **Timer Knob** (bottom knob) clockwise to set the desired cooking time, up to 60 minutes. The power indicator light will illuminate.
2. The oven will automatically turn off and an audible alert will sound once the set time has elapsed.
3. To stop cooking before the timer finishes, turn the timer knob counter-clockwise to the "OFF" position.

Tamaño XL

Cocina lo que se te antoje.



Image 6.2: The interior of the AVERA HEL30 oven showing the upper and lower heating elements in operation, illustrating the dual heating capability.

7. CLEANING AND MAINTENANCE

Regular cleaning will ensure optimal performance and extend the life of your oven.

1. **Always unplug the oven** from the power outlet and allow it to cool completely before cleaning.
2. **Exterior:** Wipe the exterior surfaces with a soft, damp cloth. Do not use abrasive cleaners or scouring pads.
3. **Interior:** Wipe the interior walls with a damp cloth and mild detergent. For stubborn stains, a non-abrasive cleaner designed for ovens can be used. Avoid spraying cleaners directly onto heating elements.
4. **Accessories:** Wash the baking tray, wire rack, and safety tongs in warm, soapy water. Rinse thoroughly and dry completely before storing or reusing.
5. **Glass Door:** Clean the glass door with a glass cleaner or a damp cloth.
6. **Do not immerse** the oven body, cord, or plug in water or any other liquid.

8. TROUBLESHOOTING

If you encounter issues with your oven, refer to the following common problems and solutions:

Problem	Possible Cause	Solution
Oven does not turn on.	Not plugged in; power outlet malfunction; timer not set.	Ensure the oven is securely plugged into a working outlet. Check the circuit breaker. Turn the timer knob to the desired cooking time.
Food is not cooking evenly.	Incorrect function selected; food placed too close to heating elements; oven not preheated.	Select the appropriate heating function (e.g., Dual Heating for even cooking). Adjust rack position. Allow the oven to preheat for 5-10 minutes before placing food inside.
Excessive smoke during cooking.	Food residue or grease buildup; high-fat foods.	Clean the oven interior and accessories thoroughly. Use a drip tray for fatty foods. Ensure proper ventilation.
Timer does not advance or oven does not turn off.	Timer mechanism issue.	If the timer is stuck or fails to turn off the oven, manually turn the function knob to "OFF" and unplug the appliance. Contact customer support.

If the problem persists after attempting these solutions, please contact AVERA customer support.

9. SPECIFICATIONS

Feature	Detail
Model Name	HEL30
Brand	AVERA
Capacity	30 Liters
Power	1500 Watts
Voltage	127 V
Frequency	60 Hz
Temperature Range	100°C to 250°C
Timer	Up to 60 minutes with auto shut-off
Functions	Toast, Bake, Broil (Gratinar), Roast

Feature	Detail
Dimensions (D x W x H)	36 cm x 49 cm x 31 cm
Weight	5.5 Kilograms
Material	Metal, Tempered Glass
Included Components	Baking Tray, Wire Rack, Safety Tongs, User Manual

MODELO: HEL30



Peso:
5.5 Kg



Image 9.1: Diagram showing the dimensions (height, width, depth) and weight of the AVERA HEL30 Electric Oven Toaster for placement and installation planning.

10. WARRANTY AND CUSTOMER SUPPORT

Your AVERA HEL30 Electric Oven Toaster comes with a manufacturer's warranty. Please refer to the warranty card included in your package for specific terms and conditions.

For technical assistance, troubleshooting not covered in this manual, or warranty claims, please contact AVERA customer support:

- **Website:** [Visit the AVERA Store on Amazon](#)
- **Contact Information:** Refer to the contact details provided in your warranty documentation or on the official AVERA website.

Please have your model number (HEL30) and purchase date ready when contacting support.