

Manuals+

[Q & A](#) | [Deep Search](#) | [Upload](#)

Manuals.plus /

- › [abetap](#) /
- › [abetap 8MP 4K Window Camera Instruction Manual](#)

abetap x24

abetap 8MP 4K Window Camera Instruction Manual

MODEL: x24

Your guide to seamless home security with advanced features.

[Introduction](#) [What's in the Box](#) [Setup Specifications](#) [Operating Support](#) [Maintenance](#) [Troubleshooting](#)

1. Introduction

The abetap 8MP 4K Window Camera is an advanced security solution designed for comprehensive indoor and outdoor monitoring. This camera offers exceptional 4K Ultra HD resolution, ensuring clear and detailed visuals. Key features include full-color night vision, intelligent AI motion detection for humans and vehicles, and continuous 24/7 recording. With its magnetic installation and dual-band WiFi support (5GHz & 2.4GHz), the camera provides flexible placement options and stable connectivity without requiring any subscription fees.

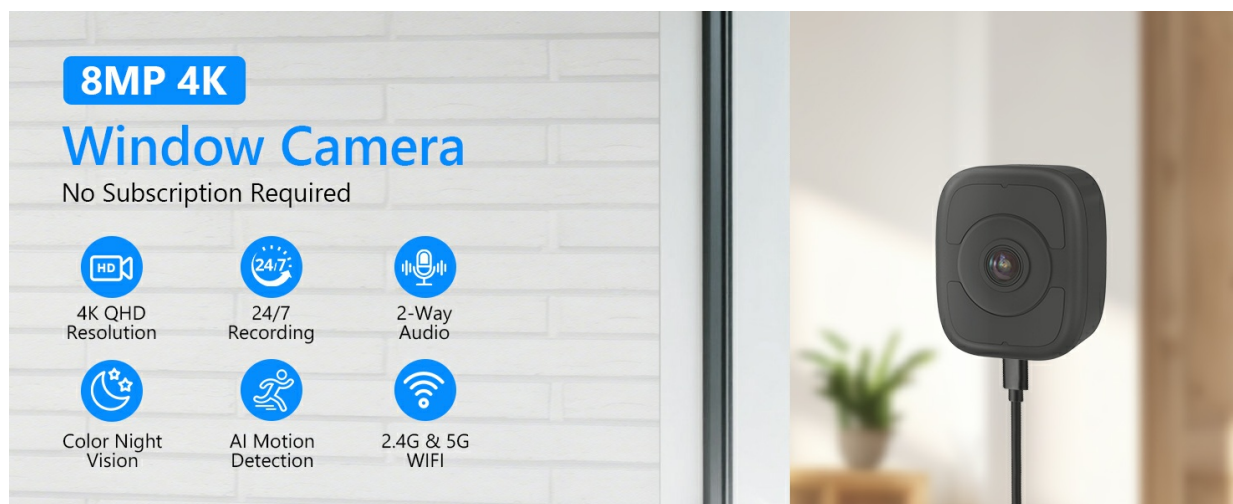
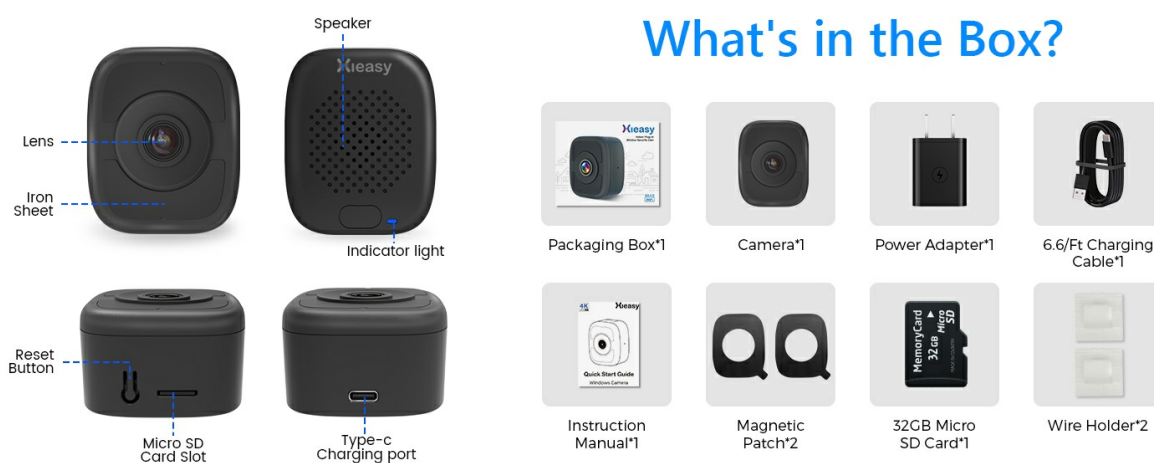

Figure 1: abetap 8MP 4K Window Camera overview highlighting key features.

2. What's in the Box

Please verify that all items listed below are included in your package:

- Camera (x1)
- 32GB SD Card (x1) - Pre-installed for immediate use.
- Charger (x1)
- 6.6FT Charging Cable (x1)
- Windows Sticker (x2) - For magnetic mounting.
- Magnetic Patch (x2) - For secure window attachment.
- Wire Holder (x2) - For cable management.
- Instruction Manual (x1)



3. Setup Guide

Follow these steps for quick and easy installation of your abetap 8MP 4K Window Camera:

1. **Power On:** Connect the camera to the provided charger and 6.6FT charging cable. Plug the charger into an electrical outlet. The camera will power on and indicate readiness for connection.
2. **Download the App:** Scan the QR code in the Quick Start Guide or search for the "Hieasy" app in your smartphone's app store (iOS or Android). Install the application.
3. **Connect to WiFi:**
 - Open the Hieasy app and click "Add Device".
 - The app will scan for nearby devices. Select your camera (e.g., "Network camera IOTFAA-999817-UGVWB") from the list.
 - Choose your WiFi network (supports both 5GHz and 2.4GHz) and enter the password. Ensure your device is close to the router during this step for optimal connection.
 - Wait for the device to connect. Once connected, you can name your device (e.g., "Family", "Living room").
 - Enable "Push alarm" to receive notifications for detected activities.
4. **Mounting the Camera:**

- Clean the window surface thoroughly where you intend to mount the camera.
- Peel off the backing from one of the magnetic mounting stickers.
- Stick the magnetic mounting sticker firmly onto the clean window surface.
- Attach the camera to the magnetic sticker. The strong magnet will hold it securely in place.
- Use the provided wire holders to neatly manage the charging cable along the window frame or wall.

Easy Setup in Minutes

Easy and successful installation in just a few steps

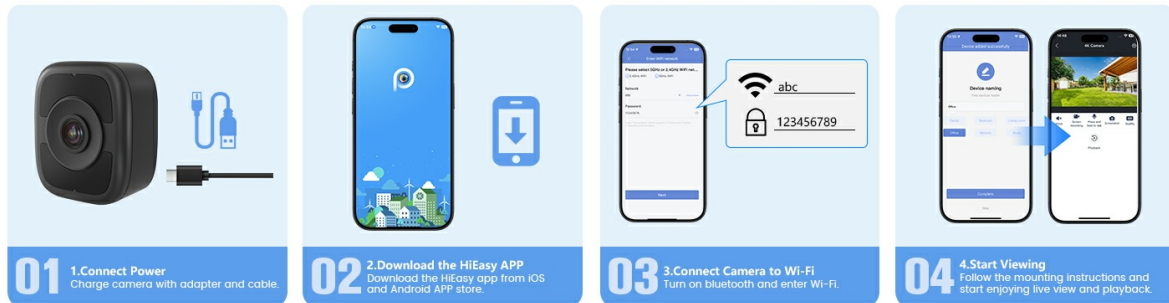

Figure 3: Visual guide for the easy setup process, from power connection to app integration.

Magnetic Window Camera

No drilling required, secure installation within 30 seconds



Figure 4: Demonstrates the magnetic installation method on a window, requiring no drilling.

Your browser does not support the video tag.

Video 1: A short tutorial demonstrating how to connect the abetap camera to the app and WiFi.

4. Operating Instructions

Your abetap 8MP 4K Window Camera offers a range of features for enhanced security and monitoring:

- **Live View & Playback:** Access real-time video feed and review recorded footage directly from the Hieasy app on your smartphone. The app interface allows for easy navigation and control.
- **4K Ultra HD Resolution:** The 8MP 4K lens provides superior image clarity with 4x zoom, enhanced HDR, and anti-glare/anti-reflection functions, ensuring optimal visibility day and night.

4K Ultra HD Resolution

See more details than 2K and 3K



Figure 5: Comparison showing the superior detail and clarity of 4K Ultra HD resolution.

- **Full Color Night Vision:** Utilizing advanced starlight color technology, the camera captures vivid color images even in low-light conditions. This is crucial for identifying details like clothing, vehicle colors, or license plates through windows at night, without the strong glare of infrared light.

Full Color Night Vision

See every detail in vivid color, even at midnight



Figure 6: Illustrates the effectiveness of full-color night vision compared to traditional night vision modes.

- **AI Motion Detection:** The intelligent action detection system provides free human and vehicle detection. When abnormal activity is detected, a notification is immediately sent to your phone, highlighting the recorded footage for future viewing. You can also customize detection areas to focus on specific zones.

Multiple Scenario Installation

Works on any window or glass

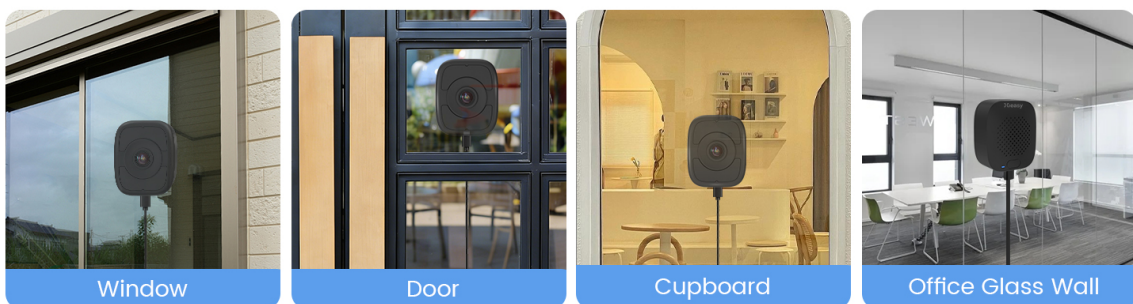

Figure 7: Shows the AI motion detection system identifying human and vehicle activity, sending alerts to a smartphone.

- **24/7 Continuous Recording & SD Card Storage:** The camera supports continuous recording and comes with a complimentary 32GB SD card, expandable up to 512GB. When the storage card is full, older video clips are automatically deleted to make space for new content, ensuring uninterrupted recording. No subscription is required for this feature.

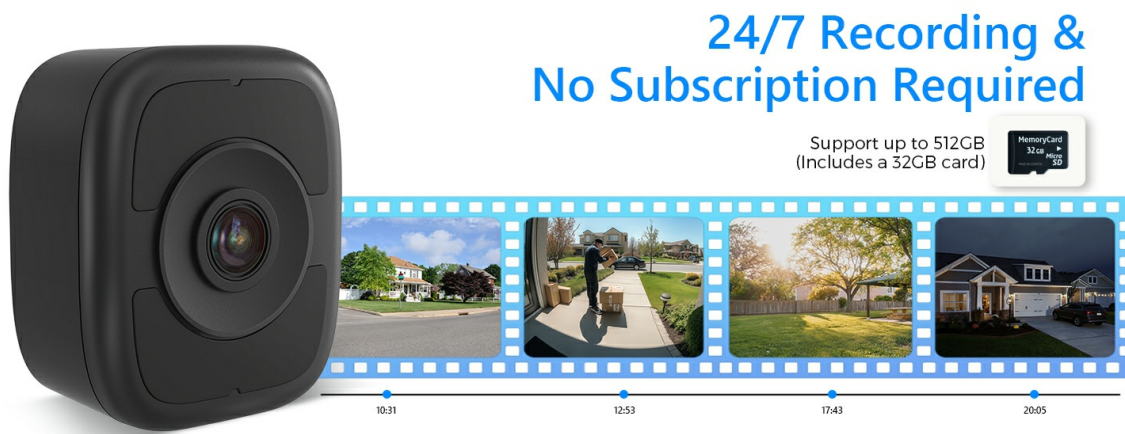

Figure 8: Highlights the 24/7 recording capability and the included 32GB SD card, with no subscription fees.

- **Two-Way Audio:** Engage in real-time conversations with visitors or deter intruders using the camera's built-in speaker and microphone, accessible through the app.

Two-way Talk

Real-time view and talk to visitors, anywhere, anytime

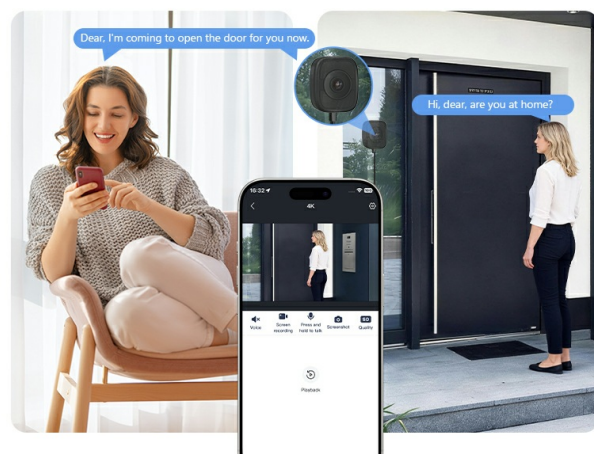

Figure 9: Demonstrates the two-way audio function, allowing communication through the camera.

- **Multiple User Sharing:** Share camera access with up to 16 family members and friends, allowing up to 3 people to view the feed simultaneously.



Multiple Users Sharing

Support sharing with 16 people, and 3 people can watch simultaneously

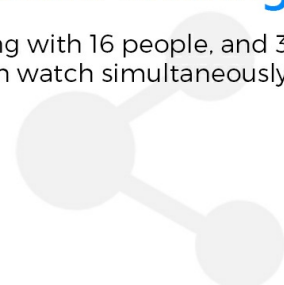

Figure 10: Illustrates the multi-user sharing feature, enabling multiple individuals to monitor

5. Maintenance

To ensure optimal performance and longevity of your abetap 8MP 4K Window Camera, consider the following maintenance tips:

- **Lens Cleaning:** Regularly clean the camera lens with a soft, lint-free cloth to prevent dust or smudges from affecting image quality.
- **Firmware Updates:** Check the Hieasy app periodically for any available firmware updates to ensure your camera has the latest features and security enhancements.
- **Power Connection:** Ensure the power cable is securely connected to both the camera and the power adapter to prevent interruptions in recording.
- **SD Card Management:** While the camera automatically manages old footage, it's good practice to occasionally review and back up important recordings from the SD card to another storage device.
- **Environmental Care:** Although designed for window mounting, avoid exposing the camera to extreme temperatures or direct harsh weather conditions if possible, to prolong its lifespan.

6. Troubleshooting

If you encounter any issues with your abetap 8MP 4K Window Camera, please refer to the following common solutions:

- **Camera Not Connecting to WiFi:**
 - Ensure the camera is within range of your WiFi router.
 - Verify that you have entered the correct WiFi password.
 - Check if your router supports both 5GHz and 2.4GHz networks. Try connecting to the other frequency if one fails.
 - Restart your router and the camera, then attempt to reconnect.
- **Poor Image/Video Quality:**
 - Clean the camera lens and the window surface.
 - Ensure there are no obstructions directly in front of the lens.
 - Check your internet connection speed; a slow connection can affect streaming quality.
- **No Motion Detection Alerts:**
 - Verify that "Push alarm" is enabled in the Hieasy app settings.
 - Check the customized detection areas to ensure they cover the desired monitoring zones.
 - Ensure the camera has a stable internet connection.
- **SD Card Not Recording:**
 - Ensure the 32GB SD card is properly inserted into the slot.
 - Check the SD card status in the app. If it's full, the camera will automatically overwrite older footage.
 - If issues persist, try formatting the SD card via the app (this will erase all data).

7. Specifications

Feature	Detail
Brand	abetap
Model Name	4K 8MP Window Camera
Model Number	x24
Recommended Uses	Outdoor Security
Connectivity Technology	Wired (for power), Wireless (for data)
Wireless Technology	2.4G & 5G Wi-Fi
Special Features	24/7 Recording, 4K HD Resolution, Two-way Audio, Color Night Vision, AI Motion Detection, No Subscription Required
Indoor/Outdoor Usage	Indoor, Outdoor
Compatible Devices	Smartphone (iOS & Android)
Mount Type	Window Mount (Magnetic)
Color	Black
Form Factor	Dome
Power Source	Corded Electric
Batteries Required	No
Viewing Angle	120 Degrees
Item Dimensions	2.6 x 2.2 x 1.3 inches
Built-In Media	32GB SD Card
Video Capture Resolution	4K
Video Capture Format	MP4
Night Vision Range	33 Feet

8. Warranty and Support

Your abetap 8MP 4K Window Camera comes with a standard 30-day return policy. For any product inquiries, technical support, or warranty claims, please contact abetap customer service through the platform where you purchased the product. Refer to the contact information provided in your purchase documentation or on the official abetap website.

© 2026 abetap. All rights reserved.