

Manuals+

[Q & A](#) | [Deep Search](#) | [Upload](#)

Manuals.plus /

› [JOYING](#) /

› JOYING Car Radio for Honda Civic 2012 (JY-HT902N12) User Manual

JOYING JY-HT902N12

JOYING Car Radio for Honda Civic 2012 (JY-HT902N12) User Manual

INTRODUCTION

This manual provides detailed instructions for the installation, operation, and maintenance of your JOYING 12.3 inch QLED Touch Screen Android 13 Car Stereo, model JY-HT902N12, designed specifically for the Honda Civic 2012. Please read this manual thoroughly before installation and use to ensure proper function and to maximize your experience with the device.

SETUP AND INSTALLATION

The JOYING car radio is designed for a plug-and-play installation in the Honda Civic 2012. All necessary cables are supplied to facilitate the installation process without requiring modifications to the vehicle's original wiring.

Vehicle Dashboard Confirmation

It is crucial to confirm your vehicle's dashboard configuration before installation. The wiring harness may differ between vehicle options. Please refer to the images below to identify the correct option for your Honda Civic 2012 dashboard. If you are uncertain, contact customer support with a photo of your car's dashboard for assistance.

Confirm Your Car Dashboard

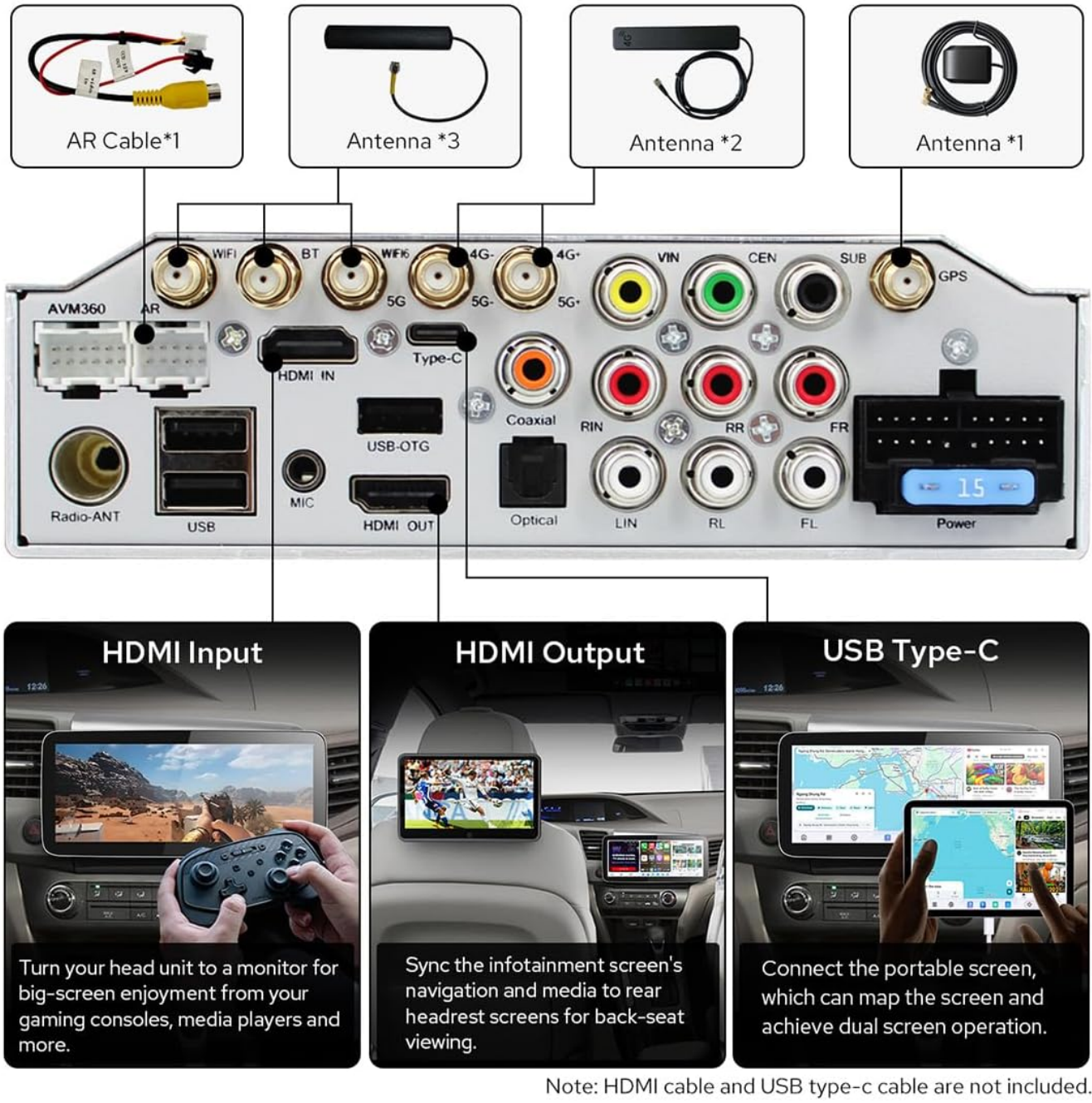

Figure 1: Confirming Car Dashboard Type. This image illustrates two common dashboard configurations for the Honda Civic 2012, labeled 'A: without screen' and 'B: with DA screen', to help identify the correct wiring harness for your vehicle.

Connecting the Head Unit

The rear of the head unit features various interfaces for connecting power, antennas, USB devices, and other accessories. Ensure all connections are secure and correctly matched to their respective ports.

Head Unit Rear Interfaces



Note: HDMI cable and USB type-c cable are not included.

Figure 2: Head Unit Rear Interfaces. This diagram details the various input and output ports located on the back of the car radio, including connections for antennas, USB, HDMI, and power.

The system is designed to retain original vehicle features such as the OEM amplifier, factory subwoofer, factory reverse camera, and factory steering wheel controls. Proper wiring ensures these functions remain operational.

Retains Original Features

- ✓ OEM Amplifier
- ✓ Factory Reverse Camera
- ✓ Factory Subwoofer
- ✓ Factory Steering Wheel Control



Figure 3: Retained Original Features. This image confirms that the car radio system is compatible with and retains the functionality of the vehicle's original amplifier, subwoofer, reverse camera, and steering wheel controls.

OPERATING INSTRUCTIONS

System Overview

The JOYING car radio operates on Android 13, powered by a Qualcomm QCM6490 8-core processor. It features 12GB RAM and 256GB storage, providing efficient multitasking and smooth application performance. The 12.3-inch QLED touchscreen offers a high-resolution display for navigation, entertainment, and various applications.

Navigation and Applications

The system integrates navigation, entertainment, and third-party applications into a single interface. You can switch between applications by tapping the designated icon.

Navigation, Entertainment, and Third-party Apps All at One Interface

Tap the "----" icon to switch to the app's interface.



Long press to switch apps.

Figure 4: Navigation and Application Interface. This image displays the user interface, demonstrating how to access and switch between different applications for navigation, media, and other functions.

CarPlay and Android Auto

The unit supports both wired and wireless Apple CarPlay and Android Auto. Connecting your smartphone allows access to contacts, maps, music, messages, and voice control features like Siri or Google Assistant.

Bluetooth Connectivity

Dual-mode Bluetooth supports simultaneous connections to two smartphones or a combination of a phone and an OBD diagnostic dongle. This allows for flexible audio streaming and hands-free communication.

Dual-mode Bluetooth Supports the Coexistence and Switching

Enabling functionalities such as simultaneous connections to two smartphones or a combined link between a phone and an OBD diagnostic dongle.



Figure 5: Dual-Mode Bluetooth and Smartphone Integration. This image highlights the system's ability to connect to multiple Bluetooth devices simultaneously and its support for wireless CarPlay and Android Auto.

Network Connectivity

The system supports dual-band WiFi (2.4 GHz, 5 GHz, and 6 GHz) for high-speed and stable network access. A 4G module is also integrated, allowing internet access via a SIM card (SIM card not included; phone calls and SMS are not supported via the unit's SIM card functionality).

AM/FM Radio

The unit includes an AM/FM radio tuner with 18 preset FM stations for local broadcast listening.

Display Modes

The display supports light and dark modes, with options for manual or automatic switching based on ambient light conditions.

Light/Dark Mode with Manual or Auto Switching

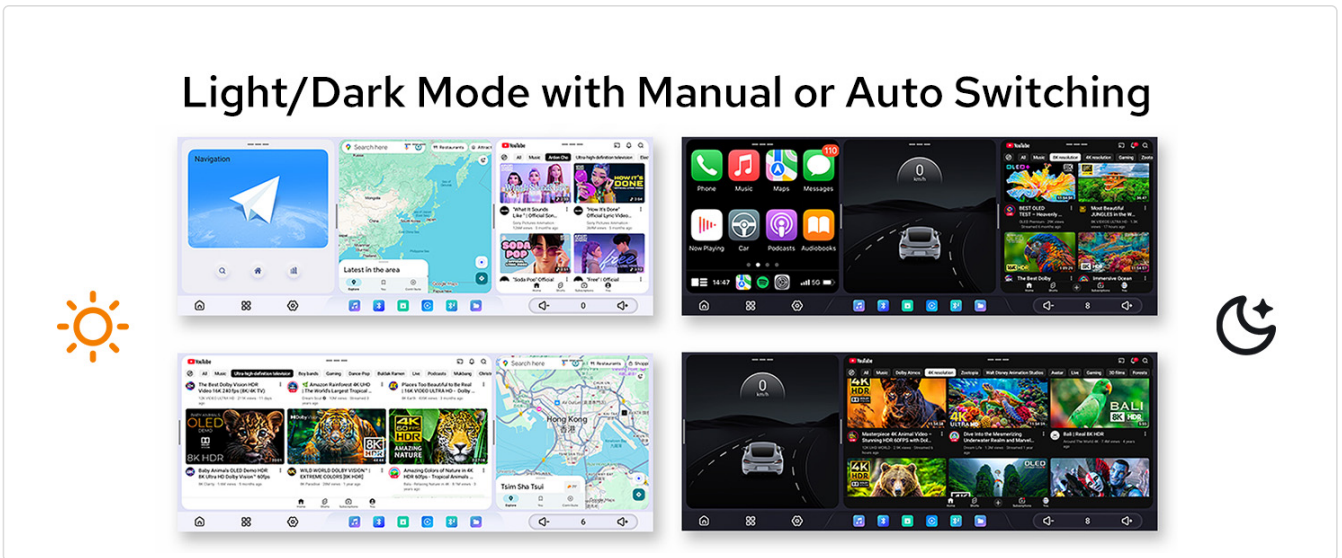

Figure 6: Light/Dark Mode Display. This image illustrates the visual difference between the light and dark display modes, which can be set manually or to switch automatically.

Audio Features

The unit features a TDA7850 amplifier, AKM 4432 DAC, and AKM 7739 DSP for high-fidelity audio output. It supports DTS sound and offers 20 selectable sound effect styles with a 48-band EQ for audio customization.

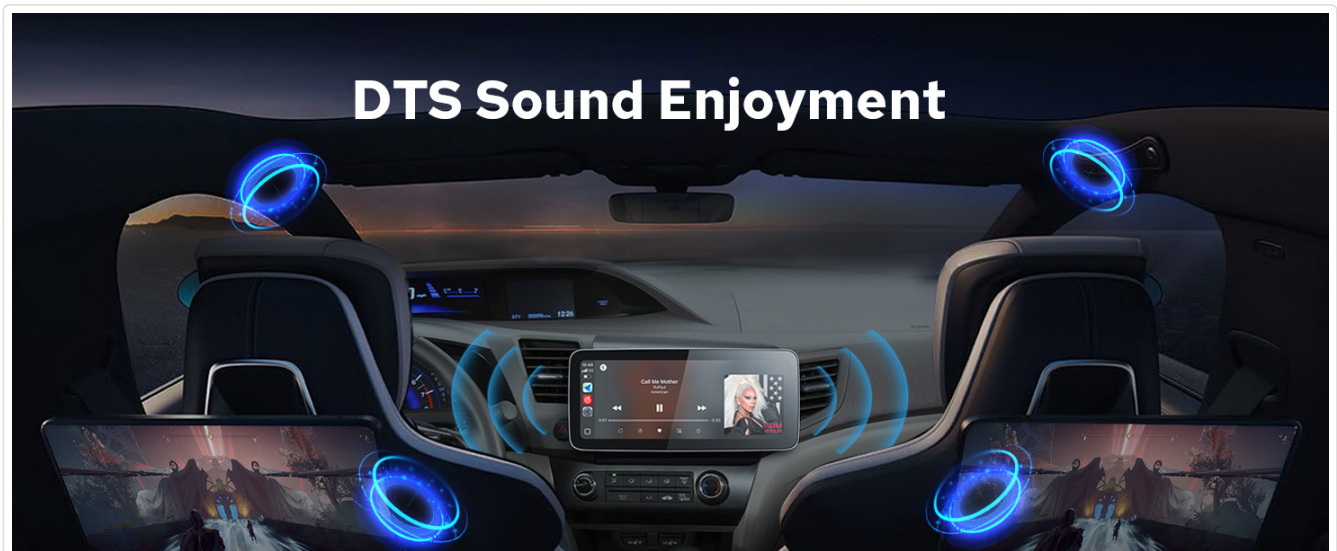

Figure 7: DTS Sound Experience. This image visually represents the immersive audio experience provided by the DTS sound technology within the vehicle.

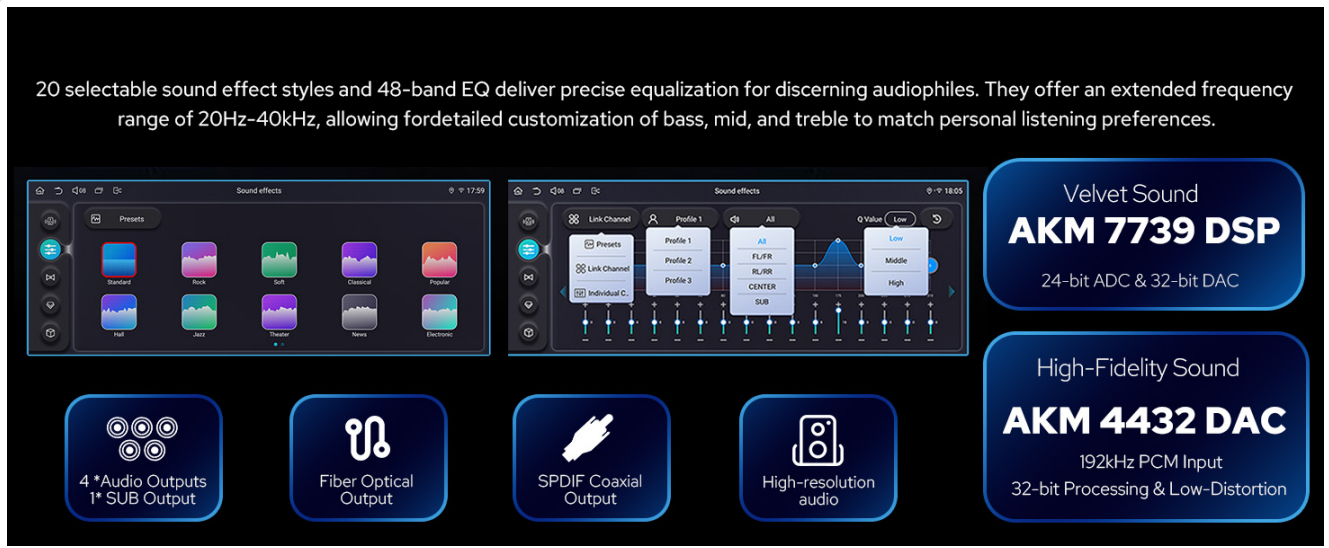

Figure 8: Audio Customization Interface. This image displays the user interface for selecting sound effect styles and adjusting the 48-band equalizer, along with key audio component specifications.

Bluetooth audio supports SBC, AAC, and Qualcomm aptX HD codecs, with aptX HD offering lossless quality for compatible Android phones.

Bluetooth	SBC	AAC	Qualcomm aptX™ HD
Resolution	16Bit	16Bit/24Bit	24bit/48kHz
Bit Rate	256kbps	320Kbps	576kbps
Bandwidth	20Hz-17kHz	20Hz-20kHz	20Hz-22kHz
Delay	200ms	120ms	60ms
Sound Quality	Normal	Normal	Lossless

Note: aptX/aptX HD Audio: Compatible with Android phones only. The iPhone defaults to the AAC codec.

Figure 9: Bluetooth Audio Codec Comparison. This table provides a comparison of different Bluetooth audio codecs supported by the unit, including their technical specifications and sound quality characteristics.

Multiband GNSS

The integrated Multiband GNSS supports GPS, GLONASS, NavIC, BeiDou, Galileo, and QZSS, utilizing GNSS L1 and L5 bands for accurate positioning and navigation.

Multiband GNSS - Integrated

Qualcomm® Location Suite Engine Global positioning system (GPS), GLONASS, NavIC, BeiDou, Galileo, quasi-zenith satellite system (QZSS) Supports GNSS L1 and L5 bands.

Generation : Wi-Fi 6E

Standards : 802.11ac, 802.11n, 802.11ax, 802.11g, 802.11b

Spectral Bands :2.4 GHz, 6 GHz, 5 GHz

MIMO Configuration :2x2

Features : MU-MIMO (UL/DL), OFDMA, Dual-Band Simultaneous (DBS)3



Figure 10: Multiband GNSS Functionality. This image illustrates the integrated global navigation satellite system, displaying satellite connections and navigation features.

MAINTENANCE

To ensure the longevity and optimal performance of your JOYING car radio, follow these maintenance guidelines:

- **Screen Cleaning:** Use a soft, lint-free cloth to gently wipe the touchscreen. For stubborn smudges, slightly dampen the cloth with water or a screen-safe cleaner. Avoid harsh chemicals or abrasive materials.
- **Software Updates:** Periodically check for available software updates from JOYING to ensure you have the latest features and performance enhancements. Follow the instructions provided with the update package.
- **General Care:** Avoid exposing the unit to extreme temperatures, direct sunlight for prolonged periods, or excessive moisture. Ensure proper ventilation around the unit to prevent overheating.

TROUBLESHOOTING

If you encounter issues with your JOYING car radio, refer to the following common troubleshooting steps:

- **No Power:** Check all power connections and fuses. Ensure the vehicle's ignition is on.
- **No Sound:** Verify speaker connections. Check volume levels and audio settings. Ensure the correct audio source is selected.
- **Touchscreen Unresponsive:** Try restarting the unit. If the issue persists, perform a factory reset (refer to system settings for this option).
- **GPS Signal Loss:** Ensure the GPS antenna is properly installed and has a clear view of the sky. Check GPS settings within the system.
- **Bluetooth/WiFi Connection Issues:** Ensure Bluetooth/WiFi is enabled on both the unit and your device. Try unpairing and re-pairing devices. Check for interference from other electronic devices.
- **CarPlay/Android Auto Not Connecting:** Ensure your phone is compatible and the connection method (wired/wireless) is correctly configured. Try a different USB cable if using a wired connection.

For persistent issues or problems not covered here, please contact JOYING customer support for further assistance.

SPECIFICATIONS

Feature	Detail
Model Number	JY-HT902N12
Display Size	12.3 Inches
Operating System	Android 13
Processor	Qualcomm QCM6490 (8-Core)
RAM	12GB
Storage Capacity	256GB
Connectivity Technology	Bluetooth, Ethernet, USB, Wi-Fi (2.4/5/6 GHz), 4G Module
Special Features	Bluetooth, Touchscreen, Wireless CarPlay & Android Auto, GPS, AM/FM Radio
Audio Output Mode	Stereo
Map Type	North America (Pre-installed)
Touch Screen Type	Capacitive

Motherboard Feature Overview

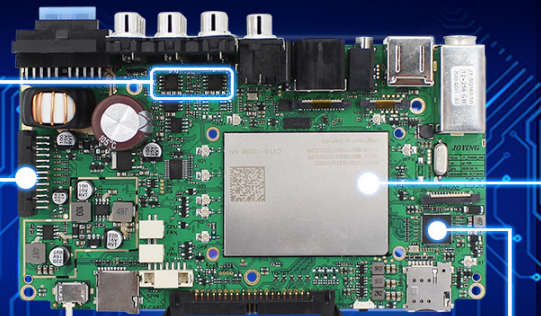

Audio Output

4-channel, 5532 Op-Amp
Ultra-Low 5 nV/√Hz Noise
for Pure Audio Fidelity.

Main Processor: ARM QCM6490

GPU: Qualcomm® Adreno™ 643 @814 MHz
NPU Computing Power: **14** TOPS
Manufacturing Process: **6nm**
Benchmark Score: ≈ **660,000** points

Octa-core Kryo 670 CPU:
* 1 × A78 Gold Plus @ 2.7 GHz
* 3 × A78 Gold @ 2.4 GHz
* 4 × A55 Silver @ 1.9 GHz



TDA7850 Amplifier

- * 4 x 20W (RMS)
- * 50W Max/Channel (at 14.4V)
- * 20Hz - 20kHz Frequency Response
- * THD+N < **0.1%**

Image Processor TP2815

Enabling AR cameras (Front & Rear) live view and a 360° panoramic camera.

Figure 11: Motherboard Feature Overview. This diagram provides a detailed look at the internal components of the car radio, including the main processor, GPU, NPU, and amplifier.

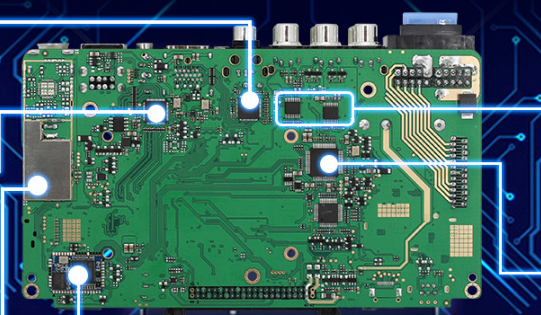

LT 8711H (Output)

- * Type-C with DP 1.2
- * HDMI 2.0a & 1.4
- * Max. 4K@30Hz & 1080p@60Hz

Audio DAC: AKM 4432

- * 192kHz PCM Input
- * 32-bit Processing & Low-Distortion
- * High-Fidelity Sound Reproduction

LT 6911C (Input)

- * HDMI 2.0a & 1.4
- * Up to 3.4Gbps/Channel
- * 1080p@60Hz & 4K Resolution
- * 3D Video Signals Support

Audio DSP: AKM 7739

- * 24-bit ADC & 32-bit DAC
- * Multi-channel Audio Processing
- * VELVET SOUND Technology
- * Automotive Audio Optimized

Radio Tuner:
NXP TEF6686
(Automotive-Grade)
FM / AM / RDS Support

Dual Bluetooth

BT1: QCC3031 with Qualcomm® aptX™/aptX™ HD audio and cVc™ echo and noise cancellation.
BT2 WCN6856 supports dual-band simultaneous (DBS) Bluetooth 5.2 compliant WLAN standards: 802.11ax, 2 × 2 multiple input, multiple output (MIMO) Wi-Fi 6E.

Figure 12: Motherboard Audio Components. This diagram focuses on the audio-related components of the motherboard, such as the Audio DAC, Audio DSP, and Radio Tuner, detailing their specifications.

Advanced Engineering High-Efficiency Cooling



Figure 13: Advanced Cooling System. This image illustrates the internal cooling mechanisms, including fans and heat sinks, designed for high-efficiency thermal management of the car radio.

PACKAGE CONTENTS

The following items are included in your JOYING car radio package:

- 12.3" Radio Unit
- Frame Kit
- Single Din Cage
- Power Cable (may vary based on vehicle option)
- BT Antenna (1x)
- WiFi Antenna (2x)
- 4G Antenna (2x)
- USB Cable (2x)
- User Manual (1x)
- GPS Antenna (1x)
- External Microphone (1x)
- AR Cable (1x)
- Screen Ribbon Cable (1x)



Figure 14: Included Package Contents. This image provides a visual representation of all items supplied with the JOYING car radio, including the main unit, installation accessories, and cables.

Optional Accessories

The following accessories are not included in the standard package and must be purchased separately:

- AR Front Camera: For recording the road ahead while driving.
- OBD2 Dongle: Connects via Bluetooth to retrieve real-time data and trouble codes from your vehicle's computer.
- AR Rear Camera: Automatically switches to reverse display when backing up.



Figure 15: Optional Accessories. This image displays additional accessories that can be purchased separately to enhance the functionality of the car radio, such as cameras and an OBD2 dongle.

WARRANTY AND SUPPORT

Warranty Information

Your JOYING car radio (Model JY-HT902N12) comes with a **2-Year Warranty** from the date of purchase. This warranty covers manufacturing defects and ensures the product meets its specified performance standards. Please retain your proof of purchase for warranty claims.

Customer Support

For technical assistance, troubleshooting, or warranty inquiries, please contact JOYING customer support. You can typically find contact information on the official JOYING website or through your purchase platform.