

[Manuals.plus](#) /

> [GODOX](#) /

> [GODOX AD800Pro Outdoor Flash Strobe User Manual](#)

GODOX AD800Pro

GODOX AD800Pro Outdoor Flash Strobe User Manual

Model: AD800Pro | Brand: GODOX

1. PRODUCT OVERVIEW

The GODOX AD800Pro is an 800Ws outdoor flash strobe designed for professional photography. It offers exceptional main-light performance, capable of overpowering bright sunlight with up to 300 full-power flashes per charge and a rapid recycle time of 0.01-1.5 seconds. This unit provides precise power control across a 10-stop range (1/512 to 1/1) with 0.1-stop increments, making it suitable for various lighting setups including product and still-life photography.

Advanced professional modes such as Freeze, Stable Color Temperature, and High-Speed Sync (HSS) enable photographers to reliably capture fast-action, product, and color-critical work. The AD800Pro integrates with the Godox 2.4 GHz X wireless system for robust, long-range control, including one-tap pairing with X3Pro/X3 transmitters. It also supports wired synchronization via a 3.5mm PC jack and external 433 MHz receivers via USB-C, offering versatile triggering options.

Power solutions are flexible, with support for an optional AC26 adapter for continuous AC operation and an optional UC-46 fast charger to reduce battery charging time to approximately 1.5 hours. The native Bowens mount ensures compatibility with a wide range of light-shaping tools, and an optional H600P extension head provides flexible light placement. The unit features an HD color screen, a 40W bi-color modeling lamp, and 16 color group indicators for intelligent and effortless control.

Your browser does not support the video tag.

Official GODOX AD800Pro Overview and Creative Tips Video. This video demonstrates various features and creative applications of the AD800Pro flash strobe, including overpowering sunlight, capturing motion with fast recycling and Freeze Mode, using the bi-color modeling lamp for slow-shutter effects, creating indoor 'sunlight' with BFP and gobos, and achieving double exposure effects.

2. WHAT'S IN THE BOX

The GODOX AD800Pro package includes the following components:

- 1 x Flash Body
- 1 x Flash Tube
- 1 x Battery
- 1 x Adapter
- 1 x Power Cable
- 1 x Reflector
- 1 x Reflector Protective Cover
- 1 x HolaFoto Cloth

What's Inside



An exploded view illustrating all components included in the GODOX AD800Pro package.

3. SETUP AND INSTALLATION

3.1 Mounting the Flash Body

Attach the AD800Pro flash body securely onto a compatible light stand. Ensure the mounting bracket is tightened to prevent accidental movement.

3.2 Installing the Battery

Insert the provided battery into the designated battery compartment on the flash body. Ensure it clicks into place for a secure connection.

3.3 Installing Flash Tube and Reflector

Carefully install the flash tube into the flash head. Then, attach the reflector by aligning it with the Bowens mount and rotating until it locks securely. The reflector protection cover can be used when the flash is not in use.

3.4 Adjusting the Angle

Use the adjustment knob on the mounting bracket to set the desired angle for the flash head. Tighten the knob to lock the position.

3.5 Power On

Press and hold the power button to turn on the AD800Pro. The HD color screen will illuminate, displaying the current settings.

4. BASIC OPERATION

4.1 Flash Modes

The AD800Pro supports various flash modes:

- **M (Manual Flash):** Manually set the flash output power.
- **Multi (Stroboscopic Flash):** Fires a series of rapid flashes within a single exposure to capture multiple movements.
- **TTL (Auto Flash):** Automatically adjusts flash output for correct exposure.

4.2 Modeling Lamp

The 40W bi-color modeling lamp offers adjustable brightness (10%-100% in 1% steps) and color temperature (2800K-6000K in 100K steps). It has three modes:

- **OFF:** Modeling lamp is off.
- **FREE (Continuous):** Lamp stays on continuously.
- **PROP (Proportional):** Modeling light brightness adjusts automatically with flash power.



The control panel of the GODOX AD800Pro, illustrating the digital display and control buttons for adjusting settings.

4.3 Other Settings

- **Beep:** Enable or disable the beep sound for flash readiness.
- **Power Type:** Adjust power output settings.
- **Standby:** Set the standby time for power saving.
- **Auto Off:** Configure automatic power-off duration.
- **Screen Brightness:** Adjust the display brightness (20%-100%).
- **Delay Flash:** Set a delay for flash firing (0.01-30s).
- **Mask:** Enable or disable mask mode.
- **Language:** Select the display language (e.g., English).
- **Reset:** Restore factory default settings.
- **Device Info:** View device firmware version.

5. ADVANCED FEATURES

5.1 High-Speed Sync (HSS)

HSS allows the flash to synchronize with shutter speeds up to 1/8000s, enabling wider apertures in bright conditions or freezing fast motion effectively.

5.2 Freeze Mode

Utilize Freeze Mode for ultra-short flash durations (as fast as 1/35710s at 1/512 power) to capture fast-moving subjects with extreme sharpness, ideal for splashes or dynamic action shots.

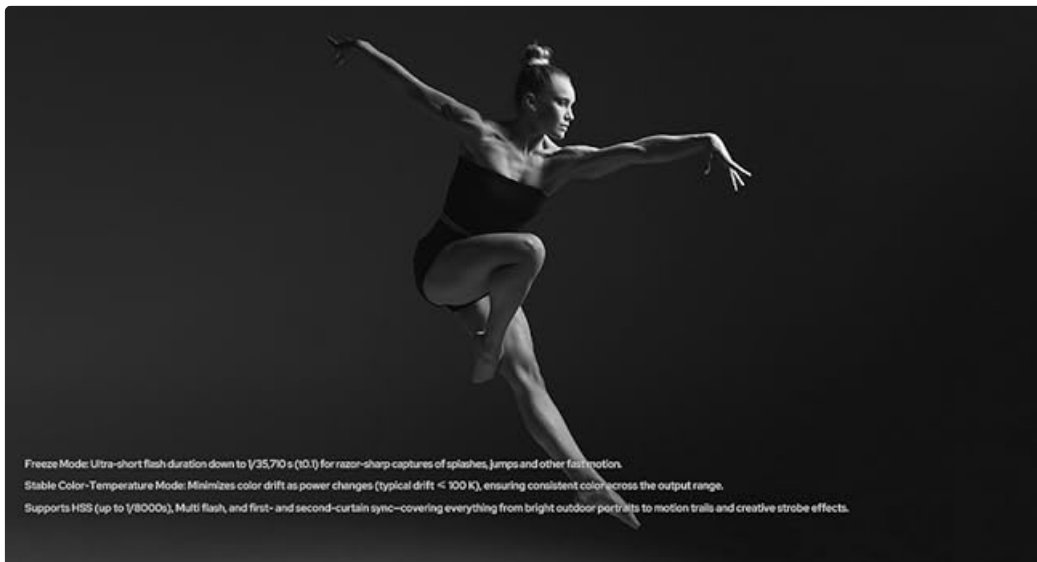

A dancer in a dynamic pose, illustrating the motion-freezing capability of the AD800Pro's advanced flash modes.

5.3 Stable Color Temperature Mode

This mode minimizes color drift across the output range, ensuring consistent color accuracy, which is crucial for product photography and other color-critical applications.

5.4 Wireless Triggering

The AD800Pro features a built-in Godox 2.4 GHz X wireless system for reliable remote control. It supports one-tap sync with X3Pro/X3 transmitters and is compatible with other X-series transmitters. Manual channel setup is also available. For broader compatibility, an optional FT433 trigger can be used via the USB-C port.

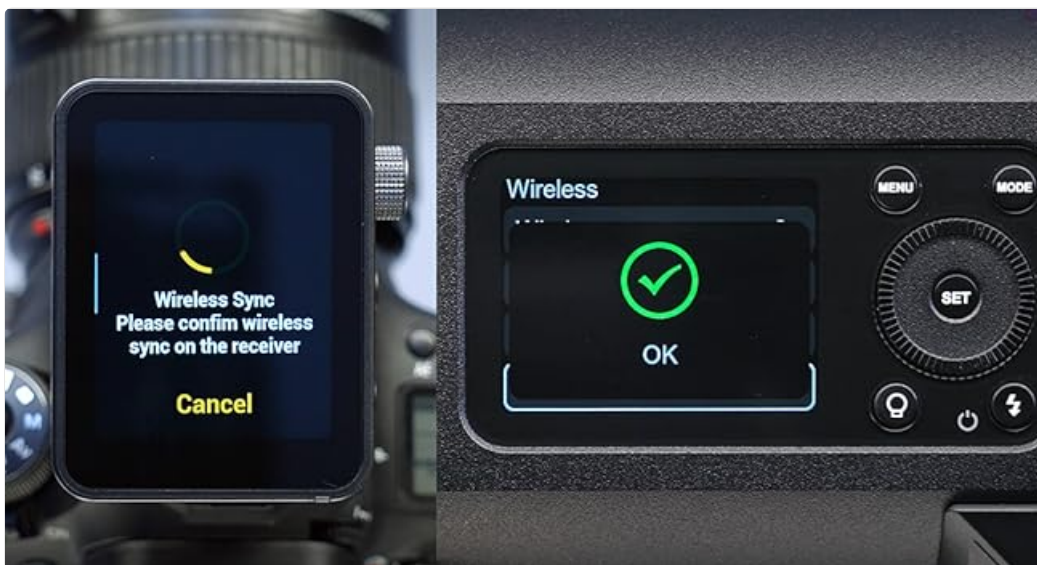

Wireless sync confirmation screens on a camera and the AD800Pro, indicating successful connection.

5.5 Flexible Power Solutions

For extended shooting sessions, the AD800Pro can be powered directly from the mains using the optional AC26 adapter. The optional UC-46 fast charger significantly reduces battery charging time.



An array of power solutions for the AD800Pro, including the AC adapter and battery chargers.

6. ACCESSORIES AND COMPATIBILITY

6.1 Bowens Mount Compatibility

The AD800Pro features a native Bowens mount, ensuring compatibility with a vast ecosystem of light modifiers such as softboxes, beauty dishes, grids, and snoots, providing extensive creative control.

6.2 Optional Extension Head (H600P)

The optional H600P extension head, equipped with a 2-meter cable, allows for flexible light placement and facilitates lightweight handheld or boom-mounted setups, separating the flash head from the main body for easier balancing.



A photographer utilizing the AD800Pro with an extension head and a large umbrella for outdoor shooting.

6.3 16-Color Group Indicators

The AD800Pro includes 16 color group indicator lights, allowing for quick identification and management of multiple light setups, simplifying complex studio or on-location shoots.

6.4 Fine Power Control

Achieve precise exposure control with power adjustments from 1/512 to 1/1 in 0.1-stop increments, offering granular control over light output.

7. TECHNICAL SPECIFICATIONS

Feature	Specification
Brand	GODOX
Model Number	AD800Pro
Flash Power	800Ws
Recycle Time	0.01-1.5s
Full Power Flashes	Up to 300
Power Range	10 stops (1/512-1/1) in 0.1-stop increments
Sync Speed	Up to 1/8000s (HSS)
Flash Modes	TTL, M, Multi, Freeze, Stable Color Temperature
Wireless Technology	Godox 2.4 GHz X System, 433 MHz (with optional receiver)
Modeling Lamp	40W Bi-color (2800K-6000K), adjustable brightness
Mount Type	Bowens Mount
Compatible Cameras	Canon, Sony, Nikon, Fujifilm, Olympus, Panasonic, Pentax, Leica
Water Resistance	Not water resistant