



Manuals.plus /

› LAICOMEIN /

› LAICOMEIN BF05 Bluetooth 6.0 Transmitter Receiver Instruction Manual

LAICOMEIN BF05

LAICOMEIN BF05 Bluetooth 6.0 Transmitter Receiver Instruction Manual

Model: BF05 | Brand: LAICOMEIN

1. PRODUCT OVERVIEW

The LAICOMEIN BF05 is an advanced Bluetooth 6.0 dual-mode audio adapter designed to provide seamless wireless audio connectivity. It functions as both a transmitter (TX) and a receiver (RX), allowing you to enjoy high-quality audio in various scenarios, from in-flight entertainment to home stereo systems.

Key features include AptX Adaptive/LL/HD Audio for clear, lag-free sound, dual-link pairing to connect two devices simultaneously, a long-lasting 20+ hour battery, and hands-free calling capabilities in RX mode.

Transmitter Mode

Moderize your non-Bluetooth TV,PC,MP3.



Receiver Mode

Update your home stereo system to wireless streaming.



Image: Overview of the LAICOMEIN BF05 operating in Transmitter (TX) mode, connecting to non-Bluetooth devices like TVs, airplanes, and gaming consoles to stream audio to Bluetooth headphones/speakers. Also shown in Receiver (RX) mode, receiving audio from smartphones/tablets to play through car stereos or wired speakers.

2. WHAT'S IN THE BOX

- LAICOMEIN BF05 Bluetooth Transmitter Receiver
- USB-C Charging Cable
- RCA Audio Adapter Cable
- Dual-prong Audio Connector for Aircraft
- Instruction Manual

Easier To Use, One-Button Operation



Image: The LAICOMEIN BF05 device and its included accessories, including the charging cable, RCA adapter, and airplane adapter, along with the instruction manual.

3. DEVICE CONTROLS AND INDICATORS

The BF05 features intuitive controls and clear LED indicators for easy operation.

- **Audio Cable:** 3.5mm jack for audio input/output.
- **Pairing / Reset Button:** Initiates pairing mode or clears paired devices.
- **Mode Selection Button (TX / RX):** Switches between Transmitter and Receiver modes.
- **Power Button:** Powers the device on/off.
- **Device 1 Status Light:** Indicates connection status for the first paired device.
- **Device 2 Status Light:** Indicates connection status for the second paired device.
- **Battery Indicator:** Shows remaining battery life.
- **Type-C Charging Port:** For charging the device.
- **Previous Track, Volume Up Button:** Controls audio playback and volume.
- **Next Track, Volume Down Button:** Controls audio playback and volume.

- **Microphone:** For hands-free calling in RX mode.

Easier To Use, One-Button Operation



Image: A detailed view of the BF05's controls and indicators, showing the audio jack, pairing button, TX/RX switch, power button, LED indicators for device connection and battery, and the USB-C charging port.

4. SETUP AND PAIRING

4.1. Initial Setup

1. **Power On:** Press and hold the Power Button for 3 seconds.
2. **Mode Selection:** Slide the TX/RX switch to your desired mode (TX for transmitting, RX for receiving).
3. **First Use Pairing:** On first use, the device will automatically enter pairing mode (Indicator 1 will flash rapidly). If not, press the "PAIRING" button.

4.2. TX Mode Pairing (Connecting to Headphones/Earbuds)

In TX mode, the BF05 transmits audio from a non-Bluetooth source to your Bluetooth headphones or earbuds.

1. Ensure your headphones/earbuds are in pairing mode. For AirPods, place them in the charging case, open the

lid, and hold the button on the back until the light flashes white.

- The BF05 will automatically connect to the nearest available Bluetooth audio device. Indicator 1 on the BF05 will illuminate, and your headphone/earbud LED will turn green upon successful pairing.

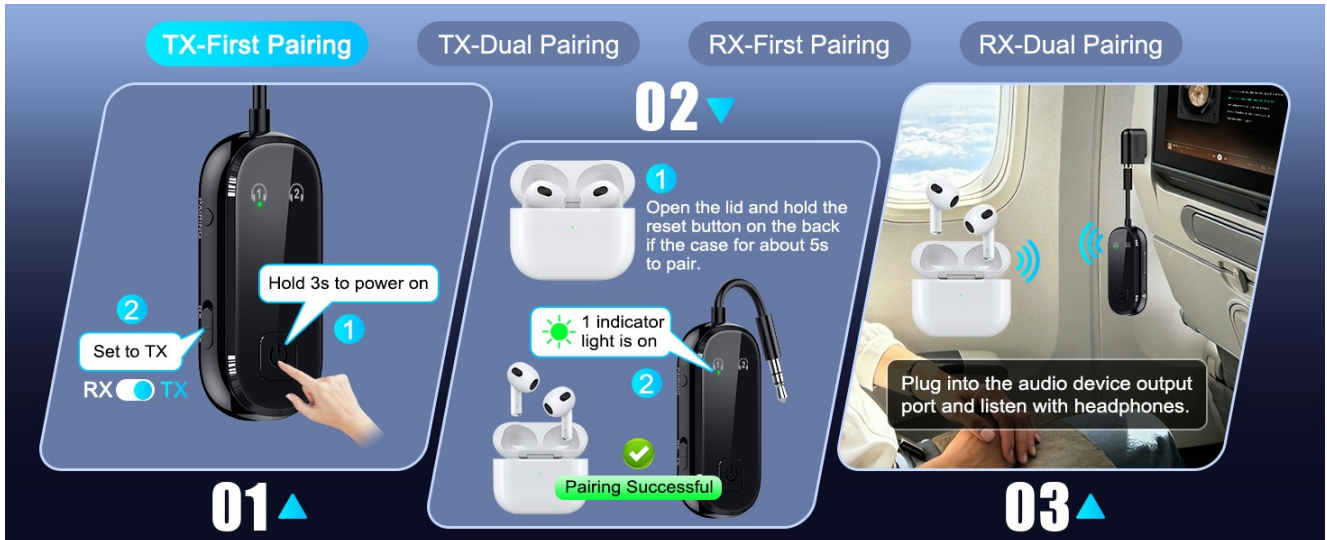

Image: Visual instructions for initial pairing in TX mode, showing how to put the BF05 into TX mode and pair it with AirPods.

TX Dual Pairing (Connecting Two Headphones)

To share audio with a second pair of headphones:

- After successfully pairing the first headset, put the second Bluetooth headset into pairing mode.
- Click the "PAIRING" button on the BF05. Indicator 2 will flash, and then both Indicator 1 and 2 will be solid when both devices are successfully paired.

Your browser does not support the video tag.

Video: Demonstrates how to pair two pairs of headphones to the LAICOMEIN BF05 in TX mode for shared listening.

4.3. RX Mode Pairing (Connecting to Smartphones/Tablets)

In RX mode, the BF05 receives audio from your Bluetooth-enabled device (smartphone, tablet) and plays it through a wired audio system (car stereo, home speakers).

- Set the BF05 to RX mode.
- On your smartphone/tablet, turn on Bluetooth and search for "BF05" in the device list. Select it to establish a connection.
- Indicator 1 on the BF05 will illuminate upon successful pairing.



Image: Visual guide for initial pairing in RX mode, showing how to connect a smartphone to the BF05 and then to a car stereo's AUX input.

RX Dual Pairing (Connecting Two Smartphones)

To connect a second smartphone to the BF05 in RX mode:

1. After successfully pairing the first smartphone, ensure the second smartphone's Bluetooth is on and in pairing mode.
2. Click the "PAIRING" button on the BF05. Indicator 2 will flash, and then both Indicator 1 and 2 will be solid when both devices are successfully paired.

Your browser does not support the video tag.

Video: Illustrates the process of pairing two smartphones to the LAICOMEIN BF05 in RX mode, allowing for effortless switching between audio sources.

5. OPERATING INSTRUCTIONS

5.1. TX Mode Usage Scenarios

Connect the BF05 to audio output ports of non-Bluetooth devices to stream audio wirelessly to your Bluetooth headphones/speakers.

- **TV:** Plug the BF05 into your TV's 3.5mm AUX audio out or RCA audio out ports. Ensure your TV's audio output is set to "Headset" or "External Speakers" if no sound is heard.

Your browser does not support the video tag.

Video: Shows how to connect the LAICOMEIN BF05 to a TV's audio output to transmit sound to Bluetooth headphones.

- **Airplane:** Use the included dual-prong adapter or the 3.5mm plug to connect to the in-flight entertainment system.

Your browser does not support the video tag.

Video: Demonstrates connecting the LAICOMEIN BF05 to an airplane's audio jack for wireless headphone use.

- **Gaming Consoles:** Connect to the 3.5mm audio output of your gaming console for wireless audio.

Flexible Use

Use the AUX port to enjoy wireless audio at the gym or anywhere else.

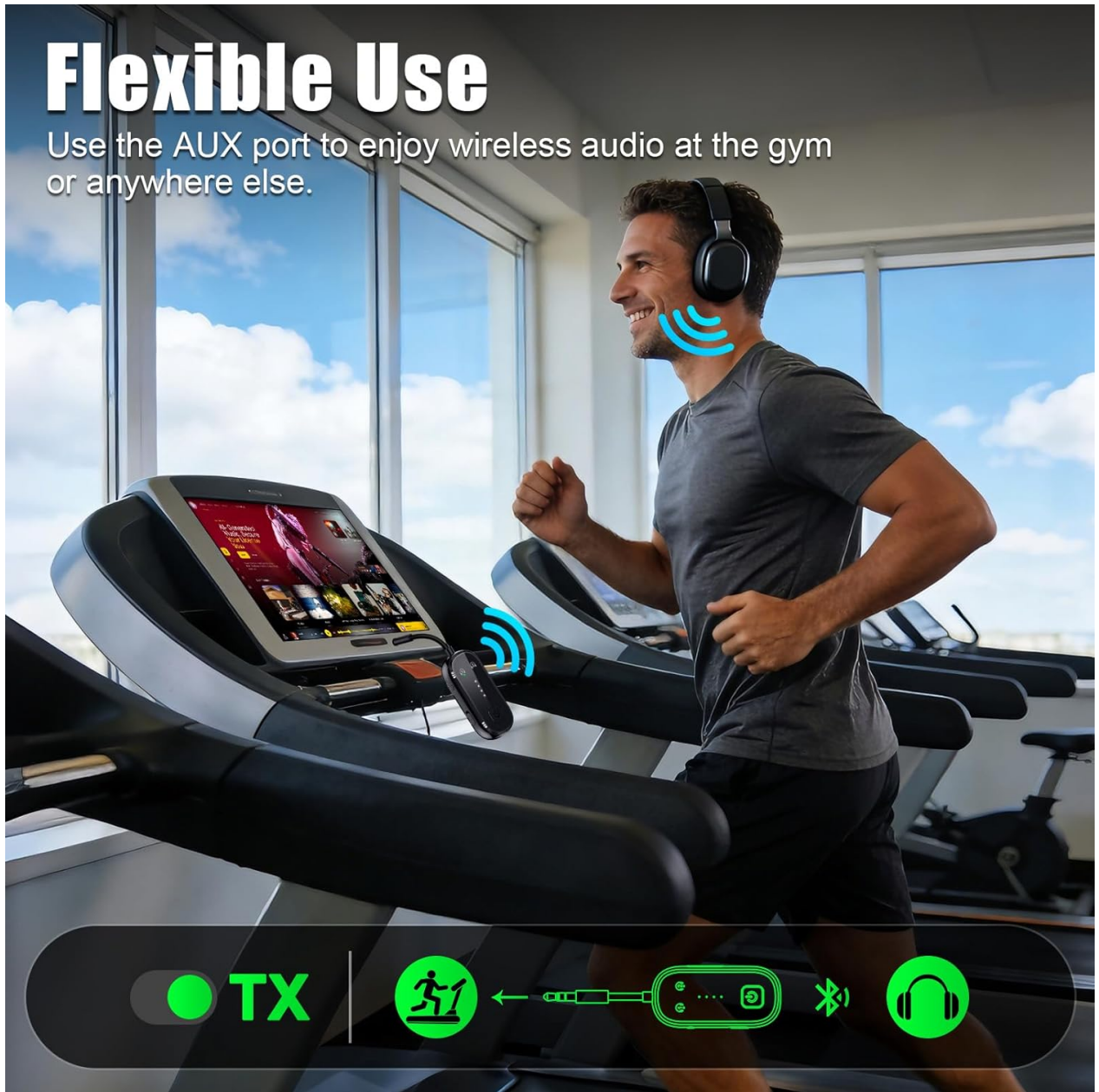

Image: The BF05 connected to an AUX port, enabling wireless audio for gym equipment or other devices.

5.2. RX Mode Usage Scenarios

Connect the BF05 to wired audio systems to receive Bluetooth audio from your smartphone or tablet.

- **Car Stereo:** Plug the BF05 into your car's AUX input. Pair your smartphone to the BF05 to stream music and make hands-free calls using the built-in microphone.

Bluetooth Receiver For Car

Safer Driving with Built-in Mic — Call Hands-Free.



Image: The BF05 used as a Bluetooth receiver in a car, enabling hands-free calls and music streaming through the car's audio system.

- **Home Stereo/Wired Speakers:** Connect the BF05 to your home stereo or wired speakers via the 3.5mm AUX or RCA input. Stream music wirelessly from your phone or tablet.

Stream Audio From Your Phone To Any Speaker Via Bluetooth.



Image: The BF05 connected to a speaker, streaming audio from a phone for outdoor entertainment.

6. MAINTENANCE

To ensure the longevity and optimal performance of your LAICOMEIN BF05, follow these simple maintenance guidelines:

- Keep the device clean and dry. Avoid exposure to extreme temperatures, moisture, or direct sunlight.
- Use the provided USB-C cable for charging. Do not use unauthorized chargers.
- Store the device in a cool, dry place when not in use.
- Avoid dropping or subjecting the device to strong impacts.

7. TROUBLESHOOTING

If you encounter issues with your LAICOMEIN BF05, please refer to the following solutions:

- **Connection Issues:** For automatic reconnections, disconnect your headphones/smartphones from other devices first before attempting to pair with the BF05.
- **No Sound from AirPods/Headphones:** If your AirPods or headphones have no sound after pairing, put them back in their case (if applicable) to reset the connection, then try pairing again.

- **Device Freeze/Unresponsive:** In case of a freeze, press and hold the Power Button for 10 seconds to force reset and shut down the device. Then, you can restart it by holding the Power Button for 3 seconds.

Your browser does not support the video tag.

Video: A troubleshooting guide for common issues with the LAICOMEIN BF05 Bluetooth transmitter, including connection problems and device resets.

8. SPECIFICATIONS

Feature	Detail
Brand	LAICOMEIN
Model	BF05
Connectivity Technology	Bluetooth, AUX, RCA
Bluetooth Version	6.0
Supported Standards	FCC, CE, RoHS, BQB, AptX Adaptive, AptX LL, AptX HD
Power Source	USB-C Battery Powered
Battery Life	20+ Hours
Battery Charge Time	1.5 - 2 Hours
Special Features	Built-In Microphone, Dual Link, Auto-Pairing, USB-C Fast Charging, LED Indicators, Dual Mode TX/RX, Hands-Free Calls, Low Latency, Noise Cancellation
Compatible Devices	TV, Car Stereo, Home Stereo, Airplane Entertainment Systems, AirPods, Bose, Sony, Bluetooth audio devices

9. WARRANTY AND SUPPORT

The LAICOMEIN BF05 comes with a **24-month warranty**. Register your product to receive an additional 12-month free return/replacement period.

For further assistance or support, please contact LAICOMEIN customer service through your purchase platform or visit the official LAICOMEIN store.