

## Trolinktek B17P

# Trolinktek Wireless CarPlay & Android Auto Adapter (Model B17P) User Manual

Model: B17P

[Product Overview](#)   [Setup Instructions](#)   [Operating](#)  
[Instructions](#)   [Maintenance](#)   [Troubleshooting](#)   [Specifications](#)   [Warranty & Support](#)

## PRODUCT OVERVIEW

---

The Trolinktek Wireless CarPlay & Android Auto Adapter (Model B17P) converts your car's wired CarPlay or Android Auto system into a wireless connection. This compact device offers quick auto-connection, dual-band Wi-Fi for stable performance, and broad compatibility with iOS and Android devices. It is designed for vehicles equipped with factory-wired CarPlay/Android Auto functions manufactured after 2015.

## SETUP INSTRUCTIONS

---

Follow these steps to set up your Wireless CarPlay & Android Auto Adapter:

- Connect the Adapter:** Plug the adapter into your car's USB port that supports wired CarPlay or Android Auto. Use the appropriate USB-A or USB-C connector provided. The adapter's indicator light will illuminate.
- Enable Wi-Fi and Bluetooth on your Phone:** Ensure both Wi-Fi and Bluetooth are turned on in your smartphone's settings. No Wi-Fi connection is required at this stage.
- Pair via Bluetooth:** On your phone, go to Bluetooth settings and search for "WirelessDongle-XXXX" (where XXXX is a unique identifier). Select it to pair. A pairing request may appear on your phone and car screen; confirm the pairing.
- Confirm CarPlay/Android Auto Connection:** After successful Bluetooth pairing, a prompt will appear on your phone to use CarPlay or Android Auto. Confirm this to initiate the wireless connection. Your car's infotainment system should then display the CarPlay or Android Auto interface.

# PLUG & PLAY, EASY PAIR

enjoy your free driving in seconds



## Plug:

Connect to USB/Type-C Ports with

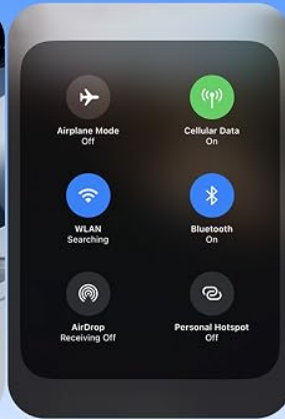

## WiFi ON:

Enable WiFi, No Connection Required

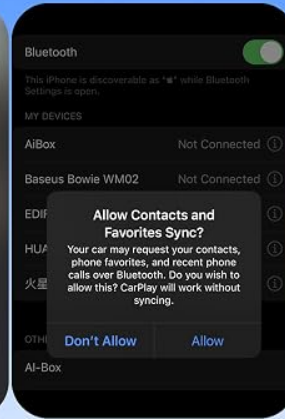

## BT Pairing:

Enable Bluetooth and Connect to WirelessDongle-xxxx

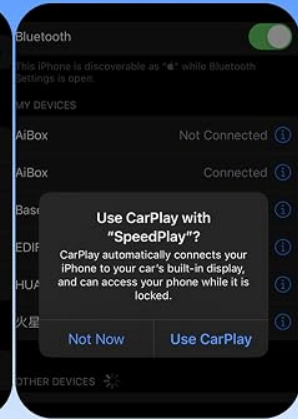

## GO:

Click "Pair" and enjoy

**Image:** Visual guide for connecting the adapter and pairing your smartphone for wireless CarPlay/Android Auto.



**Image:** Simplified three-step process for plug-and-play setup.

## Video Guide: Initial Setup

Your browser does not support the video tag.

**Video:** This video demonstrates the unboxing and setup process of the wireless adapter. It shows plugging the adapter into the car's USB port, pairing a smartphone via Bluetooth, and successfully launching CarPlay on the car's display. The video also illustrates navigation, phone calls, and music playback within the CarPlay interface.

## Compatibility Notes:

- The adapter is compatible with cars that have OEM wired CarPlay/Android Auto functions after 2015.

- It does **not** support video applications like YouTube or Netflix.
- It is **not** compatible with BMW, Tesla, or Motorcycles.
- For iOS, it supports iPhone 6 and above, running iOS 10 and above.
- For Android, it supports phones running Android 11 and above.

**Image:** Detailed compatibility information for iOS and Android devices, including links to check car compatibility for [Apple CarPlay](#) and [Android Auto](#).

## OPERATING INSTRUCTIONS

Once connected, the adapter provides a seamless wireless experience for CarPlay and Android Auto. Your car's original control methods remain fully functional.

- **Automatic Connection:** After the initial setup, the adapter will automatically connect to your paired smartphone when you start your car, typically within seconds.
- **Control Methods:** You can interact with CarPlay or Android Auto using your car's existing controls, including:
  - Steering wheel buttons
  - Touchscreen display
  - OEM control knobs
  - Voice commands (e.g., Siri or Google Assistant)
- **Audio Quality:** The adapter utilizes Bluetooth 5.4 for immersive, CD-quality audio for music and podcasts.
- **Navigation and Calls:** Enjoy stable navigation and clear calls without interruptions, thanks to dual-band 2.4GHz and 5.8GHz Wi-Fi.

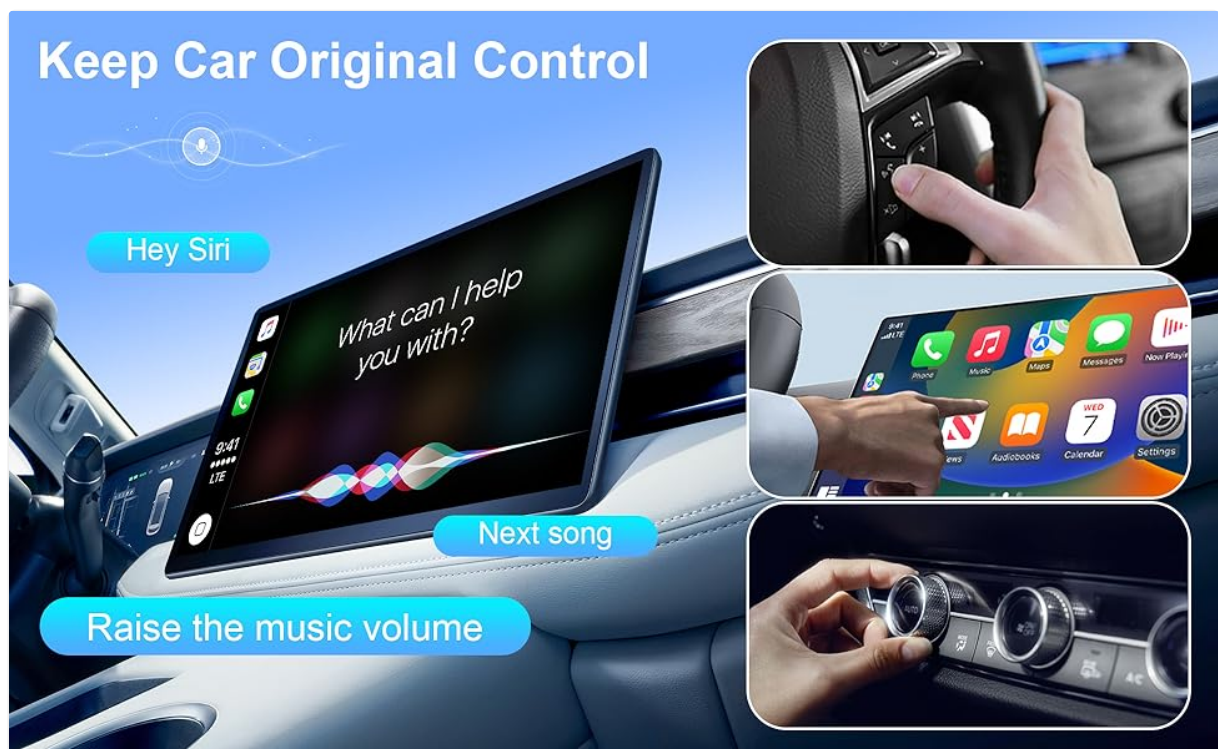

**Image:** Demonstrates the use of original car controls (steering wheel, touchscreen, rotary knob) and voice commands (Siri) with the wireless adapter.

## MAINTENANCE

---

To ensure the longevity and optimal performance of your adapter, follow these simple maintenance guidelines:

- **Cleaning:** Gently wipe the adapter with a soft, dry cloth to remove dust or smudges. Avoid using liquid cleaners or abrasive materials.
- **Storage:** When not in use for extended periods, store the adapter in a cool, dry place away from direct sunlight and extreme temperatures.
- **Handling:** Handle the adapter with care. Avoid dropping it or subjecting it to strong impacts, which could damage internal components.
- **Firmware Updates:** Periodically check for firmware updates to ensure the best performance and compatibility. Information on updates will be provided by the manufacturer.

## TROUBLESHOOTING

---

If you encounter issues with your Wireless CarPlay & Android Auto Adapter, refer to the following common solutions:

| Problem  | Possible Cause / Solution   |
|--|---|
| <b>Adapter not connecting automatically.</b>                       | <ul style="list-style-type: none"><li>• Ensure Bluetooth and Wi-Fi are enabled on your phone.</li><li>• Verify the adapter is securely plugged into the car's USB port.</li><li>• Restart your car's infotainment system and your phone.</li><li>• Re-pair the adapter via Bluetooth if the issue persists.</li></ul>   |
| <b>Poor audio quality or lag.</b>                                  | <ul style="list-style-type: none"><li>• Ensure your phone is close to the adapter and car's head unit for optimal signal.</li><li>• Check for any potential wireless interference from other devices.</li><li>• Restart the adapter by unplugging and re-plugging it.</li><li>• Ensure your phone's operating system and the adapter's firmware are up to date.</li></ul> |
| <b>Steering wheel controls or OEM knobs not working correctly.</b> | <ul style="list-style-type: none"><li>• This can sometimes occur due to specific car models or software versions.</li><li>• Try restarting the car and the adapter.</li><li>• Check for available firmware updates for the adapter, as these often include compatibility fixes.</li><li>• If the problem persists, contact customer support for assistance.</li></ul>     |

| Problem                             | Possible Cause / Solution   |
|-------------------------------------|---|
| CarPlay/Android Auto not launching. | <ul style="list-style-type: none"> <li>• Confirm your car has factory-wired CarPlay/Android Auto and was manufactured after 2015.</li> <li>• Ensure your phone meets the minimum OS requirements (iOS 10+ or Android 11+).</li> <li>• Check if your phone's CarPlay/Android Auto settings are correctly configured.</li> <li>• Verify that the adapter is properly paired via Bluetooth.</li> </ul> |

## SPECIFICATIONS

| Feature                 | Detail  |
|-------------------------|---|
| Model Number            | B17P  |
| Product Dimensions      | 0.98 x 0.4 x 2 inches   |
| Item Weight             | 2 ounces  |
| Connectivity Technology | Bluetooth 5.4, Dual-Band Wi-Fi (2.4GHz/5.8GHz), USB   |
| Power Source            | USB   |
| Material                | Acrylonitrile Butadiene Styrene (ABS)   |
| Special Features        | Auto-Reconnect, Easy Use, Fast Pairing, Smooth Performance, Low Latency, Lifetime Firmware Upgrades |

2.4Ghz/5.8Ghz  
**WiFi**



Built to last  
**10000+**  
Plug Test



**Easy & Fast Connect**  
15s



**Small Precision Design**



**Stable**  
Bring Greater Security



**Image:** Visual representation of the adapter's compact design and core features.

## WARRANTY & SUPPORT

---

Trolinktek is committed to providing reliable products and excellent customer service.

- **Customer Support:** Our dedicated support team is available 24/7 to assist you with any questions or concerns regarding your Wireless CarPlay & Android Auto Adapter. Please refer to the product packaging or manufacturer's website for contact information.
- **Firmware Updates:** The adapter is designed for lifetime firmware upgrades to ensure continued compatibility and performance enhancements.