

Gyroor G13

Gyroor G13 Self-Balancing Scooter with K1 Adjustable Seat Attachment User Manual

Model: G13 Scooter, K1 Seat Attachment

[Introduction](#) [Safety Information](#) [Package Contents](#) [Setup](#) [Operating](#) [Maintenance](#)
[Troubleshooting](#) [Specifications](#) [Warranty & Support](#)

1. INTRODUCTION

Welcome to the user manual for your Gyroor G13 Self-Balancing Scooter and K1 Adjustable Seat Attachment. This manual provides essential information for the safe assembly, operation, maintenance, and troubleshooting of your product. Please read it thoroughly before first use to ensure optimal performance and safety.



Image 1.1: Gyroor G13 Self-Balancing Scooter with K1 Adjustable Seat Attachment.

2. SAFETY INFORMATION

Your safety is paramount. The Gyroor G13 Self-Balancing Scooter is UL2272 certified, ensuring it meets high electrical safety standards. Always adhere to the following guidelines:

- **Wear Protective Gear:** Always wear a helmet, knee pads, and elbow pads when operating the scooter or seat attachment.
- **Age and Weight Limits:** The scooter is designed for youth and adults. Refer to the specifications section for precise weight limits.
- **Supervision:** Children should always be supervised by an adult while riding.
- **Environmental Conditions:** Avoid riding in wet conditions, on steep slopes exceeding 15 degrees, or on uneven, slippery surfaces.
- **Traffic Laws:** Obey all local traffic laws and regulations. Ride responsibly and be aware of your surroundings.
- **Pre-Ride Check:** Before each ride, ensure all components are securely fastened, the battery is charged, and the tires are in good condition.



Image 2.1: The Gyroor G13 is UL2272 certified for electrical safety.

3. PACKAGE CONTENTS

Upon unpacking, verify that all items listed below are present and undamaged:

- Gyroor G13 Self-Balancing Scooter
- K1 Adjustable Seat Attachment components (seat, frame, handles, front wheel)
- Charging Adapter
- User Manual
- Assembly Tools

4. SETUP

4.1 Initial Charging

Before first use, fully charge the Gyroor G13 Scooter. Connect the charging adapter to the scooter's charging port and then to a power outlet. The indicator light on the charger will change from red to green when fully charged.

4.2 Assembling the K1 Seat Attachment

The K1 Seat Attachment transforms your scooter into a go-kart. Follow these steps for assembly:

1. Assemble the main frame of the seat attachment using the provided tools.
2. Attach the footrest with the front wheel to the main frame. Slide it into position and tighten securely.
3. Secure the assembled seat attachment to the Gyroor G13 Scooter using the Velcro straps. Ensure it is firmly attached and does not wobble.
4. Adjust the length of the seat attachment frame to comfortably fit the rider's leg length. Loosen the adjustment knob, select the appropriate hole, and re-tighten.



Image 4.1: Key components of the K1 Adjustable Seat Attachment.



Image 4.2: Operating instructions for the K1 Seat Attachment.

4.3 Video Guide: Gyroor G13 Hoverboard & Seat Attachment

Your browser does not support the video tag.

Video 4.1: Official Gyroor video demonstrating the G13 Hoverboard and K1 Seat Attachment, including assembly and usage.

5. OPERATING INSTRUCTIONS

5.1 Riding the G13 Scooter (Standing Mode)

To ride the G13 Scooter in standing mode, gently step onto the footpads. The self-balancing technology will assist in maintaining stability. Lean slightly forward to move forward, backward to slow down or reverse, and left or right to steer.

5.2 Riding with K1 Seat Attachment (Go-Kart Mode)

Once the K1 Seat Attachment is securely installed, sit comfortably in the seat. Use the hand levers to control movement:

- **Forward:** Push both hand levers forward.
- **Backward:** Pull both hand levers backward.
- **Turn Left:** Push the right lever forward and pull the left lever backward.
- **Turn Right:** Push the left lever forward and pull the right lever backward.



2-IN-1

2-IN-1 TWICE THE FUN

Stand or sit—switch modes in seconds

Image 5.1: The Gyroor G13 offers 2-in-1 riding options: standing scooter or go-kart with the K1 attachment.

5.3 LED Lights and Bluetooth Speaker

The G13 Scooter features colorful LED lights on the wheels and front headlights for enhanced visibility and style. It also includes a high-quality Bluetooth speaker. To connect your device, turn on the scooter, activate Bluetooth on your smartphone or other device, and select "Gyroor" from the available devices. You can then play your favorite music through the scooter's speaker.

LED LIGHTS & BLUETOOTH MUSIC



Image 5.2: Enjoy illuminated rides with the integrated LED lights and Bluetooth speaker.

5.4 All-Terrain Capability

The 6.5-inch rugged off-road tires provide excellent traction and stability, allowing for smooth rides on various surfaces including grass, gravel, dirt, and paved roads. The scooter can handle slopes up to 15 degrees.

ALL TERRAIN OFF ROAD BALANCING SCOOTER



Image 5.3: The G13 is designed for all-terrain use.

6. MAINTENANCE

Regular maintenance ensures the longevity and safe operation of your Gyroor Scooter and K1 Seat Attachment.

- **Cleaning:** Wipe down the scooter and attachment with a damp cloth after each use. Avoid using harsh chemicals or abrasive cleaners.
- **Battery Care:** Charge the battery fully after each use. If storing for an extended period, charge it to 50-70% every 3 months to prevent deep discharge.

- **Tire Inspection:** Regularly check the tires for wear, punctures, or damage. Ensure they are free from debris.
- **Fastener Check:** Periodically inspect all screws, bolts, and straps on both the scooter and the seat attachment to ensure they are tight and secure.
- **Storage:** Store the scooter in a cool, dry place away from direct sunlight and extreme temperatures.

EASY TO OPERATE

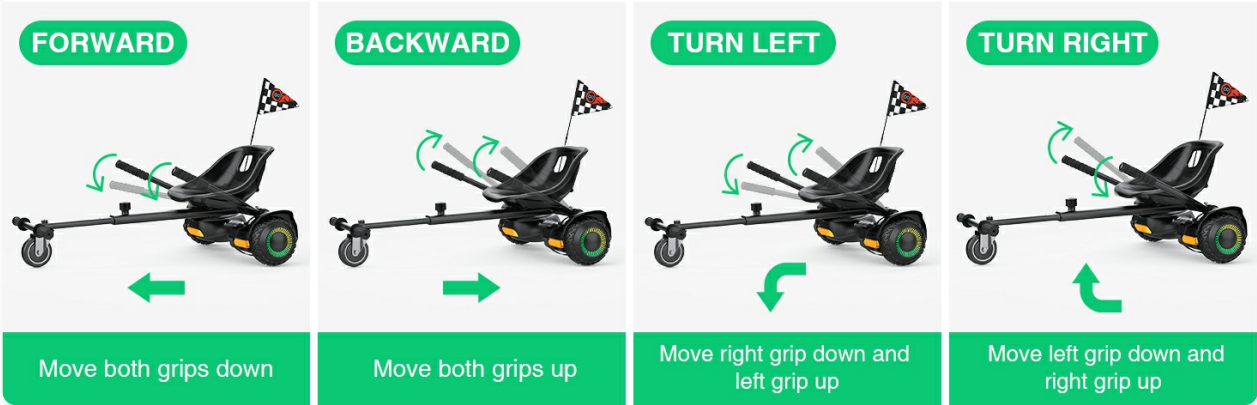

Image 6.1: The G13 features a 36V 2Ah battery for reliable performance.

7. TROUBLESHOOTING

If you encounter issues with your Gyroor Scooter, refer to the following common problems and solutions:

- **Scooter Not Turning On:** Ensure the battery is fully charged. Check the power button for proper engagement.
- **Scooter Not Balancing:** If the scooter is not self-balancing, try recalibrating it according to the instructions in the full manual (if provided separately). Ensure you are on a flat, level surface.
- **Reduced Performance/Speed:** This may indicate a low battery charge. Fully charge the scooter. If the issue persists, contact customer support.
- **Bluetooth Connection Issues:** Ensure the scooter is powered on and your device's Bluetooth is enabled. Try restarting both devices.
- **Unusual Noises:** Stop using the scooter immediately and inspect for loose parts or damage. Contact customer support if the source of the noise cannot be identified or resolved.

8. SPECIFICATIONS

Feature	Detail
Brand	Gyroor
Model	G13 (Scooter), K1 (Seat Attachment)
Motor Power	Dual 250W Motors (500W total)
Maximum Speed	7.75 MPH
Tire Size	6.5 inches, All-Terrain

Feature	Detail
Climbing Angle	Up to 15 degrees
Battery	36V 2Ah (72WH)
Safety Certification	UL2272 Certified
Special Features	Built-In Bluetooth Speaker, LED Lights
K1 Seat Adjustment Range	28.3–33.5 inches (frame length)
Item Weight	14 Pounds (Scooter only)
Material	Metal, Plastic, Rubber

RIDE SAFELY WITH G13



Image 8.1: Key specifications of the Gyroor G13 Scooter.





Image 8.2: The powerful 500W motor and all-terrain tires ensure a robust riding experience.



9. WARRANTY & SUPPORT

The Gyroor G13 Self-Balancing Scooter and K1 Adjustable Seat Attachment come with a **1-year warranty** from the date of purchase. This warranty covers manufacturing defects under normal use conditions. For warranty claims, technical support, or any questions regarding your product, please contact Gyroor Customer Service through their official website or the retailer where the product was purchased. Please have your purchase receipt and product model number ready when contacting support.

© 2025 Gyroor. All rights reserved.

Related Documents - G13

	<p>GYROOR G13 Hoverboard User Manual - Safety, Operation, and Specifications</p> <p>Comprehensive user manual for the GYROOR G13 Hoverboard, featuring a Minions theme for kids. Covers safety instructions, operating procedures, maintenance, specifications, and troubleshooting.</p>
	<p>Gyroor G13 Hoverboard User Manual - Safety, Operation, and Maintenance Guide</p> <p>Comprehensive user manual for the Gyroor G13 Hoverboard. Learn about safety guidelines, how to ride, charging, maintenance, specifications, calibration, warranty, and troubleshooting.</p>
	<p>Gyroor G13 Hoverboard User Manual: Safety, Operation, and Maintenance Guide</p> <p>Comprehensive user manual for the Gyroor G13 hoverboard. This guide covers essential safety instructions, how to learn to ride, maintenance procedures, detailed specifications, calibration steps, and answers to frequently asked questions.</p>

	<p>Gyroor Warrior G2 Hoverboard User Manual - Safety, Operation, and Maintenance</p> <p>Comprehensive user manual for the Gyroor Warrior G2 hoverboard, covering safety guidelines, riding instructions, maintenance, specifications, and troubleshooting. Learn how to operate your Gyroor G2 safely and effectively.</p>
	<p>Gyroor G2 Warrior Hoverboard User Manual: Safety, Operation, and Maintenance</p> <p>Comprehensive user manual for the Gyroor G2 Warrior hoverboard, covering essential safety guidelines, riding instructions, maintenance tips, technical specifications, and troubleshooting. Learn how to operate your hoverboard safely and effectively.</p>
	<p>Gyroor G11 Hoverboard User Manual - Safety, Operation, and Specifications</p> <p>Comprehensive user manual for the Gyroor G11 Hoverboard. Learn about riding safety, packing list, charging, first ride, learning to ride, warnings, maintenance, specifications, calibration, app usage, warranty, and FAQs.</p>