

ACEFAST 6-in-1 80W Foldable GaN Wireless Charging Station

ACEFAST 6-in-1 80W Foldable GaN Wireless Charging Station User Manual

Model: B0G4VW9CHR

[Introduction](#) | [Safety Information](#) | [Package Contents](#) | [Product Overview](#) | [Setup](#) | [Operating Instructions](#) | [Maintenance](#) | [Troubleshooting](#) | [Specifications](#) | [Warranty](#) | [Support](#)

1. INTRODUCTION

This manual provides detailed instructions for the safe and efficient use of your ACEFAST 6-in-1 80W Foldable GaN Wireless Charging Station. This device is designed to provide a versatile charging solution for multiple electronic devices, including smartphones, smartwatches, and earbuds, using both wireless and wired connections.

2. SAFETY INFORMATION

Please read all safety warnings and instructions before using this product to prevent injury or damage. Keep this manual for future reference.

- Do not expose the device to liquids, moisture, or extreme temperatures.
- Do not disassemble, modify, or attempt to repair the device.
- Use only the provided power adapter or a certified equivalent.
- Avoid placing metal objects or magnetic cards on the wireless charging pads.
- Ensure proper ventilation during use to prevent overheating.
- Keep out of reach of children.

The device incorporates multiple protection features, including overvoltage, overcurrent, overpower, short circuit, overtemperature, and anti-interference protection, to ensure safe charging.

3. PACKAGE CONTENTS

Verify that all items are present in your package:

- ACEFAST 6-in-1 80W Foldable GaN Wireless Charging Station
- Power Cable
- User Manual (this document)

4. PRODUCT OVERVIEW

The ACEFAST 6-in-1 80W Foldable GaN Wireless Charging Station is a compact and versatile charging solution. It features multiple charging interfaces and a foldable design for portability and desktop organization.

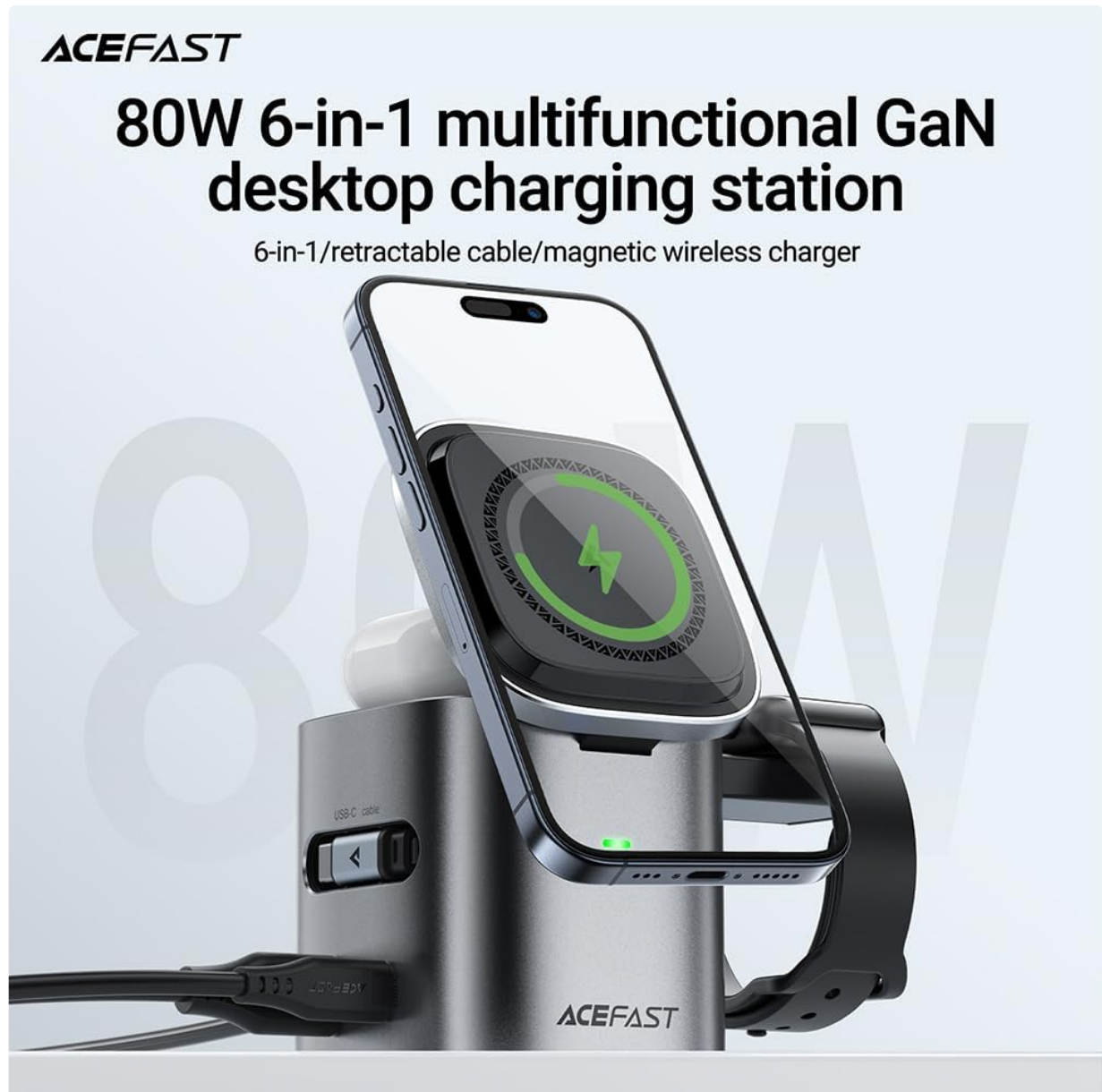

Figure 1: The ACEFAST 6-in-1 80W Foldable GaN Wireless Charging Station, shown with a smartphone, earbuds, and smartwatch actively charging.

Key Features:

- **6-in-1 Charging:** Simultaneously charge up to six devices.
- **80W GaN Technology:** Efficient and fast charging with Gallium Nitride components.
- **Foldable Design:** Compact for travel and adjustable for desktop use.

- **Magnetic Wireless Charging:** 15W max for smartphones (e.g., iPhone 12 series and newer).
- **Retractable USB-C Cable:** Built-in PD60W fast-charging cable for laptops and other USB-C devices.
- **Additional Ports:** USB-C PD3.0 (65W Max) and USB-A (18W Max) ports.
- **Watch Charging:** Dedicated 2.5W wireless charging stand for smartwatches.
- **Earbud Charging:** 5W wireless charging pad for TWS earbuds.

6-in-1 desktop wireless charger



Figure 2: Overview of the charging station's interfaces, including wireless pads, retractable USB-C cable, USB-C port, and USB-A port.

5. SETUP

Follow these steps to set up your charging station:

1. **Connect Power:** Plug the provided power cable into the AC input port on the back of the charging station, then connect it to a wall outlet. The charging indicator light will illuminate.
2. **Positioning:** Place the charging station on a stable, flat surface. Ensure adequate space around the device for ventilation.
3. **Adjust Phone Stand:** The magnetic wireless charging pad for phones can be adjusted to a 65° angle for optimal viewing and charging. Gently push or pull to set the desired angle.
4. **Watch Stand:** The smartwatch charging stand can be pulled out for use and pushed back in for

storage.

Your browser does not support the video tag.

Video 1: This video demonstrates the initial setup and various features of the ACEFAST 6-in-1 80W Foldable Wireless Charging Station, including connecting power and positioning devices for charging.

6. OPERATING INSTRUCTIONS

6.1 Wireless Phone Charging

The top magnetic pad is designed for wireless charging of compatible smartphones (e.g., iPhone 12 series and newer). It supports up to 15W wireless charging.

1. Ensure the phone charging pad is in the upright position (adjustable up to 65°).
2. Place your compatible smartphone directly onto the magnetic charging pad. The phone will snap into place magnetically.
3. The charging indicator light on the station will confirm charging status.

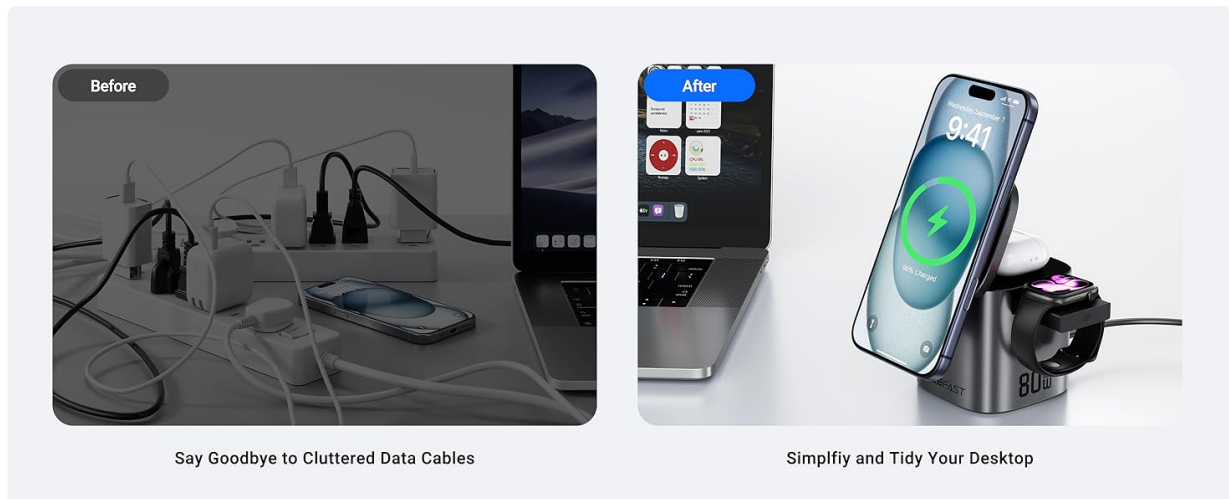

Figure 3: The magnetic charging pad securely holds and charges compatible smartphones. For optimal magnetic connection, use phones without thick cases or with MagSafe-compatible cases.

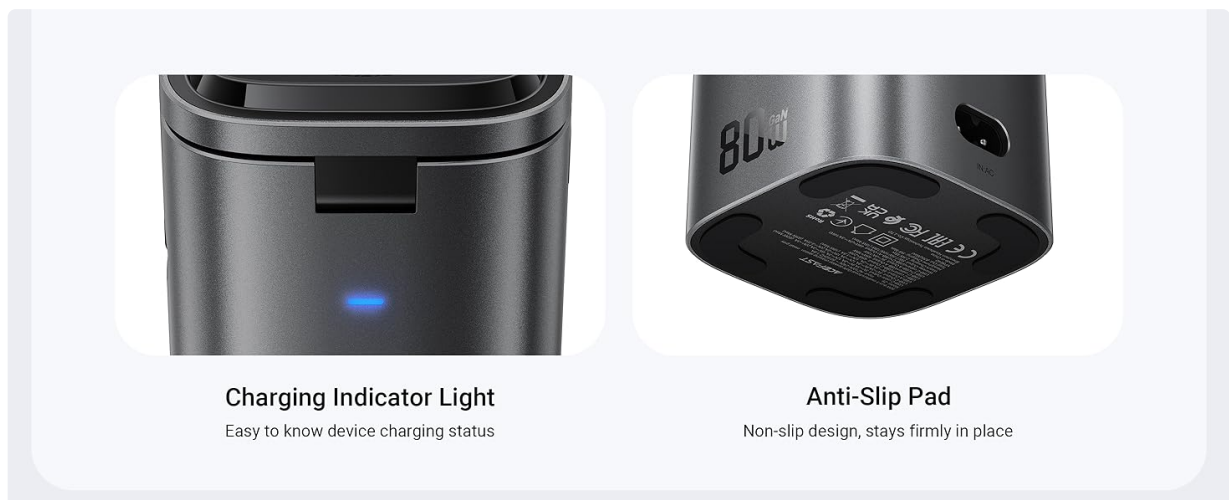

Figure 4: The phone charging pad can be adjusted to a 65-degree angle for comfortable viewing while charging.

6.2 Wireless Smartwatch Charging

The retractable stand on the side is for wireless charging of compatible smartwatches (e.g., Apple Watch series).

1. Gently pull out the smartwatch charging stand from the side of the station.
2. Place your smartwatch onto the charging pad. Ensure it is properly aligned for charging.
3. After charging, push the stand back into the station for compact storage.

6.3 Wireless Earbud Charging

The recessed area on the top of the station is for wireless charging of compatible TWS earbuds (e.g., AirPods 2/3/4/Pro 2/Pro 3).

1. Place your wireless charging compatible earbud case into the designated recessed area.
2. Ensure the case is centered on the charging pad for optimal connection.

6.4 Wired Charging (USB-C and USB-A Ports)

The station includes a USB-C PD3.0 port and a USB-A port for wired charging of various devices.

- **USB-C PD3.0 Port:** Connect your USB-C compatible device (e.g., laptop, tablet, smartphone) to this port using a suitable USB-C cable. This port supports up to 65W output.
- **USB-A Port:** Connect your USB-A compatible device to this port using a suitable USB-A cable. This port supports up to 18W output.

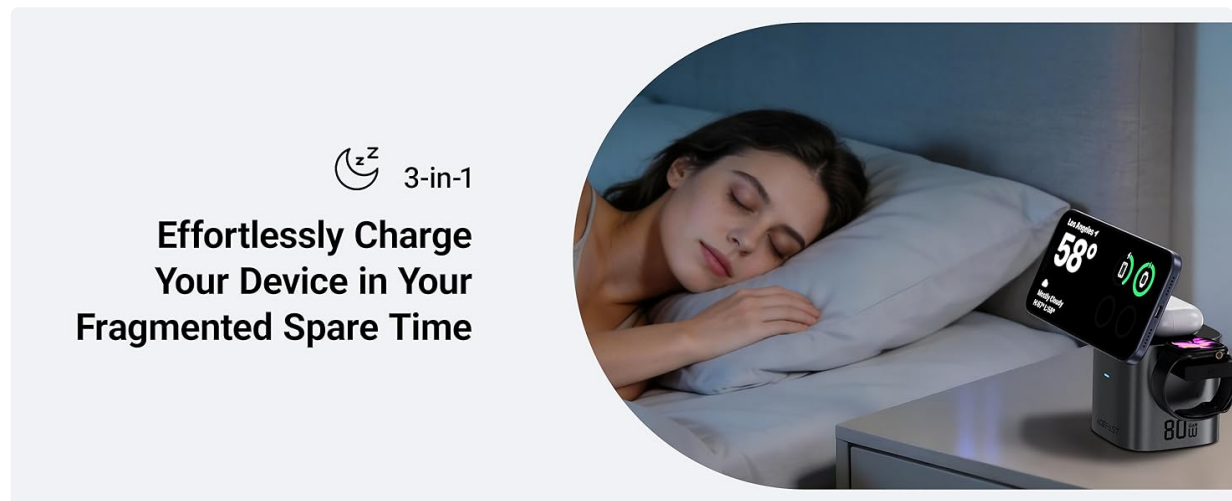

Figure 5: The USB-C port provides up to 65W power delivery, suitable for fast charging laptops and other high-power devices.

6.5 Retractable USB-C Cable

The built-in retractable USB-C cable offers convenient wired charging without extra cables.

1. **To Extend:** Gently pull the USB-C cable from its housing to the desired length. It has multiple length settings (12cm, 19cm, 33cm, 47cm, 55cm, 70cm).
2. **To Retract:** Gently pull the cable slightly further, then release it to allow it to retract automatically into the housing.
3. Connect the USB-C end to your compatible device for charging. This cable supports up to 60W PD fast charging.



Figure 6: The retractable USB-C cable offers adjustable lengths for flexible charging setups.

7. MAINTENANCE

Proper care ensures the longevity of your charging station:

- **Cleaning:** Disconnect the power before cleaning. Use a soft, dry cloth to wipe the surface. Do not use abrasive cleaners or solvents.
- **Storage:** When not in use, store the charging station in a cool, dry place. Retract all cables and fold the phone stand for compact storage.
- **Cable Care:** Avoid excessive pulling or bending of the retractable cable to prevent damage.

8. TROUBLESHOOTING

If you encounter issues, refer to the following common problems and solutions:

Problem	Possible Cause	Solution
Device not charging wirelessly.	Device misalignment, non-compatible device, thick phone case, foreign objects.	Ensure device is centered on the pad. Verify device supports wireless charging. Remove thick cases or metal objects.
Slow charging.	Using a non-fast charging cable/adapter, multiple devices charging simultaneously, device not supporting fast charge.	Ensure all connections are secure. Use appropriate cables. Reduce the number of devices charging if total power exceeds capacity.
Charging station indicator light is off.	No power connection.	Check if the power cable is securely plugged into the station and the wall outlet. Try a different outlet.
Retractable cable not retracting smoothly.	Cable twisted or mechanism obstructed.	Gently pull the cable out completely, then release it to allow it to retract. Do not force it.

9. SPECIFICATIONS

Feature	Detail
Brand	ACEFAST
Model	6-in-1 80W Foldable GaN Wireless Charging Station (B0G4VW9CHR)
Color	Metal Gray
Input Voltage	110 Volts
Total USB Ports	3 (1x USB-C PD3.0, 1x USB-A, 1x Retractable USB-C)
Wireless Output (Phone)	5W/7.5W/10W/15W (Max 15W for smartphone)
Wireless Output (Watch)	2.5W Max
Wireless Output (Earbuds)	5W Max
USB-C PD3.0 Port Output	Up to 65W
USB-A Port Output	Up to 18W
Retractable USB-C Cable Output	Up to 60W
Compatible Devices	AirPods, iPhone (12 series and newer), Apple Watch
Material	PC fireproof material

10. WARRANTY INFORMATION

This ACEFAST product comes with a **2-Year Manufacturer Warranty**. This warranty covers defects in materials and workmanship under normal use. It does not cover damage caused by misuse, accidents, unauthorized modifications, or external causes.

Please retain your proof of purchase for warranty claims.

11. SUPPORT

For technical support, warranty claims, or further assistance, please contact ACEFAST customer service through the retailer where you purchased the product or visit the official ACEFAST website.

Website: www.acefast.com