

Manuals+

[Q & A](#) | [Deep Search](#) | [Upload](#)

Manuals.plus /

› [Merach](#) /

› MERACH Vibration Plate Armrest Instruction Manual for Models V28, CV30, V33

Merach Vibration Plate Armrest

MERACH Vibration Plate Armrest Instruction Manual

Model: Vibration Plate Armrest

1. PRODUCT OVERVIEW

The MERACH Vibration Plate Armrest is designed to provide additional stability and support for users of MERACH vibration plates, including models V28, CV30, and V33, as well as other compatible vibration plates ranging from 12.7"D to 22.8"D. This accessory enhances safety, particularly for seniors and beginners, by offering a secure handhold during exercise.

Key features include:

- **Wide Compatibility:** Designed for MERACH V28, CV30, V33, and other vibration plates within a 12.7"D-22.8"D range.
- **Adjustable Height:** Easily adjusts from 27.2 inches to 38.6 inches to suit various user heights and exercise postures.
- **Enhanced Stability:** Features a robust alloy steel construction and a non-slip base with 5 suction cups for firm attachment.
- **Comfortable Grip:** Soft rubber handles ensure a secure and comfortable grip during use.

Vibration Plates *with Handrails*

Suitable for seniors and beginners



Stable



Unstable



Image 1.1: The MERACH Vibration Plate Armrest provides stability for users during vibration plate exercises. The image shows a person standing on a vibration plate, holding the armrest, demonstrating stable usage.

2. SAFETY INFORMATION

Please read and understand all safety instructions before assembling and using the MERACH Vibration Plate Armrest. Failure to follow these instructions may result in injury or damage to the product.

- Always ensure the armrest is securely attached to your vibration plate and all fasteners are tightened before use.
- Verify the stability of the armrest and vibration plate on a flat, stable surface.
- Do not exceed the maximum recommended user weight for your vibration plate.
- Consult a physician before starting any new exercise program.
- Keep children and pets away from the vibration plate and armrest during operation.
- Regularly inspect the armrest for any signs of wear, damage, or loose components. Do not use if damaged.
- This product is an armrest only and does not include the vibration plate.

3. PACKAGE CONTENTS

Carefully unpack the box and ensure all the following components are present. If any parts are missing or damaged, please contact customer support.

- Support Handle Rail (1)
- Vertical Support Rail (1)
- Vertical Support Rail Base (1)
- Left Suction Cup Base (1)
- Right Suction Cup Base (1)
- Adjustable Height Knob for Support Rail (1)
- Padding Blocks (32x15mm) (4)
- Padding Blocks (40x5mm) (1)
- Screws (various sizes)
- Suction Cup Screws (various sizes)
- Instruction Manual (this document)

Package Including

1. Support Handle Rail
2. Vertical Support Rail
3. Vertical Support Rail Base
4. Left Suction Cup Base
5. Right Suction Cup Base
6. Adjustable Height Knob for Support Rail
7. Padding Blocks (32x15mm)*4
8. Padding Blocks (40x5mm)*1
9. Screws
10. Suction Cup Screw

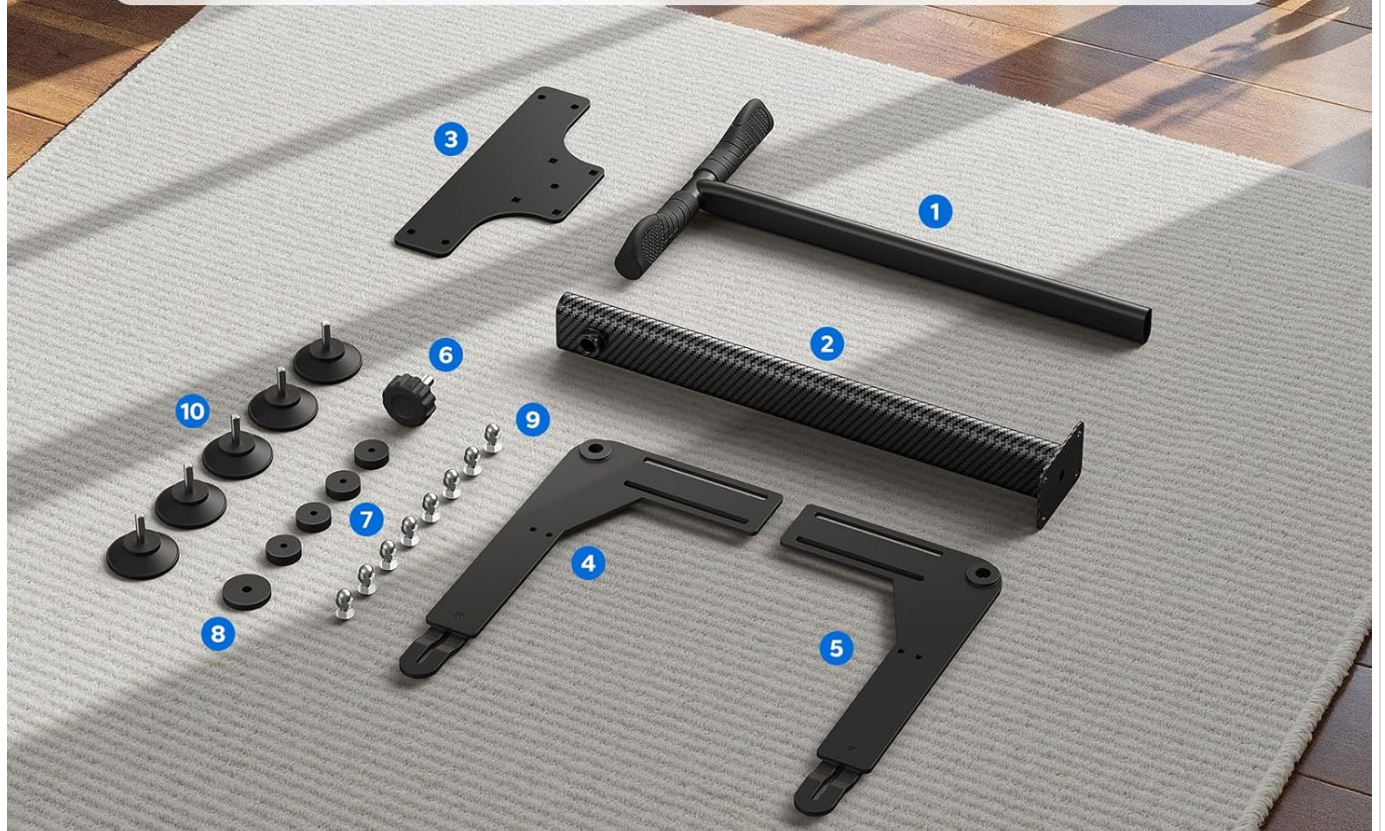

Image 3.1: All components included in the MERACH Vibration Plate Armrest package. The image displays each part laid out, numbered for identification, such as the support handle rail, vertical support rail, various bases, adjustment knob, padding blocks, and screws.

4. SETUP AND ASSEMBLY

Assembly requires careful attention to detail. Refer to the included diagrams and ensure all parts are correctly oriented and securely fastened. Some users have reported challenges with screw threading; ensure screws are aligned properly before tightening.

1. **Prepare the Vibration Plate:** If your vibration plate has existing suction pads, remove them as instructed by your vibration plate's manual.
2. **Attach Suction Cup Bases:** Secure the Left and Right Suction Cup Bases to the underside of your vibration plate using the provided screws. Ensure they are positioned correctly to accommodate the armrest.
3. **Install Vertical Support Rail Base:** Attach the Vertical Support Rail Base to the top surface of your vibration plate, aligning it with the suction cup bases. Use the appropriate screws.
4. **Connect Vertical Support Rail:** Insert the Vertical Support Rail into the Vertical Support Rail Base.
5. **Attach Support Handle Rail:** Place the Support Handle Rail onto the top of the Vertical Support Rail. Secure it

using the Adjustable Height Knob.

6. **Adjust Height:** Loosen the Adjustable Height Knob, slide the Support Handle Rail to your desired height (between 27.2 inches and 38.6 inches), and then firmly tighten the knob.
7. **Final Check:** Before first use, gently shake the assembled armrest to ensure all connections are secure and the suction cups provide a strong grip on the floor.



5 Suction Cups

Stronger suction, stable and no shaking

Alloy Steel Material

Sturdy and durable



Rubber Armrests

Soft and comfortable

Image 4.1: The base of the armrest features 5 suction cups for enhanced stability and a durable alloy steel construction. This image highlights the robust design of the armrest's foundation.

Multi-hole Design

Adapt to different vibration plates

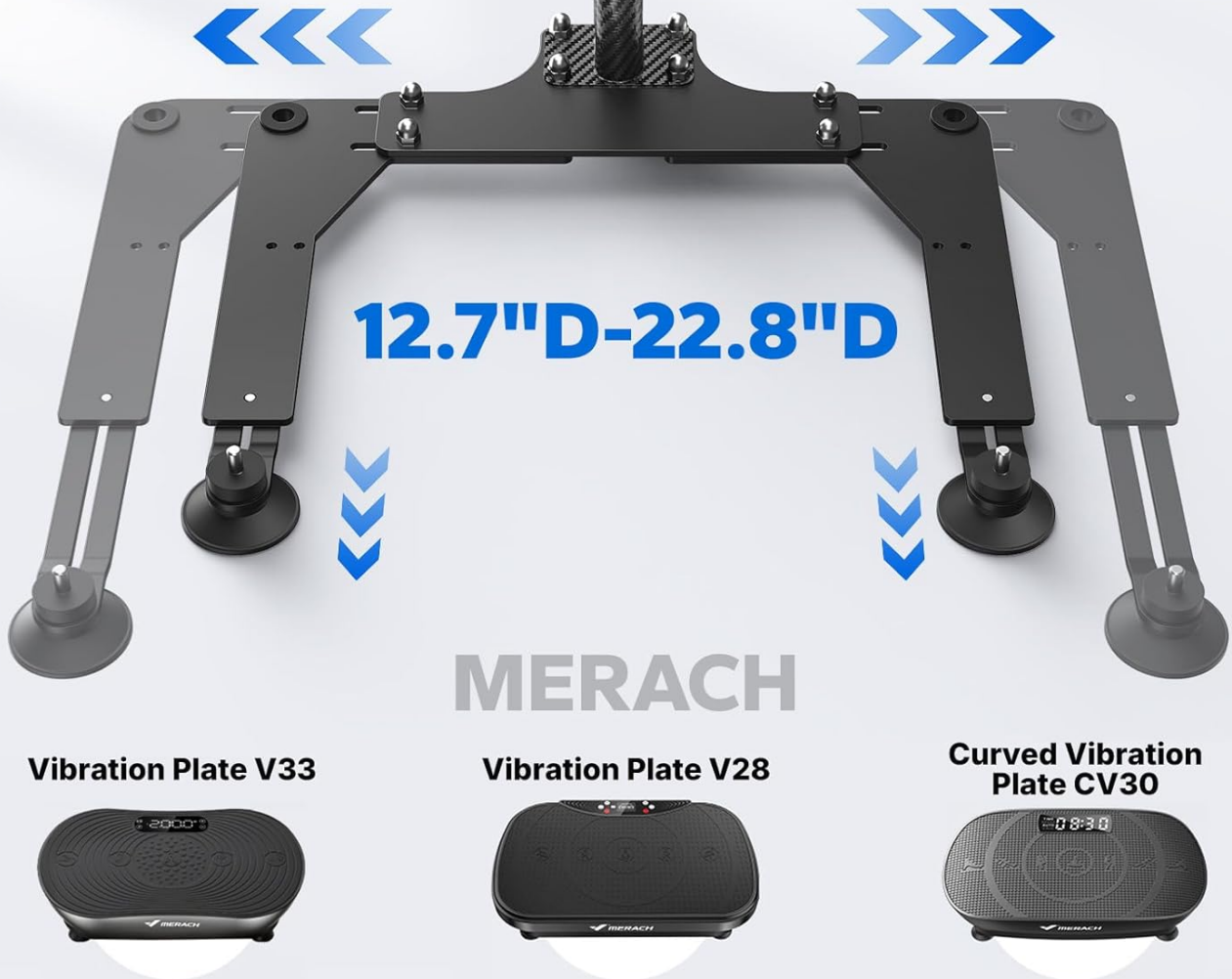

Image 4.2: The multi-hole design of the armrest base allows for adaptation to various vibration plate sizes, specifically compatible with MERACH V33, V28, and CV30 models, and other plates between 12.7"D and 22.8"D.

5. OPERATING INSTRUCTIONS

The MERACH Vibration Plate Armrest is designed for straightforward use to enhance your exercise experience.

- Positioning:** Place your vibration plate with the attached armrest on a flat, stable, and non-slip surface. Ensure the suction cups are firmly engaged with the floor.
- Height Adjustment:** Before starting your exercise, adjust the armrest height to a comfortable level. Loosen the Adjustable Height Knob, slide the handle to your preferred height (e.g., waist level for standing, lower for squatting), and then securely tighten the knob.
- Using the Armrest:** Step onto your vibration plate. Hold the rubber handles firmly with both hands to maintain balance and stability during your workout.
- Exercise Safely:** Use the armrest as a support aid. Do not lean heavily on it or use it to support your full body weight.

Height Adjustable & Removable Armrests

38.6"
Maximum

27.2"
Minimum

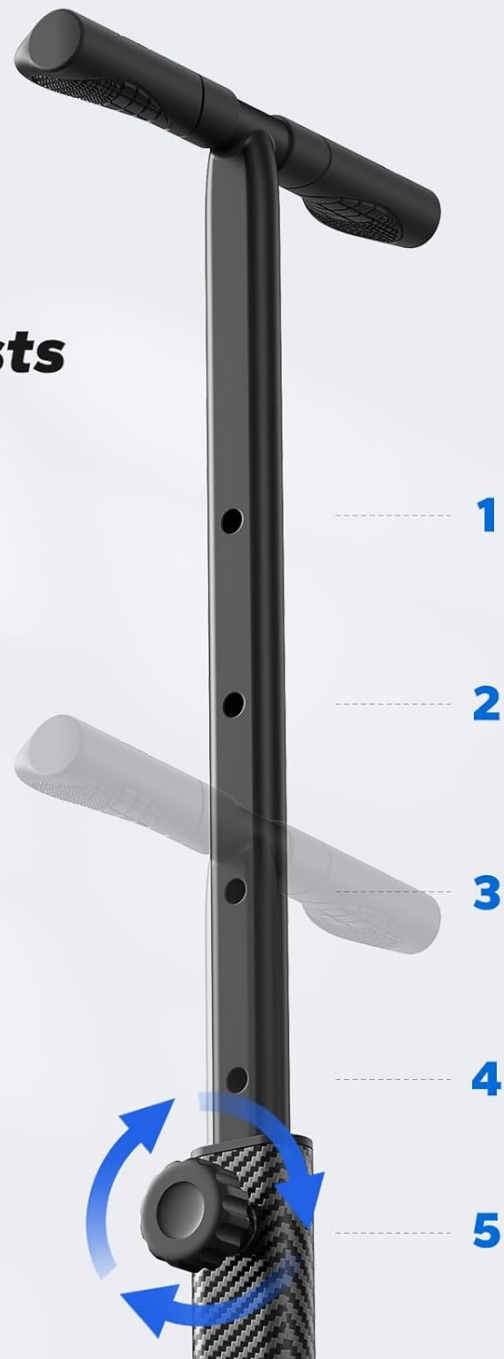

Image 5.1: The armrest features an adjustable height mechanism, allowing users to set the handle between a minimum of 27.2 inches and a maximum of 38.6 inches for personalized comfort and support.

Safe and Stable Handrails



Image 5.2: The armrest provides a safe and stable support for users on a vibration plate. The image shows a user maintaining balance by holding the handrails.

6. MAINTENANCE

Proper maintenance ensures the longevity and safe operation of your MERACH Vibration Plate Armrest.

- **Cleaning:** Wipe down the armrest with a soft, damp cloth after each use. Avoid abrasive cleaners or solvents that could damage the finish or rubber grips.
- **Inspection:** Periodically check all screws and connections to ensure they remain tight. Re-tighten if necessary.
- **Storage:** Store the armrest and vibration plate in a clean, dry environment away from direct sunlight and extreme temperatures.
- **Suction Cups:** Ensure the suction cups are clean and free of debris to maintain optimal grip.

7. TROUBLESHOOTING

If you encounter issues with your MERACH Vibration Plate Armrest, refer to the following common problems and

solutions.

Problem	Possible Cause	Solution
Armrest feels unstable or wobbly.	<ul style="list-style-type: none">• Screws are not fully tightened.• Suction cups are not properly engaged or are dirty.• Armrest not correctly assembled.	<ul style="list-style-type: none">• Check and tighten all assembly screws.• Ensure suction cups are clean and placed on a smooth, non-porous surface. Press down firmly to engage.• Review Section 4 (Setup and Assembly) to confirm correct installation.
Difficulty assembling components (e.g., screws not fitting).	<ul style="list-style-type: none">• Screws or holes are misaligned.• Incorrect screws used for a specific part.	<ul style="list-style-type: none">• Carefully align screws before attempting to tighten. Do not force.• Refer to the assembly diagram in the manual to ensure the correct screws are used for each component.• If issues persist, contact customer support.
Armrest height adjustment knob is loose or doesn't hold.	<ul style="list-style-type: none">• Knob not tightened sufficiently.• Internal mechanism worn or damaged.	<ul style="list-style-type: none">• Ensure the knob is tightened firmly after adjusting the height.• If the knob or mechanism is damaged, contact customer support for replacement parts.

8. SPECIFICATIONS

Feature	Detail
Brand	Merach
Model	Vibration Plate Armrest
Material	Alloy Steel
Color	Black
Item Weight	4.72 kg
Adjustable Height Range	27.2 inches - 38.6 inches
Compatible Vibration Plate Depth	12.7 inches - 22.8 inches
Included Components	Handrail, Instruction manual, Screw pack
ASIN	B0FC2P6YRR

9. WARRANTY AND SUPPORT

MERACH is committed to customer satisfaction. Your purchase includes full customer support and a clear after-sales guarantee. If you have any questions, require assistance with assembly, or encounter any issues with your Vibration Plate Armrest, please contact MERACH customer service through the retailer where you purchased the product or visit the official MERACH website for support contact information.

Please retain your proof of purchase for warranty claims.

