

ByteUp D12Pro

ByteUp D12 Pro Bluetooth Label Maker Instruction Manual

Model: D12Pro

1. INTRODUCTION

The ByteUp D12 Pro is a compact and portable thermal label printer designed for various labeling needs. It connects via Bluetooth to your smartphone, allowing you to create and print labels for food date tracking, home organization, office files, and more. This device utilizes thermal printing technology, eliminating the need for ink cartridges, and features a magnetic back for convenient storage.

2. WHAT'S IN THE BOX

Upon opening your ByteUp D12 Pro package, please ensure all the following items are present:

- 1 x D12 Pro Label Maker
- 1 x Roll of White Label Paper
- 1 x Type C Charging Cord
- 1 x User Manual

What's in the Box + Quick Tips



Quick Tips

- Pair in the app (not phone Bluetooth)
- PIN: 1234 (if asked)
- Auto power-off ~20 min idle (adjustable)

Figure 2.1: Package Contents of the D12 Pro Label Maker.

3. PRODUCT FEATURES

- **One-Touch Date/Time Stamp:** Quickly print the current date and time with a single tap, ideal for tracking food freshness and reducing waste.
- **Bluetooth App Printing:** Design and print labels wirelessly from your smartphone using the dedicated app.
- **203 DPI Thermal Inkless Printing:** Produces clear, readable black text without the need for ink, toner, or cartridges.
- **Compatible Tape Width:** Supports label tape widths between 12mm and 15mm (0.47–0.59 inches), suitable for various organizational tasks.
- **Magnetic Back:** Allows for convenient storage on metal surfaces like refrigerators, keeping the device easily accessible.
- **USB-C Rechargeable:** Equipped with a 1200mAh battery, rechargeable via USB-C, providing approximately 2.5–3 hours for a full charge and up to 50m of continuous printing.
- **Automatic Power-Off:** The device automatically powers off after approximately 20 minutes of inactivity (timer adjustable in the app) to conserve battery.



Figure 3.1: Key Features of the D12 Pro Label Maker.

4. SETUP GUIDE

Follow these steps to set up your D12 Pro Label Maker for first use:

1. **Power On:** Press and hold the power button for 2-3 seconds until the indicator light turns on.
2. **Open the Cover:** Gently lift the top cover of the label maker to access the tape compartment.
3. **Install Label Roll:** Insert the label tape roll into the compartment. Ensure the side with the label faces outward, feeding it through the slot.
4. **Align Paper:** Close the cover. Press the power button once to align the label paper.
5. **Download App:** Download the "AiYin" app from your smartphone's app store (iOS or Android).
6. **Connect via Bluetooth:** Open the AiYin app. Navigate to the connection section and search for your D12 Pro device. Pair the device within the app (do not pair directly through your phone's Bluetooth settings). If prompted for a PIN, enter **1234**. Android users may need to grant Location/GPS permission due to system Bluetooth rules.

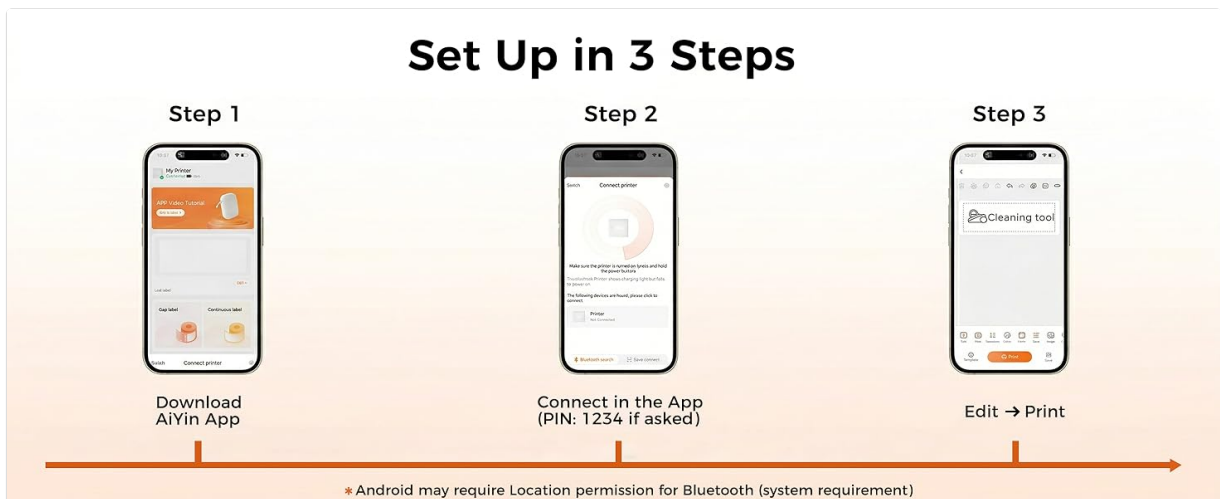

Figure 4.1: App Setup Steps.



Figure 4.2: Loading Label Tape.

Video: Simple Installation Guide

Your browser does not support the video tag.

This video provides a step-by-step visual guide for the physical installation of the D12 Pro Label Maker, including powering on, opening the cover, installing the label roll, and aligning the paper.

5. OPERATING INSTRUCTIONS

Once your D12 Pro is set up and connected to the AiYin app, you can begin creating and printing labels.

5.1. Printing Custom Labels via App

1. **Select Label Type:** In the AiYin app, choose between "Gap label" or "Continuous label" based on your label roll type.
2. **Design Your Label:** Use the app's interface to add text, dates, symbols, frames, and images. You can adjust font, size, and layout.
3. **Preview and Print:** Review your label design in the app's preview. Adjust print density and the number of copies if needed, then tap "Print".

Set Up in 3 Steps

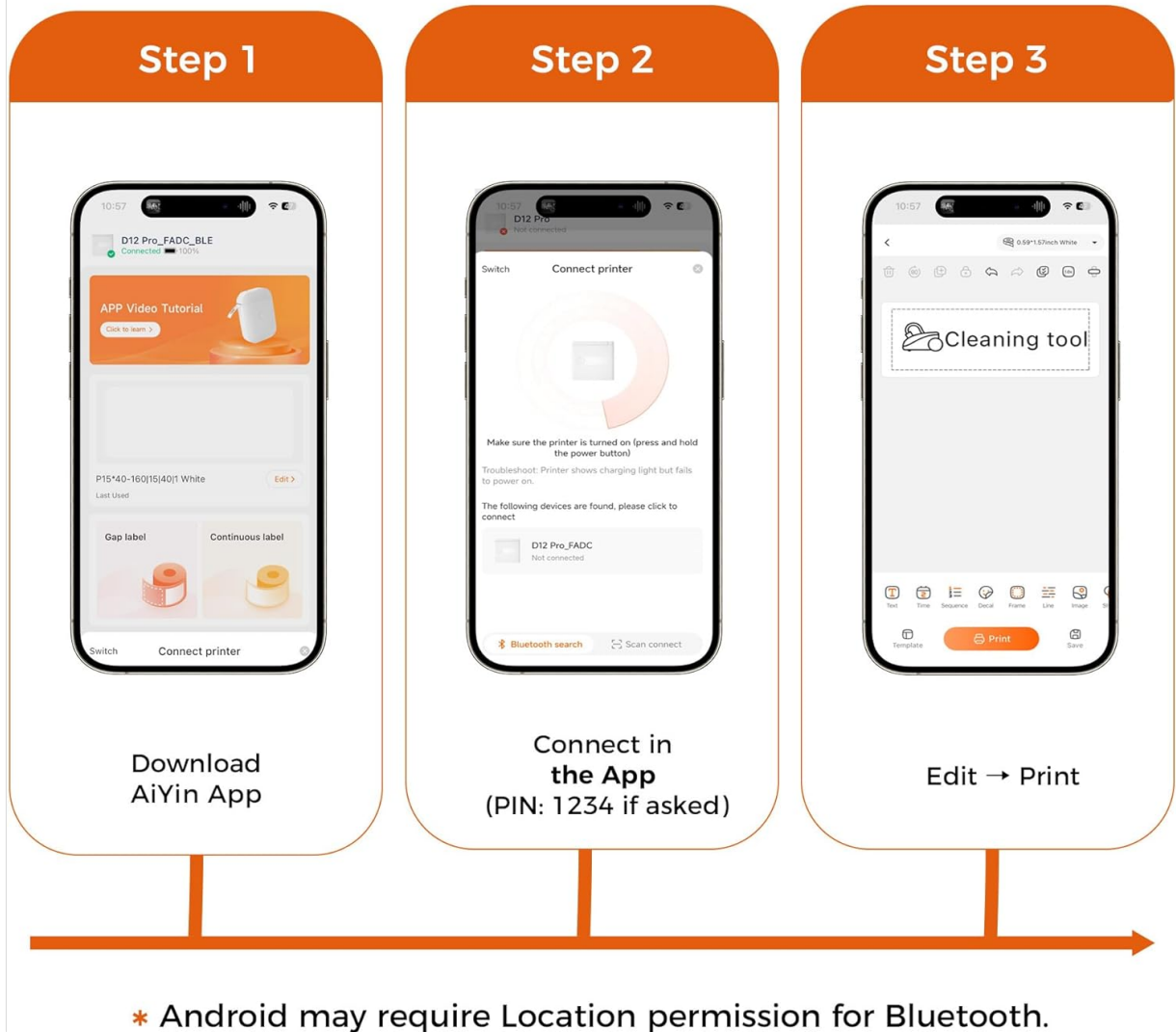

Figure 5.1: App Interface for Label Creation.

5.2. One-Touch Date/Time Printing

For quick date and time labels, simply double-click the power button on the D12 Pro device. It will automatically print the current date and time.

One-Tap Date / Time Stamp

Label leftovers & meal prep in seconds
Auto-sync time when you open the app



Figure 5.2: Using the One-Touch Date/Time Stamp.

Video: Label Printing D12Pro

Your browser does not support the video tag.

This video demonstrates the process of printing labels using the D12 Pro, including custom text and the one-touch date/time function.

Video: Print Labels from Smartphones

Your browser does not support the video tag.

This video illustrates how to print labels directly from your smartphone using the dedicated application, showcasing the ease of use for both iOS and Android devices.

6. MAINTENANCE

Proper maintenance ensures the longevity and optimal performance of your D12 Pro Label Maker.

- **Cleaning the Print Head:** If print quality degrades, gently wipe the thermal print head with a cotton swab lightly dampened with isopropyl alcohol. Ensure the device is off and dry before use.
- **Battery Care:** Charge the device regularly, even if not in frequent use, to maintain battery health. Avoid fully discharging the battery for extended periods.

- **Storage:** Store the label maker in a cool, dry place away from direct sunlight and extreme temperatures.
- **Label Roll Storage:** Store unused label rolls in their original packaging to protect them from dust, moisture, and light, which can affect print quality and adhesive.

7. TROUBLESHOOTING

If you encounter issues with your D12 Pro Label Maker, refer to the following common problems and solutions:

Problem	Possible Cause	Solution
Device won't power on.	Low battery or power button not held long enough.	Charge the device using the USB-C cable. Hold the power button for 2-3 seconds.
Cannot connect via Bluetooth.	Incorrect pairing method or app permissions.	Ensure pairing is done within the AiYin app, not phone settings. Grant Location/GPS permission on Android. Enter PIN 1234 if requested.
Poor print quality (faint, blurry).	Dirty print head or incorrect label roll insertion.	Clean the print head. Ensure the label roll is inserted with the printable side facing outward. Adjust print density in the app.
Labels not feeding correctly.	Label roll misalignment or empty roll.	Re-insert the label roll, ensuring it's properly seated. Press the power button once to align. Replace the roll if empty.

Quick Tips & FAQ

What's in the Box

1 Label Printer
2 Roll of Tape
3 USB-C Cable
4 User Manual

Device PIN PIN: 1234 (Enter if asked during setup)

App Permissions Android may need Location/GPS permission for Bluetooth (system rule)

Printing Style Monochrome printing (Black text only)

Power Management Auto power-off after ~20 minutes (adjustable)

Tape Width Fits 12-15mm width only (Check roll size)

Figure 7.1: Quick Tips and Common Solutions.

8. SPECIFICATIONS

Feature	Detail
Brand	ByteUp
Model Name	D12Pro
Connectivity Technology	Bluetooth

Feature	Detail
Printing Technology	Thermal
Printer Output	Monochrome (Black Text Only)
Max Print Speed (Monochrome)	30 mm/s
Maximum Print Resolution	203 DPI
Product Dimensions (D x W x H)	2.8"D x 2.9"W x 1.3"H
Controller Type	iOS, Android (via App)
Compatible Devices	Smartphones (iPhone, iOS & Android)
Hardware Interface	USB Type C
Print Media	Labels
Supported Label Width	12-15mm (0.47-0.59 inches)
Battery Capacity	1200mAh
Auto Power-Off	Adjustable, default ~20 minutes idle

9. WARRANTY AND SUPPORT

The ByteUp D12 Pro Label Maker comes with a **1-year warranty** from the date of purchase. This warranty covers manufacturing defects and malfunctions under normal use conditions.

For technical support, troubleshooting assistance, or warranty claims, please contact ByteUp customer service through the contact information provided in your product packaging or on the official ByteUp website. Please have your model number (D12Pro) and proof of purchase ready when contacting support.