

[Manuals.plus](#) /

> [Surakey](#) /

> Surakey 9.7-inch Android Car Stereo for Dodge Ram 1500 2500 3500 (2006-2008) - User Manual

Surakey 2+64GB

Surakey 9.7-inch Android Car Stereo User Manual

Model: 2+64GB for Dodge Ram 1500/2500/3500 (2006-2008)

1. INTRODUCTION

Thank you for choosing the Surakey 9.7-inch Android Car Stereo. This manual provides essential information for the proper installation, operation, and maintenance of your new car stereo system. Please read it thoroughly before installation and use to ensure optimal performance and safety.

2. COMPATIBILITY

This car stereo is designed for specific vehicle models. Please verify your vehicle's compatibility before proceeding with installation.

- **Compatible Vehicles:** Dodge Ram 1500, 2500, 3500
- **Compatible Years:** 2006, 2007, 2008

Important Note:

Before ordering, confirm your car's model, year, and compatibility. It is recommended to send a complete image of the plugs on the back of your central console and the onboard head unit to the manufacturer to ensure exact matching and to determine if any additional wiring harnesses or adapters are required.



Image: Examples of compatible Dodge Ram dashboards, showing various factory stereo configurations that fit the Surakey unit.

3. PACKAGE CONTENTS

Upon unpacking, ensure all items listed below are present:

- 1 x Car MP5 Player (Main Unit)
- 1 x Power Cable
- 1 x GPS Antenna
- 1 x Backup Camera
- 1 x RCA Input/Output Cable
- 2 x USB Cables
- 2 x Metal Frames
- 4 x Screws
- 1 x Instruction Manual

4. SETUP AND INSTALLATION

Warning: Professional installation is highly recommended. Incorrect installation can damage the

device or your vehicle's electrical system.

Note: Years just for your reference, please confirm the center console of your vehicle before bidding.

Please Note!



It is NOT Plug and Play. you'll need to cut wires to install.

Image: Important notice indicating that the unit is not 'Plug and Play' and requires wire cutting for installation.

4.1 Pre-Installation Checks

- Ensure the vehicle's ignition is off and the battery is disconnected before starting.
- Confirm all package contents are present.
- Review your vehicle's specific dashboard removal and wiring diagrams.

4.2 Wiring Connections

Connect the power cable, GPS antenna, USB cables, and RCA input/output cables according to the provided wiring diagram (refer to the included instruction manual for detailed diagrams). The unit requires direct wiring and may involve cutting and splicing wires from your vehicle's existing harness.

- **Power Cable:** Connect to the vehicle's power supply, ground, and accessory wires.
- **GPS Antenna:** Connect the GPS module and place the antenna in a location with a clear view of the sky (e.g., dashboard, under the windshield).
- **USB Cables:** Connect the two USB interfaces for external devices or data transfer.
- **Backup Camera:** Connect the included backup camera to the designated video input. Ensure the trigger wire is connected to the reverse light circuit for automatic activation.
- **External Microphone:** If using an external microphone, connect it to the dedicated input for improved call quality.

4.3 Mounting the Unit

Use the provided metal frames and screws to securely mount the car stereo into your vehicle's dashboard opening. Ensure all connections are firm and wires are neatly tucked away to prevent interference or damage.

5. OPERATING INSTRUCTIONS

Your Surakey car stereo runs on Android 13, offering a wide range of features and customization options.

5.1 Basic Operation

- **Power On/Off:** Press and hold the power button (usually located on the front panel or integrated into the volume knob) to turn the unit on or off. A short press typically mutes or unmutes the audio.
- **Volume Control:** Adjust the volume using the physical knob or on-screen controls.

- **Touchscreen Interface:** Navigate through menus and applications by tapping, swiping, and pinching on the 9.7-inch HD display.

5.2 Apple CarPlay and Android Auto

Connect your smartphone for seamless integration of navigation, music, calls, and more.

- **Connection:** Supports both wired (via USB) and wireless (via Bluetooth and WiFi) connections.
- **Features:** Access phonebook, mail, notifications, map navigation, music playback, make calls, and utilize voice control (Siri for CarPlay, Google Assistant for Android Auto).



Image: Illustration of wired and wireless Apple CarPlay and Android Auto interfaces on the car stereo display.

5.3 GPS Navigation

The unit supports both offline and online navigation options.

- **Offline Maps:** Integrated offline maps are available. Ensure the GPS antenna is properly connected for accurate positioning.
- **Online Navigation:** Connect to WiFi/WLAN to download and use online navigation applications from the app store.

GPS Navigation

Online Map

Offline Map



Image: Display showing GPS navigation with options for online and offline maps, including popular navigation apps.

5.4 Mirror Link and Split Screen

- **Mirror Link:** Mirror the display of your iOS or Android smartphone onto the car stereo screen via WiFi.
- **Split Screen:** Run two applications simultaneously on the screen, such as navigation and music playback, for enhanced multitasking.

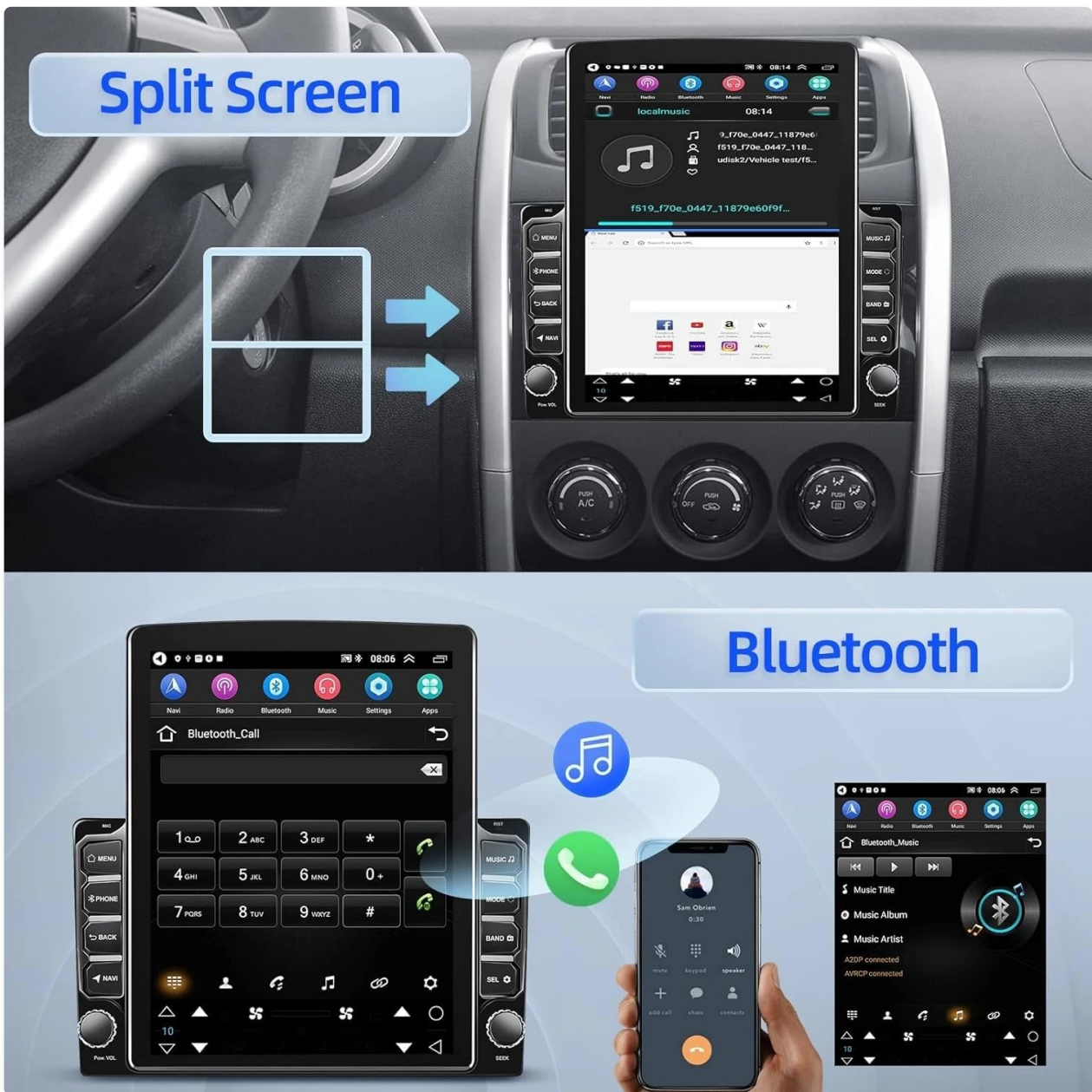

Image: Demonstrates the split-screen feature, allowing two applications to run concurrently, and the Bluetooth calling interface.

5.5 Steering Wheel Control (SWC)

If your vehicle supports it, connect the SWC wires to control the stereo directly from your steering wheel buttons.

- **Functions:** Answer calls, change music tracks, adjust volume, and more, without taking your hands off the wheel.
- **Configuration:** Access the steering wheel control settings in the unit's menu to map your vehicle's buttons to the desired functions.

5.6 AHD Backup Camera

The system supports an AHD backup camera for enhanced safety when reversing.

- **Automatic Display:** When the vehicle is put into reverse gear, the camera feed will automatically display on the screen.
- **Guidelines:** Dynamic parking guidelines may be available to assist with parking maneuvers.

AHD Backup Camera



Steering Wheel Control



Image: Shows the AHD backup camera view on the display and the interface for configuring steering wheel controls.

5.7 Bluetooth Connectivity

Pair your smartphone or other Bluetooth devices for hands-free calling and audio streaming.

- **Pairing:** Enable Bluetooth on your phone and search for the car stereo. Select the device and confirm the pairing code.
- **Hands-Free Calling:** Make and receive calls directly from the car stereo interface.
- **Audio Streaming:** Play music from your phone through the car's speakers.

5.8 Radio (FM/RDS)

Tune into your favorite radio stations.

- **Frequency Range:** 87.5-108 MHz.
- **RDS:** Radio Data System provides additional information like station name and song title (where available).

5.9 Media Playback

The unit supports various audio and video formats for local media playback.

- **Audio Formats:** APE, FLAC, WAV, MP3, WMA, and more.
- **Video Formats:** MKV, RMVB, AVI, MP4, MDV, and more.
- **Image Formats:** PNG, JPEG, JPG, GIF, WBMP, BNP, and more.

6. MAINTENANCE

To ensure the longevity and optimal performance of your car stereo, follow these maintenance guidelines:

- **Cleaning:** Use a soft, dry cloth to clean the screen and unit. Avoid abrasive cleaners or solvents that could damage the surface.
- **Temperature:** Avoid exposing the unit to extreme temperatures, direct sunlight for prolonged periods, or high humidity.
- **Connections:** Periodically check all wiring connections to ensure they are secure and free from corrosion.
- **Software Updates:** Check the manufacturer's website for any available software or firmware updates to improve performance and add new features.

7. TROUBLESHOOTING

If you encounter issues with your car stereo, refer to the following common troubleshooting steps:

- **No Power:** Check all power connections and fuses. Ensure the vehicle's battery is charged.
- **No Sound:** Verify speaker connections, volume level, and audio source selection.
- **Touchscreen Unresponsive:** Try restarting the unit. If the issue persists, a factory reset might be necessary.
- **GPS Signal Loss:** Ensure the GPS antenna has a clear view of the sky and is securely connected.
- **Bluetooth Connection Issues:** Delete previous pairings on both the stereo and your phone, then attempt to re-pair.
- **Factory Settings Keyword:** If a factory reset requires a password, the default keyword is **8888**.

If problems persist after attempting these steps, please contact customer support.

8. SPECIFICATIONS

Feature	Specification
Operating System	Android 13
Material	Metal, Plastic
Memory (RAM + ROM)	2GB (RAM) + 64GB (ROM)
Display Size	9.7 inches
Output Power	4x45W

Feature	Specification
FM Frequency Range	87.5-108 MHz
Steering Wheel Control	Supported
Bluetooth Version	4.0
Power Amplifier Chip	AC7388
Radio Band	FM/RDS
Video Output	Supported
External Microphone	Supported
Maps	Built-in Offline Maps
WiFi	Supported
USB Interface	Dual USB
Supported Audio Formats	APE, FLAC, WAV, MP3, WMA, etc.
Supported Video Formats	MKV, RMVB, AVI, MP4, MDV, etc.
Supported Image Formats	PNG, JPEG, JPG, GIF, WBMP, BNP, etc.
Factory Settings Keyword	8888
Supported Languages	Chinese, English, French, Italian, Korean, Japanese, Arabic, Spanish, Portuguese, Russian, Turkish, Vietnamese, Hebrew, Polish, German
ASIN	B0G391LD9W

9. WARRANTY AND SUPPORT

For warranty information, please refer to the documentation included with your purchase or contact the retailer. For technical support, installation assistance, or any other inquiries, please reach out to Surakey customer service through their official channels.

