



Manuals.plus /

› ANCTOR /

› ANCTOR Wardrobe Closet with Doors (Model HK-BA-YN02) - Instruction Manual

## ANCTOR HK-BA-YN02

# ANCTOR Wardrobe Closet with Doors

Model: HK-BA-YN02

### INTRODUCTION

---

Thank you for choosing the ANCTOR Wardrobe Closet. This manual provides essential information for the safe assembly, operation, and maintenance of your new furniture. Please read all instructions carefully before beginning assembly and retain this manual for future reference.

### Important Safety Information

Always secure the wardrobe to the wall using the provided wall-mounted anchors to prevent tipping. Be cautious during assembly to avoid injury from tools or falling parts. Keep the wardrobe away from heat sources and never place heavy objects on top to prevent instability. Ensure all fasteners are tightened securely before use.

# Anti-tipping Anchors for Stability

Securely mounted to the wall, use for sure.

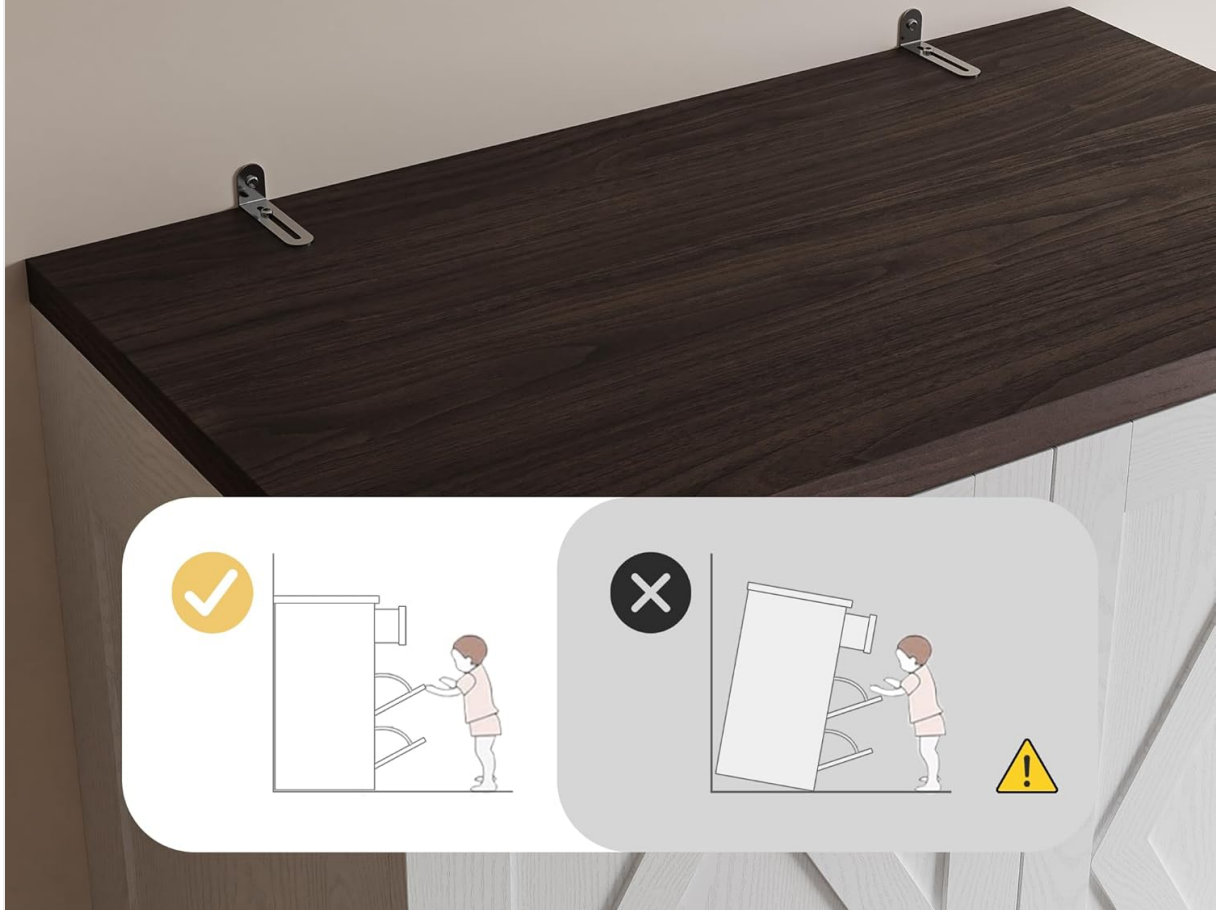

Image: Anti-tipping Anchors for Stability. Securely mounted to the wall, use for sure. This diagram illustrates the correct method of attaching the wardrobe to the wall using anti-tipping anchors (left) versus an unstable, unanchored setup (right).

## PACKAGE CONTENTS

Before assembly, verify that all components and hardware are present. Refer to the included parts list in your package. The wardrobe includes:

- 4 Doors
- 5 Shelves (one adjustable)
- Hanging Rod
- Installation Kit
- User Manual (this document)

## SETUP (ASSEMBLY INSTRUCTIONS)

Assembly is required for this wardrobe. It is recommended to have two people for assembly. Please follow the step-by-step instructions provided in the included assembly guide. For a visual aid, you may refer to the assembly video below, which demonstrates the process for a similar 2-door wardrobe. Please note that specific steps or components may vary slightly from your ANCTOR HK-BA-YN02 model.

Your browser does not support the video tag.

Video: 2 Door Wardrobe Assembly Video. This video demonstrates the assembly process for a similar wardrobe. Please refer to your specific product's instruction manual for exact steps and parts.

## Key Assembly Steps:

1. **Unpack and Identify Parts:** Carefully unpack all components and lay them out on a soft, clean surface to prevent scratches. Identify each part using the labels and diagrams in your manual.
2. **Assemble Base Structure:** Follow the instructions to connect the base panels using the provided hardware.
3. **Attach Side Panels:** Secure the side panels to the base.
4. **Install Shelves and Hanging Rod:** Insert the fixed and adjustable shelves. Position the hanging rod as desired.
5. **Attach Back Panel:** Secure the back panel to the wardrobe frame.
6. **Install Doors:** Attach the doors using the hinges. Adjust as needed for proper alignment.
7. **Install Handles:** Secure the door handles.
8. **Secure with Anti-Tipping Anchors:** This is a critical safety step. Attach the anti-tipping hardware to the top of the wardrobe and secure it to a wall stud using appropriate wall anchors.



Image: Details of the wardrobe's metal handles, sturdy hanging rod, and smooth hinges, highlighting quality components.

## OPERATING INSTRUCTIONS

The ANCTOR Wardrobe Closet is designed for versatile storage of clothing and accessories.

- **Hanging Area:** Use the integrated hanging rod for suits, dresses, jackets, and other items that require wrinkle-free

storage. The hanging space measures approximately 16.3"W x 21.9"D x 44.5"H.

- **Shelves:** The wardrobe features 5 shelves, one of which is adjustable. These are ideal for folded items such as sweaters, jeans, undergarments, and accessories. Adjust the height of the movable shelf to accommodate different item sizes.
- **Doors:** The four doors provide easy access to the wardrobe's contents and keep items neatly concealed.



Image: An open wardrobe displaying its various storage zones, including a top area for boxes, a hanging section for clothes, shelves for folded items, and a bottom area for shoes or additional storage.



Image: This image highlights the adjustable and removable shelf feature, allowing for customizable interior layouts to fit changing storage needs.

## MAINTENANCE

Proper care will ensure the longevity of your ANCTOR Wardrobe Closet.

- **Cleaning:** Wipe surfaces with a soft, damp cloth. Avoid using harsh chemicals or abrasive cleaners, as these can damage the finish.
- **Dusting:** Regularly dust the wardrobe with a dry, soft cloth.
- **Spills:** Clean spills immediately to prevent staining.
- **Hardware:** Periodically check all screws and fasteners to ensure they remain tight. Retighten if necessary.
- **Weight Limit:** Do not exceed the weight limit of 50 pounds for the hanging rod and shelves to prevent damage or collapse.

## TROUBLESHOOTING

If you encounter any issues with your wardrobe, refer to the following common solutions:

- **Wobbly Wardrobe:** Ensure all cam locks and screws are fully tightened. Verify the anti-tipping anchors are securely installed to the wall.
- **Doors Not Aligning:** Check that the hinges are correctly installed and tightened. Most hinges allow for minor

adjustments to align the doors. Refer to the assembly manual for hinge adjustment details.

- **Difficulty Opening/Closing Doors:** Ensure no items are obstructing the door's path. Check hinges for proper function and lubrication if needed.
- **Missing Parts:** If any parts are missing upon unpacking, please contact customer support immediately.

## SPECIFICATIONS

<b>Brand</b>	ANCTOR
<b>Model Name</b>	HK-BA-YN02
<b>Color</b>	White
<b>Material</b>	Engineered Wood
<b>Product Dimensions</b>	22"D x 31"W x 71"H
<b>Item Weight</b>	130 Pounds
<b>Number of Shelves</b>	5 (one adjustable)
<b>Weight Limit (Rod &amp; Shelves)</b>	50 Pounds
<b>Special Features</b>	4 Doors, Adjustable Shelf, Anti-Tipping, Hanging Rod
<b>Installation Type</b>	Freestanding (with wall mount anchors)



- Complete Protect (monthly plan covering eligible purchases)