

Relndoo T901

Relndoo T901 10-Inch Android 15 Tablet User Manual

Model: T901 | Brand: Relndoo

1. INTRODUCTION

This manual provides comprehensive instructions for the Relndoo T901 10-inch Android 15 Tablet. It is designed to help you understand the device's features, set it up correctly, operate it efficiently, and troubleshoot common issues. Please read this manual thoroughly before using your tablet.



Figure 1: Overview of Relndoo T901 Tablet features.

2. WHAT'S IN THE BOX

The Relndoo T901 Tablet package includes the following items:

- 1 x Relndoo T901 10-inch Tablet
- 1 x Bluetooth Keyboard

- 1 x Wireless Mouse
- 1 x Stylus Pen
- 1 x Foldable Protective Case (Black)
- 1 x Screen Protector
- 1 x Charging Head
- 1 x USB-C Charger Cable
- 1 x User Manual



Figure 2: The Relindoo T901 Tablet and its complete accessory bundle.

3. SETUP

3.1 Initial Charging

Before first use, fully charge your tablet using the provided USB-C charger cable and charging head. The tablet features an 8000mAh battery for extended use.

3.2 Power On/Off

- To power on: Press and hold the power button until the screen lights up.
- To power off: Press and hold the power button, then select 'Power off' from the options.

3.3 Connecting Accessories

The tablet supports Bluetooth 5.0 for seamless wireless pairing with the included keyboard, mouse, and other accessories.

- **Bluetooth Keyboard/Mouse:** Turn on the accessory and enable Bluetooth on your tablet via Settings > Connected devices > Bluetooth. Select the accessory from the available devices to pair.
- **Stylus Pen:** The stylus is ready for use directly on the touchscreen.

Best Study Partner



Figure 3: Connecting devices via Bluetooth for enhanced convenience.

4. OPERATING INSTRUCTIONS

4.1 Android 15 Operating System

Your tablet runs on the latest Android 15 OS, offering a smooth and personalized user experience. Key features include:

- **App Pairs:** Easily open two apps side-by-side for multitasking.
- **App Archiving:** Free up storage by archiving rarely used apps while keeping their data.
- **Enhanced Physical Keyboard Support:** Improved navigation and typing experience with external keyboards.
- **Personalized Widget Previews:** Preview widgets before adding them to your home screen.
- **Color Correction Slider:** Adjust display colors for optimal viewing comfort.

Widevine L1 Support

1080P Viewing Experience on Netflix, HBO, Hulu, Disney+, and Amazon Prime Video.



10.1" HD+ Tab, 10.1" Portable PC

Crisp and Clear, All Alive



Eye-friendly Modes:



- Reading Mode**
- Night Light**
- Dark Mode**
(Enhanced/Moderate/Gentle)

 79% Screen-to-body Ratio	 HD+IPS Panel Type	 350 nits Brightness	 800*1280 Resolution
--	--	---	---

Figure 4: Android 15 user experience features.

4.2 Gemini AI Integration

The built-in Gemini AI engine provides intelligent task optimization and enhanced performance. It supports various functions:

- Content creation assistance

- Information retrieval and summarization
- Image analysis
- Code development support
- Language learning tools
- Intelligent assistant capabilities



Figure 5: Integrated Gemini AI for enhanced experiences.

4.3 Connectivity

The tablet supports dual-band Wi-Fi (2.4GHz & 5.0GHz) for stable internet access and Bluetooth 5.0 for connecting wireless peripherals.

4.4 Camera Usage

The tablet features a 13MP rear camera and a 5MP front camera for photos and video calls.

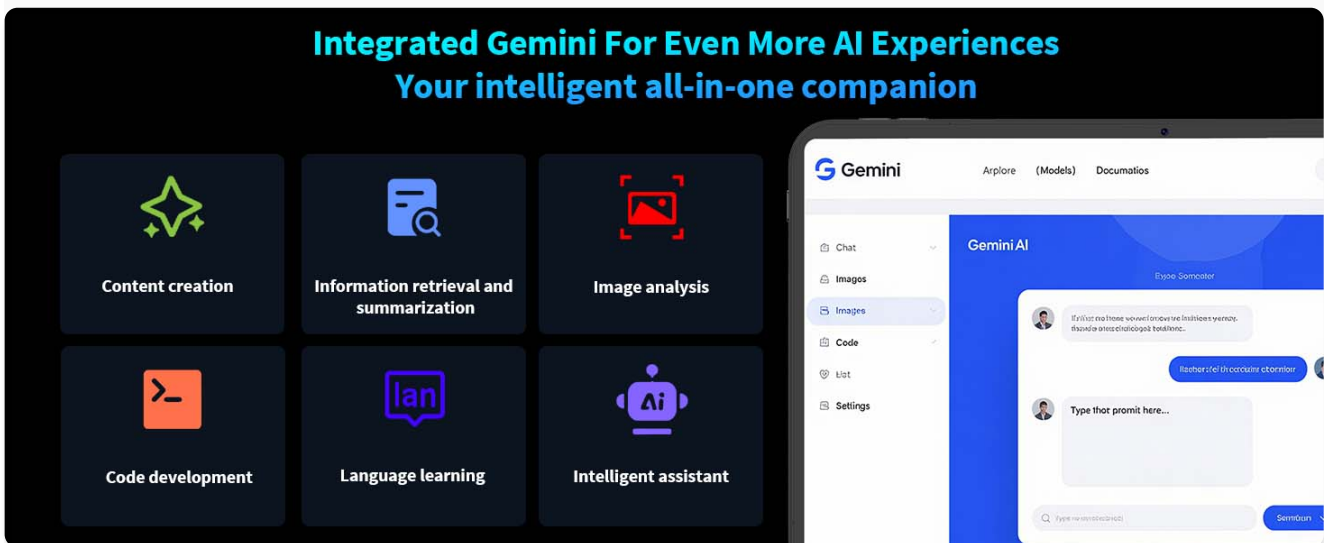

Figure 6: Camera specifications and capabilities.

4.5 Memory Management

The tablet comes with 24GB RAM (6GB physical + 18GB virtual) and 256GB internal storage, expandable up to 2TB via a TF card (sold separately).



Three-Finger Screenshot

Take a screenshot by swiping with three fingers



Split Screen

Simple multitasking through simultaneous use of two applications



FM Radio

Explore the world through sound

Figure 7: Memory and storage capabilities.

4.6 GMS Certification

The tablet is GMS-certified, allowing seamless browsing and downloading of applications from the Google ecosystem, including the Google Play Store.

Entertainment Partner



Figure 8: GMS certification for app access.

4.7 Display Features

The 10-inch IPS display with 1280x800 resolution supports Widevine L1 for 1080p full HD streaming on platforms like Netflix. It also includes eye-friendly modes such as Reading Mode, Night Light, and Dark Mode.

The Latest Stock Android 15, Always Stay a Step Ahead

Multitask with Ease, Convenience Within Reach

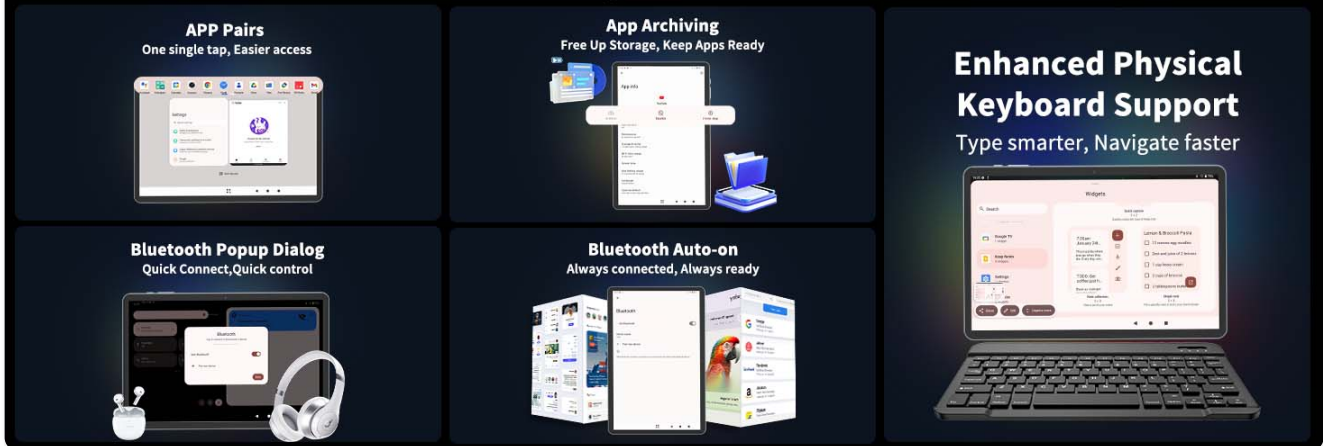

Figure 9: Display features and Widevine L1 support.

4.8 Audio

Equipped with dual speakers for an immersive audio experience. A 3.5mm headphone jack is also available for wired audio.

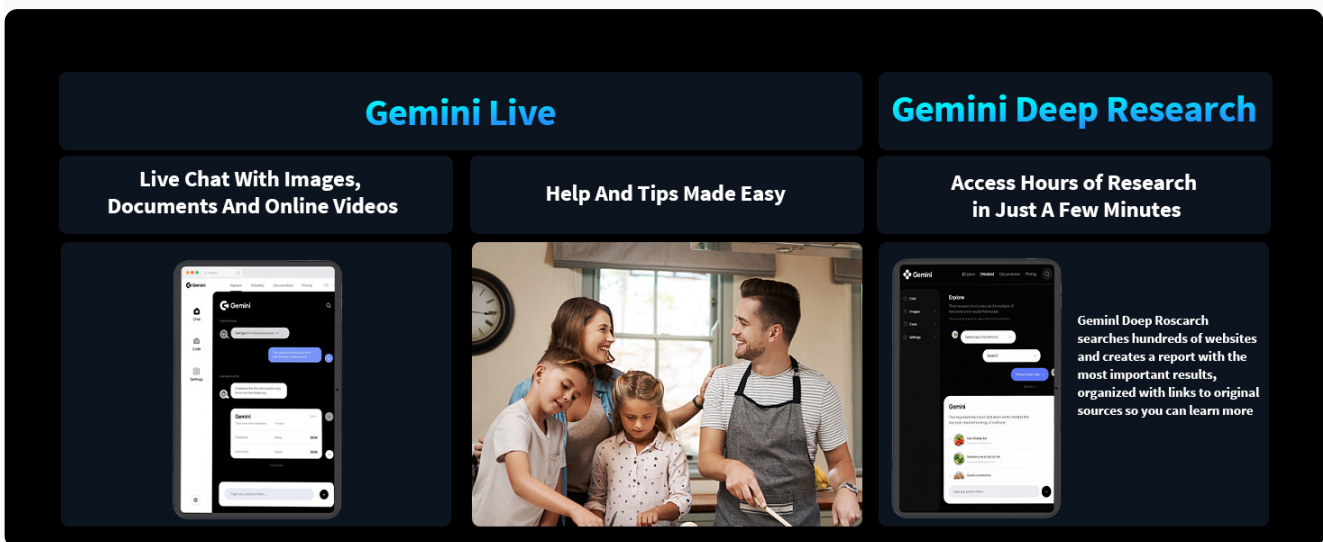

Figure 10: Dual speakers and headphone jack.

5. MAINTENANCE

5.1 Battery Care

To prolong battery life, avoid extreme temperatures and fully discharge and recharge the battery periodically. The 8000mAh battery provides up to 12 hours of average use.

The Perfect Workmate



Figure 11: Long-lasting battery power.

5.2 Cleaning

Use a soft, lint-free cloth to clean the screen and body of the tablet. Avoid using harsh chemicals or abrasive materials.

6. TROUBLESHOOTING

6.1 Wi-Fi Not Connecting or Keeps Dropping

If you experience issues with Wi-Fi connectivity, try resetting your network settings:

1. Go to **Settings**.
2. Scroll down and tap on **System**.
3. Select **Reset options**.
4. Tap **Reset Bluetooth & Wi-Fi**.
5. Confirm the reset.

Your browser does not support the video tag.

Video 1: Steps to fix Wi-Fi not connecting or keeps dropping on the T901 tablet.

6.2 Camera Permissions Issue

If the camera is not functioning correctly due to permission issues, follow these steps:

1. Long-press the Camera app icon on your home screen.
2. Tap **App info**.
3. Go to **Storage & cache**.
4. Tap **Clear storage** and confirm.
5. Re-open the Camera app and grant necessary permissions when prompted.

Your browser does not support the video tag.

Video 2: Guide to enabling camera permissions via system settings.

6.3 Changing System Language

To change the system language on your tablet:

1. Go to **Settings**.
2. Scroll down and tap on **System**.
3. Select **Languages**.
4. Tap **System Languages**.
5. Tap **Add a language** and select your desired language.
6. Drag your preferred language to the top of the list to set it as the primary system language.

Your browser does not support the video tag.

Video 3: Instructions for changing the system language on your tablet.

6.4 System Updates

To ensure your tablet has the latest features and security patches, regularly check for system updates:

1. Go to **Settings**.
2. Scroll down and tap on **System**.
3. Select **System updates**.
4. Tap **Check for update**.

Your browser does not support the video tag.

Video 4: Steps to upgrade your tablet's system version.

6.5 Using App Split-Screen

To use the split-screen feature for multitasking:

1. Open the first app you want to use.
2. Long-press the icon of the second app you want to open in split-screen.
3. Select **Split screen** from the options.
4. The screen will divide, allowing you to use both applications simultaneously.

Your browser does not support the video tag.

Video 5: How to use app split-screen on your device.

7. SPECIFICATIONS

Feature	Specification
Brand	Relindoo
Model Name	T901
Operating System	Android 15

Feature	Specification
Processor	Unisoc T606 Octa-Core
RAM Memory	24GB (6GB physical + 18GB virtual)
Internal Storage	256GB
Expandable Storage	Up to 2TB via microSD
Screen Size	10 Inches
Display Resolution	1280x800 Pixels (HD+ IPS)
Widevine Support	L1 (for 1080p streaming)
Rear Camera	13MP
Front Camera	5MP
Battery Capacity	8000mAh Lithium Polymer
Average Battery Life	12 Hours
Connectivity	5G Wi-Fi (802.11ac/b/g/n), Bluetooth 5.0
Charging Port	USB-C (bidirectional fast charging)
Audio	Dual Stereo Speakers, 3.5mm Headphone Jack
Human-Interface Input	Touchscreen with Stylus Support
Color	Black (tablet color is blue, case is black)
Dimensions (L x W x Th)	10.7"L x 7.6"W x 1.7"Th

8. WARRANTY AND SUPPORT

8.1 Warranty Information

The Relndoo T901 Tablet comes with a limited warranty. Please refer to the warranty card included in your package for specific terms and conditions. Keep your proof of purchase for warranty claims.

8.2 Customer Support

For technical assistance, troubleshooting, or any product-related inquiries, please contact Relndoo customer support. Contact information can typically be found on the manufacturer's website or on the packaging.

