

Manuals+

[Q & A](#) | [Deep Search](#) | [Upload](#)

manuals.plus /

› [Flieks](#) /

› [Flieks 60-inch Bathroom Vanity with Double Sinks User Manual](#)

Flieks N759S351759K-MZJ

Flieks 60-inch Bathroom Vanity with Double Sinks User Manual

Model: N759S351759K-MZJ

INTRODUCTION

This manual provides essential instructions for the safe installation, operation, and maintenance of your Flieks 60-inch Bathroom Vanity with Resin Double Sinks. Please read this manual thoroughly before assembly and use to ensure proper function and longevity of your product. Keep this manual for future reference.

Safety Information

- Always use appropriate safety gear during assembly, including gloves and eye protection.
- Ensure all parts are present and undamaged before beginning assembly. Do not proceed with assembly if any parts are missing or damaged.
- This vanity is heavy. Two or more people are recommended for lifting and assembly to prevent injury.
- Do not overtighten screws, as this may damage the material.
- Keep small parts away from children to avoid choking hazards.

SETUP AND INSTALLATION

Unpacking and Inspection

- Carefully unpack all components from the packaging.
- Verify that all listed parts are included and free from damage. Refer to the parts list (not provided in this manual, typically found in packaging).
- Retain packaging materials until assembly is complete in case of returns or exchanges.

Tools Required (Not Included)

- Phillips Head Screwdriver
- Adjustable Wrench
- Level
- Drill (for anti-tip device installation)
- Sealant/Caulk (for sink installation)

Assembly Steps

While specific step-by-step assembly instructions are provided with the product packaging, the general process involves:

1. **Cabinet Base Assembly:** Assemble the main cabinet structure according to the provided diagrams. Ensure all connections are secure.
2. **Leg Attachment:** Securely attach the solid wood legs to the base of the cabinet.
3. **Drawer and Door Installation:** Install the 3 drawers and 4 cabinet doors. Note that 2 of the doors include double-layer shelves. These shelf-equipped doors can be installed on the left, right, or one per side to suit your storage needs.
4. **Sink Top Placement:** Carefully place the resin double sink top onto the cabinet base. Apply a suitable sealant around the edges to secure it and prevent water infiltration.
5. **Faucet Installation:** Install your chosen 8-inch widespread faucets (not included) into the pre-drilled holes on the sink top. Connect the water supply lines according to faucet manufacturer instructions.
6. **Drain Connection:** Connect the sink drains to your plumbing system. The vanity features an open-back design for easier plumbing setup.
7. **Anti-Tip Device:** For safety, install the included anti-tip device to secure the vanity to the wall. This prevents accidental tipping.
8. **Adjustable Support Feet:** The cabinet feet are adjustable. Use them to level the vanity on uneven floors.

Unit:inch

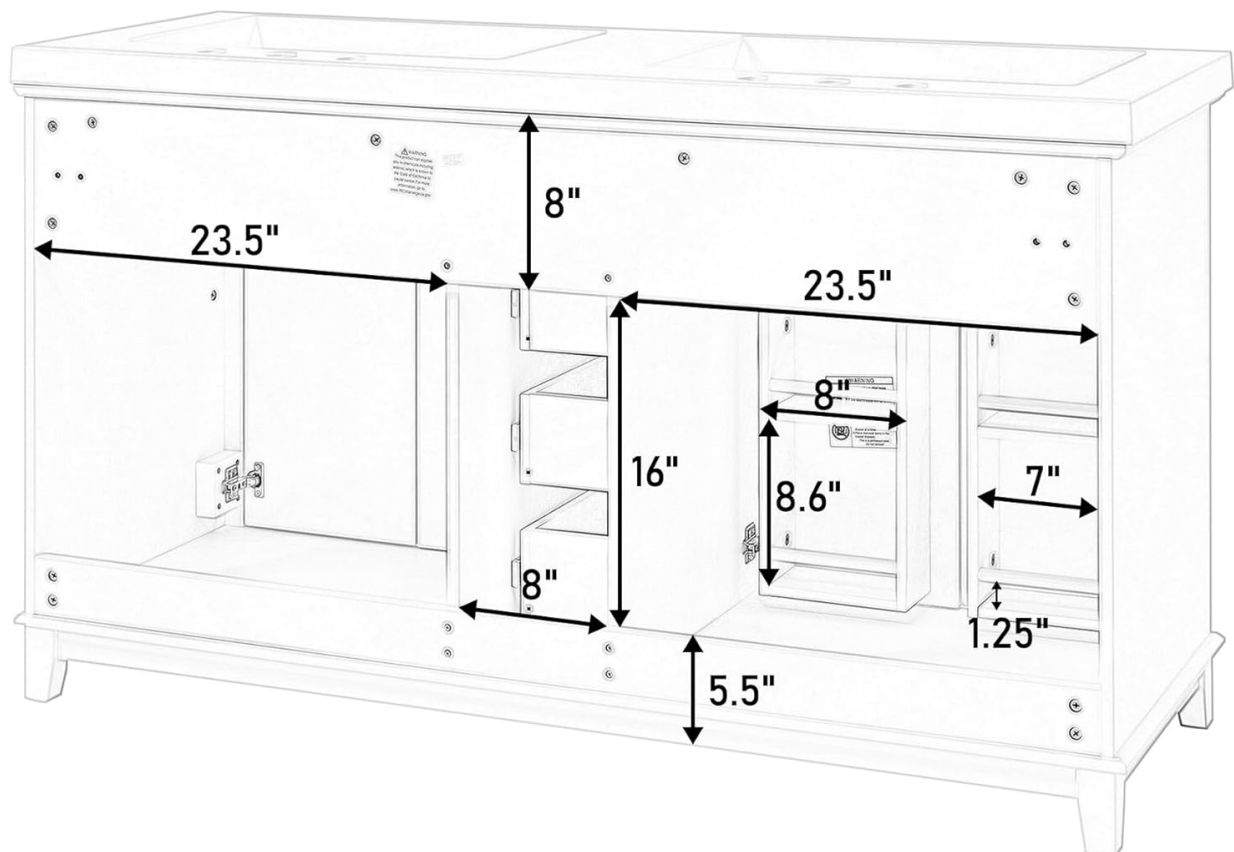

Figure 1: Front View Dimensions

Unit:inch

Basin Size

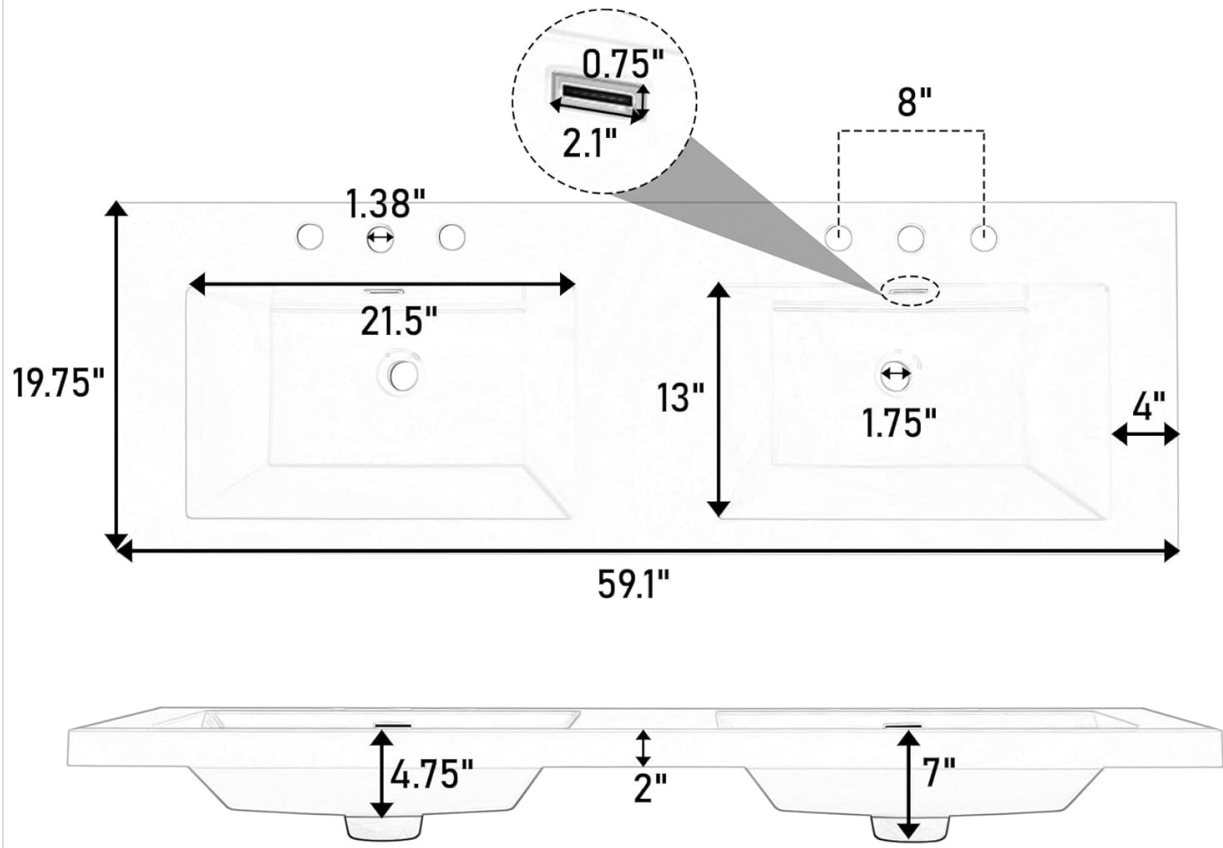

Figure 2: Back View Dimensions and Open-Back Design

OPERATING INSTRUCTIONS

Soft-Close Mechanism

Your Flieks vanity is equipped with a full soft-close mechanism on all drawers and cabinet doors. This feature ensures quiet operation and reduces wear and tear on the hardware. Simply push the drawer or door gently, and the mechanism will slowly pull it to a closed position.



Figure 3: Soft-Closing Mechanism

Storage Organization

The vanity offers versatile storage:

- **Drawers:** Three central drawers are ideal for smaller items such as toiletries, brushes, or cosmetics.
- **Cabinet Doors:** Four cabinet doors provide larger storage compartments. Two of these doors feature double-layer shelves, which can be adjusted or configured to optimize space for taller bottles or various bathroom essentials.

Unit:inch

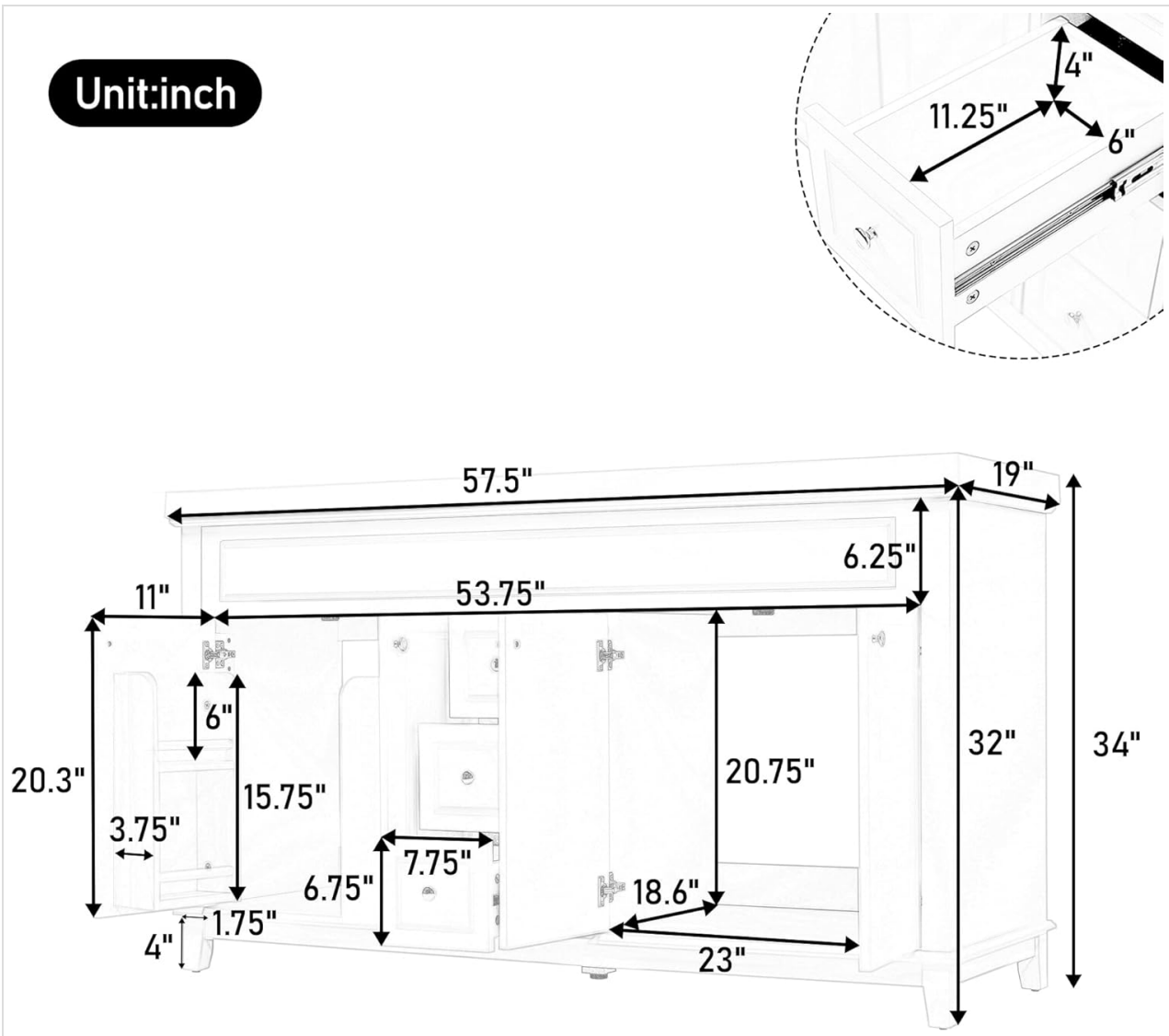

Figure 4: Internal Storage View

Resin Double Sinks

The integrated resin double sinks are designed for durability and ease of maintenance. Each sink includes a built-in overflow to prevent accidental spills. Ensure proper drainage by regularly cleaning the sink and drain area.

- Smooth Resin Double Sinks -



Long-Lasting & Easy to Maintain



Compatible with
8" Widespread Faucet
(not included)



Pre-drilled Three Faucet Holes
Chrome-finish Overflow

Figure 5: Resin Double Sinks Detail

MAINTENANCE

Cleaning the Vanity

- **Cabinet Surface:** The cabinet exterior features a smooth painted finish. Wipe clean with a soft, damp cloth. Avoid abrasive cleaners or harsh chemicals, as these can damage the finish.
- **Resin Sinks:** The resin sinks have an ultra-smooth, non-porous surface. Clean with mild soap and water. For stubborn stains, a non-abrasive liquid cleaner can be used. Rinse thoroughly after cleaning.
- **Hardware:** Clean metallic handles with a soft, dry cloth. Avoid chemical cleaners that may tarnish the finish.

General Care

- Avoid placing extremely hot items directly on the sink top or cabinet surface.
- Wipe up spills immediately to prevent water damage or staining.
- Periodically check all screws and connections to ensure they remain tight.

TROUBLESHOOTING

Problem	Possible Cause	Solution
Drawers/Doors do not soft-close properly.	Obstruction in the slide/hinge; mechanism misalignment; excessive weight.	Check for obstructions. Ensure drawers/doors are correctly aligned. Reduce weight if overloaded.
Water spots or stains on sink.	Hard water deposits; residue from toiletries.	Clean regularly with mild soap and water. For hard water, use a vinegar solution followed by a rinse.
Vanity feels unstable or wobbly.	Uneven floor; loose leg connections; anti-tip device not installed.	Adjust the leveling feet at the bottom of the cabinet. Tighten all leg connections. Ensure the anti-tip device is securely installed to the wall.
Slow sink drainage.	Clogged drain; improper plumbing connection.	Clear any debris from the drain. Consult a plumber if the issue persists after clearing the drain.

SPECIFICATIONS

Feature	Detail
Overall Product Dimensions	59.1" W x 19.75" D x 34" H
Cabinet Base Dimensions	57.5" L x 19" W x 32" H
Sink Top Dimensions	59.1" W x 19.75" D x 7.00" H
Cabinet Material	MDF + Pine
Handle Material	Zinc Alloy
Finish	Painted Finish
Mounting Type	Freestanding
Sink Type	Resin Double Sinks
Faucet Compatibility	8" Widespread Faucets (not included)
Weight Capacity - Each Drawer	20 lbs
Weight Capacity - Bottom Panel (Cabinet)	30 lbs
Weight Capacity - Cabinet Top	100 lbs
Weight Capacity - Each Door Shelf	10 lbs
Model Number	N759S351759K-MZJ
UPC	195358869291

High-Quality Materials

Open-Back Design



for Hassle-Free Plumbing Setup



Figure 6: High-Quality Materials and Open-Back Design

Unit:inch

Basin Size

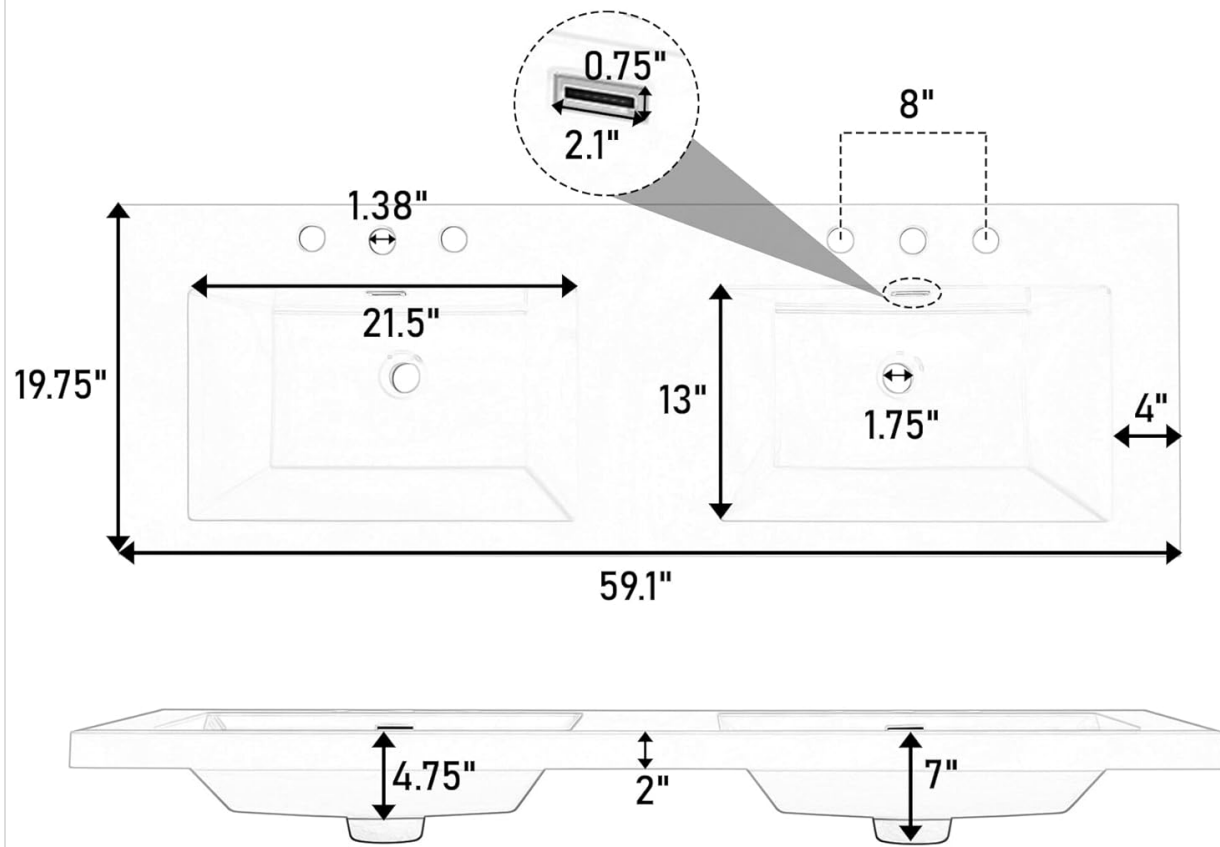

Figure 7: Sink Dimensions

WARRANTY INFORMATION

This product is covered by a manufacturer's warranty against defects in materials and workmanship. Please refer to the warranty card included with your product packaging for specific terms, conditions, and duration. Keep your proof of purchase for warranty claims.

CUSTOMER SUPPORT

For assistance with assembly, missing parts, or any other inquiries regarding your Flieks bathroom vanity, please contact our customer support team. Contact information can typically be found on the product packaging or on the official Flieks website.

Please have your model number (N759S351759K-MZJ) and proof of purchase ready when contacting support.