

Baseus Picogo AG11

Baseus Picogo AG11 45W Universal Travel Adapter Instruction Manual

Model: Picogo AG11

1. PRODUCT OVERVIEW

The Baseus Picogo AG11 is a 45W 6-in-1 universal travel adapter designed for global compatibility. It features 4 different plug types (Type C/A/G/I) to connect in over 200 countries and regions, including Europe, Asia, USA, and Australia. This compact adapter simplifies your charging needs by consolidating multiple plug types into one device.



Image: The Baseus Picogo AG11 adapter showcasing its adaptability with different plug configurations for EU/KR, UK, USA/JP, and AUS/CN regions, highlighting its universal design.

2. SETUP AND PLUG SELECTION

To select the appropriate plug type, use the sliders on the side of the adapter. Push the slider corresponding to your region (EU, USA/AUS, UK) to extend the correct prongs. Ensure the prongs are fully extended before inserting into a wall outlet.

The universal AC socket on the front accepts various global plug types for your devices. Additionally, a side 2-prong outlet is available for US/Japan plugs.

All-in-One Travel Adapter

Works in 200+ countries and regions.

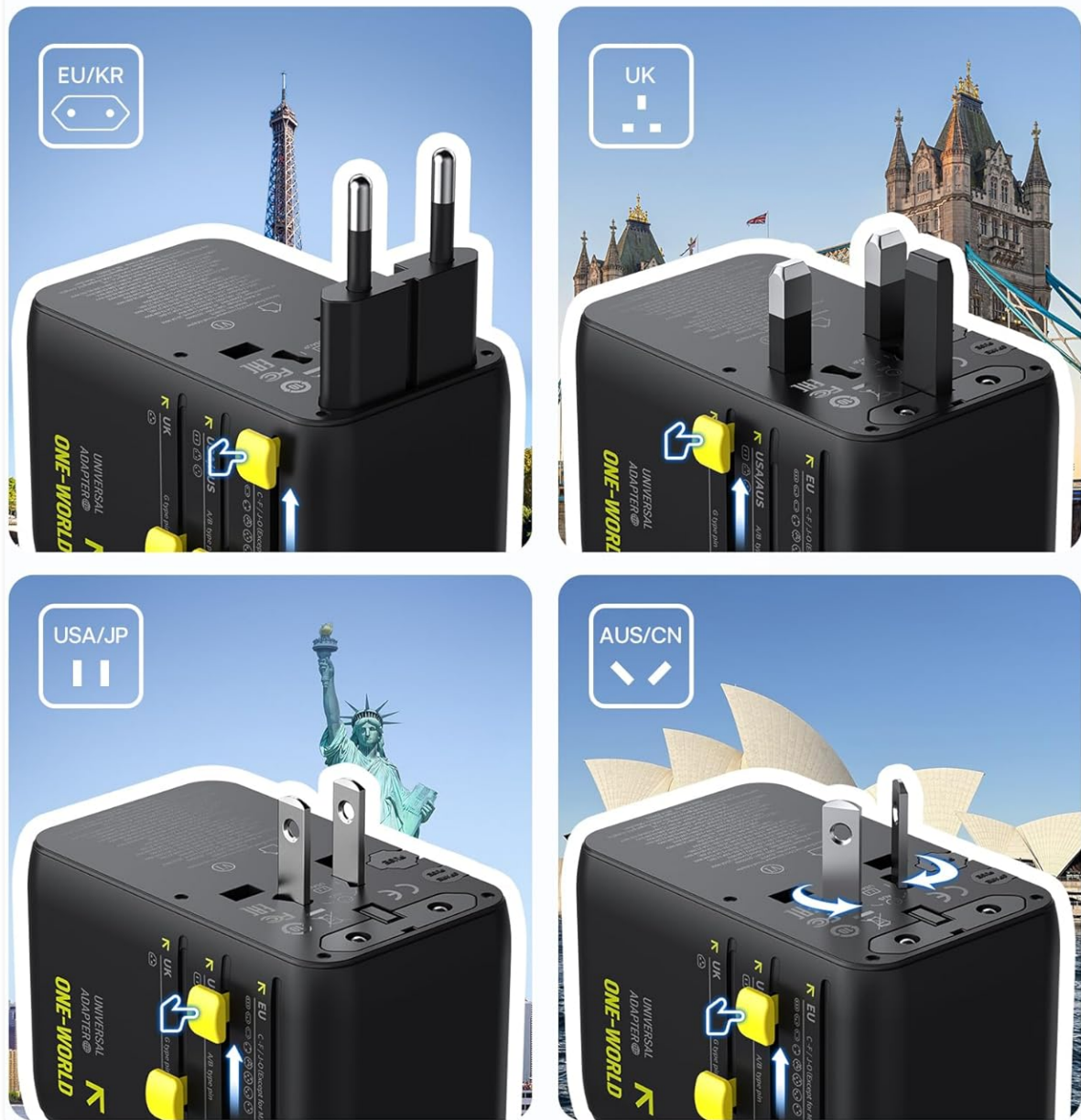

Image: A detailed view of the adapter's side, illustrating the sliders used to deploy the correct plug prongs for different international standards.

3. OPERATING INSTRUCTIONS

3.1 Multi-Device Charging

The Baseus Picogo AG11 allows simultaneous charging of up to 6 devices. It features a universal AC socket, a built-in 45W retractable USB-C cable, two USB-A ports, and one additional USB-C port.

Charge Up to 6 Devices at Once



Image: The adapter connected to a wall outlet, actively charging a laptop, smartphone, smartwatch, and earbuds, demonstrating its 6-in-1 multi-device charging capability.

3.2 Retractable USB-C Cable

The adapter includes a built-in 45W Max retractable USB-C cable, braided for durability. Pull the cable gently to extend it (up to 27 inches) and pull again to retract it for storage. This eliminates the need for carrying extra cables.

45W Fast Charging Retractable Cable



Image: The retractable USB-C cable extended from the adapter, showing its braided texture and maximum length, emphasizing its convenience.

3.3 Power Output Details

The power output varies depending on the number of ports in use:

- **Single-Port Output:** USB-C1 (retractable cable) up to 45W Max; USB-C2 up to 15W Max; USB-A1/A2 up to 12W Max.
- **Dual-Port Output:** Combinations like USB-C1 + USB-C2/USB-A1/USB-A2 can deliver up to 35W Max (e.g., 20W + 15W).
- **Three-Port Output:** Combinations like USB-C1 + USB-C2 + USB-A1/A2 can deliver up to 35W Max (e.g., 20W + 15W).
- **Four-Port Output:** USB-C1 + USB-C2 + USB-A1 + USB-A2 can deliver up to 35W Max (e.g., 20W + 15W).

The universal AC socket supports a maximum power of 1250W at 125V AC (10A in US) and 2500W at 250V AC (10A in EU).

Video: An official product video from Baseus Brand Store demonstrating the features and usage of the 45W 6-in-1 Universal Travel Plug Adapter, including its various plug types and charging capabilities.

4. SAFETY FEATURES

The Baseus Picogo AG11 is built with multiple safety protections to ensure secure charging:

- **2x10A Overload Fuses:** Automatic power off during overload to protect your devices.
- **Fireproof Shell:** Constructed with effective fire-resistant materials.
- **GaN6 Material:** Boosts charging efficiency and safety while maintaining a smaller size.
- **Indicator Light:** Shows operational status without disturbing your rest.
- **Additional Protections:** Includes over-power protection, over-voltage protection, short-circuit protection, overheating protection, and shock-resistant design. It is also cruise-friendly.



Image: An exploded view diagram of the adapter, detailing its internal components and safety mechanisms like 2x10A overload fuses, fireproof shell, GaN6 material, and an indicator light.

5. SPECIFICATIONS

Feature	Detail
Product Dimensions	2 x 1 x 2.5 inches
Item Weight	9.2 ounces
Item Model Number	E0307F
Brand	Baseus
Color	Black
Input Voltage	100-250V, 50/60Hz

Output Voltage	5 Volts (USB ports)
Max AC Rated Power	2500W
Max AC Rated Current	10.0A

6. TROUBLESHOOTING AND IMPORTANT NOTES

- **Not a Voltage Converter:** This travel adapter is NOT a voltage converter. It cannot convert AC voltages; it only adapts plug types. Ensure your electronic appliances support the local voltage (100-250V, 50/60Hz) before using the AC Outlet to prevent damage.
- **Laptop Charging:** For optimal laptop charging, use the universal AC outlet. While USB-C ports can charge some laptops, the AC outlet provides a better charging experience for higher power demands.
- **Overload Protection:** If the adapter stops working, check the overload fuses. The device includes 2x10A replacement fuses for convenience.

7. MAINTENANCE

- Keep the adapter clean and dry. Avoid exposure to moisture or extreme temperatures.
- Do not attempt to disassemble or repair the adapter yourself. Refer to qualified service personnel if needed.
- Store in a cool, dry place when not in use.

8. WARRANTY AND SUPPORT

For warranty information, technical support, or any product-related inquiries, please refer to the official Baseus website or contact their customer service directly. Details can typically be found on the product packaging or the manufacturer's official online channels.