

Manuals+

[Q & A](#) | [Deep Search](#) | [Upload](#)

manuals.plus /

> [CYKOV](#) /

> [CYKOV Ergonomic Office Chair with Footrest - Instruction Manual for Model CY59KT-AU](#)

CYKOV CY59KT-AU

CYKOV Ergonomic Office Chair with Footrest

MODEL: CY59KT-AU

User Instruction Manual

1. Introduction

Thank you for choosing the CYKOV Ergonomic Office Chair with Footrest. This manual provides essential information for the safe and efficient assembly, operation, and maintenance of your new chair. Designed for optimal comfort and support, this chair features multiple adjustment systems to enhance your work, gaming, or relaxation experience.

2. Important Safety Information

Please read and understand all instructions before assembly and use. Keep this manual for future reference.

- Always assemble the chair according to the provided instructions.
- Do not exceed the maximum weight recommendation of 330 pounds.
- Keep the chair away from heat sources and sharp objects to prevent damage to the material.
- Ensure all screws and bolts are tightened securely before use. Periodically check and re-tighten if necessary.
- Avoid standing on the chair or using it as a step stool.

3. Package Contents

Before beginning assembly, ensure all components are present and undamaged. Refer to the included assembly instructions for a detailed list of parts and hardware.



Image: All components of the CYKOV Ergonomic Office Chair laid out for assembly, including the seat, backrest, headrest, armrests, base, wheels, and hardware.

4. Assembly Instructions

Your CYKOV office chair is designed for straightforward assembly. An Allen wrench and all necessary hardware are included. For detailed step-by-step instructions, please refer to the separate assembly manual provided in the packaging.

General Assembly Steps:

1. Attach the wheels to the chair base.
2. Insert the gas lift cylinder into the center of the base.
3. Secure the mechanism plate to the underside of the seat cushion.
4. Attach the backrest to the seat cushion.
5. Install the armrests to the sides of the seat.
6. Mount the headrest to the top of the backrest.
7. Place the assembled seat onto the gas lift cylinder.

5. Operating Adjustments

Your CYKOV chair offers multiple adjustments for personalized comfort.

5.1. Seat Height Adjustment

To adjust the seat height, pull the lever located on the right side of the seat upwards while applying or releasing body weight. The chair offers a 4-inch height lift to fit various desk heights.

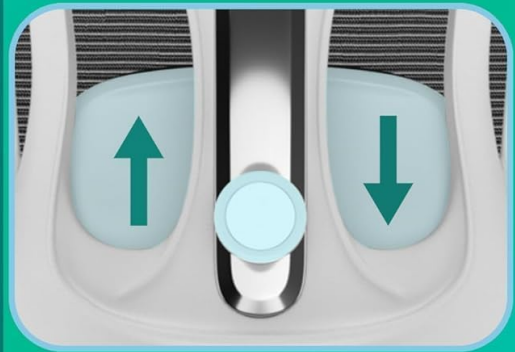

Image: The chair's height adjustment lever and a visual representation of its 360-degree swivel capability.

5.2. Lumbar Support Adjustment

The chair features a 2-way lumbar support system. Use the knob on the backrest to adjust the depth (1.18 inches) and height (2 inches) of the lumbar support to perfectly hug your lower back.

Height & Depth Adjustable Lumbar Support



2" height adjustable for comfort.

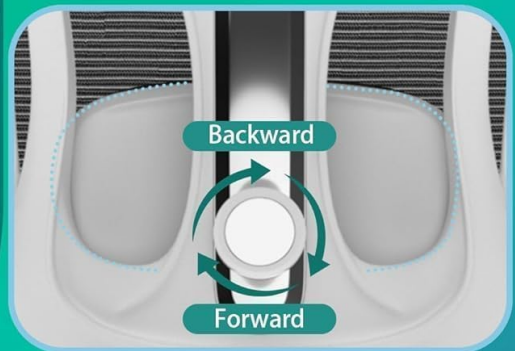

1.18" depth adjustable lumbar support.

Image: A detailed view of the chair's adjustable lumbar support mechanism, showing controls for height and depth.

5.3. Headrest Adjustment

The headrest offers 4.72 inches of height adjustment and a 60° swivel. Press the buttons on the sides of the headrest to slide it up or down, and pivot it to find your ideal neck and head support.

Design for Your Comfort



Height Adjustable &
Rotatable Headrest



Warm-Hearted
Hanger Design



Linked Armrest

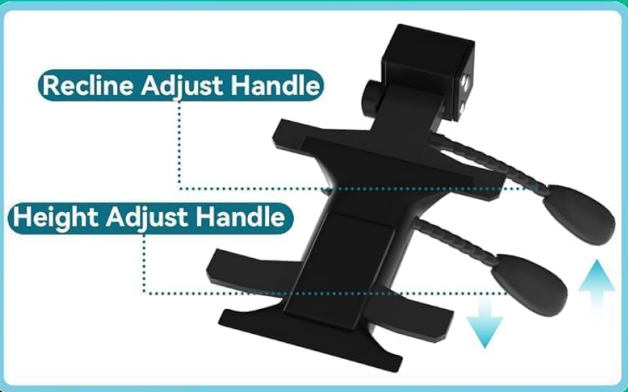

Image: The chair's headrest demonstrating its height and angle adjustment capabilities.

5.4. Armrest Adjustment

The armrests can be adjusted in height and can also slide forward/backward and pivot inward/outward. They also feature a flip-up design, allowing you to push the chair closer to your desk or customize your seating position.

4" Height Adjustable Rolling Office Chair



- ✓ Lifting between 20"-24"
- ✓ 360° of free rotation



Image: The chair's armrests illustrating their height adjustment and pivot functionality.

5.5. Recline and Footrest

The chair reclines from 90° (work mode) to 160° (nap mode) with lockable angles. Pull the lever on the left side of the seat outwards to recline, and push it inwards to lock the desired angle. The retractable footrest can be pulled out and extended to transform your chair into a comfortable lounging position.

Breathable Mesh Design

Comfy for the whole day



High-density,
Responsive Foam

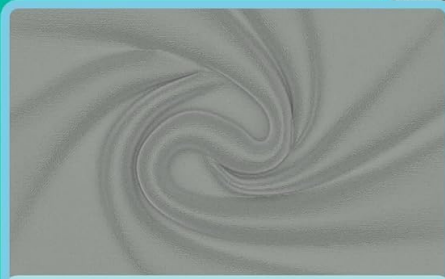

Skin-friendly,
Breathable Mesh Back



Image: The CYKOV chair fully reclined with its footrest extended, demonstrating a comfortable lounging position.

5.6. Breathable Mesh and Seat Cushion

The chair features a skin-friendly, breathable mesh back for optimal airflow, preventing heat buildup. The seat cushion is made with high-density foam for lasting comfort and support.

Stable and Durable



Planks

Blanket

Tile



SGS-certified Gas Lift



Safety and Stability
Supports up to 300lbs
for stability.

Image: A close-up view highlighting the breathable mesh material of the backrest and the high-density foam of the seat cushion.

5.7. Built-in Hanger

A convenient built-in hanger is located on the back of the chair, perfect for hanging jackets, headsets, or bags to keep your workspace tidy.

5.8. Product Videos

Video: This video demonstrates the various ergonomic adjustments and features of the CYKOV Comfy Ergonomic Office Desk Chair with Footrest, including the headrest, lumbar support, armrests, recline function, and footrest.

Video: This video showcases the ergonomic design and home office suitability of the CYKOV Ergonomic Home Office Desk Chair with Footrest, highlighting its comfort and adjustability.

6. Maintenance

To ensure the longevity and performance of your CYKOV office chair, follow these maintenance guidelines:

- **Cleaning:** Wipe mesh and foam surfaces with a damp cloth and mild soap. Avoid harsh chemicals that may damage the materials.

- **Inspection:** Periodically check all screws and bolts to ensure they are tight. Re-tighten if any looseness is detected.
- **Moving Parts:** Keep moving parts (wheels, gas lift) free from dust and debris to ensure smooth operation.

7. Troubleshooting

If you encounter any issues with your chair, please refer to the following common solutions:

- **Chair not adjusting height:** Ensure the gas lift lever is fully engaged and that there are no obstructions.
- **Squeaking noises:** Check and tighten all assembly screws. Lubricate moving parts if necessary.
- **Chair feels unstable:** Verify that all components are correctly assembled and tightened according to the instructions.

For further assistance, please contact customer support.

8. Specifications

Feature	Detail
Brand	CYKOV
Model Name	home office chair
Item Model Number	CY59KT-AU
Color	Light Grey
Product Dimensions	22"D x 20"W x 40"H
Maximum Weight Recommendation	330 Pounds
Material	Nylon, Foam
Back Style	Mesh Back
Special Feature	Adjustable Height, Lumbar Support, Headrest, Reclining, Footrest
Reclining Position Count	3 (90°-160°)
Item Weight	28.6 pounds

9. Warranty & Support

Your CYKOV Ergonomic Office Chair is backed by a **5-Year Warranty**. We stand behind our product and are committed to ensuring your satisfaction. For any quality issues or support needs, please contact our customer service team.

Customer Support: Please refer to the contact information provided on your warranty card or product packaging for assistance.
