

Nunoo 8 Core 4+32G

Nunoo Android 13 Car Radio User Manual

Model: 8 Core 4+32G | Compatible with Ford F150/F250/F350 (2004-2014)

1. INTRODUCTION

This manual provides detailed instructions for the installation, operation, and maintenance of your Nunoo Android 13 Car Radio. Please read this manual thoroughly before using the product to ensure proper functionality and safety. Keep this manual for future reference.

2. PRODUCT OVERVIEW

The Nunoo Android 13 Car Radio is an advanced infotainment system designed to upgrade your vehicle's audio and connectivity. Featuring an 8-core processor, 4GB RAM, and 32GB ROM, it offers smooth performance and extensive functionality.

Key Features:

- **Operating System:** Android 13
- **Processor:** 8-Core CPU
- **Memory:** 4GB RAM + 32GB ROM
- **Display:** 7-inch 1024x600 IPS Touchscreen
- **Connectivity:** Wireless CarPlay, Android Auto, Mirror Link, Bluetooth 5.2, Wi-Fi, USB
- **Audio:** AM/FM/RDS Radio, 32-band EQ, DSP, Subwoofer support
- **Navigation:** Online/Offline GPS Navigation
- **Additional:** Backup Camera support, Steering Wheel Control (SWC) compatibility

Compatibility:

This car radio is compatible with the following Ford models:

- Ford F150 (2004-2008)
- Ford F250/F350 (2006-2014)
- Ford E250/E350 (2009-2014)
- Shelby GT500 (2007-2009)
- Five Hundred/Montego (2005-2007)

- Milan (2006-2009)
- Sable (2008-2009)
- Mountaineer (2007-2010)
- Fusion (2006-2009)
- Taurus (2008-2009)
- Escape (2008-2012)
- Freestyle (2005-2007)
- Freestar (2004-2007)
- MKX (2007-2009)
- Mark LT (2006-2008)
- Edge (2007-2010)
- Focus (2005-2007)
- Mustang (2005-2009)
- Explorer (2006-2010)
- Expedition/MAX (2007-2014)

Note:

Please ensure your OEM radio matches the provided photos for proper fitment. It is not suitable for installation if your car radio plug is the same as shown on the left in the compatibility image.

Ford F150/F250/F350 2004-2014

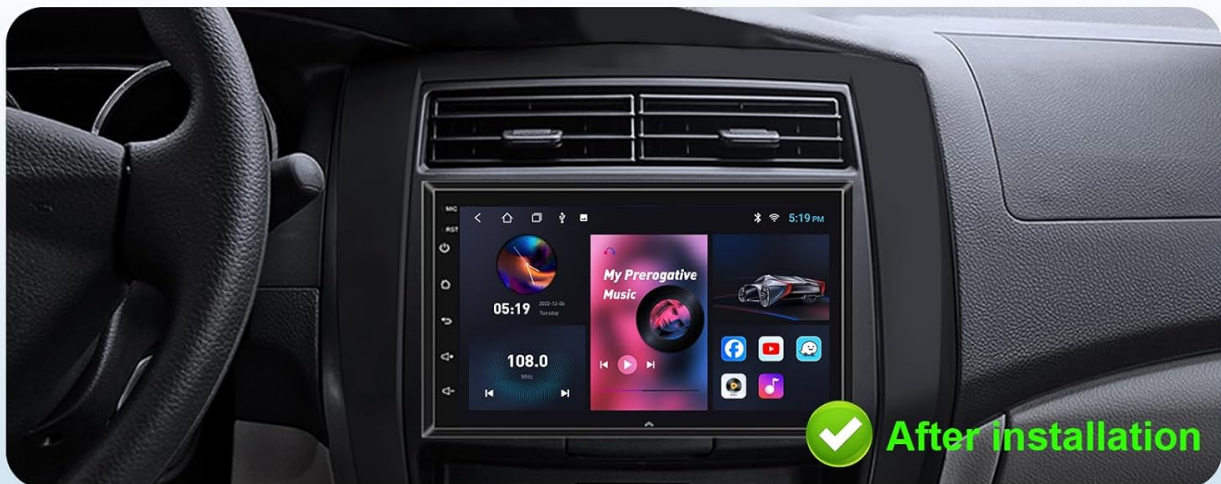

Ford F150 (2004-2008)
F250/F350 (2006-2014)
E250/E350 (2009-2014)
Shelby GT500(2007-2009)
Five Hundred/Montego (2005-2007)
Freestyle (2005-2007)
Freestar (2004-2007)



Milan (2006-2009)
Sable (2008-2009)
Mountaineer (2007-2010)
Fusion (2006-2009)
Taurus (2008-2009)
Escape (2008-2012)
MKX (2007-2009)

Mark LT (2006-2008)
Edge (2007-2010)
Focus (2005-2007)
Mustang (2005-2009)
Explorer (2006-2010)
Expedition/MAX (2007-2014)

Image: Nunoo Android 13 Car Radio after installation in a Ford F-Series dashboard, demonstrating a seamless fit.



Image: Visual guide for Ford F-Series compatibility, showing OEM radio units and the Nunoo radio post-installation.

Included Components:

- Car Radio with Frame
- Rear View Camera
- Cables (Power Cable, RCA Cable, USB Cables, Rear View Input, GPS Antenna)
- User Manual
- 24H Pre-sales and After-sales Support information

Accessories

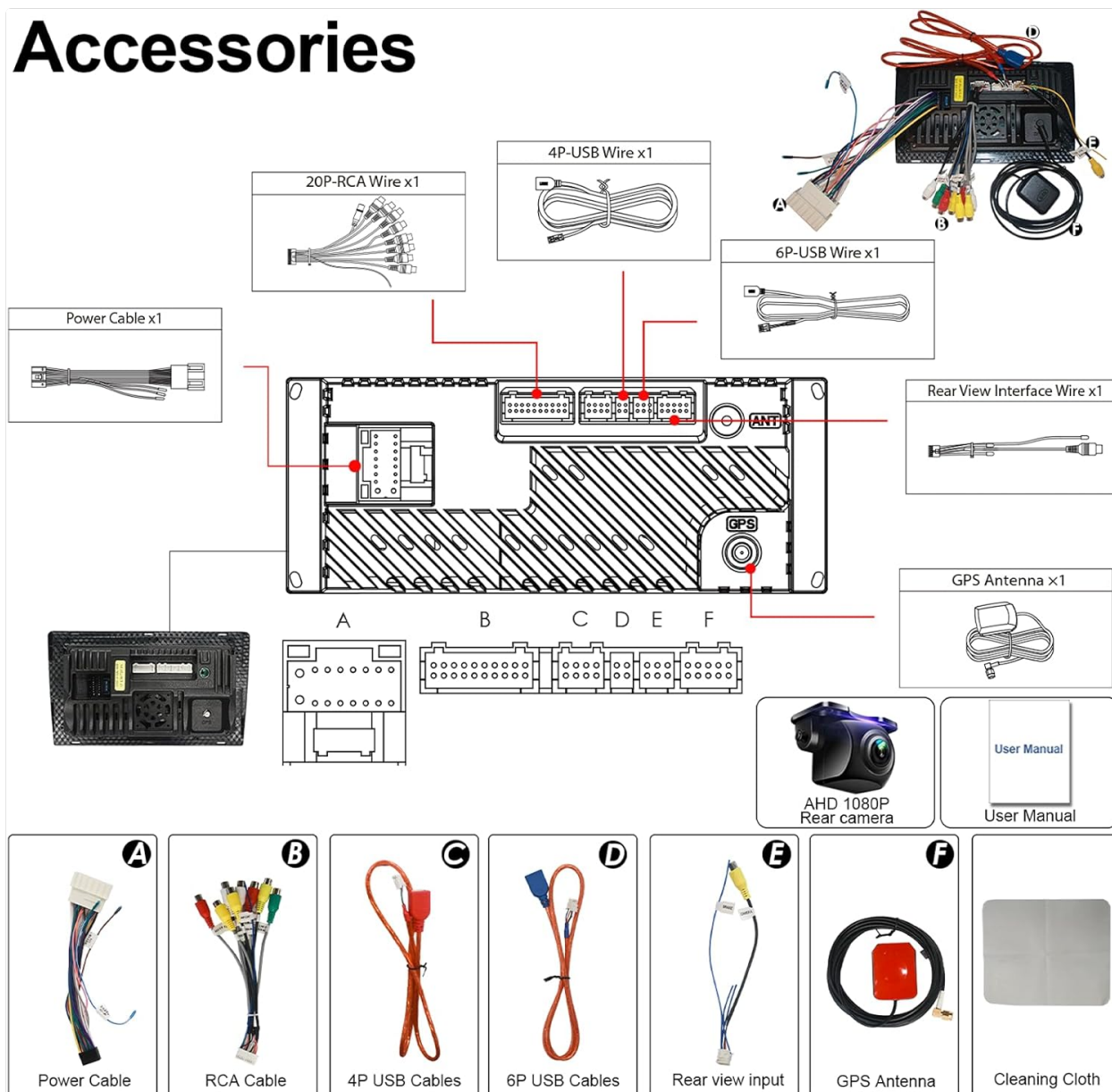

Image: A comprehensive layout of all accessories included with the Nunoo Android 13 Car Radio.

3. SETUP & INSTALLATION

Follow these steps carefully for proper installation of your car radio. Professional installation is recommended if you are unfamiliar with car audio wiring.

3.1 General Installation Steps:

- 1. Remove OEM Radio:** Carefully remove the existing radio and dashboard trim. Use appropriate pry tools to avoid damage.
- 2. Install Mounting Frame:** Attach the provided mounting frame to the car's dashboard opening.
- 3. Connect Wiring Harness:** Connect the main power and speaker harnesses from the vehicle to the corresponding connectors on the new car radio. Ensure all connections are secure.
- 4. Connect Antennas:** Connect the GPS antenna and radio antenna to the designated ports on the car radio.
- 5. Test Functionality:** Before fully reassembling the dashboard, perform a basic test of the radio's functions (power, audio, touch screen).

6. **Reassemble Dashboard:** Once all connections are verified and tested, carefully reassemble the dashboard trim and secure the car radio in place.

3.2 Rear View Camera Connection:

Connecting the rear view camera involves specific wiring to ensure it activates correctly when reversing.

1. **Connect RCA Cable:** Connect the yellow RCA interface of the camera extension cable to the 'CAM IN' port on the car radio.
2. **Connect Power Wires:** The red wire from the camera power cord should be connected to the positive terminal of the car's tail light wire. The black wire from the camera power cord should be connected to a ground wire (e.g., a metal bolt on the car frame).
3. **Connect Reverse Detection Wire:** The red wire from the camera extension cord needs to be connected to the reverse detection wire of the main unit. This wire is typically pink or brown, depending on the car model. Refer to the wiring diagram for exact pin location (usually pin '3' on the main power cord).



New Generation
Super Processor Faster Touch Screen IPS
1024*600 resolution IPS touch screen car audio-clearer picture, smoother speed and more vivid colors

Image: Wiring diagram for connecting the rear view camera to the car radio system.

Your browser does not support the video tag.

Video: Demonstrates the wiring process for the rear view camera, including connecting the RCA, power, and reverse detection wires.

Your browser does not support the video tag.

Video: Step-by-step guide on how to install the car radio for Ford F150/F250/F350 models.

Your browser does not support the video tag.

Video: Provides detailed directions for connecting the wiring harness during installation.

4. OPERATING INSTRUCTIONS

This section covers the basic and advanced operations of your Nunoo Android 13 Car Radio.

4.1 Power On/Off & Basic Navigation:

Press the power button on the unit to turn it on or off. Navigate through the main interface by tapping icons on the 7-inch IPS touchscreen.

4.2 Wireless CarPlay & Android Auto:

Connect your smartphone wirelessly or via USB to access CarPlay or Android Auto. This allows for seamless integration of navigation, music, calls, and messages directly on the car radio display.



Image: The car radio display showcasing Wireless CarPlay, Android Auto, and Mirror Link functionalities.

Your browser does not support the video tag.

Video: Demonstrates how to connect your smartphone to the car radio for CarPlay functionality.

4.3 Mirror Link:

Mirror Link allows you to project your smartphone screen onto the car radio display, enabling access to apps and content directly from your phone.

Your browser does not support the video tag.

Video: Shows the process of using Mobile Mirror Link to display your phone's screen on the car radio.

4.4 Audio Settings (AM/FM/RDS, EQ, DSP, Subwoofer):

Access the audio settings to customize your listening experience. The 32-band equalizer (EQ) and Digital Signal Processing (DSP) allow for fine-tuning of sound. The AM/FM/RDS radio allows you to store and listen to various stations.

FM/AM/RDS/32EQ/Subwoofer

Dynamic sound with high-fidelity brings you professional sound experience



Image: The car radio's audio interface, displaying 32-band EQ and subwoofer settings for a personalized sound experience.

4.5 Bluetooth Functionality:

Pair your mobile phone via Bluetooth 5.2 for hands-free calling and music streaming. The system supports automatic connection after initial setup.



Bluetooth Hands-free Call

Control Bluetooth hands-free calls by using the steering wheel to make and answer them. After initial set-up, Bluetooth connects automatically next time.



Transmission rate:
Increased by

50%

Signal stable:
Strengthened by

70%

Bluetooth 5.4

Image: Illustration of Bluetooth hands-free calling, showing the phone interface on the car radio and improved Bluetooth 5.4 performance.

4.6 GPS Navigation:

Utilize online or offline GPS navigation through pre-installed maps or downloaded applications like Waze. The 7-inch IPS touchscreen provides clear and responsive map displays.



Image: The car radio displaying GPS navigation alongside various popular applications available for download.

4.7 Customizing Buttons and Themes:

The car radio allows for customization of physical buttons and digital themes to personalize your user experience.

Your browser does not support the video tag.

Video: Guide on how to customize the single key button shortcut functions on the car radio.

Your browser does not support the video tag.

Video: Demonstrates how to adjust touch button settings on the car radio interface.

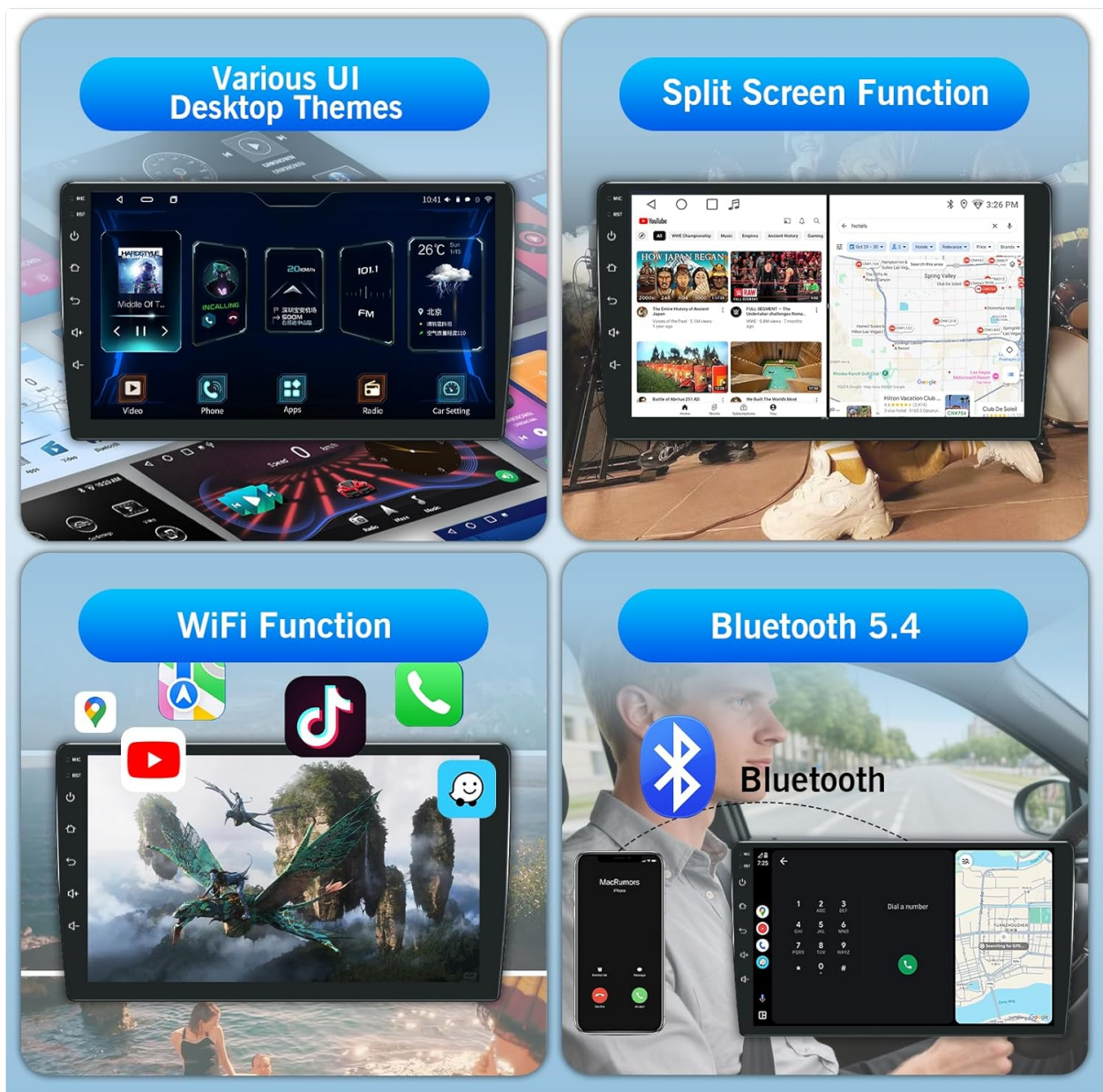

Image: The car radio interface showcasing different UI desktop themes and the split-screen feature.

5. MAINTENANCE

To ensure the longevity and optimal performance of your Nunoo Android 13 Car Radio, follow these maintenance guidelines:

- **Cleaning:** Use a soft, dry cloth to clean the touchscreen and unit. Avoid abrasive cleaners or solvents that may damage the screen or finish.
- **Software Updates:** Periodically check for software updates to ensure you have the latest features and bug fixes. Refer to the manufacturer's website or support channels for update instructions.
- **Temperature Control:** Avoid exposing the unit to extreme temperatures. The built-in small cooling fan automatically adjusts to regulate temperature.
- **Cable Integrity:** Regularly inspect all connected cables for any signs of wear or damage. Ensure connections remain secure.

6. TROUBLESHOOTING

If you encounter any issues with your car radio, refer to the following common troubleshooting tips:

- **No Power:**
 - Check all power connections to ensure they are securely plugged in.
 - Verify the car's fuse related to the radio is not blown.
- **No Sound:**
 - Check speaker wiring connections.
 - Ensure the volume is not muted or set too low.
 - Verify audio settings (EQ, DSP) are configured correctly.
- **CarPlay/Android Auto Not Connecting:**
 - Ensure Bluetooth and Wi-Fi are enabled on your smartphone.
 - Try reconnecting the USB cable or re-pairing Bluetooth.
 - Restart both the car radio and your smartphone.
- **Rear View Camera Not Displaying:**
 - Check the RCA video input and the reverse detection wire connection.
 - Ensure the camera is receiving power from the tail light.
- **Touchscreen Unresponsive:**
 - Restart the unit.
 - Ensure the screen is clean and free from debris.

For persistent issues, please contact customer support.

7. SPECIFICATIONS

Feature	Specification
Operating System	Android 13
CPU	8-Core
RAM	4GB
ROM	32GB
Screen Size	7 Inches
Screen Resolution	1024x600 IPS
Bluetooth Version	5.2
EQ Settings	32-band

Connectivity	Bluetooth, USB, Wi-Fi
Audio Output Mode	Stereo
Item Weight	2.7 pounds
Package Dimensions	11.8 x 7.6 x 3.3 inches

8. WARRANTY AND SUPPORT

Your Nunoo Android 13 Car Radio comes with a standard warranty. For specific warranty details, please refer to the documentation included in your product packaging.

For technical support, installation assistance, or any inquiries, please contact Nunoo customer service. You can typically find contact information on the manufacturer's website or through the retailer where you purchased the product.

How to reach us for installation & technical support?

STEP 1

In Stock

Quantity: 1

[Add to Cart](#)

[Buy Now](#)

Ships from **Amazon**

Sold by **NUNOO**

Returns Eligible for return within 30 days of receipt

Support Product support included

Step 1 Click "NUNOO"

Step 2 Click "Ask a question"

Step 3 Please send us pictures or videos of the technical or installation questions you met. Then we will get back to you as soon as possible.

STEP 2

Seller

Visit the **Seller** storefront

★★★★★ | 100% positive in the last 12 months (15 ratings)

About Seller

Seller is committed to providing each customer with the highest standard of customer service.

Have a question for Seller ?

[Ask a question](#)

Image: Guide on how to access installation and technical support by contacting the seller.