

## GOFEI SZ411141Y-US10165

# GOFEI Black Barber & Beauty Salon Station

Model: SZ411141Y-US10165

Instruction Manual

## INTRODUCTION

This manual provides detailed instructions for the assembly, operation, and maintenance of your GOFEI Black Barber & Beauty Salon Station. Please read this manual thoroughly before assembly and use to ensure proper function and longevity of the product. Keep this manual for future reference.

## SAFETY INFORMATION

- Always assemble the unit on a clean, flat, and stable surface to prevent damage or injury.
- Ensure all screws and fasteners are securely tightened before use. Periodically check and re-tighten as necessary.
- Do not overload drawers or shelves. Distribute weight evenly to maintain stability.
- Keep small parts and hardware away from children to prevent choking hazards.
- Use caution when handling heated styling tools. Always place them in the designated alloy sleeves to prevent heat damage to the station.
- Avoid exposing the unit to excessive moisture or direct sunlight.

## PACKAGE CONTENTS

Before beginning assembly, verify that all parts listed below are present and undamaged. If any parts are missing or damaged, please contact customer service.

- All necessary wooden panels (labeled with letters for easy identification).
- Hardware kit (screws, cam locks, dowels, drawer slides, handles, keys for lockable drawer).
- Assembly instructions manual.
- Basic assembly tools (screwdriver).

## SETUP AND ASSEMBLY

Follow the step-by-step instructions provided in the included manual and refer to the assembly video for visual guidance. Ensure you have ample space for assembly.

1. **Unpack and Identify Parts:** Carefully remove all components from the packaging. Lay them out on a soft, clean surface. Match each wooden panel to its corresponding letter in the instruction manual. Separate all hardware components.
2. **Assemble Base Structure:** Begin by attaching the side panels to the bottom and top panels using the provided cam locks and dowels. Ensure all connections are secure.
3. **Install Drawer Slides:** Attach the drawer slides to the designated panels using the appropriate screws. Pay attention to the orientation of the slides.
4. **Construct Drawers:** Assemble the drawer boxes. Attach the drawer fronts, handles, and the lock mechanism for the lockable drawer. Insert the assembled drawers into the slides.
5. **Attach Shelving Unit:** Secure the upper shelving unit to the main desktop section.
6. **Install Hot Tool Racks:** Place the alloy sleeves into the pre-drilled holes on the side extension for heated styling tools.
7. **Final Checks:** Once assembled, ensure all connections are tight and the unit is stable.

Your browser does not support the video tag.

**Video Description:** This video demonstrates the step-by-step assembly process for the GOFEI Black Barber & Beauty Salon Station, including unboxing, identifying parts, and securing components.



**Image:** Fully assembled GOFEI Black Barber & Beauty Salon Station, showcasing its multi-functional design with storage and workspace.

## OPERATING INSTRUCTIONS

The GOFEI Salon Station is designed for efficient organization and use of styling tools and products.

- **Drawers:** The station features four smooth-gliding drawers. One drawer is lockable for securing valuable items. Use the provided keys to lock and unlock.
- **Hot Tool Racks:** Three alloy sleeves are integrated into the design to safely hold heated items such as blow dryers, curling irons, and straighteners. These sleeves are heat-resistant to protect the station's surface.
- **Open Storage:** Utilize the three open storage compartments for frequently accessed items, decorative elements, or product displays.
- **Cabinet:** The lower cabinet provides additional enclosed storage for larger items or supplies.
- **Towel Rack:** A convenient towel rack is included for easy access to towels during services.

# Product Details



**2 circular cups:** Can be used to hold items such as straightening combs and other accessories

**1 heat-resistant circular ring:** Allows the hair dryer to be inserted safely

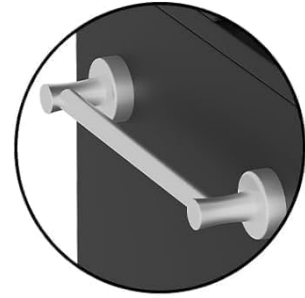

**towel rack:** Convenient Towel Access



**Lockable drawer:** Protects the safety of valuable items.

**Image:** Close-up view of the salon station's features, including heat-resistant alloy sleeves for tools, a convenient towel rack, and a lockable drawer.

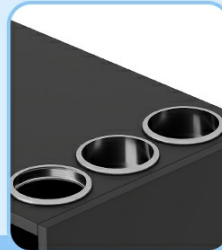

**Three heat-resistant storage compartments:** Help store items like hair dryers, straighteners, and other accessories.



**Lockable drawer:** Protects your valuable items and privacy.



**Towel rack:** Provides easy access to towels.

**Image:** Detailed view of the salon station's features, including three heat-resistant compartments, a lockable drawer for secure storage, and a towel rack for easy access.

## MAINTENANCE

Regular maintenance will help preserve the appearance and functionality of your salon station.

- **Cleaning:** The matte black PVC surface is waterproof and easy to clean. Wipe down surfaces with a soft, damp cloth and mild detergent. Avoid abrasive cleaners or harsh chemicals that may damage the finish.
- **Spills:** Promptly wipe up any spills to prevent staining or damage to the material.
- **Hardware:** Periodically check all screws and fasteners to ensure they remain tight. Re-tighten if necessary.
- **Heat Protection:** Always use the alloy sleeves for hot tools. Do not place hot tools directly on the station's surface.

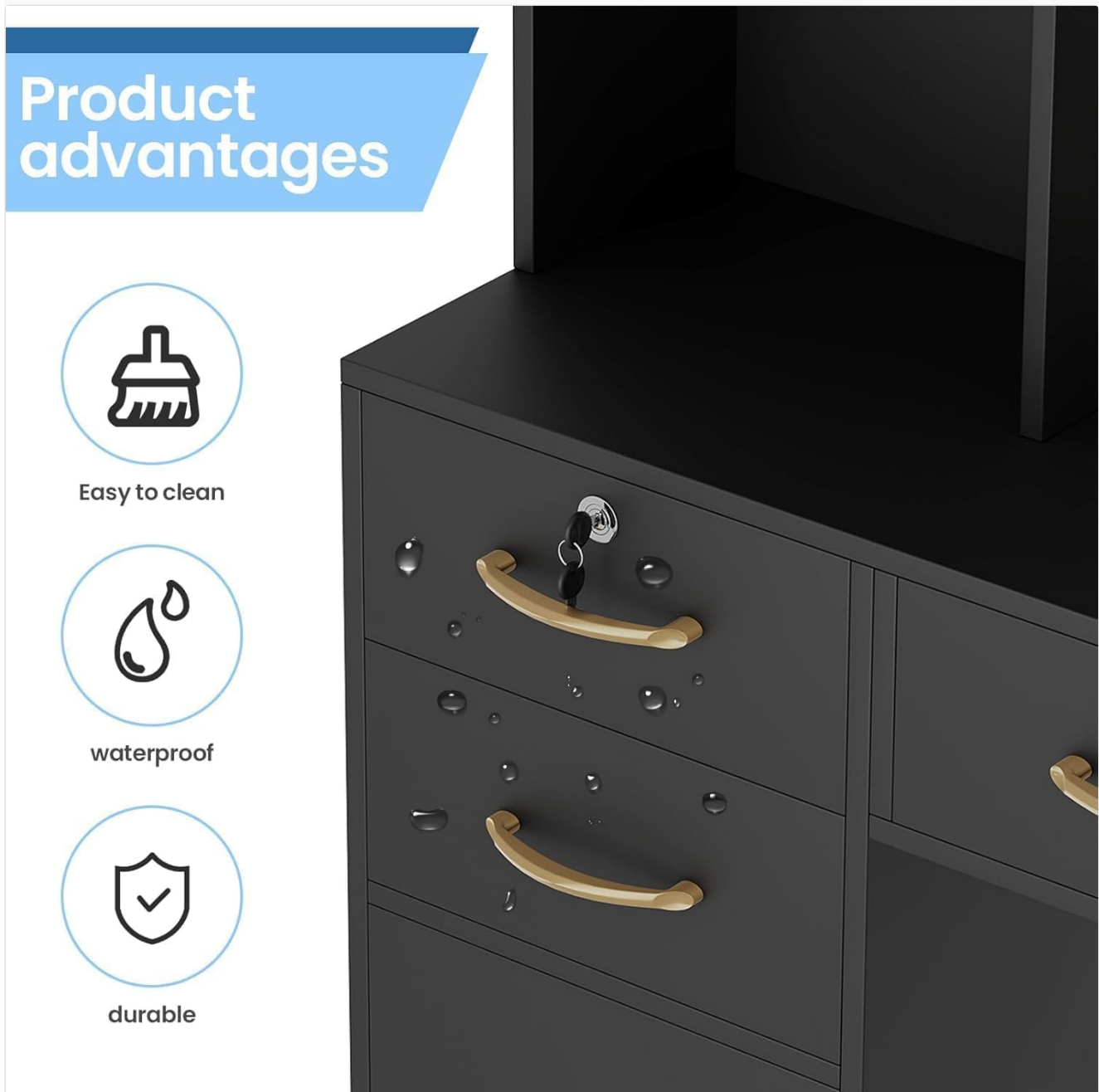

**Image:** Visual representation of the product's advantages: easy to clean, waterproof surface, and durable construction.

## TROUBLESHOOTING

If you encounter any issues with your salon station, refer to the following common solutions:

- **Wobbly Unit:** Ensure the unit is placed on a level surface. Check all assembly screws and cam locks for

tightness and re-tighten if loose.

- **Drawers Not Sliding Smoothly:** Verify that the drawer slides are correctly installed and free from obstructions. Apply a silicone-based lubricant to the slides if needed.
- **Lockable Drawer Issues:** Ensure the key is fully inserted and turned correctly. Check for any obstructions preventing the drawer from closing completely.
- **Surface Damage:** For minor scratches, a furniture repair marker matching the black finish may be used. For significant damage, contact customer service.

## SPECIFICATIONS

- **Model Number:** SZ411141Y-US10165
- **Brand:** GOFEI
- **Color:** Black
- **Material:** Engineered Wood (Thickened MDF with matte black PVC double-layer decorative surface)
- **Style:** Modern
- **Product Dimensions (Overall):** 13.77"D x 50.39"W x 69.29"H
- **Item Weight:** 77.8 pounds
- **Storage Features:** 3 open compartments, 4 drawers (1 lockable), 1 cabinet, 3 alloy hot tool sleeves, towel rack.
- **Assembly Required:** Yes
- **UPC:** 717839388192

# Product size

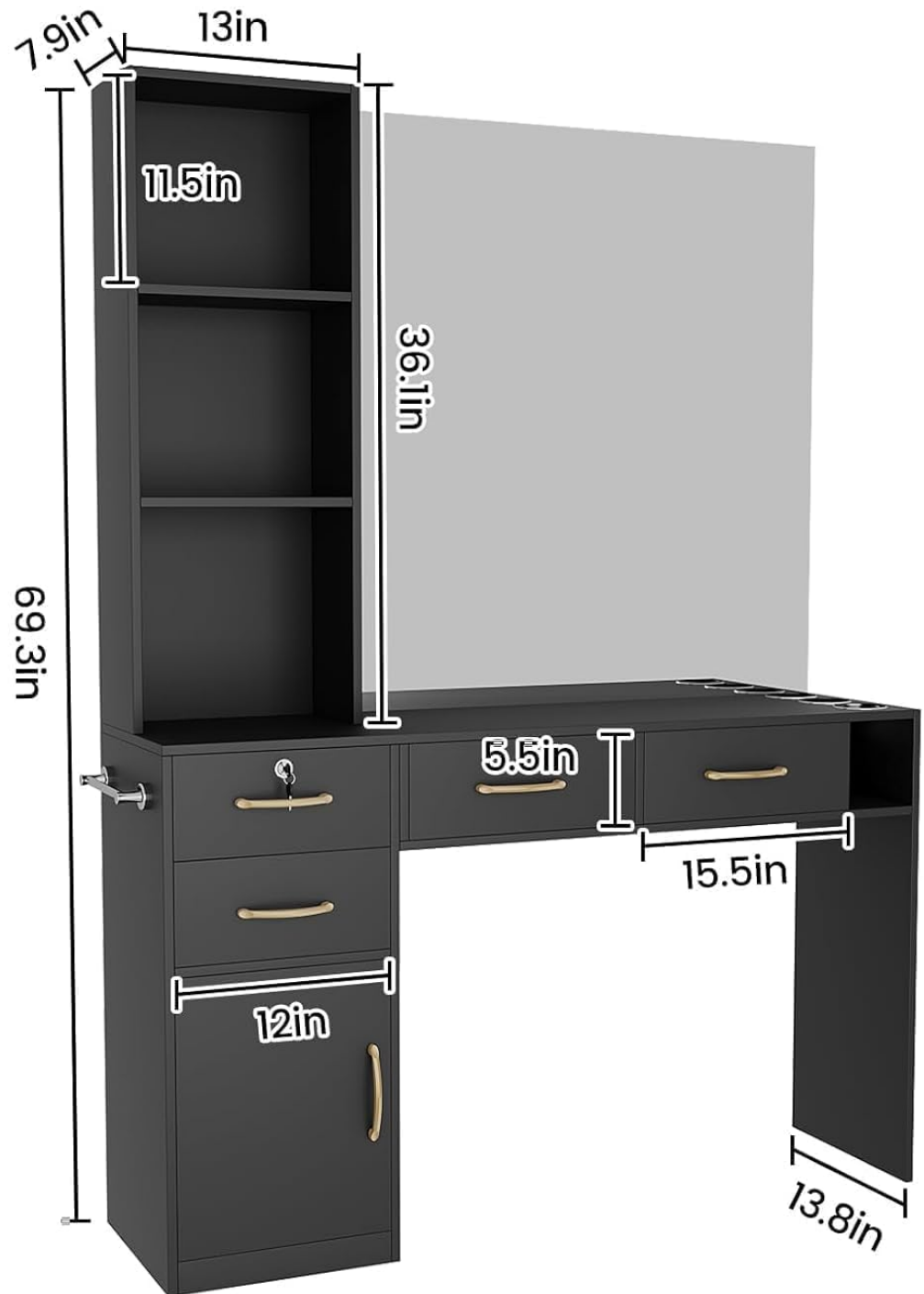

**Image:** Detailed dimensions of the GOFEL Black Barber & Beauty Salon Station, including height, width, and depth of various sections.

## WARRANTY AND CUSTOMER SUPPORT

This Barber Salon Station comes with all necessary parts and a detailed instruction manual for a quick and hassle-free assembly. If you have any questions, our customer service team will respond promptly to assist you and ensure a smooth experience. Please refer to your purchase documentation for specific warranty details.

For assistance, please contact GOFEL customer service through the retailer's platform or the contact information provided with your purchase.

