

NIVIAN NVS-TOUCHALARM-W

NIVIAN NVS-TOUCHALARM-W WiFi + GSM Alarm System User Manual

Model: NVS-TOUCHALARM-W | Brand: NIVIAN

1. PRODUCT OVERVIEW

The NIVIAN NVS-TOUCHALARM-W is an advanced WiFi and GSM 4G alarm system designed to provide comprehensive security for homes and businesses. It offers dual communication channels for reliable alerts and features a user-friendly touchscreen interface, wireless sensors, and mobile app control.

Key features include:

- **Dual Communication:** Connects via WiFi and GSM 4G for continuous security, ensuring notifications even during internet outages.
- **Instant Notifications:** Receive alerts via the TUYA app, SMS messages, and calls for intrusions, power failures, or internet loss.
- **Wireless Installation:** Easy setup with wireless opening sensors and PIR motion detectors, offering a range of up to 100 meters.
- **Intuitive Control:** Features a 7-inch touchscreen, remote control, and RFID key fobs for convenient arming and disarming.
- **Advanced Sensors:** Includes opening sensors, PIR presence detectors, and a tamper-proof outdoor siren, all compatible with Nivian kits.
- **False Alarm Immunity:** Environmental compensation technology minimizes false alarms.
- **Smart System:** Supports geolocating, voice control, multi-user access, and customizable arming modes (full, home, panic).
- **Backup Power:** Equipped with a backup battery for continued operation during power outages.



Figure 1: Core components of the NIVIAN NVS-TOUCHALARM-W alarm system, highlighting its WiFi, GSM, and RF capabilities, along with included accessories like the 115dB siren, 5000mAh battery, and wireless sensors.

2. SETUP AND INSTALLATION

2.1 Unpacking and Initial Setup

Carefully unpack all components. Ensure all items listed in the package contents are present. The main control panel and sensors are pre-paired for convenience. It is recommended to connect the control panel to power and allow the internal battery to charge fully before proceeding with further setup.

2.2 Wireless Sensor Installation

The system's sensors (opening sensors, PIR detectors) are completely wireless, simplifying installation. Position opening sensors on doors and windows, and PIR detectors in areas where motion detection is required. Ensure sensors are within the 100-meter wireless range of the main control panel. Avoid placing PIR sensors near heat sources or direct sunlight to prevent false alarms.

2.3 Control Panel Placement

The 7-inch touchscreen control panel can be placed on a desktop or mounted on a wall. Choose a central

location that is easily accessible for daily operation and where the WiFi and GSM signals are strong.



Figure 2: Rear view of the NIVIAN NVS-TOUCHALARM-W control panel, illustrating its design for easy wall mounting and connection points.

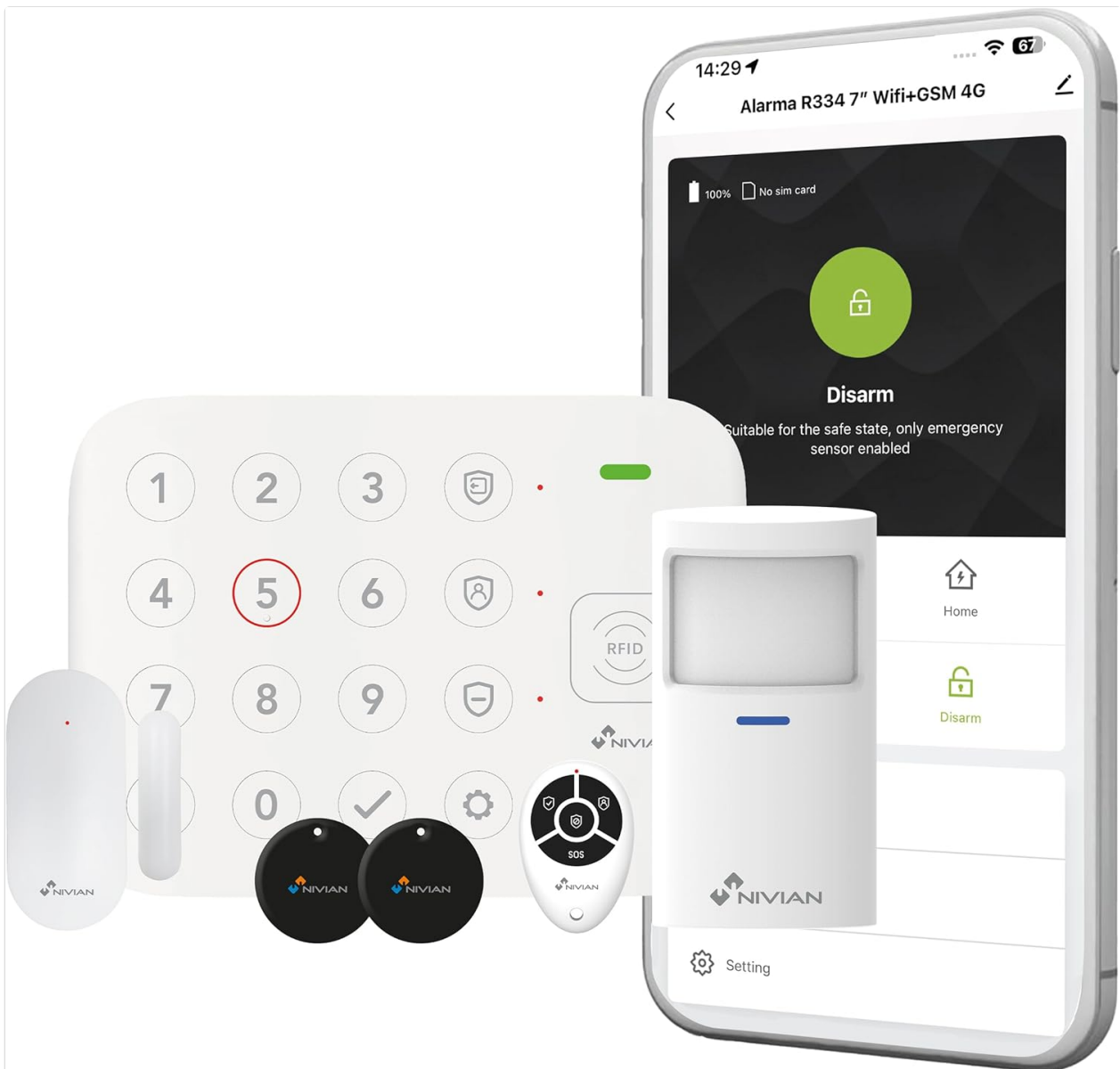

Figure 3: The NIVIAN NVS-TOUCHALARM-W control panel can be installed on a wall or placed on a desktop for flexible placement options.

2.4 SIM Card Insertion

Insert a voice/SMS compatible SIM card into the designated slot on the control panel. This enables GSM communication for calls and SMS notifications. Note that data-only SIM cards are not supported for this function.

3. OPERATING THE SYSTEM

3.1 Arming and Disarming

The NIVIAN NVS-TOUCHALARM-W offers multiple methods for arming and disarming the system:

- **Touchscreen Panel:** Use the intuitive 7-inch touchscreen to select 'Arm', 'Disarm', 'Away', or 'Home' modes.
- **Remote Control:** The included remote control allows for quick arming and disarming from a distance.
- **Mobile Application:** Control the system remotely via the TUYA app on your smartphone.
- **SMS Commands:** Send specific SMS commands to the system for remote control, especially useful in areas without internet access.

EASY INSTALLATION FOR TOTAL CONTROL



DESKTOP



ON WALL

Figure 4: The main control panel interface of the NIVIAN NVS-TOUCHALARM-W, demonstrating options for arming (System Armed), disarming, setting 'Away' mode, and 'Home' mode for tailored security.

3.2 Receiving Notifications

Upon detection of an event (e.g., intrusion, sensor trigger, power outage), the system will send immediate notifications:

- **TUYA App:** Real-time alerts and system status updates directly to your smartphone.
- **SMS Messages:** Text message alerts sent to pre-configured phone numbers.
- **Phone Calls:** The system can dial pre-configured numbers to alert users of an event.

3.3 SOS Feature

The remote control includes an SOS button. In an emergency, pressing this button will trigger an immediate alert, sending notifications to designated contacts. This feature is designed for personal safety and quick response.

AMPLÍA LA SEGURIDAD INSTALANDO UN PANEL DE TECLADO EXTRA



Pensado también para **usuarios con permisos limitados**, puedes permitir el desarmado del sistema mediante **llavero de proximidad**

Figure 5: The remote control includes an SOS button, enabling users to send immediate emergency notifications to pre-configured contacts, enhancing personal safety.

3.4 User Management and Permissions

The TUYA app allows the primary administrator to manage access for other users. You can invite family members or guests to control the system with varying levels of permissions, ensuring secure and shared management of your alarm system.



Figure 6: This image illustrates the mobile application's 'Add Member' feature, allowing the primary user to grant access and control permissions to family members or guests for the NIVIAN NVS-TOUCHALARM-W system.

4. MAINTENANCE

4.1 Power Supply and Battery Backup

The control panel operates on AC power and includes a built-in backup battery. Ensure the control panel remains connected to a reliable power source. The backup battery provides continued operation during power outages, typically for several hours. Regularly check the battery status via the app or control panel.

4.2 Sensor Battery Replacement

Wireless sensors are battery-powered. The system will notify you when a sensor's battery is low. Replace batteries promptly with the recommended type to ensure continuous protection.

4.3 Cleaning

Clean the control panel and sensors with a soft, dry cloth. Avoid using abrasive cleaners or solvents, which can damage the surfaces.

5. TROUBLESHOOTING

5.1 No Notifications Received

- **Check WiFi Connection:** Ensure the control panel is connected to a stable WiFi network.
- **Check GSM Signal:** Verify that the inserted SIM card has a strong GSM signal and sufficient credit/plan for calls and SMS. Confirm it is a voice/SMS SIM, not data-only.
- **App Settings:** Ensure app notifications are enabled on your smartphone and within the TUYA app settings.
- **Contact Numbers:** Verify that emergency contact numbers are correctly configured in the system.

5.2 False Alarms

- **PIR Sensor Placement:** Ensure PIR sensors are not facing direct sunlight, heat sources, or areas with significant air currents (e.g., near vents).
- **Sensor Sensitivity:** Adjust sensor sensitivity settings if available in the app or control panel.
- **Environmental Factors:** The system features environmental compensation technology, but extreme conditions can still affect performance.

5.3 Sensor Not Responding

- **Battery Check:** Replace the sensor battery if it is low or depleted.
- **Range:** Ensure the sensor is within the 100-meter wireless range of the control panel. Obstructions like thick walls can reduce range.
- **Re-pairing:** If necessary, try re-pairing the sensor with the main control panel according to the instructions in the app or panel menu.

6. TECHNICAL SPECIFICATIONS

Feature	Specification
Brand	NIVIAN
Model Number	NVS-TOUCHALARM-W
Connectivity Technology	Wireless (WiFi, GSM, RF)
Power Source	AC with backup battery
Backup Battery Capacity	5000 mAh (Control Panel)
Compatible Devices	Smartphone, Personal Computer, Tablet
Control Method	App, Touchscreen, Remote Control
Maximum Wireless Range	100 Meters (for accessories)
Alert Type	Audio and Motion
Siren Output	115 dB (Outdoor Siren)
Smart Home Compatibility	Compatible with smart home platforms (e.g., Tuya, Google Assistant, Amazon Alexa)
Item Dimensions (L x W x H)	12 x 7 x 5 centimeters
Country of Origin	China

7. SUPPORT AND WARRANTY

For additional information, technical support, and warranty details regarding your NIVIAN NVS-TOUCHALARM-W alarm system, please visit the official NIVIANHOME website.

You can also find tutorials and tips on our social media channels:

- Instagram: @nivianhome_es
- YouTube: @nivian7121



THE TRUSTED EUROPEAN BRAND
AT YOUR SERVICE

NIVIANHOME WEB



Information



Technical support



Warranty

 Instagram

 YouTube



Tutorials & Tips

Figure 7: NIVIAN's online resources, including the NIVIANHOME WEB portal for product information, technical support, and warranty details, alongside links to their Instagram and YouTube channels for tutorials and tips.