



Manuals.plus /

- › DAYI /
- › DAYI Safe Box D70 Lite 4.0 Cubic Feet Lite Instruction Manual

DAYI D70 Lite

DAYI Safe Box D70 Lite 4.0 Cubic Feet Lite Instruction Manual

Model: D70 Lite

| | | | | | | | |
|--------------------------|-----------------------|---------------------------|---|--|---|--------------------------------|--------------------------|
| Contents | Setup | Operation | Introduction Features | Safety Information Maintenance & Support | Package Troubleshooting | Specifications | Warranty |
|--------------------------|-----------------------|---------------------------|---|--|---|--------------------------------|--------------------------|

1. INTRODUCTION

Thank you for choosing the DAYI Safe Box D70 Lite 4.0 Cubic Feet Lite. This security safe is designed to protect your valuable possessions, including money, documents, and other important items, in your home or office. It features a digital keypad for easy access, a dual alarm system for enhanced security, and comes with a fireproof bag for additional protection of sensitive documents. This manual provides detailed instructions for setup, operation, and maintenance to ensure optimal performance and security.



Image: The DAYI Safe Box D70 Lite, showcasing its sleek black design and digital keypad interface.

2. SAFETY INFORMATION

- **Secure Mounting:** For maximum security, it is highly recommended to mount the safe to a wall or floor using the provided hardware. This prevents unauthorized removal of the safe.
- **Battery Safety:** Use only the specified battery type (4x AA alkaline batteries). Do not mix old and new batteries or different types of batteries. Remove batteries if the safe is not used for extended periods.
- **Fireproof Bag:** The included fireproof bag offers basic fire and water protection for documents. The safe box itself is not fireproof. For items requiring certified fire protection, consider additional measures.
- **Keep Keys Secure:** Store emergency override keys in a secure location away from the safe and out of reach of unauthorized individuals.
- **Avoid Obstructions:** Ensure the door and locking bolts are free from obstructions when closing the safe to prevent damage or improper locking.

3. PACKAGE CONTENTS

Verify that all items listed below are included in your package:

- 1 x DAYI Safe Box (D70 Lite)
- 1 x Accessories Package (includes 2 x Physical Keys, 4 x Foot Pads, 2 x Wedge Anchors)
- 1 x User Manual
- 1 x Fireproof Bag
- 1 x External Battery Case

PRODUCT DETAILS

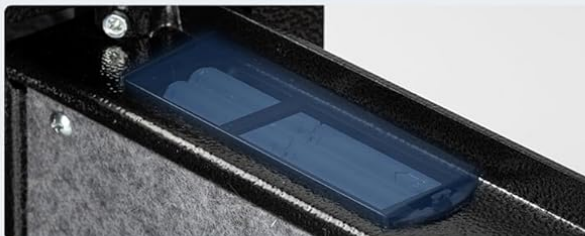

Built-in Battery Case



Passcode Setting Button

Image: Visual representation of the safe's dimensions and all components included in the package.

4. SETUP

4.1. Battery Installation

1. Locate the battery compartment inside the safe door.
2. Insert 4x AA alkaline batteries (not included) according to the polarity markings.
3. Close the battery compartment cover.

4.2. Initial Unlock & Passcode Setting

Upon first use, the safe will be unlocked using the physical override key.

1. Locate the hidden keyhole on the digital keypad panel.
2. Insert one of the physical keys and turn it clockwise.
3. Turn the handle counter-clockwise to open the safe door.
4. With the door open, locate the reset button on the inside of the door.
5. Press the reset button. The yellow light on the keypad will illuminate.
6. Enter your desired 1-8 digit passcode on the digital keypad, then press '#'. The safe will beep twice, confirming the new passcode.

4.3. Mute Function

To operate the safe silently, you can activate the mute function:

- **To turn off sound:** Press '*' then '633' on the keypad.
- **To turn on sound:** Press '*' then '66' on the keypad.



Image: Instructions for activating and deactivating the mute function on the digital keypad.

4.4. Mounting the Safe

To prevent theft, secure the safe to a wall or floor.

1. Choose a suitable location for mounting.
2. Use the provided wedge anchors to drill holes in the desired mounting surface (wall or floor).
3. Align the safe's pre-drilled holes with the drilled holes in the surface.
4. Secure the safe using the wedge anchors.

WALL MOUNTING

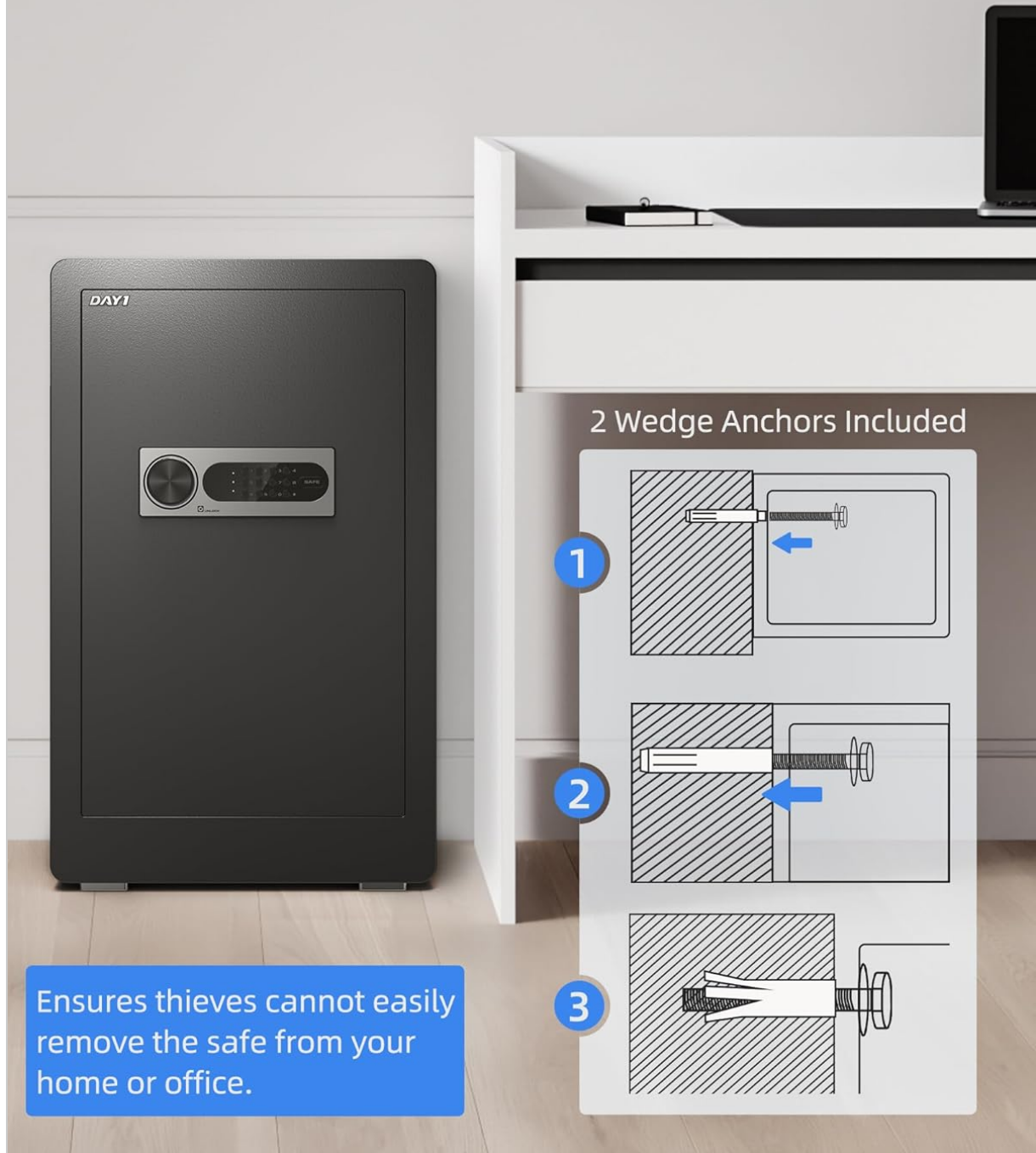

Image: Step-by-step guide for securely mounting the safe to a wall.

5. OPERATING INSTRUCTIONS

5.1. Opening with Digital Keypad

1. Enter your programmed 1-8 digit passcode on the digital keypad.
2. Press '#'. The green light will illuminate.
3. Turn the handle counter-clockwise to open the door within 5 seconds.

ELEGANT DIGITAL KEYPAD

Unlock your safe effortlessly.



Image: A hand interacting with the digital keypad to enter a passcode.

5.2. Opening with Physical Key (Emergency Override)

In case of forgotten passcode or dead batteries, use the physical key:

1. Locate the hidden keyhole on the digital keypad panel.
2. Insert one of the physical keys and turn it clockwise.
3. Turn the handle counter-clockwise to open the safe door.

5.3. Emergency Power Supply

If the internal batteries are depleted, use the external battery case:

1. Insert 4x AA batteries into the external battery case.

2. Plug the external battery case into the emergency power port located on the keypad panel.
3. Enter your passcode as usual.
4. Turn the handle counter-clockwise to open the door.

Your browser does not support the video tag.

Video: Demonstration of using the external battery box and master key to open a safe when internal batteries are depleted.

5.4. Closing and Locking

1. Close the safe door firmly.
2. Turn the handle clockwise to engage the locking bolts. The safe will automatically lock.

6. KEY FEATURES

6.1. Unmatched Security

- **Anti-Pry Door:** Crafted with advanced one-piece bending and laser-cutting technology, the door is designed to resist prying attempts.
- **6 Live-Locking Bolts:** Features six 1.2-inch thick live-locking bolts that provide robust protection against physical attacks and lock manipulation.

MAXIMUM PROTECTION

Solid
Steel Construction



Heavy Duty
Locking Bolts

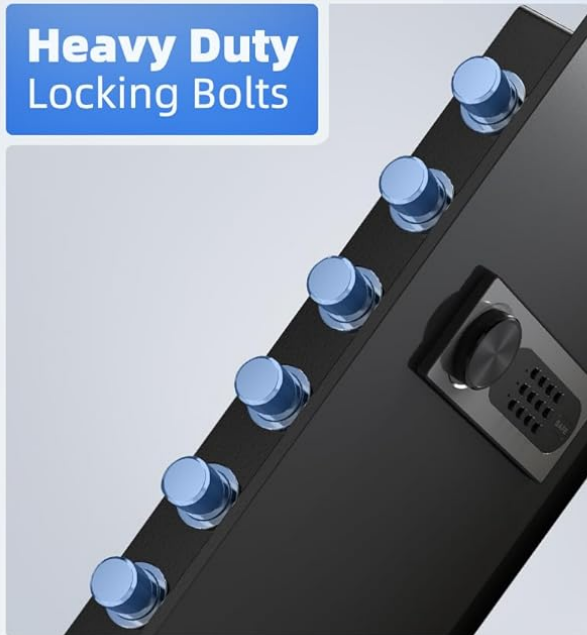

Seamless
pry-resistant door

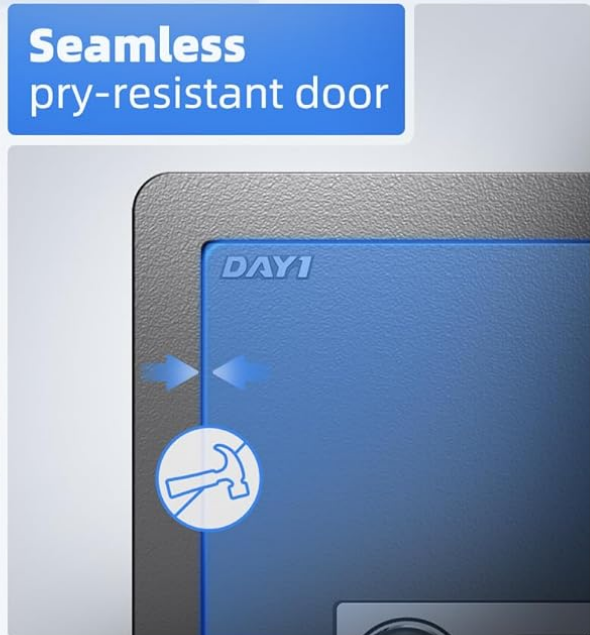

Image: Visual details highlighting the robust security features of the safe.

6.2. Dual Alarm System

The built-in dual alert system provides enhanced tamper protection:

- If three incorrect passcode attempts are made, a loud 70-decibel alarm will sound.
- Any forceful breach or impact will also trigger the alarm, deterring intruders.

DUAL ALERT SYSTEM

For peace of mind

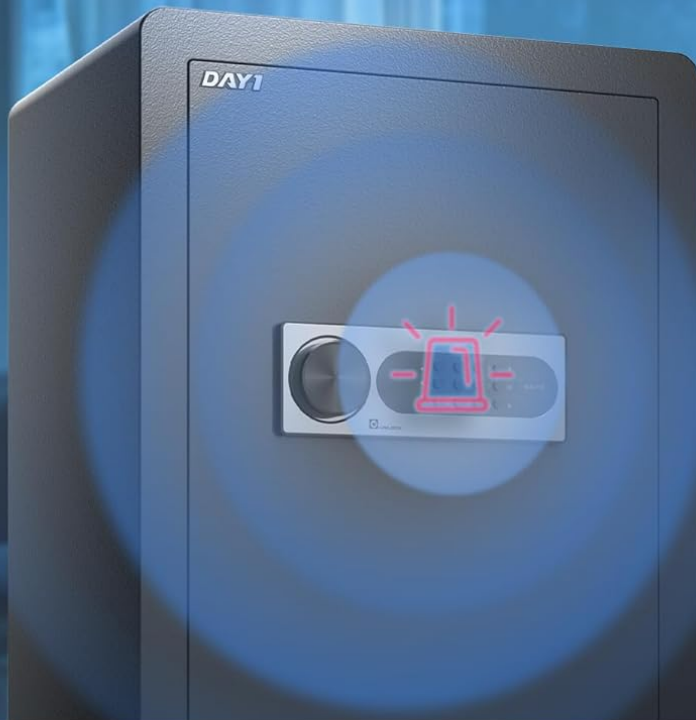

ANY UNAUTHORIZED ACCESS OR FORCEFUL BREACH

Trigger a loud alarm, deterring intruders.

Image: Representation of the safe's dual alarm system activating upon unauthorized access.

6.3. Versatile & Organized Interior

- **Removable Shelves:** Two removable shelves allow for customizable storage space to accommodate various item sizes.
- **Built-in Hooks:** Convenient hooks inside the door for organizing keys or small jewelry.
- **Soft Carpeted Interior:** Protects delicate items from scratches and damage.
- **Integrated LED Sensor Light:** Automatically illuminates the interior when the door is opened, making it easy to locate items in low light.
- **Privacy Lock Box:** An internal lockable compartment provides an extra layer of security for highly sensitive items.

- **Door Storage Basket:** A basket on the inside of the door offers additional storage for documents or small valuables.

DETAILS YOU WILL APPRECIATE

Privacy Locking Box



Key rack



LED Interior Lighting



Door Organizer

Image: Detailed view of the safe's interior organization features.

REMOVABLE SHELF

Customize your storage space

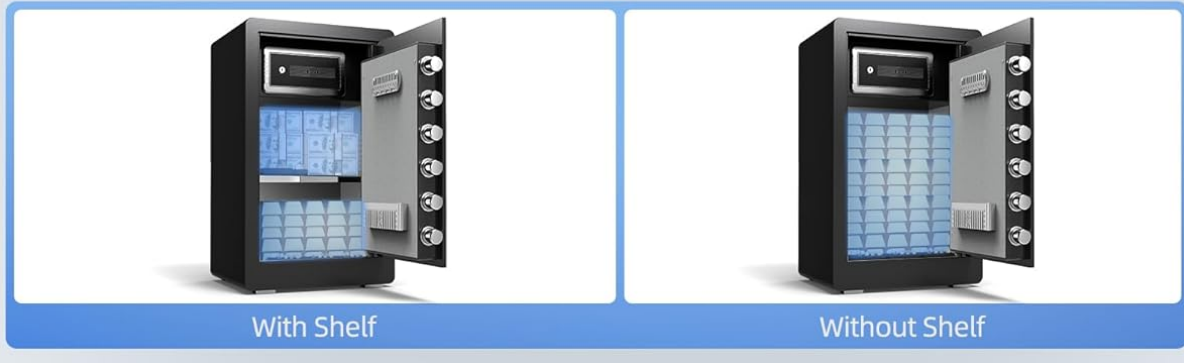

Image: The removable shelf feature, allowing for flexible interior configuration.

6.4. Included Fireproof Bag

The safe includes a fireproof and waterproof bag for emergency readiness.

- Its four-layer protection and fire-resistant stitching help shield contents from basic fire and water threats.
- Ideal for irreplaceable documents, cash, and small valuables.

7. MAINTENANCE

- **Cleaning:** Wipe the exterior with a soft, damp cloth. Avoid abrasive cleaners or solvents.

- **Battery Replacement:** Replace batteries annually or when the low battery indicator appears.
- **Locking Mechanism:** Periodically check the locking bolts and hinges for smooth operation. Do not lubricate the digital keypad.

8. TROUBLESHOOTING

| Problem | Possible Cause | Solution |
|-----------------------------------|---|---|
| Safe does not open with passcode. | Incorrect passcode entered; Batteries are low/dead. | Re-enter correct passcode; Use external battery case or physical key. Replace internal batteries. |
| Alarm sounds unexpectedly. | Three incorrect passcode attempts; Forceful impact/tampering. | Enter correct passcode to silence; Inspect safe for signs of tampering. |
| Door does not lock properly. | Obstruction in the door frame; Locking bolts not fully extended. | Clear any obstructions; Ensure door is fully closed before turning handle clockwise. |
| Keypad is unresponsive. | Dead batteries. | Use external battery case or physical key. Replace internal batteries. |

9. SPECIFICATIONS

| Feature | Detail |
|------------------------|---|
| Brand | DAYI |
| Model Number | D70 Lite |
| Product Dimensions | 11.8"D x 14.2"W x 27.5"H |
| Capacity | 4 Cubic Feet |
| Lock Type | Electronic Combination Lock, Key |
| Color | Black |
| Material | Alloy Steel |
| Item Weight | 47 Pounds |
| Special Features | Alarm System, Anti-Theft, Combination Lock, Removable Shelf, Sensor Light |
| Mounting Type | Wall Mount |
| Batteries Required | Yes (4x AA) |
| Water Resistance Level | Not Water Resistant |

10. WARRANTY & SUPPORT

For warranty information, technical support, or any inquiries regarding your DAYI Safe Box, please contact the manufacturer directly through their official website or the contact details provided at the point of

purchase. Keep your purchase receipt as proof of purchase for warranty claims.