

QUW FHC48SC6D-DW

QUW Farmhouse 6 Drawer Dresser with Charging Station Instruction Manual

Model: FHC48SC6D-DW

1. INTRODUCTION

This manual provides detailed instructions for the assembly, operation, and maintenance of your QUW Farmhouse 6 Drawer Dresser with an integrated charging station. Please read this manual thoroughly before assembly and use to ensure safe and proper operation.



Image 1.1: The QUW Farmhouse 6 Drawer Dresser in Dark Walnut, featuring six drawers and an integrated charging station on the top surface.

2. SAFETY INFORMATION

To prevent injury and damage, adhere to the following safety guidelines:

- **Anti-Tipping Device:** Always install the included anti-tipping device. This is crucial for preventing the dresser from falling over, especially in households with children or pets.
- **Weight Distribution:** Distribute weight evenly across drawers. Place heavier items in lower drawers to enhance stability.
- **Assembly:** Assemble the dresser on a soft, clean surface to prevent scratches. Ensure all screws and fasteners are securely tightened before use. Periodically check and retighten fasteners as needed.
- **Electrical Safety:** The charging station is designed for indoor use only. Do not expose it to moisture. Do not overload the outlets. If the power cord is damaged, discontinue use and contact customer support.
- **Placement:** Place the dresser on a level surface. Avoid placing it near heat sources or in direct sunlight to prevent material degradation.

3. PACKAGE CONTENTS

Before beginning assembly, verify that all components and hardware are present. Refer to the included assembly diagram for a complete list of parts. If any parts are missing or damaged, do not proceed with assembly; contact QUW customer support immediately.

4. SETUP AND ASSEMBLY

Assembly is required for this dresser. Follow the step-by-step instructions provided in the separate assembly guide included with your product. Key steps include:

1. **Unpacking:** Carefully unpack all components and lay them out on a protected surface.
2. **Frame Assembly:** Assemble the main frame of the dresser according to the diagrams.
3. **Drawer Assembly:** Construct each of the six drawers, ensuring smooth operation of the drawer slides.
4. **Charging Station Installation:** Securely install the charging station into the designated slot on the dresser top.
5. **Anti-Tipping Device Installation:** Attach the anti-tipping device to the back of the dresser and secure it to a wall stud. This step is mandatory for safety.



Image 4.1: The assembled QUW Farmhouse 6 Drawer Dresser positioned in a bedroom, showcasing its aesthetic integration into a living space.



Image 4.2: Detailed view highlighting the stable and sturdy base, decorative side strips, and chic metal handles of the dresser.

5. OPERATING INSTRUCTIONS (CHARGING STATION)

The integrated charging station provides convenient power access for your electronic devices.

- **Power Connection:** After assembly, plug the 6.5-foot power cord from the charging station into a standard wall outlet.
- **AC Outlets:** Use the two AC outlets for devices requiring standard wall power.
- **USB Ports:** Use the USB-A and USB-C ports for charging compatible smartphones, tablets, and other USB-powered devices.

- **Usage:** Ensure devices are properly connected. The charging station is designed for low-power electronics. Avoid plugging in high-wattage appliances.



Stable & Sturdy Base

Decorative Strips



Chic Metal Handle

Image 5.1: An overhead view of the dresser, illustrating the integrated charging station with AC and USB ports, and the spacious drawers open for storage.

6. MAINTENANCE

Proper care will extend the life and appearance of your dresser:

- **Cleaning:** Wipe surfaces with a soft, damp cloth. Avoid harsh chemicals or abrasive cleaners, which can damage the finish.
- **Spills:** Clean spills immediately to prevent staining or water damage.
- **Hardware:** Periodically check all screws and fasteners to ensure they remain tight. Retighten as necessary.
- **Drawer Slides:** If drawers become stiff, a small amount of silicone lubricant can be applied to the slides.

7. TROUBLESHOOTING

Problem	Possible Cause	Solution
Drawers do not slide smoothly.	Misaligned slides, loose screws, or debris in tracks.	Check alignment of drawer slides. Ensure all screws are tight. Clean tracks of any debris. Apply silicone lubricant if needed.
Charging station not working.	Not plugged in, power outlet issue, or overloaded.	Ensure the power cord is securely plugged into a functional wall outlet. Test the outlet with another device. Do not overload the charging station with high-power devices.
Dresser feels unstable.	Anti-tipping device not installed, uneven floor, or loose fasteners.	Verify the anti-tipping device is correctly installed and secured to the wall. Place the dresser on a level surface. Check and tighten all assembly fasteners.

8. SPECIFICATIONS

Feature	Detail
Brand	QUW
Model Name	6 Drawer Dresser
Model Number	FHC48SC6D-DW
Color	Dark Walnut
Product Dimensions (D x W x H)	15"D x 47"W x 33"H
Item Weight	112.6 Pounds
Charging Station	2 AC Outlets, 1 USB-A Port, 1 USB-C Port
Power Cord Length	6.5 feet
Assembly Required	Yes
Room Type	Bedroom, Living Room, Hallway, Entryway

Product Dimensions

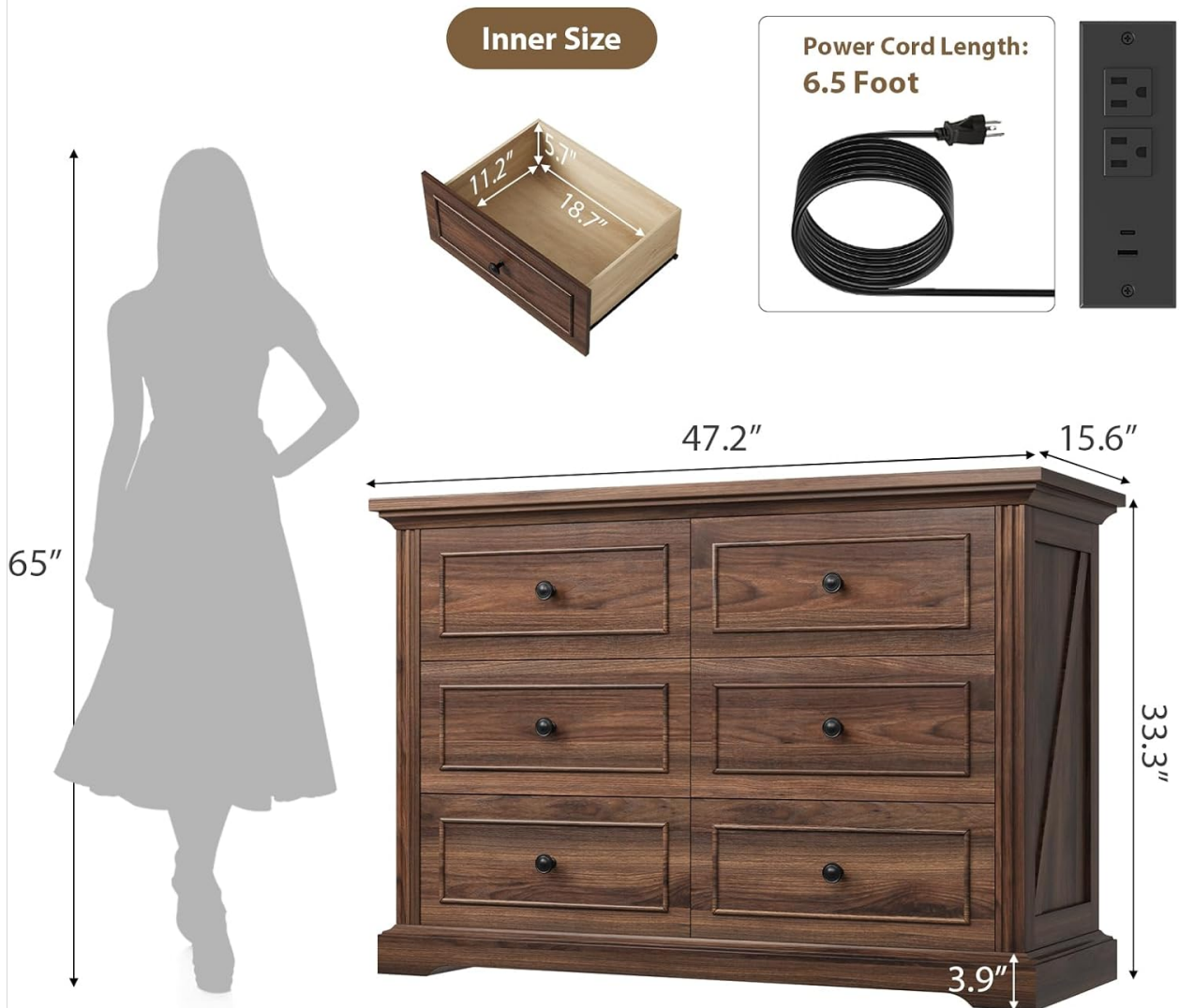

Image 8.1: A detailed diagram illustrating the overall dimensions of the dresser (47"W x 15.6"D x 33.3"H), inner drawer dimensions (18.7"L x 11.2"W x 5.1"D), and the 6.5-foot power cord length for the charging station.

9. WARRANTY AND SUPPORT

For warranty information or technical support, please contact QUW customer service. Keep your purchase receipt and model number (FHC48SC6D-DW) handy for faster service. You can typically find contact information on the manufacturer's website or through your retailer.

Manufacturer: QUW

ASIN: B0FSZ18Y5H

Related Documents - FHC48SC6D-DW



[VMAX iP G4 User Manual - Digital Watchdog](#)

Comprehensive user manual for the Digital Watchdog VMAX iP G4 series of IP Video Solutions, covering setup, operation, network configuration, and system specifications.

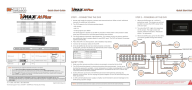

[Digital Watchdog VMAX A1 Plus DVR Quick Start Guide](#)

A quick start guide for Digital Watchdog VMAX A1 Plus HD over Coax DVRs, detailing connection, power-up, setup wizard, camera control, system monitoring, and mobile app remote access.

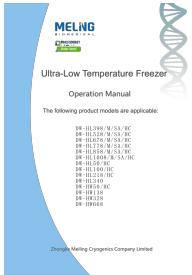

[MELING BIOMEDICAL Ultra-Low Temperature Freezer Operation Manual](#)

Comprehensive operation manual for MELING BIOMEDICAL Ultra-Low Temperature Freezers, covering installation, usage, safety, maintenance, and specifications for models like DW-HL398, DW-HW50, and others.



1. Mount and install all necessary camera and external devices. Refer to their individual manuals for additional information.
2. The DVR supports the following analog signals:
 - HD-Analog
 - HD-TVI
 - Standard analog camera up to 60Hz

The DVR supports camera up to 5MP/4K for 60Hz model in resolution. Please refer to the product data sheet and full manual for recording specifications per product.
3. The DVR supports automatic signal detection. This means you do not have to perform any additional setup to assign signals to each BNC input. The DVR will detect the proper signal automatically.
4. Place the DVR in its final position. See installation tips below.
5. Connect all necessary cables to the DVR:
6. Connect the DVR to an appropriate power supply.
7. The DVR will boot up automatically.

Model	Power consumption
STP-5A-50-40	DC 57V 24W 2A
STP-5A-50-40	DC 57V 40W 4A
STP-5A-50-40	DC 57V 40W 4A

- Make sure the cameras and the monitors are properly connected to the DVR.
- The DVR should be placed in a dust and moisture free environment. It should never be directly exposed to sunlight. A room temperature is highly recommended to reduce the effect of overheating. (Room temperature is considered as 60-70°F), which may cause the DVR to become unstable.
- During the boot up process, the DVR should not be interrupted by pressing any key on the remote control. Do not unplug the power adapter or turn the DVR off during the boot up process.
- A UPS (uninterrupted power supply) is highly recommended to prevent damage to the DVR during a power outage.

NOTE: HD Monitor output and VGA output cannot be used at the same time due to monitoring.

1. You will be asked to setup a new password. The password will be a minimum of eight (8) characters with at least four (4) combinations of upper-case letters, lower-case letters, numbers, and special characters.
2. When the DVD boots up for the first time, you will be guided through the startup wizard.

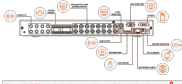

- Follow the static wizard's instructions to setup the IPv6 basic settings, including interface, data type, and network. You may need to change any default settings to match your network. For example, you may need to change the link-local address and set the IPv6's manually.
- Set the IPv6 network's settings to match your network's requirements. It is recommended that you set the network's address type to "Static" and the network's "CONV" and let the IPv6 static detect the network's settings. Then, change the IPv6 to static. Please contact your network administrator for more information. Press "APPLY" to save and "OK" to return to the next step. After the "IPv6" settings are completed, refer to the "IPv6 Configuration" manual for initial setup. See STEP 6 - HOSTS AND REMOTE HOSTS.
- If it is your first time powering up the IPv6, you are encouraged to set the IPv6's settings. If you prefer to manually set the IPv6's settings to your preference, you can set the IPv6 address at any time.

The DVDR supports complete camera control via the control camera port (VCI). There is no need for an additional RS-485 connection between the camera and the DVDR in order to control the camera. This feature must be supported in the camera's code.

To use a VCI or VCI camera

- 1. Plug into any camera on the DVDR and go to "MENU" > "DEVICE" > "VCI"

2. Camera type will be auto-identified and displayed under the camera type field. Pressing should result in the camera type field to:

- HD-CVI > HD-CVI Axiom signal camera
- HD-AES > HD-AES Axiom signal camera
- HD-SDI > HD-SDI Axiom signal camera
- DVI > DVI signal camera

NOTE: The following cameras will not be identified:

- HD-SDI > HD-SDI Axiom signal camera
- HD-SDI > HD-SDI Axiom signal camera

3. To control the camera's menu and settings, press the "MENU" button under the "CAMERA" row. See user manual for more information.

Navigation - use the INCLUDED User Guide to navigate around the DNR's monitoring and analysis software.

6. To access the menu bar - move the mouse's cursor to the bottom of the display area to show the menu bar. You will also display a status bar by pressing the pin icon on the right side.

7. To access the quick menu options, right-click anywhere on the screen. This will take you to the quick menu options, which include:

- "DISPLAY MODE" - Options
- "THERMAL" - "THERMAL" and "FUSING" image (per supported encoder)
- "ADD BROWSE" - "SEARCH" and "PREVIEW" search
- "RECORDING STATUS" - "SEARCH" and "PREVIEW" search
- "RECORDING STATUS" - "SEARCH" and "PREVIEW" search

8. To help - For your convenience, the help button located at the bottom left of setup screen includes basic information and settings. For more information and settings, refer to this page for all user information.

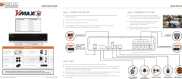
[illegible]

Comprehensive quick start guide for Digital Watchdog DVRs (DW-VA1G44, DW-VA1G48, DW-VA1G416 series). Covers initial setup, password, connections, startup wizard, camera control (UTC/PTZ), monitoring, and mobile remote access.

Quick start guide for the Digital Watchdog VMAX IP NVR, covering initial setup, connection, powering up, startup wizard, system monitoring, and remote access via DDNS.

Get started quickly with the Digital Watchdog VMAX IP NVR. This guide covers NVR connection, setup, camera registration, monitoring, and remote access.