

Atcall C5

Atcall C5 Vehicle Cell Phone Signal Booster Instruction Manual

Model: C5

1. PRODUCT OVERVIEW

The Atcall C5 Vehicle Cell Phone Signal Booster is designed to enhance 5G and 4G LTE cellular signals within your car or SUV. It supports all major U.S. carriers, including AT&T, Verizon, T-Mobile, Sprint, and U.S. Cellular. This device aims to provide more reliable calls, fewer dropped connections, and faster data speeds for multiple users and devices simultaneously.

Key features include:

- **Universal Carrier Compatibility:** Works with all U.S. carriers on bands 12/17, 13, 5, 2/25, and 4/66.
- **Omni-Directional Signal Reception:** The outdoor magnetic antenna receives signals from all directions, eliminating the need for manual adjustment.
- **Intuitive LED Indicator:** Provides visual feedback on the operational status of each frequency band.
- **FCC Approved:** Certified for safe and compliant operation.

Compatible with **All Carriers**

Band 12/17/13/5/2/25/4/66



Image 1.1: The Atcall C5 booster is compatible with all major U.S. cellular carriers, supporting various frequency bands for enhanced signal reception.



Strength Your Signal **On the Road**

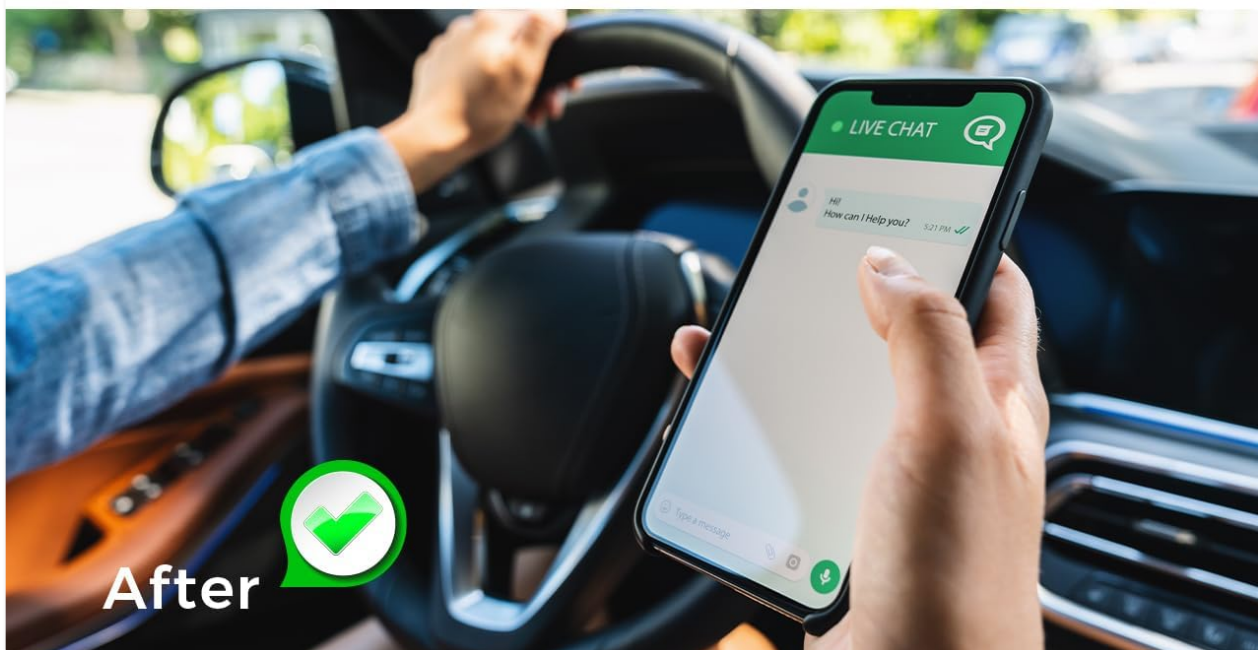

Image 1.2: Visual representation of signal improvement within a vehicle after installing the booster.

2. PACKAGE CONTENTS

Verify that all components are present in your package:

- Signal Booster Unit
- Outdoor Magnetic Antenna
- Indoor Patch Antenna
- Power Supply (Car Charger)

Work with Most Vehicles



Image 2.1: All components included in the Atcall C5 Signal Booster Kit.

3. INSTALLATION INSTRUCTIONS

Follow these steps for a successful installation. No specialized technical experience is required.

1. **Mount the Outdoor Antenna:** Attach the magnetic outdoor antenna to the roof of your vehicle. Ensure it is positioned to receive signals from all directions.
2. **Route the Cable:** Carefully route the cable from the outdoor antenna into the vehicle, ensuring it does not interfere with doors or windows.
3. **Position the Booster:** Place the signal booster unit in a suitable location inside the vehicle, such as under a seat or in the console.
4. **Mount the Indoor Antenna:** Attach the indoor patch antenna inside the vehicle. It should be positioned where you typically use your cell phone, ensuring it is not pointing directly at the outdoor antenna.
5. **Connect Cables:** Connect the outdoor antenna cable to the designated port on the booster. Connect the indoor antenna cable to its designated port.
6. **Connect Power:** Plug the power supply (car charger) into your vehicle's 12V power outlet and connect it to the booster unit.

Important Separation Guidelines: For optimal performance and to prevent signal interference, maintain the following distances between the outdoor and indoor antennas:

- **Horizontal Separation:** Greater than 3 feet (0.9 meters).
- **Vertical Separation:** Greater than 2 feet (0.6 meters).

Testing Methods of Frequency Band



For iPhone

1. Dial *3001#12345#* then press call button
2. Choose All Metrics, Click Serving Cell Info
3. Check Band Info

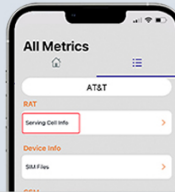

For Android Phone

1. Download "Network Cell Info Lite"
2. Choose "GAUGE"
3. Check "BAND"

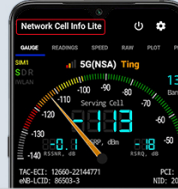
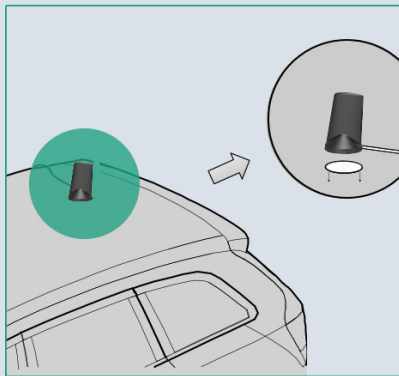
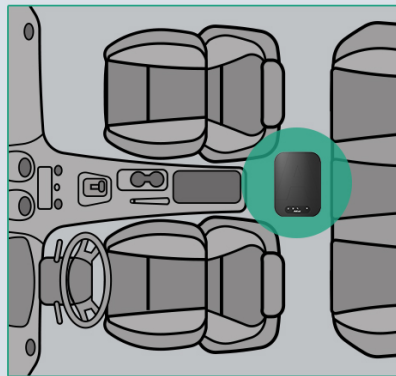

Image 3.1: Recommended antenna separation for optimal booster performance in a vehicle.



Outside Magnetic Roof Antenna

Firmly attached to the roof of the vehicle, better receive signals from all directions.



Signal Booster

Amplifies the signal received from cell tower by the outside antenna.

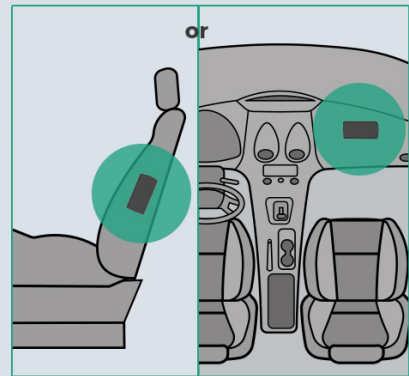

Inside Patched Mounted Antenna

Transfer the improved signal to the cell phone. More stable and reliable.

Image 3.2: Typical installation points for the outdoor antenna, booster, and indoor antenna.

4. OPERATION

Once installed and powered on, the Atcall C5 booster will automatically begin to amplify the available cellular signal. The system requires at least one bar of existing outdoor signal to function effectively. It is designed to work with smartphones, tablets, and other cellular devices from all supported U.S. carriers.

The booster operates by receiving weak signals from nearby cell towers via the outdoor antenna, amplifying them, and then rebroadcasting the stronger signal inside your vehicle through the indoor antenna. This process improves voice call clarity, reduces dropped calls, and increases data transfer speeds.

Keep in Touch Along the Way



Image 4.1: The booster helps maintain connectivity even in remote areas during travel.

5. LED INDICATOR GUIDE

The Atcall C5 booster features LED indicators that display the operational status of each frequency band. Understanding these indicators is crucial for monitoring performance and troubleshooting.

LED Color	Status	Description
Green	Functional	The corresponding band is operating correctly.

LED Color	Status	Description
Orange	Self-Test and Signal Interference	The booster is performing a self-test or detecting signal interference. Adjust antenna separation if this persists.
Red	Abnormal	An issue is detected with the corresponding band. Refer to the troubleshooting section.

Note on Band Inclusion:

- Band 17 is included in Band 12.
- Band 25 is included in Band 2.
- Band 66 is included in Band 4.

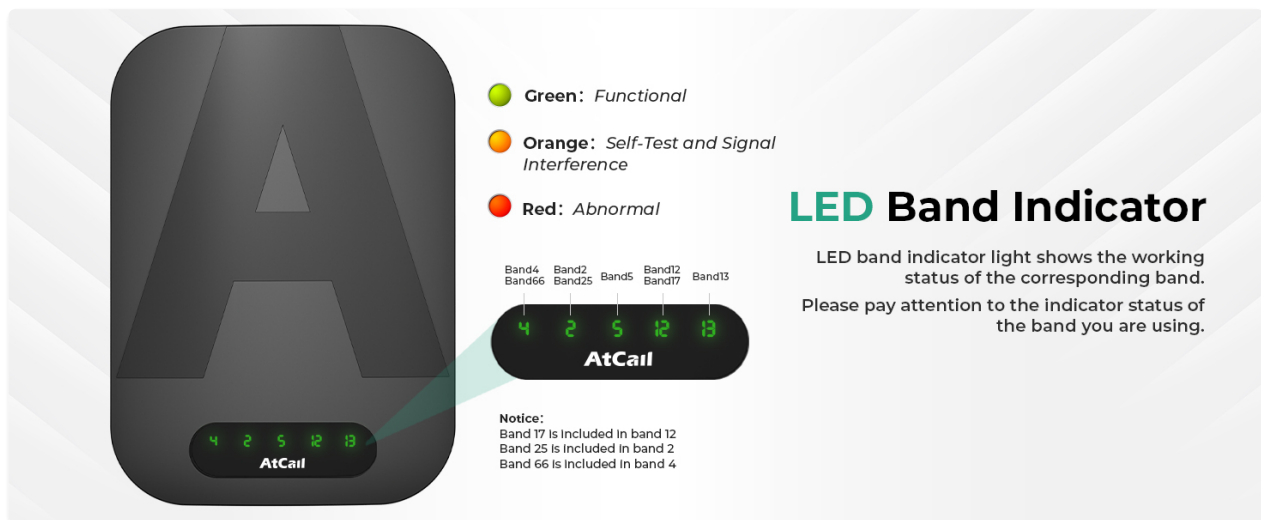

Image 5.1: Visual guide to the LED band indicators on the Atcall C5 booster.

6. TROUBLESHOOTING

If you experience issues with your Atcall C5 signal booster, refer to the following common problems and solutions:

- **No Signal Improvement:**
 - Ensure there is at least one bar of existing cellular signal outside your vehicle. The booster amplifies existing signal; it does not create it.
 - Verify all cable connections are secure between the antennas and the booster.
 - Check the LED indicators. If any are red or orange, proceed to the next steps.
- **Orange LED Indicator (Signal Interference):**
 - This indicates that the outdoor and indoor antennas are too close or are pointing towards each other, causing oscillation.
 - Increase the physical separation between the outdoor and indoor antennas, adhering to the recommended horizontal (greater than 3 ft) and vertical (greater than 2 ft) distances.
 - Ensure the indoor antenna is not directly facing the outdoor antenna.
- **Red LED Indicator (Abnormal Operation):**

- A red light suggests a significant issue with the corresponding band.
- Power cycle the booster by disconnecting and reconnecting the power supply.
- Inspect cables for any damage or kinks.
- If the issue persists, contact Atcall customer support for assistance.

- **Testing Frequency Band:**

To identify the specific frequency band your phone is using, you can perform the following:

- **For iPhone:** Dial ***3001#12345#*** then press the call button. Select 'All Metrics', then 'Serving Cell Info', and check 'Band Info'.
- **For Android Phone:** Download a network cell info application (e.g., "Network Cell Info Lite"). Open the app, choose 'GAUGE', and then check 'BAND'.

7. SPECIFICATIONS

Feature	Detail
Model	C5
Supported Bands	12/17, 13, 5, 2/25, 4/66
Max Gain	50dB
FCC ID	2A34B-SFZN002
Package Dimensions	9.33 x 7.28 x 2.6 inches
Item Weight	2.01 pounds
Manufacturer	Atcall
Compatible Devices	Smartphones, tablets, and other cellular devices from AT&T, Verizon, T-Mobile, Sprint, U.S. Cellular and more.

8. WARRANTY AND SUPPORT

The Atcall C5 Vehicle Cell Phone Signal Booster is FCC approved, ensuring compliance with regulatory standards. It comes with a 3-year warranty.

For any questions or technical assistance, please contact our professional online tech support team. We are available to assist you.



Image 8.1: FCC approval and warranty information for the Atcall C5 booster.