

[Manuals.plus](#) /

> [Keledz](#) /

> Keledz Magnetic Phone Camera Grip P5-MP-003 Instruction Manual for iPhone 17 Pro

## Keledz P5-MP-003

# Keledz Magnetic Phone Camera Grip P5-MP-003 Instruction Manual

Model: P5-MP-003 | Brand: Keledz

## INTRODUCTION

This manual provides detailed instructions for the Keledz Magnetic Phone Camera Grip, Model P5-MP-003, designed for iPhone 17 Pro. This device enhances mobile photography and videography by offering DSLR-style controls, improved stability, and extended battery life. Please read this manual thoroughly before using the product to ensure proper operation and to maximize its features.

## PACKAGE CONTENTS

Verify that all items listed below are included in your package:

- Magnetic mobile phone camera handle x 1
- Magnetic suction ring x 1
- Lanyard x 1
- Instructions x 1
- Charging cable x 1
- Exquisite packaging box (for storage)

# Package List

TELESIN Master Grip x 1,  
Phone case x 1,  
Wrist strap x 1,  
Charging cable x 1,  
Instructions x 1

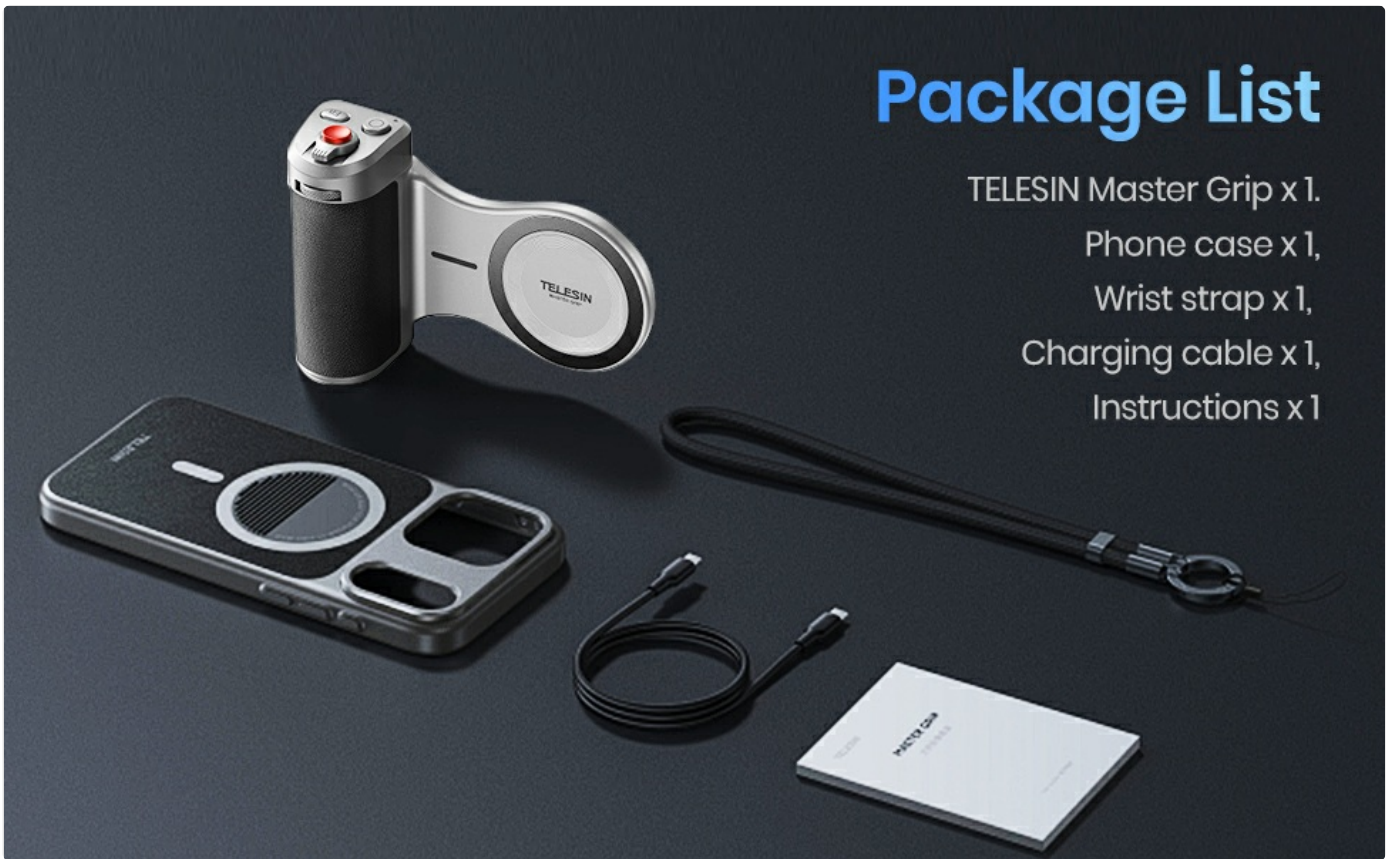

Image: All components included in the Keledz Magnetic Phone Camera Grip package.

## PRODUCT OVERVIEW

The Keledz Magnetic Phone Camera Grip is designed to provide a professional camera feel and enhanced control for your iPhone 17 Pro. Key features include a two-stage mechanical shutter, adaptive zoom dial, and a comfortable ergonomic design.

## Key Components and Controls



Image: Detailed view of the grip's controls, including the Fn Custom Key, Screen Off Wake Button, Shooting Button, Zoom Rocker, and Mode Dial.

- **Shooting Button:** Press and hold for 2 seconds to power on/off. Half-press for focus, full-press to capture a photo or start/stop video recording.
- **Fn Custom Key:** In the app, press to switch dial mode. In video mode, press to capture, double-click to start/stop recording.
- **Screen Off Wake Button:** Press and hold for 2 seconds to wake the camera. Press to switch between cameras.
- **Zoom Rocker:** Right for zoom in, left for zoom out.
- **Mode Dial:** Default function is to switch camera modes. Can be customized in the app for filter intensity, etc.

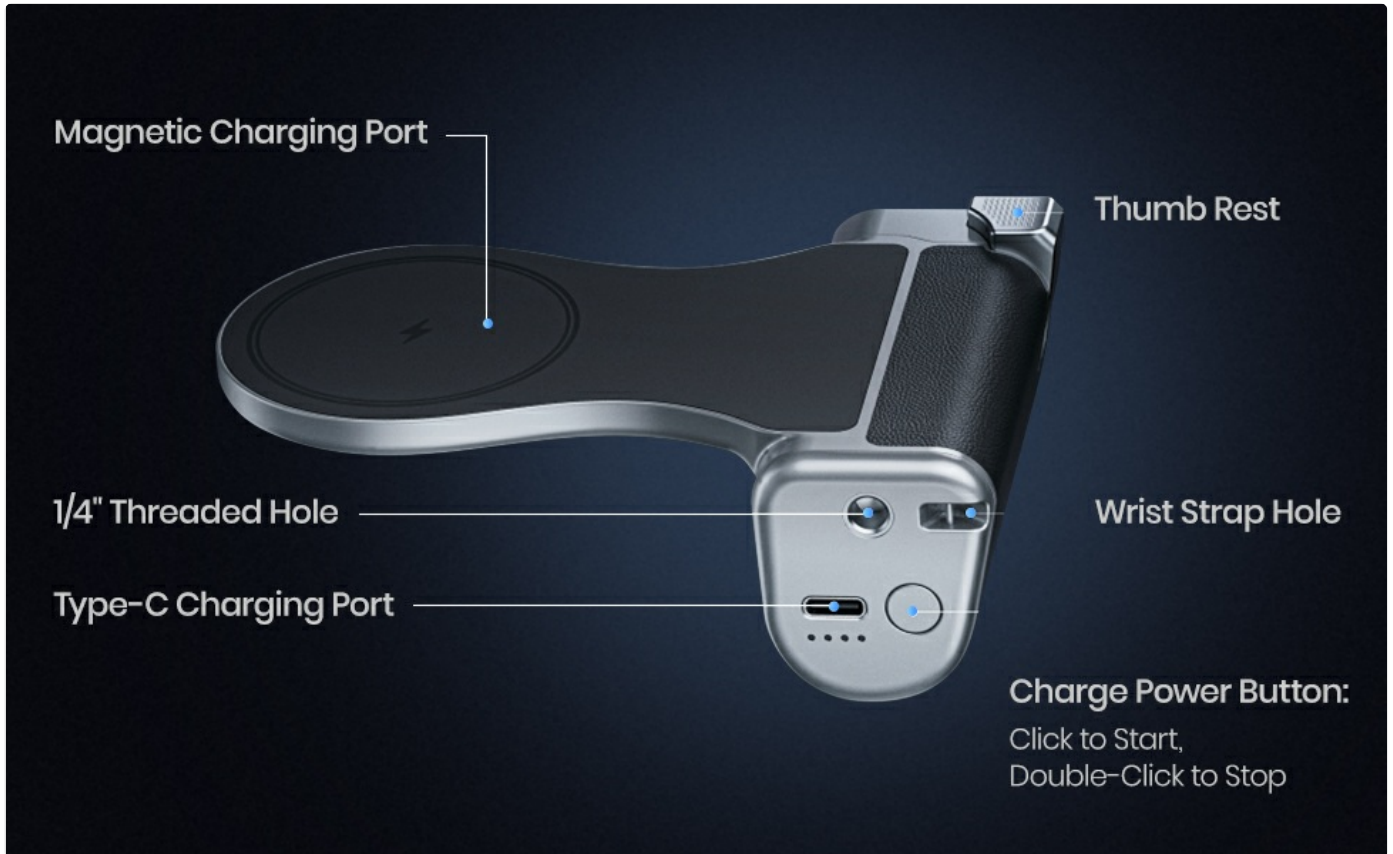

Image: Underside view of the grip, highlighting the Magnetic Charging Port, 1/4" Threaded Hole, Type-C Charging Port, Wrist Strap Hole, and Charge Power Button.

- **Magnetic Charging Port:** For wireless charging of the grip.
- **1/4" Threaded Hole:** For mounting on tripods, lights, or other accessories.
- **Type-C Charging Port:** For wired charging of the grip.
- **Wrist Strap Hole:** For attaching the included lanyard for secure handling.
- **Charge Power Button:** Click once to start charging, double-click to stop.

## SETUP

### 1. Attaching the Grip to your iPhone 17 Pro

The grip attaches magnetically to your iPhone 17 Pro. Ensure your phone is either compatible with MagSafe or use the provided magnetic suction ring for secure attachment. The grip is designed to work seamlessly with the iPhone 17 Pro's telephoto lens.

# Mechanical Shutter & Zoom Dial Maximizes New Telephoto

Optimized for iPhone 17's telephoto lens. Achieves stable 8× zoom control while minimizing touchscreen jitter.



## Two-Stage Mechanical Shutter

Half-press: Focus & Lock Exposure

Full-press: Capture Photo/Video

## Adaptive Zoom Dial

Photo Mode: 0.1× precision adjustments

Video Mode: 1-3× cinematic smooth zoom in APP

Image: The Keledz grip securely attached to an iPhone, demonstrating its ergonomic design.

## 2. Bluetooth Connection

To enable full functionality, connect the grip to your iPhone via Bluetooth.

1. **Power On:** Press and hold the Shooting Button for 2 seconds to power on the grip. It will enter Bluetooth pairing mode.
2. **Enable Bluetooth:** On your iPhone, go to Settings > Bluetooth and turn Bluetooth on.
3. **Pair Device:** Look for "TELESIN\_IP" in the list of devices and tap to connect. Confirm pairing if prompted.

# First Connection Guide (Set up once)

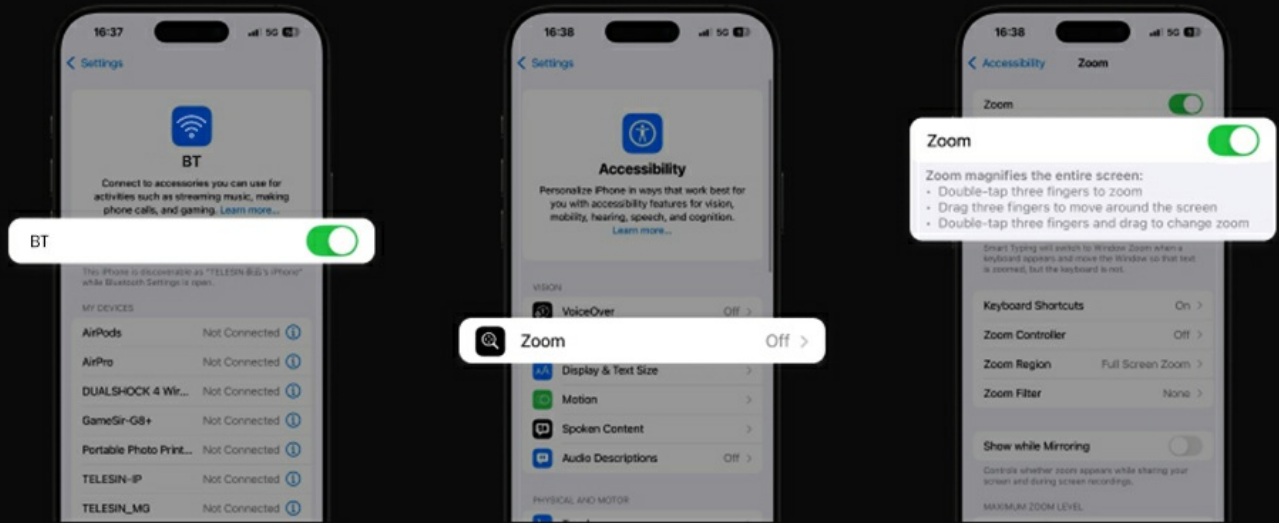

BT search for "TELESIN\_IP"  
Connect handle

Settings → Accessibility – Zoom – Turn on zoom.  
"Zoom" enlarges screen. 3-finger double-tap restore.

Image: Step-by-step guide for connecting the grip via Bluetooth on an iPhone.

### 3. Accessibility Settings (Zoom Function)

For optimal zoom control, adjust your iPhone's accessibility settings:

1. Go to iPhone Settings > Accessibility > Zoom.
2. Turn on the "Zoom" feature.
3. To restore the screen scale, triple-tap the screen with three fingers.

## More fun than using a phone More convenient than using a camera



Two-Stage  
Shutter



Zoom  
Lever



Mode  
Dial



Custom  
Key



Quick  
Camera

## OPERATING INSTRUCTIONS

### Basic Operation

- **Wake Camera:** Press the Screen Off Wake Button to quickly open the camera app.
- **Shutter Control:** Half-press the Shooting Button to focus, full-press to capture a photo or start/stop video recording.
- **Zoom Adjustment:** Use the Zoom Rocker to precisely adjust the camera's zoom level.
- **Mode Switching:** Rotate the Mode Dial to switch between different camera modes (e.g., Photo, Video, Cinematic).



Image: Demonstrating one-handed control with the grip, showing access to shutter, zoom, mode switch, and quick camera functions.

### Advanced Functions (via Reef Color App)

The Reef Color App allows for customization and advanced controls:

- **Custom Dial and Fn Button:** Customize the dial and Fn button for direct access to settings like shutter speed, ISO, and more.

- **OTA Hardware Upgrades:** The app enables continuous over-the-air hardware upgrades for new features.
- **Master Filters:** Access 8 master filters for creative effects.

# Professional Grip Design Grip Feel Like Pro Cameras

Vintage design inspired by classic cameras,  
with professional contours adapting to all hand sizes.



Image: Explaining the two-stage mechanical shutter for focus/capture and the adaptive zoom dial for precise adjustments in photo and video modes.

## Video Demonstration

Your browser does not support the video tag.

Video: This video demonstrates the basic features and operation of the Keledz Magnetic Phone Camera Grip, including power on/off, Bluetooth pairing, screen wake, zoom control, mode switching, and Fn button functions for recording.

## MAINTENANCE

To ensure the longevity and optimal performance of your Keledz Magnetic Phone Camera Grip, follow these maintenance guidelines:

- **Cleaning:** Use a soft, dry cloth to wipe the grip. Avoid abrasive cleaners or solvents.
- **Storage:** Store the grip in a cool, dry place away from direct sunlight and extreme temperatures.

- **Charging:** Charge the built-in 3200mAh battery regularly, even if not in frequent use, to maintain battery health.
- **Cooling System:** The grip features an advanced cooling system. Ensure the cooling vents are not obstructed during use.
- **Magnetic Connection:** Keep the magnetic surfaces clean and free of debris to ensure a strong and secure connection to your iPhone.

## TROUBLESHOOTING

If you encounter issues with your Keledz Magnetic Phone Camera Grip, refer to the following common solutions:

- **Grip Not Powering On:** Ensure the grip is fully charged. Press and hold the Shooting Button for 2 seconds to power on.
- **Bluetooth Connection Issues:**
  - Make sure Bluetooth is enabled on your iPhone.
  - Forget the device ("TELESIN\_IP") in your iPhone's Bluetooth settings and attempt to pair again.
  - Restart both your iPhone and the grip.
- **Controls Not Responding:**
  - Verify the Bluetooth connection is active.
  - Ensure the camera app is open and active on your iPhone.
  - Check for any app updates for the Reef Color App.
- **Unstable Magnetic Connection:**
  - Ensure both the grip's magnetic surface and your iPhone's back (or magnetic ring) are clean and free of obstructions.
  - Confirm your iPhone model is compatible or that the magnetic suction ring is correctly applied.

For further assistance, please contact customer support.

## SPECIFICATIONS

<b>Model Number</b>	P5-MP-003
<b>Brand</b>	Keledz
<b>Compatible Devices</b>	iPhone 17 Pro
<b>Color</b>	Black&Gray
<b>Product Dimensions</b>	4.8"D x 1.4"W x 3.1"H (12.1cm x 3.5cm x 8.9cm)
<b>Weight</b>	180g
<b>Battery Capacity</b>	3200mAh
<b>Charging Input</b>	5V2A Type-C
<b>Charge Time</b>	2 hours
<b>Maximum Weight Recommendation</b>	3 Kilograms
<b>Water Resistance Level</b>	Not Water Resistant
<b>Manufacturer</b>	Telesin digital Co.,Ltd.

# Specifications



**Material** ABS/PC/aluminum alloy

**Dimensions** 4.8×1.7×3.5in

**Weight** 180g

**Battery** 3200mAh

**Charging** 5V2A Type-C

**Charge Time** 2 hr

Image: Visual representation of product dimensions and key specifications.

## WARRANTY AND SUPPORT

The Keledz Magnetic Phone Camera Grip comes with a **1-year warranty** from the date of purchase, covering manufacturing defects. Please retain your proof of purchase for warranty claims.

For technical support, troubleshooting assistance, or warranty inquiries, please visit the official Keledz store or contact their customer service through the platform where the product was purchased.

Official Brand Store: [Keledz Store on Amazon](#)