

## Futanwei PUBU S69

# Futanwei Tempered Glass Screen Protector User Manual for PUBU S69 Smartwatch

Model: PUBU S69 (1.46 Inch)

## 1. INTRODUCTION

---

Thank you for choosing the Futanwei Tempered Glass Screen Protector for your PUBU S69 Smartwatch. This product is designed to provide superior protection for your device's screen against scratches, impacts, and daily wear. This manual will guide you through the installation process and highlight the key features of your new screen protector.



Image: The Futanwei Tempered Glass Screen Protector applied to a PUBU S69 Smartwatch, showing its clear and protective layer.

## 2. PACKAGE CONTENTS

---

- 3 x Futanwei Tempered Glass Screen Protectors for PUBU S69 Smartwatch
- Wet Wipes
- Dry Wipes
- Dust Absorber Stickers

## 3. INSTALLATION GUIDE

---

Follow these steps carefully for a bubble-free and perfectly aligned installation of your screen protector.

# Install Guide:



## Step 1

Gently clean phone screen with included wet wipe 1, then dry wipe 2.



## Step 2

Use included dust absorber to remove all dust on phone screen.

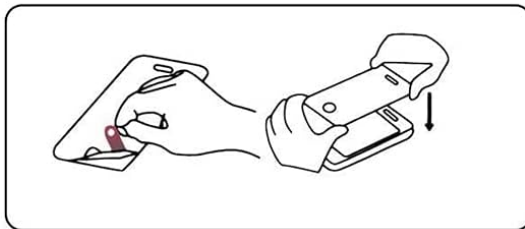

## Step 3

Peel off the film on the back of the screen protector.

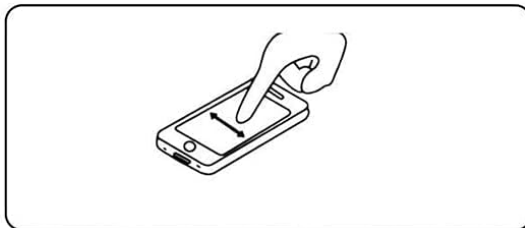

## Step 4

Align the screen protector to the screen and press the middle part with finger.

Image: A visual guide illustrating the four steps for applying the screen protector to a device.

### 1. Step 1: Clean the Screen

Gently clean your smartwatch screen with the included wet wipe (labeled '1'). Follow this by drying the screen thoroughly with the dry wipe (labeled '2'). Ensure no moisture or residue remains.

### 2. Step 2: Remove Dust

Use the provided dust absorber sticker to carefully remove any remaining dust particles from the smartwatch screen. Inspect the screen closely under good lighting to ensure it is completely dust-free.

### 3. Step 3: Prepare the Protector

Carefully peel off the protective film from the adhesive side of the tempered glass screen protector. Avoid touching the adhesive surface to prevent fingerprints or dust.

### 4. Step 4: Apply the Protector

Align the screen protector precisely with your smartwatch screen. Once aligned, gently press the middle part of the protector with your finger. The adhesive will spread automatically. If any small bubbles remain, gently push them towards the edges with a soft cloth.

## 4. PRODUCT FEATURES

The Futanwei Tempered Glass Screen Protector offers several key features to enhance your smartwatch experience:

- **Compatible Model:** Specifically designed for the PUBU S69 Smart Watch (1.46 Inches). Please verify your smartwatch model before installation.

## Compatible Model

Specially Designed for **PUBU S69** Smart Watch



Image: A PUBU S69 Smartwatch with the screen protector, emphasizing its compatibility.

- **9H Hardness:** Constructed from 9H-hardened tempered glass, providing robust protection against scratches from keys, coins, and other hard objects.

## High Hardness

Guardian of screen.

All glass is more resistant to hard objects.

Daily scratch and wear resistance.



Image: A utility knife blade shown near a smartwatch screen, illustrating the screen protector's high hardness and scratch resistance.

- **Oleophobic and Hydrophobic Coating:** Features a special coating that repels sweat and oil residue, reducing fingerprints and making the screen easier to clean. It also offers water resistance.
- **Ultra HD Clarity & High Transparency:** With 99.9% light transmission, the protector maintains the original display quality of your smartwatch, ensuring clear photos and videos without distortion.



# Ultra Clear

Advanced HD Clarity Tempered Glass



Image: A close-up of a smartwatch screen with the ultra-clear tempered glass protector, showcasing its transparency.

- **High Touch Sensitivity:** Designed to preserve the original touch sensitivity of your smartwatch screen, allowing for smooth and responsive interaction.

# Bubble Free



Image: A finger interacting with a smartwatch screen, demonstrating the maintained touch sensitivity after protector application.

- **Bubble-Free Application:** Engineered for easy, bubble-free installation when following the provided instructions.

# Touch Sensitive

Provide 100% touch screen effect. Keep the original touch sensitivity of the screen fast



Image: A smartwatch screen next to an icon representing a bubble-free installation process.

## 5. SPECIFICATIONS

Specification	Detail
Brand	Futanwei
Compatible Model	PUBU S69 Smart Watch (1.46 Inches)
Material	Tempered Glass
Item Hardness	9H
Special Features	Anti-Scratch, Bubble Free, HD Clarity, Oleophobic, Hydrophobic, High Touch Sensitivity
Finish Type	Glossy
Product Dimensions	7.62 x 5.08 x 1.27 cm



Item Weight

9.07 g

## 6. TROUBLESHOOTING

- **Bubbles After Installation:** Small bubbles may disappear naturally within 24-48 hours. For larger bubbles, gently lift the nearest edge of the protector and reapply, pushing the bubble out with a soft cloth. Ensure the screen is completely dust-free before reapplication.
- **Misalignment:** If the protector is misaligned, carefully lift it from one corner and re-align. This is best done immediately after initial placement.
- **Dust Under Protector:** If dust particles are trapped, carefully lift the protector and use a dust absorber sticker to remove the dust from both the screen and the adhesive side of the protector.



## 7. WARRANTY AND SUPPORT



Futanwei products are designed for quality and durability. While specific warranty details are not provided in this manual, please retain your proof of purchase. For any questions, concerns, or support regarding your Futanwei Tempered Glass Screen Protector, please contact the seller or Futanwei customer service through the platform where you made your purchase.

We are committed to ensuring your satisfaction with our products.

© 2025 Futanwei. All rights reserved.

### Related Documents - PUBU S69

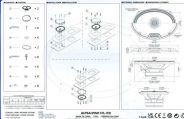
	<p><a href="#">Pubu Smartwatch: Connection Guide, Call Features &amp; Audio Playback</a></p> <p>Comprehensive instructions for connecting your Pubu smartwatch to your smartphone, utilizing its call receiving and dialing capabilities, and managing audio playback settings across iOS and Android devices.</p>
	<p><a href="#">How to Connect and Use Your S53 Smartwatch</a></p> <p>A comprehensive guide on connecting your S53 smartwatch to your phone, using its call receiving and dialing functions, and managing app audio playback for both iOS and Android systems.</p>

 <p>User's manual COLMI P71</p> <p>Comprehensive user manual for the COLMI P71 smartwatch. Learn about its features, specifications, charging, connection, operation, troubleshooting, and precautions. Get the most out of your COLMI P71.</p>	<p><a href="#">COLMI P71 Smartwatch User Manual - Features, Setup, and Specifications</a></p> <p>Comprehensive user manual for the COLMI P71 smartwatch. Learn about its features, specifications, charging, connection, operation, troubleshooting, and precautions. Get the most out of your COLMI P71.</p>
 <p>Alpine R2-S69 6x9 Inch Coaxial 2-Way Speaker System - Installation, Specifications, and Warranty</p> <p>Comprehensive guide for the Alpine R2-S69 6x9 inch coaxial 2-way speaker system, covering installation, technical specifications, important warnings, product registration, and limited warranty details from Alpine Electronics.</p>	<p><a href="#">Alpine R2-S69 6x9 Inch Coaxial 2-Way Speaker System - Installation, Specifications, and Warranty</a></p> <p>Comprehensive guide for the Alpine R2-S69 6x9 inch coaxial 2-way speaker system, covering installation, technical specifications, important warnings, product registration, and limited warranty details from Alpine Electronics.</p>
 <p>Alpine S2-S69 Coaxial 2-Way Speaker System - Installation, Specifications, and Warranty</p> <p>Detailed information for the Alpine S2-S69 Coaxial 2-Way Speaker System, including installation guidelines, technical specifications, and limited warranty details. Learn about product features, power handling, and compliance.</p>	<p><a href="#">Alpine S2-S69 Coaxial 2-Way Speaker System - Installation, Specifications, and Warranty</a></p> <p>Detailed information for the Alpine S2-S69 Coaxial 2-Way Speaker System, including installation guidelines, technical specifications, and limited warranty details. Learn about product features, power handling, and compliance.</p>
 <p>Alpine 2025 Product Catalog: High-Resolution Car Audio Systems</p> <p>Discover the latest in automotive sound with the Alpine 2025 Product Catalog. Featuring Hi-Res Audio certified systems, amplifiers, speakers, and subwoofers designed to elevate your driving experience. Explore innovative solutions for seamless integration and legendary sound quality.</p>	<p><a href="#">Alpine 2025 Product Catalog: High-Resolution Car Audio Systems</a></p> <p>Discover the latest in automotive sound with the Alpine 2025 Product Catalog. Featuring Hi-Res Audio certified systems, amplifiers, speakers, and subwoofers designed to elevate your driving experience. Explore innovative solutions for seamless integration and legendary sound quality.</p>