



[Manuals.plus](#) /

> [Seesii](#) /

> SEESII Cordless Pole Hedge Trimmer ET1611-510 User Manual

Seesii ET1611-510

SEESII Cordless Pole Hedge Trimmer ET1611-510 User Manual

Model: ET1611-510

1. IMPORTANT SAFETY INSTRUCTIONS

Read all safety warnings and instructions before operating this tool. Failure to follow the warnings and instructions may result in electric shock, fire, and/or serious injury. Keep this manual for future reference.

General Power Tool Safety

- **Work Area Safety:** Keep the work area clean and well-lit. Cluttered or dark areas invite accidents. Do not operate power tools in explosive atmospheres, such as in the presence of flammable liquids, gases, or dust.
- **Electrical Safety:** Avoid body contact with earthed or grounded surfaces such as pipes, radiators, ranges, and refrigerators. There is an increased risk of electric shock if your body is earthed or grounded.
- **Personal Safety:** Always wear eye protection. Use appropriate personal protective equipment such as dust masks, non-skid safety shoes, hard hats, or hearing protection for relevant conditions. Stay alert, watch what you are doing, and use common sense when operating a power tool.
- **Tool Use and Care:** Do not force the power tool. Use the correct power tool for your application. It will do the job better and safer at the rate for which it was designed. Disconnect the battery pack from the power tool before making any adjustments, changing accessories, or storing power tools.

Hedge Trimmer Specific Safety

- **Keep Hands Away from Blades:** Never attempt to remove cut material or hold material to be cut when blades are moving. Ensure the switch is off when clearing jammed material. A moment of inattention while operating the hedge trimmer may result in serious personal injury.
- **Hold Tool Properly:** Hold the hedge trimmer by insulated gripping surfaces only, because the cutter blade may contact hidden wiring or its own cord.
- **Clear Work Area:** Before starting, inspect the area for foreign objects such as wires or other debris that could become entangled in the blades.
- **Maintain Balance:** Always maintain proper footing and balance. Do not overreach.
- **Use Shoulder Strap:** Utilize the provided shoulder strap to reduce fatigue and maintain better control,

especially when using the telescopic pole.

- **Blade Cover:** Always use the blade cover when storing or transporting the hedge trimmer.

2. PACKAGE CONTENTS

Verify that all items listed below are included in your package. If any parts are missing or damaged, please contact customer support.

- 1 x SEESII 20" Cordless Hedge Trimmer Head
- 1 x Telescopic Pole with Comfortable Grip
- 2 x 4000mAh Rechargeable Battery
- 1 x Fast Charger
- 1 x Ergonomic Shoulder Strap
- 1 x Safety Blade Cover
- 1 x User Manual

What's in the Box?



2 x 4.0Ah Rechargeable Batteries



Fast Charger



User Manual



Shoulder Strap



Blade Cover

Image: The package includes the 20-inch hedge trimmer head, telescopic pole, two 4000mAh batteries, a fast charger, shoulder strap, safety blade cover, and user manual.

3. ASSEMBLY AND SETUP

Follow these steps to assemble your SEESII Cordless Pole Hedge Trimmer.

Assembly Steps

1. **Insert the Pole into the Head:** Align the telescopic pole with the trimmer head and push firmly until it clicks into place. Ensure a secure connection.
2. **Attach the Shoulder Strap:** Clip the ergonomic shoulder strap to the designated attachment point on the

pole. Adjust the strap for comfortable use.

3. **Insert the Battery:** Slide a charged 4000mAh battery into the battery compartment on the handle until it locks securely.
4. **Start the Trimmer:** Press the safety lock button and then squeeze the trigger to start the trimmer. Release the safety lock once the trigger is engaged.

Your browser does not support the video tag.

Video: This video demonstrates how to install the battery and attach the pole to the hedge trimmer for initial setup.



1 Insert the Pole into the Head.



2 Attach the Shoulder Strap.



3 Insert the Battery.



4 Press Trigger+Safety Lock to Start.

Image: A visual guide showing the four quick assembly steps: inserting the pole, attaching the shoulder strap, inserting the battery, and pressing the trigger with the safety lock.

4. OPERATION

This section provides instructions for operating your hedge trimmer effectively and safely.

General Trimming Guidelines

- Always ensure the area is clear of people, pets, and obstacles before starting.
- Hold the trimmer firmly with both hands when operating, or use the shoulder strap for support.
- Move the trimmer in a smooth, sweeping motion across the hedge.
- Avoid cutting branches thicker than the specified 18mm (0.71") cutting capacity to prevent damage to the blades and motor.

Adjusting Pole Length and Head Angle

The telescopic pole allows you to extend your reach up to 8 feet, and the head can be adjusted by 120 degrees for versatile trimming.

Your browser does not support the video tag.

Video: This video demonstrates how to adjust the telescopic pole length and the angle of the trimmer head.



Image: The trimmer head can be adjusted up to 120 degrees, allowing for flexible trimming of hedge tops and sides.

Reach Higher with Confidence

Trim Tall Hedges from the Ground



Aluminum
Pole



Reinforced
& Durable



Rust-
Resistant

Image: A man demonstrates using the extended pole hedge trimmer to reach and trim the top of a tall hedge without needing a ladder.

Your browser does not support the video tag.

Video: An overview of the SEESII 20" Cordless Pole Hedge Trimmer, highlighting its features and use.

5. BATTERY CHARGING AND CARE

The SEESII Cordless Pole Hedge Trimmer is powered by two 4000mAh lithium-ion batteries, providing extended runtime.

Charging Instructions

- Use only the provided fast charger to charge the batteries.
- Insert the battery into the charger. The indicator light on the charger will show the charging status.
- A full charge typically takes 1-2 hours per battery.
- Do not overcharge batteries. Remove them from the charger once fully charged.

Battery Care

- Store batteries in a cool, dry place away from direct sunlight and extreme temperatures.
- Do not store batteries in a discharged state for long periods. Charge them periodically if not in use.
- Dispose of old or damaged batteries according to local regulations.

Dual 4.0Ah Batteries

Finish the Job in One Go



Image: Two 4000mAh lithium-ion batteries, which provide power for the cordless hedge trimmer.



Image: This image highlights the dual 4000mAh batteries, fast charging capability (1-2 hours), and up to 60 minutes of runtime per battery.

6. MAINTENANCE

Regular maintenance ensures optimal performance and extends the life of your hedge trimmer.

Blade Care

- **Cleaning:** After each use, disconnect the battery and carefully clean the blades with a stiff brush to remove sap, leaves, and debris.
- **Lubrication:** Apply a light machine oil or blade lubricant to the blades after cleaning to prevent rust and ensure smooth operation.
- **Sharpening:** If the blades become dull, they can be sharpened by a qualified service technician.

Storage

- Always attach the safety blade cover before storing the trimmer.
- Store the tool in a dry, secure location out of reach of children.
- Ensure batteries are charged before long-term storage.

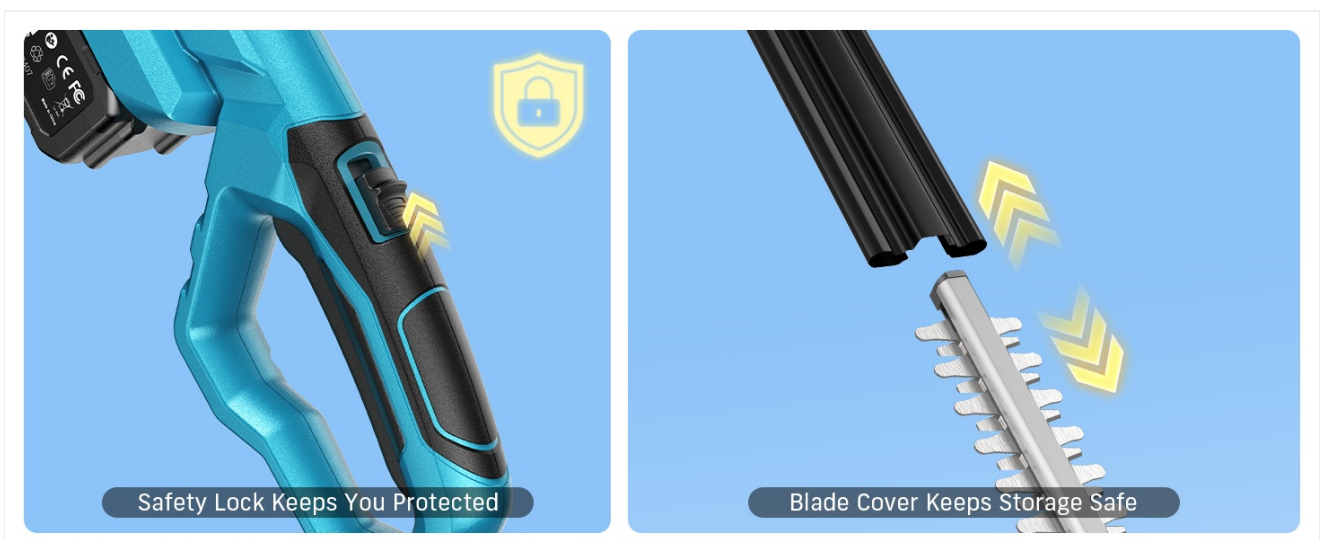

Image: This image shows the safety lock mechanism on the handle and the blade cover for safe storage.

7. TROUBLESHOOTING

This section addresses common issues you might encounter with your hedge trimmer.

Problem	Possible Cause	Solution
Trimmer does not start	Battery not inserted correctly Battery discharged Safety lock not engaged	Ensure battery is fully seated Charge battery fully Press safety lock before squeezing trigger
Reduced cutting performance	Dull blades Blades clogged with debris Cutting material too thick	Sharpen blades (professional service recommended) Clean blades thoroughly Do not attempt to cut branches exceeding 18mm (0.71")
Excessive vibration	Loose components Damaged blade	Check all connections and tighten if necessary Inspect blade for damage; replace if necessary

If you encounter issues not listed here or if solutions do not resolve the problem, please contact SEESII customer support.

8. SPECIFICATIONS

Key technical specifications for the SEESII Cordless Pole Hedge Trimmer ET1611-510:

Feature	Specification
Brand	Seesii
Model Number	ET1611-510
Power Source	Battery Powered
Voltage	20 Volts
Blade Length	20 Inches
Cutting Capacity	18mm / 0.71 Inches
Telescopic Pole Length	6-8 Feet
Adjustable Head Angle	120 Degrees
Motor Power	600W
Blade Speed	Up to 2,400 SPM
Item Weight	7.8 Pounds
Product Dimensions (L x W x H)	40.1" x 6.3" x 7.1"
Material Type	Aluminum

9. WARRANTY AND SUPPORT

SEESII is committed to providing quality products and customer satisfaction.

Manufacturer's Warranty

This product comes with a **2-Year Manufacturer Warranty**. This warranty covers defects in materials and workmanship under normal use. It does not cover damage resulting from misuse, abuse, accidents, or unauthorized repairs.

Customer Support

For technical support, warranty claims, or any questions regarding your SEESII Cordless Pole Hedge Trimmer, please contact our customer service team. We offer 36 months of technical support and aim for a fast response within 24 hours.



Image: A customer service representative ready to assist with product inquiries and support.