

Tilta TKL-IP17-AFC-B

Tilta Khronos Lite Case for iPhone 17 Air - Black: User Manual

Model: TKL-IP17-AFC-B

INTRODUCTION

This manual provides instructions for the proper installation, operation, and maintenance of your Tilta Khronos Lite Case for iPhone 17 Air. Please read this manual thoroughly before using the product to ensure optimal performance and longevity.

KEY FEATURES

- Custom designed for iPhone 17 Air.
- Lightweight design for professional performance in a compact package.
- Integrated kickstand supports vertical and horizontal configurations.
- Magnetic connection supports accessories like lights, SSDs, power banks, or cooling fans.
- Additional protection via metal lens frame and reinforced corners.

WHAT'S IN THE BOX

- 1 x Tilta Khronos Lite iPhone 17 Air Case - Black
- 1 x Khronos Screen Protector for iPhone 17 Air

SETUP

Case Installation

1. Ensure your iPhone 17 Air is clean and free of dust or debris.
2. Carefully align the iPhone with the case, ensuring all buttons and ports match the case cutouts.
3. Gently press the iPhone into the case until it is securely seated. Ensure all edges are fully enclosed by the case.

Screen Protector Installation

1. Clean the iPhone screen thoroughly using a microfiber cloth to remove any smudges or dust.
2. Carefully peel off the protective film from the screen protector.

3. Align the screen protector with the iPhone screen, starting from one edge and slowly lowering it.
4. Gently press down on the center of the screen protector and smooth out any air bubbles towards the edges.



Image: The Tilta Khronos Lite Case securely installed on an iPhone 17 Air, showcasing its sleek black design and integrated kickstand.

OPERATING INSTRUCTIONS

Using the Integrated Kickstand

The Khronos Lite Case features a built-in kickstand for hands-free viewing. To deploy the kickstand, locate the small tab on the back of the case and gently pull it outwards. The kickstand can be used to prop up your iPhone in both vertical (portrait) and horizontal (landscape) orientations for comfortable viewing of videos, video calls, or browsing.

BUILT-IN KICKSTAND

Supports both portrait and landscape modes, perfect for hands-free video calls, streaming, or study sessions.



PORTRAIT MODE

65°

FIXED-ANGLE BRACKET

LANDSCAPE MODE



Image: An iPhone 17 Air case demonstrating the integrated kickstand in both portrait and landscape modes, providing a stable 65-degree fixed-angle bracket.

Magnetic Back Plate for Accessories

The case includes a magnetic back plate designed to securely attach various accessories. Simply align your compatible magnetic accessory (such as an LED light, SSD, power bank, or cooling fan) with the magnetic area on the back of the case until it snaps into place. Ensure a firm connection before use.

MAGNETIC BACK PANEL

Snap on essentials available separately: Card holder, LED light, SSD, Power bank, Cooling fan.



Image: A visual representation of the magnetic back panel on the Khronos Lite Case, showing how compatible accessories can be attached and detached.

Capacitive Camera Control Button

The case features a capacitive camera control button for enhanced photography experience. This button provides a tactile and responsive way to interact with your iPhone's camera functions.



Metal Lens Ring Prevents Scratches

Capacitive "Camera Control" Button

Image: An exploded view illustrating the components of the metal lens ring and the capacitive camera control button, highlighting their integration into the case design.

PROTECTION FEATURES

The Tilta Khronos Lite Case is engineered to provide robust protection for your iPhone 17 Air:

- **Reinforced Corners:** Designed to absorb impact and protect your device from drops and bumps.
- **Metal Lens Frame:** A durable metal frame surrounds the camera lenses, preventing scratches and direct impact damage.

PROTECTION THAT MATTERS

Reinforced corners absorb impact.



Image: A detailed view of the reinforced corners on the Khronos Lite Case, showcasing the textured design engineered to absorb impact.

PRODUCT OVERVIEW VIDEO

Your browser does not support the video tag.

Video: An official overview from Tilta introducing the Khronos Lite series for iPhone 17, highlighting its design, features, and compatibility with various iPhone 17 models.

MAINTENANCE

To keep your Tilta Khronos Lite Case in optimal condition:

- **Cleaning:** Wipe the case regularly with a soft, damp cloth. Avoid using harsh chemicals or abrasive cleaners, as these may damage the finish.
- **Inspection:** Periodically inspect the case for any signs of wear or damage, especially around the corners and lens frame.
- **Storage:** When not in use, store the case in a clean, dry environment away from direct sunlight and extreme temperatures.

TROUBLESHOOTING

- **Case not fitting correctly:** Ensure you have the correct model of the Khronos Lite Case for your iPhone 17 Air. Double-check that the phone is aligned properly before pressing it into the case.
- **Magnetic accessories not attaching securely:** Verify that the accessory is compatible with the Khronos magnetic system. Ensure there is no debris between the accessory and the case's magnetic plate.
- **Kickstand not deploying/retracting smoothly:** Check for any obstructions or debris in the kickstand mechanism. Apply gentle, even pressure when operating.

SPECIFICATIONS

Feature	Detail
Model Number	TKL-IP17-AFC-B
Compatible Devices	iPhone 17 Air
Color	Black
Item Weight	13.4 ounces
Package Dimensions	11.42 x 9.06 x 4.33 inches
Manufacturer	Tilta
UPC	810193520120

WARRANTY AND SUPPORT

For detailed warranty information and customer support, please refer to the documentation included with your product or visit the official Tilta website. You can also find more information and contact options at the [Tilta Store on Amazon](#).

Related Documents - TKL-IP17-AFC-B

	<p>KHROS iPhone 15 Pro Max Accessory Kit by TILTA - User Manual</p> <p>Comprehensive guide to the TILTA KHROS accessory system for iPhone 15 Pro Max, including the case, power handle, cooling system, card holder, NATO bracket, and hand wheel controller. Learn about product specifications, assembly instructions, feature descriptions, Bluetooth connectivity, and safety guidelines.</p>
---	---

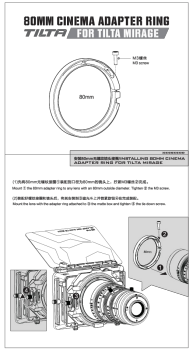

[Tilta 80mm Cinema Adapter Ring for Mirage: Installation Guide](#)

Step-by-step installation instructions for the Tilta 80mm Cinema Adapter Ring, compatible with the Tilta Mirage matte box. Learn how to attach the adapter to your lens and secure it to the matte box.

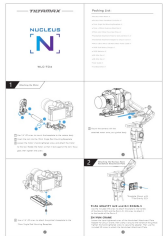

[Tilta Nucleus-Nano Wireless Lens Control WLC-T04 User Guide](#)

A comprehensive guide to setting up and using the Tilta Nucleus-Nano Single Channel Wireless Lens Control system (WLC-T04), including attaching the motor and handwheel, auto-calibration, and wireless control assignment.

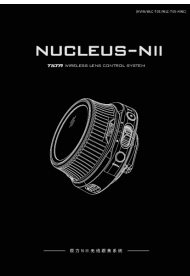

[Tilta Nucleus-N II Wireless Lens Control System User Manual](#)

User guide for the Tilta Nucleus-N II Wireless Lens Control System (WLC-T05), detailing hand unit and motor setup, operation, pairing, firmware updates, and safety precautions.

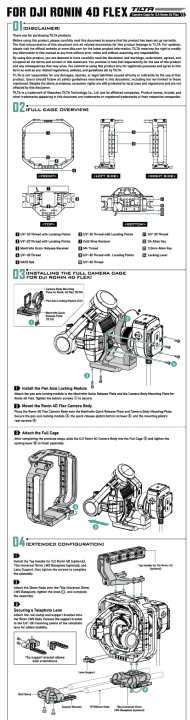

[DJI Ronin 4D Flex Camera Cage Installation and Configuration Guide](#)

A comprehensive guide to installing and configuring the Tilta Camera Cage for the DJI Ronin 4D Flex, including component overviews and extended setup options.

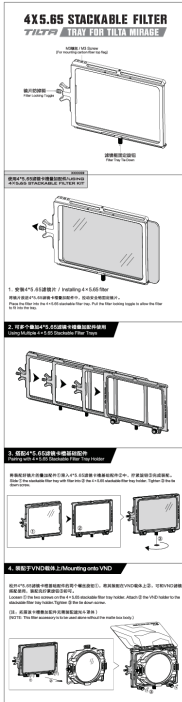

[Tilta 4x5.65 Stackable Filter Tray for Tilta Mirage - Installation Guide](#)

A comprehensive guide detailing the installation and usage of the Tilta 4x5.65 Stackable Filter Tray with the Tilta Mirage camera system. Learn how to insert filters, stack multiple trays, and mount the system onto VND carriers.