

KESIEME YYK-530

KESIEME YYK-530 Bluetooth Earpiece User Manual

Model: YYK-530

1. INTRODUCTION

Thank you for choosing the KESIEME YYK-530 Bluetooth Earpiece. This single-ear wireless headset is designed for clear phone calls and hands-free communication, featuring noise-cancelling technology and a comfortable, adjustable design. This manual provides detailed instructions for setup, operation, and maintenance to ensure optimal performance.



Image 1.1: KESIEME YYK-530 Bluetooth Earpiece.

2. PRODUCT FEATURES

- **Extended Battery Life:** The earpiece provides 12-15 hours of continuous talk time. The included charging case extends total usage time up to 180 hours. A full charge takes approximately 1.5 hours via the Type-C port.
- **Bluetooth 5.2 Connectivity:** Utilizes the latest Bluetooth 5.2 technology for a fast and stable connection up to 33 feet (10 meters) from your device.
- **Advanced Noise Cancellation:** Equipped with built-in HD microphones and CVC8.0 noise reduction technology for crystal clear audio during calls.
- **Comfortable and Adjustable Design:** Lightweight (12g) with a 360° adjustable ear hook and three optional ear tips for a secure and comfortable fit on either ear.
- **Hands-Free Operation:** Supports voice assistant activation (Siri or Google Assistant) and features easy-to-reach buttons for call management, including a mute function.
- **Multi-Device Connection:** Can connect to two Bluetooth devices simultaneously, allowing you to answer calls from either device.



Image 2.1: Hands-free conversation with CVC 8.0 noise reduction.

3. SETUP

3.1 Charging the Earpiece

1. Connect the provided Type-C charging cable to the charging port on the earpiece.
2. Connect the other end of the cable to a USB power source (e.g., wall adapter, computer USB port).
3. The LED indicator on the earpiece will show charging status. A full charge typically takes 1.5 hours.
4. The charging case also has an LED display to indicate its battery level.

120mAh Headphone Battery Capacity

24 hours
standby time

12 hours
talk time

15 hours
of music playback time



Image 3.1: Earpiece battery capacity and charging information.

3.2 Powering On/Off

- **Power On:** Press and hold the Power button for approximately 3 seconds until the LED indicator flashes.
- **Power Off:** Press and hold the Power button for approximately 5 seconds until the LED indicator turns off.

3.3 Bluetooth Pairing

1. Ensure the earpiece is fully charged and powered off.
2. Press and hold the Power button for about 5-7 seconds until the LED indicator flashes red and blue alternately, indicating it is in pairing mode.
3. On your smartphone, tablet, or other Bluetooth-enabled device, go to the Bluetooth settings.
4. Search for available devices and select "YYK-530" from the list.
5. Once connected, the LED indicator on the earpiece will flash blue slowly.
6. The earpiece can connect to two devices simultaneously. To connect a second device, repeat steps 2-4 after the first device is paired.

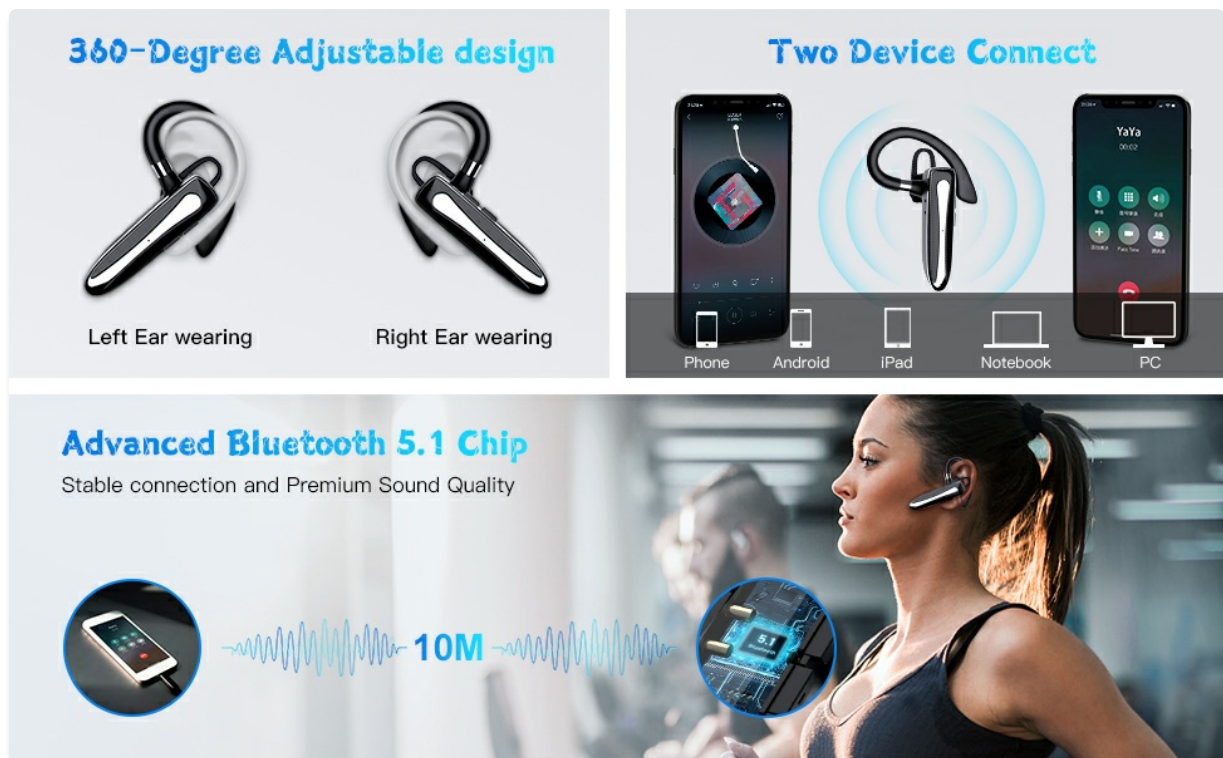

Image 3.2: Bluetooth 5.2 quick connection with various devices.



Image 3.3: Multiple device connection capability.

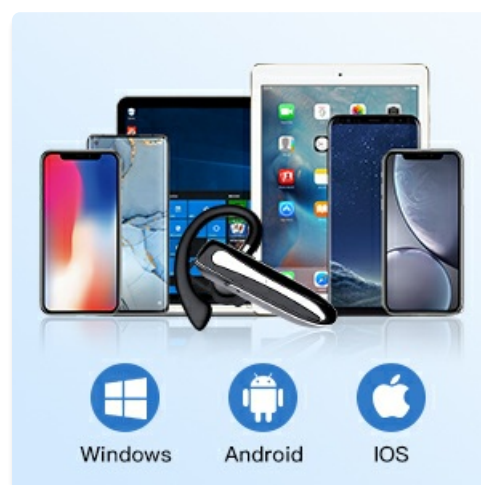

Image 3.4: Compatibility with various operating systems.

4. OPERATING INSTRUCTIONS

4.1 Wearing the Earpiece

The YYK-530 features a 360° adjustable ear hook and comes with three sizes of ear tips to ensure a comfortable and secure fit. You can wear it on either your left or right ear.

1. Choose the ear tip size that best fits your ear canal.
2. Adjust the ear hook to comfortably fit over your ear.
3. Rotate the earpiece body to position the microphone towards your mouth for optimal voice pickup.

Ergonomic Design

Switch between left and right ears at will to bring you a better experience



Image 4.1: Ergonomic design and 360° adjustability for left or right ear wearing.

4.2 Button Functions

Refer to the diagram below for the location and function of each button:

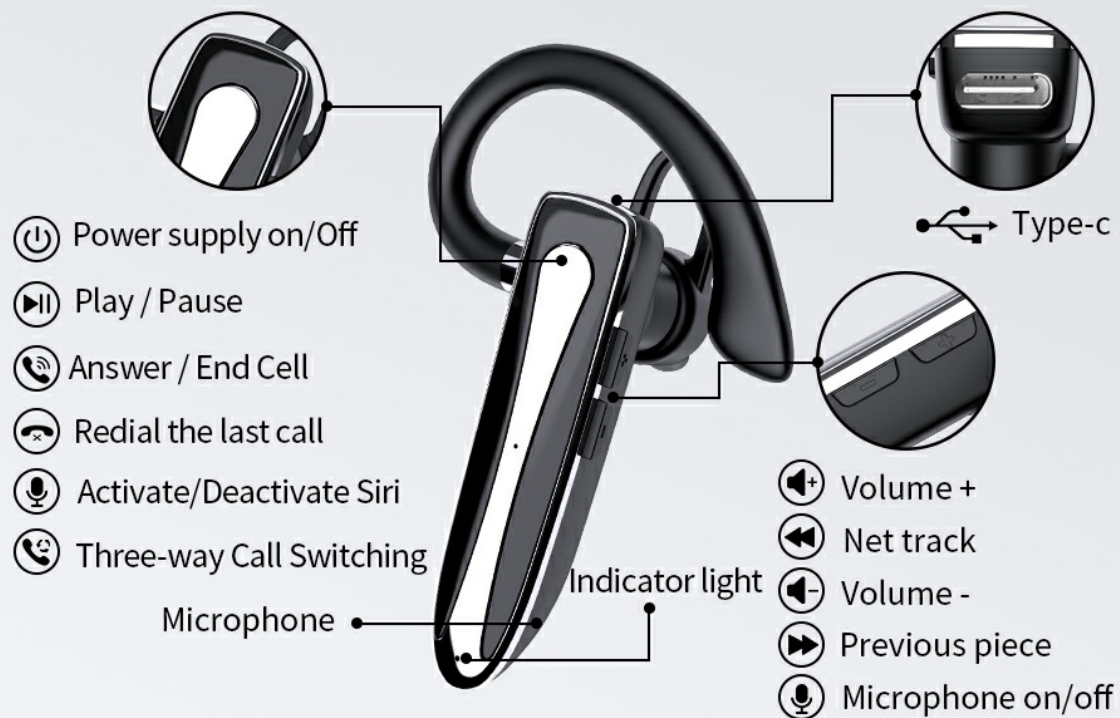

Image 4.2: Earpiece control layout and functions.

- **Power Supply On/Off:** Press and hold the main button.
- **Play/Pause:** Single press the main button during music playback.
- **Answer/End Call:** Single press the main button during an incoming call or active call.
- **Redial Last Call:** Double press the main button.
- **Activate/Deactivate Voice Assistant (Siri/Google Assistant):** Press and hold the main button for 2 seconds.
- **Three-way Call Switching:** During a three-way call, single press the main button to switch between calls.
- **Volume + / Next Track:** Single press for Volume +, long press for Next Track.
- **Volume - / Previous Piece:** Single press for Volume -, long press for Previous Track.
- **Microphone On/Off (Mute):** Press the Volume +/- button for 2 seconds during a call to mute/unmute the microphone.

4.3 Important Note for Laptop/Computer Calls

When the headset is connected to a laptop or computer during a call, the sound will only be picked up by the microphone on the laptop/computer, not the headset's microphone. Please ensure you stay near your connected device for clear communication in this scenario. This is a common characteristic of many wireless Bluetooth earphones.



Image 4.3: Microphone behavior when connected to a computer.

5. MAINTENANCE

- **Cleaning:** Wipe the earpiece with a soft, dry cloth. Do not use harsh chemicals or abrasive materials.
- **Storage:** Store the earpiece in its charging case when not in use to protect it from dust and damage.
- **Battery Care:** To prolong battery life, avoid fully discharging the earpiece frequently. Charge it regularly, even if not in constant use.
- **Water Resistance:** The earpiece is rated as waterproof. However, avoid prolonged submersion in water. Ensure the charging port cover is securely closed.

6. TROUBLESHOOTING

Problem	Possible Cause	Solution
Earpiece does not power on.	Low battery.	Charge the earpiece fully.
Cannot pair with device.	Earpiece not in pairing mode; Bluetooth off on device; too far from device.	Ensure earpiece is in pairing mode (flashing red/blue). Turn on Bluetooth on your device. Move earpiece closer to the device (within 33 feet).
No sound or poor sound quality.	Volume too low; earpiece not connected; interference.	Adjust volume on earpiece and device. Re-pair the earpiece. Move away from sources of interference.
Microphone not working during computer calls.	System default microphone is computer's built-in mic.	This is expected behavior. Use the computer's microphone and stay within range.

Problem	Possible Cause	Solution
Earpiece disconnects frequently.	Out of range; low battery; interference.	Stay within 33 feet of the connected device. Charge the earpiece. Avoid strong Wi-Fi signals or other Bluetooth devices.

7. SPECIFICATIONS

Feature	Detail
Model Number	YYK-530
Bluetooth Version	5.2
Bluetooth Range	Up to 33 feet (10 meters)
Battery Life (Talk Time)	12-15 hours
Battery Life (with Charging Case)	Up to 180 hours
Charging Time	Approximately 1.5 hours
Charging Port	Type-C
Noise Control Features	CVC8.0 Active Noise Cancellation
Earpiece Shape	Ear Hook
Control Method	Push Button
Water Resistance Level	Waterproof
Compatible Devices	Smartphones, Tablets, Laptops, MP3 Players
Weight	12g (approx. 0.4 oz)

8. WARRANTY AND SUPPORT

KESIEME products are designed for reliability and performance. For warranty information or technical support, please refer to the contact details provided with your purchase or visit the official KESIEME website. Please retain your proof of purchase for warranty claims.